

06-15-12 LETTING ITEM 025

INDEX OF SHEETS

- 1 COVER SHEET & INDEX OF SHEETS
- 2 SUMMARY OF QUANTITIES
- 3 GENERAL NOTES & UTILITIES
- 4-9 PLAN SHEETS
- 10-15 PAVEMENT MARKING DETAIL
- 16 SIGN DETAILS
- 17 SOLAR POWERED FLASHING BEACON DETAIL
- 18-20 DISTRICT STANDARD 41.1

- 701106-2 OFF ROAD OPERATIONS, MULTILANE, MORE THAN 15' (4.5m) AWAY
- 701101-02 OFF ROAD OPERATIONS MULTILANE, 15' (4.5m) TO 24" (600mm) FROM PAVEMENT EDGE
- 701400-05 APPROACH TO LANE CLOSURE, FREEWAY/EXPRESSWAY
- 701406-06 LANE CLOSURE FREEWAY/EXPRESSWAY
- 701426-04 LANE CLOSURE, MULTILANE, INTERMITTENT OR MOVING OPERATIONS FOR SPEEDS > 45 MPH
- 701901-02 TRAFFIC CONTROL DEVICES
- 701701-08 URBAN LANE CLOSURE, MULTILANE INTERSECTION
- 814001-02 HANDHOLES

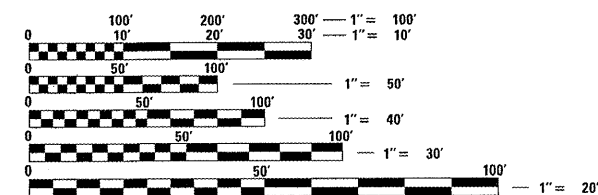

FULL SIZE PLANS HAVE BEEN PREPARED USING STANDARD ENGINEERING SCALES. REDUCED SIZED PLANS WILL NOT CONFORM TO STANDARD SCALES. IN MAKING MEASUREMENTS ON REDUCED PLANS, THE ABOVE SCALES MAY BE USED.

J.U.L.I.E.
JOINT UTILITY LOCATION INFORMATION FOR EXCAVATION
1-800-892-0123
OR 811

PROJECT ENGINEER SCOTT KULLERSTRAND 815.284.5468
PROJECT MANAGER KRISTINE HILL 815.284.5476

CONTRACT NO. 64H15

STATE OF ILLINOIS

DEPARTMENT OF TRANSPORTATION

DIVISION OF HIGHWAYS

PROPOSED HIGHWAY PLANS

FAP ROUTE 301 (US 20)
SECTION (17, 40)M-3
PROJECT: HSIP-0301(009)
TYPE of IMPROVEMENT
WINNEBAGO COUNTY

C-92-123-11

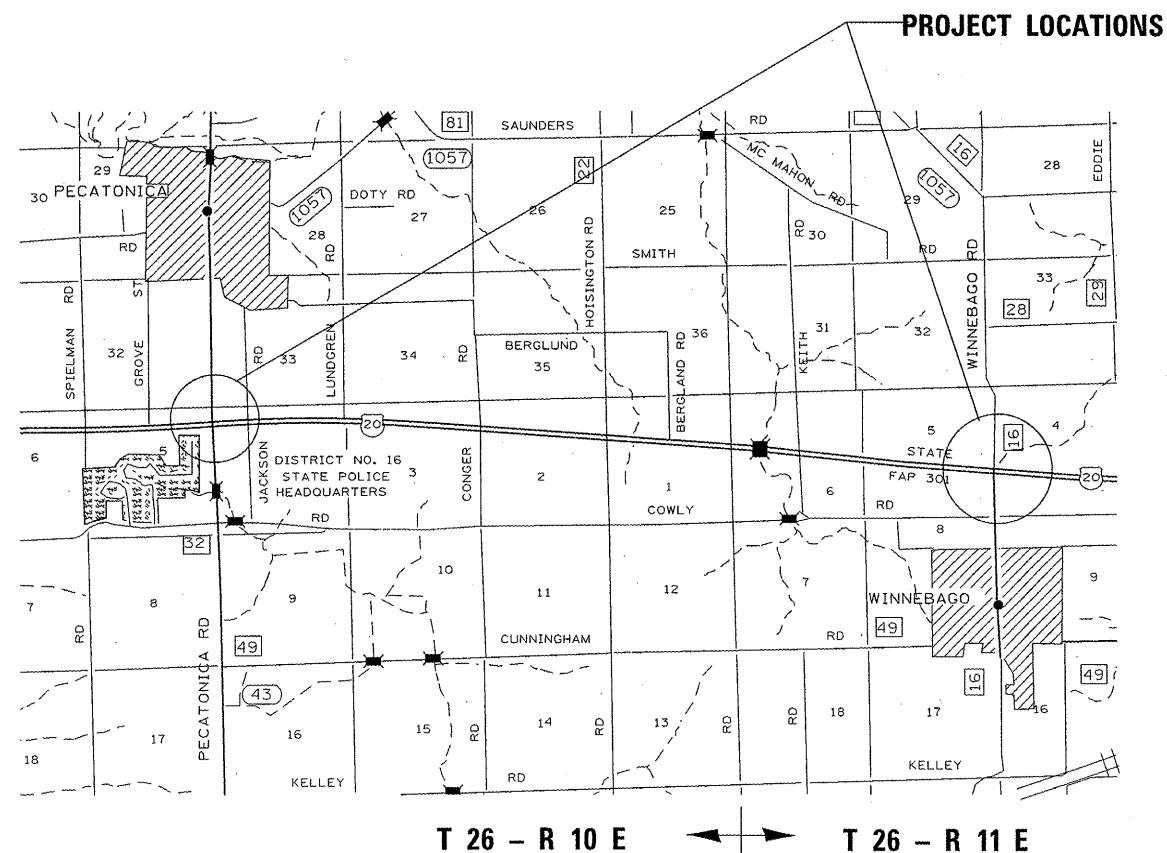

PROJECT LOCATIONS

| F.A.P. RTE. | SECTION | COUNTY | TOTAL SHEETS | SHEET NO. |
|-------------|-------------|-----------|--------------------|-----------|
| 301 | (17, 40)M-3 | WINNEBAGO | 19 | 1 |
| | | ILLINOIS | CONTRACT NO. 64H15 | |

long section number
multiple county names

D92-082-11

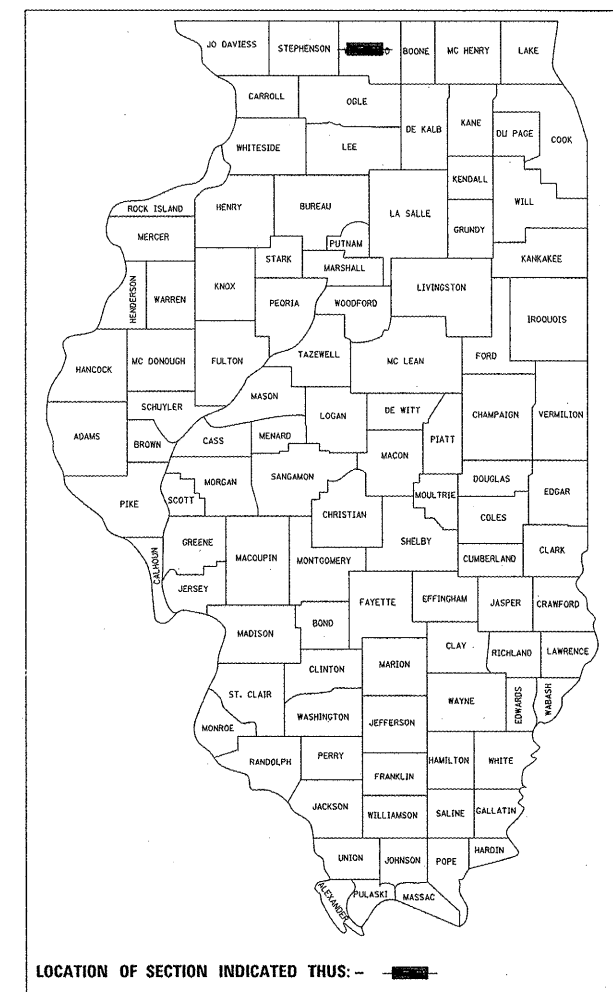

LOCATION OF SECTION INDICATED THUS: -

STATE OF ILLINOIS
DEPARTMENT OF TRANSPORTATION
DIVISION OF HIGHWAYS

SUBMITTED March 14 2012
Eric S. Chackel
DEPUTY DIRECTOR OF HIGHWAYS, REGION ENGINEER

May 11 2012
John D. Baranzeli, P.E.
ENGINEER OF DESIGN AND ENVIRONMENT

May 11 2012
William R. Frey, Jr.
DIRECTOR OF HIGHWAYS, CHIEF ENGINEER

PRINTED BY THE AUTHORITY
OF THE STATE OF ILLINOIS

| PAY CODE | TABULATION OF QUANTITIES | | UNIT | PECATONICA RD | WINNEBAGO RD | TOTAL QUANTITY | 90% Fed 10% State 0021 |
|----------|--|--|-------|---------------|--------------|----------------|------------------------------|
| | ITEM | | | | | | |
| 60100074 | SHOULDER REMOVAL AND REPLACEMENT, 8" | | FOOT | 8 | 8 | 16 | |
| 67100100 | MOBILIZATION | | L SUM | 0.5 | 0.5 | 1 | |
| 70102635 | TRAFFIC CONTROL AND PROTECTION, STANDARD 701701 | | L SUM | 0.5 | 0.5 | 1 | |
| 73000100 | WOOD POST SUPPORT | | FOOT | 40 | 40 | 80 | |
| 78000100 | THERMOPLASTIC PAVEMENT MARKING LETTERS & SYMBOLS | | SQ FT | 375 | 375 | 750 | |
| 78000200 | THERMOPLASTIC PAVEMENT MARKING LINE 4" | | FOOT | 1131 | 2636 | 3767 | |
| 78000500 | THERMOPLASTIC PAVEMENT MARKING LINE 8" | | FOOT | 1495 | 1646 | 3141 | |
| 78000600 | THERMOPLASTIC PAVEMENT MARKING LINE 12" | | FOOT | 275 | 476 | 751 | |
| 78000650 | THERMOPLASTIC PAVEMENT MARKING LINE 24" | | FOOT | 218 | 222 | 440 | |
| 78300100 | PAVEMENT MARKING REMOVAL | | SQ FT | 2207 | 3105 | 5312 | |
| 80300100 | LOCATING UNDERGROUND CABLE | | FOOT | 4689 | 2802 | 7491 | |
| 80500100 | SERVICE INSTALLATION, TYPE A | | EACH | 1 | 1 | 2 | |
| 81028720 | UNDERGROUND CONDUIT, COILABLE NONMETALLIC CONDUIT, 1" DIA. | | FOOT | 80 | 80 | 160 | |
| 81028740 | UNDERGROUND CONDUIT, COILABLE NONMETALLIC CONDUIT, 1 1/2" DIA. | | FOOT | 400 | 400 | 800 | |
| 81400700 | HANDHOLE, PORTLAND CONCRETE CEMENT | | EACH | 2 | 2 | 4 | |
| 84500120 | REMOVAL OF ELECTRIC SERVICE INSTALLATION | | EACH | 1 | 1 | 2 | |
| 85000200 | MAINTENANCE OF EXISTING TRAFFIC SIGNAL INSTALLATION | | EACH | 1 | 1 | 2 | |
| 86200200 | UNINTERRUPTIBLE POWR SUPPLY, STANDARD | | EACH | 0 | 1 | 1 | |
| 87900200 | DRILL EXISTING HANDHOLE | | EACH | 2 | 4 | 6 | |
| 88500100 | INDUCTIVE LOOP DETECTOR | | EACH | 0 | 1 | 1 | |
| 88600100 | DETECTOR LOOP, TYPE I | | FOOT | 96 | 192 | 288 | |
| 89502400 | REMOVE EXISTING FLASHING BEACON INSTALLATION COMPLETE | | EACH | 2 | 2 | 4 | |
| X0325714 | FLASHING BEACON, POST MOUNTED, SOLAR POWERED INSTALLATION | | EACH | 4 | 4 | 8 | |
| X0325469 | MODIFY EXISTING TRAFFIC SIGNAL BACKPLATE | | EACH | 14 | 23 | 37 | |
| X8809005 | LED SIGNAL FACE LENS COVER | | EACH | 0 | 50 | 50 | |

| | | | |
|---------------------------------------|--------------------------------------|------------|-----------|
| FILE NAME = | USER NAME = h11k1 | DESIGNED - | REVISED - |
| \\d2srw2\users\HILLKLV\Projects\us 28 | peo and winn 2011\64H15.dgn | DRAWN - | REVISED - |
| | PLOT SCALE = 42.485' / in. | CHECKED - | REVISED - |
| | PLOT DATE = Wed Mar 14 10:39:26 2012 | DATE - | REVISED - |

**STATE OF ILLINOIS
DEPARTMENT OF TRANSPORTATION**

| | |
|--------------------------|-------------------------------|
| SUMMARY OF QUANTITIES | |
| SCALE: _____ | SHEET NO. ____ OF ____ SHEETS |
| STA. _____ TO STA. _____ | |

| | | | | |
|---------------------------|-----------|-----------|--------------------|-----------|
| F.A.P. RTE. | SECTION | COUNTY | TOTAL SHEETS | SHEET NO. |
| 301 | 17. 40M-3 | WINNEBAGO | 20 | 2 |
| ILLINOIS FED. AID PROJECT | | | CONTRACT NO. 64H15 | |

GENERAL NOTES:

THE CONTRACTOR SHALL BE RESPONSIBLE FOR LOCATING ALL TRAFFIC SIGNAL AND LIGHTING UTILITIES. THE CONTRACTOR MAY CONTACT SCOTT KULLERSTRAND, 815.284.5468, WITH THE DISTRICT 2 DOT FOR A HARD COPY OF THE ELECTRICAL PLANS

THE CONTRACTOR SHALL BE RESPONSIBLE FOR PROTECTING UTILITY PROPERTY DURING CONSTRUCTION OPERATIONS AS OUTLINED IN ARTICLE 107.31 OF THE STANDARD SPECIFICATIONS. A MINIMUM OF 48 HOURS ADVANCE NOTICE IS REQUIRED FOR NON-EMERGENCY LOCATE WORK. THE JULIE NUMBER IS 800-892-0123. THE FOLLOWING LISTED UTILITIES LOCATED WITHIN THE PROJECT LIMITS OR IMMEDIATELY ADJACENT TO THE PROJECT CONSTRUCTION LIMITS ARE MEMBERS OF JULIE:

UTILITIES

| NAME | TYPE | TELEPHONE | JULIE MEMBER |
|--|-----------|--------------|---------------------|
| MR. MICHAEL LENOX COMMONWEALTH EDISON COMPANY 123 ENERGY AVE ROCKFORD, IL 61109 | ELECTRIC | 815-490-2869 | YES 800-892-0123 |
| MR. KALIN HINSHAW FRONTIER 112 W ELM STREET SYCAMORE, IL 60178 | TELEPHONE | 815-895-1515 | YES 800-892-0123 |
| MS. CONSTANCE LANE NICOR GAS CO 1844 FERRY ROAD NAPERVILLE IL 60563-9600 | GAS | 630-983-8676 | YES 800-892-0123 |
| MR. MIKE OWENS COMCAST 4450 KISHWAUKEE ST ROCKFORD, IL 61109 | CATV | 815-395-8977 | YES 800-892-0123 |
| MR. MATT FORGAS MEDIACOM 808 E NORTH STREET ELBURN IL 60119 | CATV | 630-365-0045 | YES 800-892-0123 |

REMOVE TWO (2) SERVICE DROPS AT THE FLASHER LOCATIONS.
REMOVE AND REPLACE SERVICE INSTALLATION FOR THE TRAFFIC SIGNALS
WITH A METERED SERVICE. ADDRESSES FOR THE SERVICES ARE;
US 20 WITH WINNEBAGO - MASTER # 3209080038 SUB # 4700162003
US 20 WITH PEATONICA - MASTER # 5955151019 SUB # 0689055043

CADD DATA WILL BE AVAILABLE TO CONTRACTORS AND CONSULTANTS WORKING ON THE PROJECT. THIS INFORMATION WILL BE PROVIDED UPON REQUEST AS MICROSTATION CADD FILES ONLY. IF DATA IS REQUIRED IN OTHER FORMATS IT WILL BE YOUR RESPONSIBILITY TO MAKE THESE CONVERSIONS. IF ANY DISCREPANCY OR INCONSISTENCY ARISES BETWEEN THE ELECTRONIC DATA AND THE INFORMATION ON THE HARD COPY, THE INFORMATION ON THE HARD COPY SHOULD BE USED. CONTACT THE DISTRICT'S PROJECT ENGINEER TO REQUEST THESE FILES.

| | | | | | | | | | | | |
|--|-------------------------|------------|-----------|---|--|---------------------------|-------------|-----------|-----------------|--------------|--|
| FILE NAME = | USER NAME = h11k1 | DESIGNED - | REVISED - | STATE OF ILLINOIS DEPARTMENT OF TRANSPORTATION | GENERAL NOTES & UTILITIES | F.A.P. RTE. | SECTION | COUNTY | TOTAL SHEETS | SHEET NO. | |
| \\d2srrv2\users\h11k1\Projects\us 20 p | and winn 2011\64HIS.dgn | DRAWN - | REVISED - | | | 301 | (17, 40M-3) | WINNEBAGO | 19 | 3 | |
| PLOT SCALE = 42.405' / in. | | CHECKED - | REVISED - | | | CONTRACT NO. 69815 | | | | | |
| PLOT DATE = Wed Mar 14 10:35:50 2012 | | DATE - | REVISED - | | | ILLINOIS FED. AID PROJECT | | | | | |

NOTE:

1. MODIFY 14 EXISTING MAST ARM MOUNTED BACKPLATES
2. INSTALL FAR ADVANCE DETECTION
3. REMOVE FLASHING BEACONS AND CONTROLLERS AND REPLACE WITH SOLAR POWER FLASHING BEACONS ON EXISTING SIGN POSTS
4. REMOVE SERVICE AND REPLACE WITH A METERED SERVICE AT CONTROLLER
5. INSTALL DETECTOR WIRE IN EXISTING CONDUIT

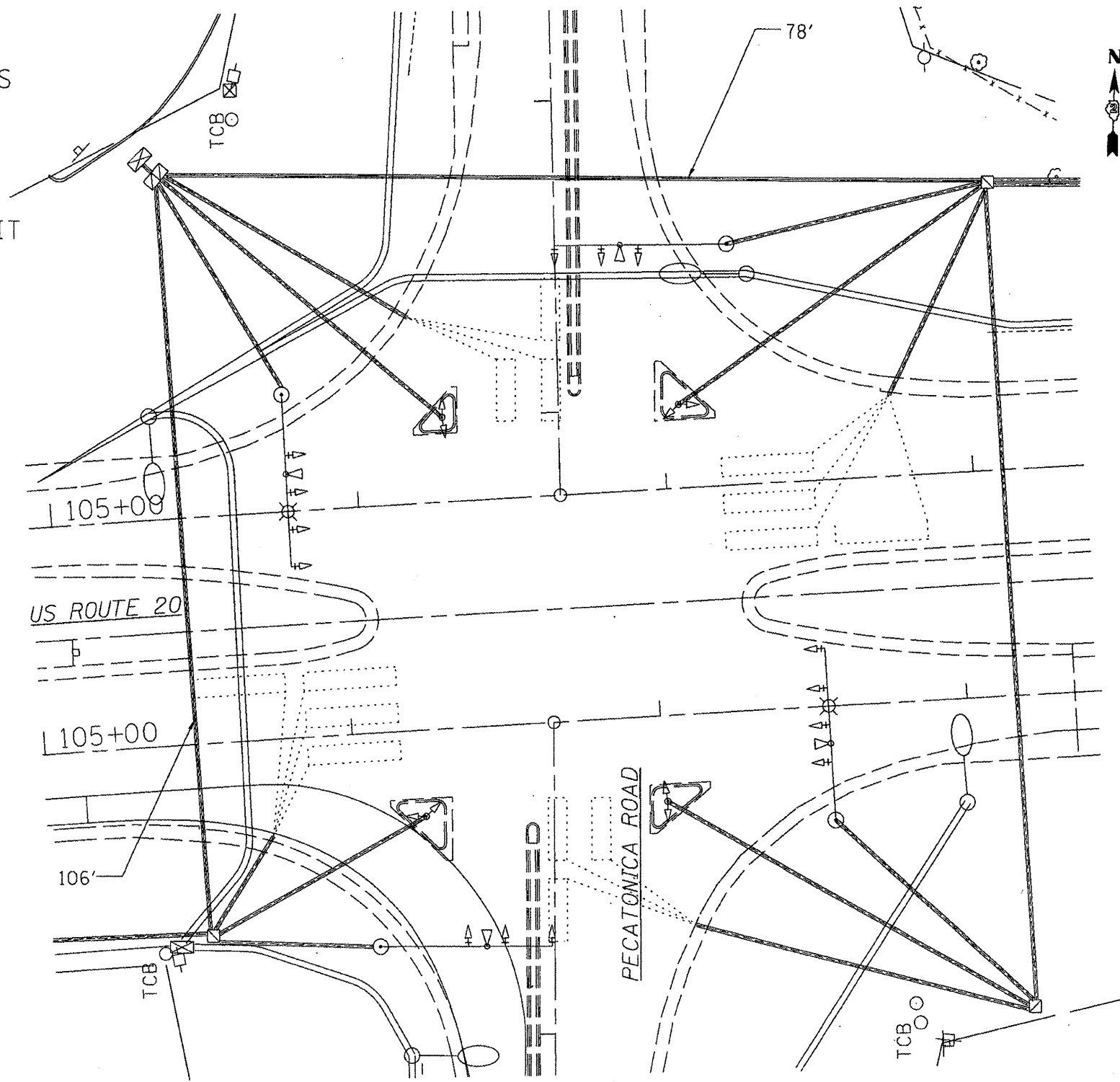

| | | | |
|--------------------------------------|--------------------------------------|------------|-----------|
| FILE NAME = | USER NAME = h11k1 | DESIGNED - | REVISED - |
| \\d2s3rv2\users\HILLK\Projects\us 20 | plc and winn 2011\64115.dgn | DRAWN - | REVISED - |
| | PLOT SCALE = 42.485' / in. | CHECKED - | REVISED - |
| | PLOT DATE = Wed Mar 14 10:36:01 2012 | DATE - | REVISED - |

**STATE OF ILLINOIS
DEPARTMENT OF TRANSPORTATION**

**US 20 AT PECATONICA RD
PLAN SHEET**

SCALE: _____ SHEET NO. ____ OF ____ SHEETS STA. _____ TO STA. _____

| | | | | |
|--------------------|-------------|-----------|---------------------------|-----------|
| F.A.P. RTE. | SECTION | COUNTY | TOTAL SHEETS | SHEET NO. |
| 301 | (17, 40M-3) | WINNEBAGO | 19 | 4 |
| CONTRACT NO. 64B15 | | | ILLINOIS FED. AID PROJECT | |

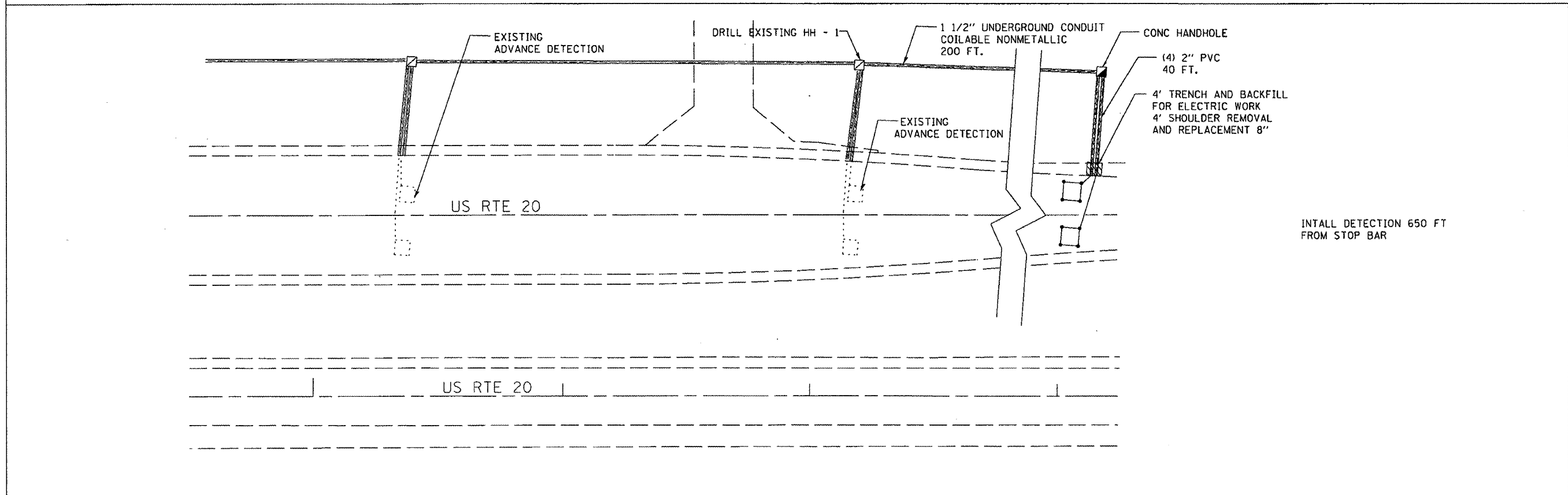
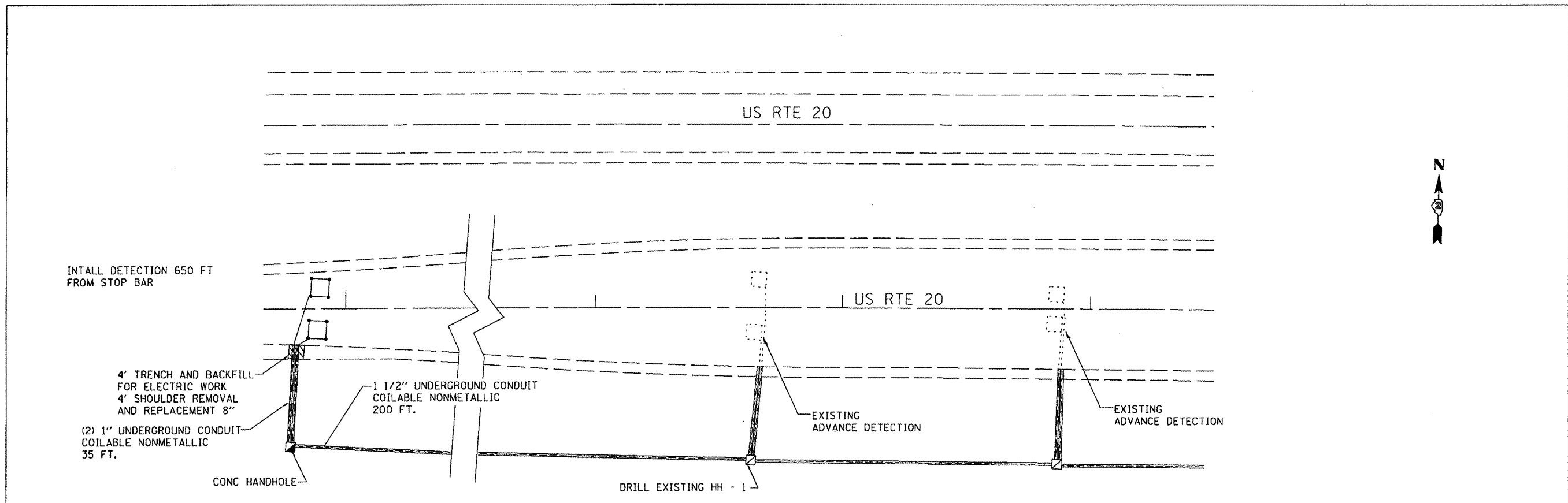

| | | | |
|--------------------------------------|------------------------|------------|-----------|
| FILE NAME = | USER NAME = h11k1 | DESIGNED - | REVISED - |
| \\d2serv2\users\HILLK\Projects\us 20 | and win 2011\64H15.dgn | DRAWN - | REVISED - |
| PLOT SCALE = 42.405' / in. | CHECKED - | REVISED - | REVISED - |
| PLOT DATE = Wed Mar 14 10:36:11 2012 | DATE - | REVISED - | REVISED - |

**STATE OF ILLINOIS
DEPARTMENT OF TRANSPORTATION**

**US 20 AT PECATONICA RD
PLAN SHEET**

SCALE: _____ SHEET NO. _____ OF _____ SHEETS STA. _____ TO STA. _____

| | | | | |
|--------------------|-------------|--------|---------------------------|-----------|
| F.A.P. RTE. | SECTION | COUNTY | TOTAL SHEETS | SHEET NO. |
| 301 | (17, 40M-3) | | 19 | 5 |
| CONTRACT NO. 64H15 | | | ILLINOIS FED. AID PROJECT | |

CABLE PLAN

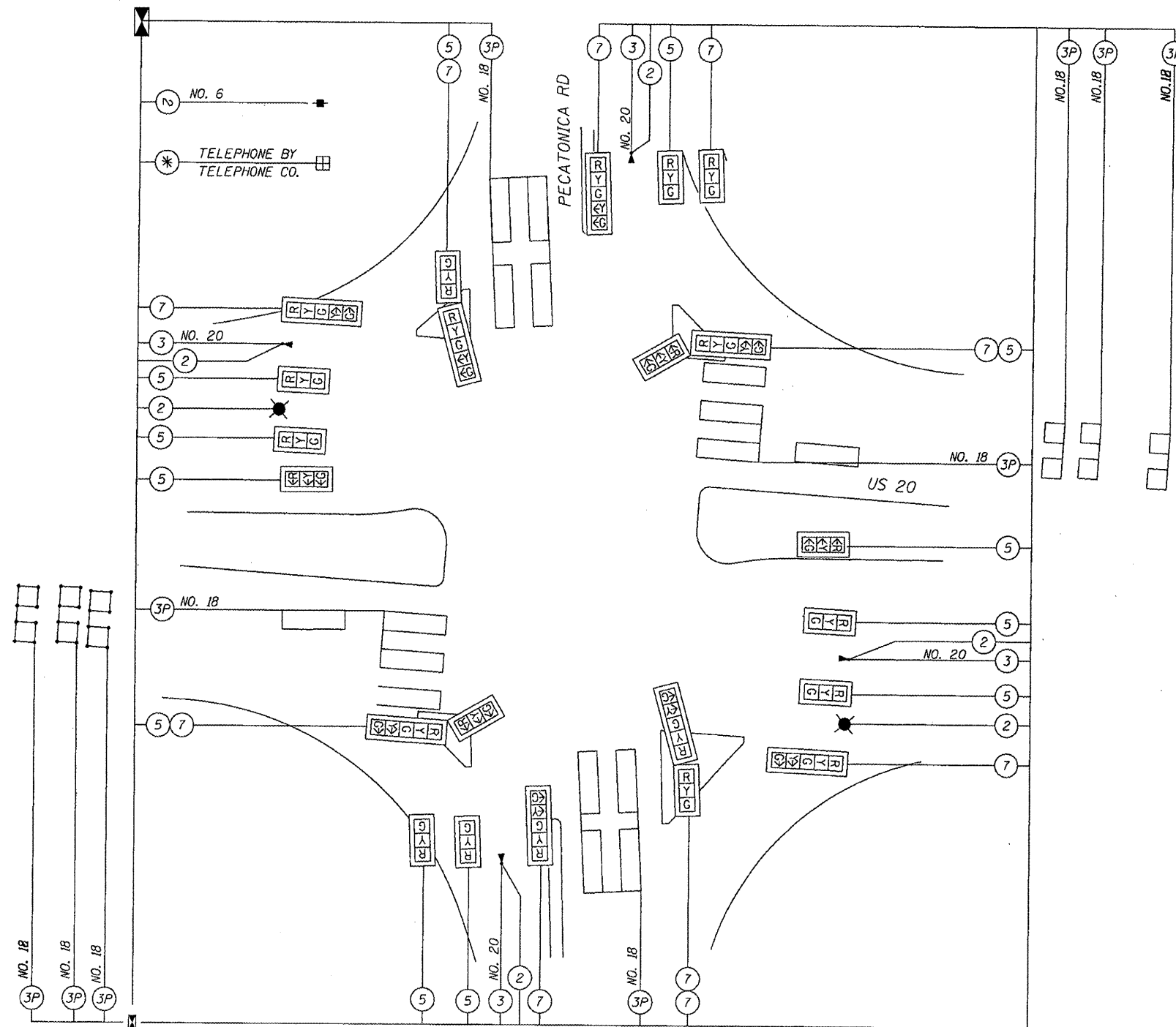

PHASE DESIGNATION DIAGRAM

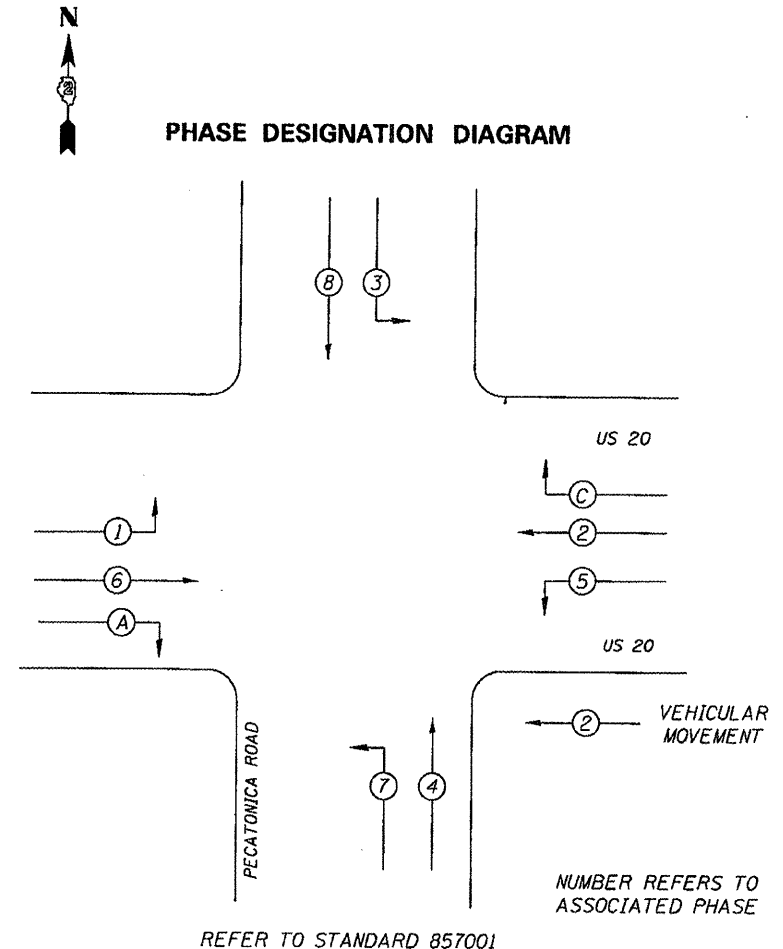

REFER TO STANDARD 857001

- NOTE
1. PHASES 1 & 5 ARE PROTECTED PHASES ONLY
 2. THERE ARE FOUR(4) SEPERATE EMERGENCY PREEMPTS.

LEGEND

- INDICATES NUMBER OF NEW CONDUCTORS. ALL CABLE IS NO. 14 EXCEPT AS INDICATED. "P" INDICATES PAIR CABLE
- NEW SIGNAL HEAD WITH OR WITHOUT BACKPLATE
- OPTICAL DETECTOR WITH CONFIRMATION BEACON
- STROBE LIGHT - WHITE

| | | | |
|---------------------------------------|--------------------------------------|------------|-----------|
| FILE NAME = | USER NAME = hllkl | DESIGNED - | REVISED - |
| \\d2serv2\users\HILLKL\Projects\us 20 | and winn 2011\64105.dgn | DRAWN - | REVISED - |
| | PLOT SCALE = 42.405' / in. | CHECKED - | REVISED - |
| | PLOT DATE = Wed Mar 14 10:36:21 2012 | DATE - | REVISED - |

STATE OF ILLINOIS
DEPARTMENT OF TRANSPORTATION

US 20 AT WINNEBAGO RD CABLE
DETAIL PLAN SHEET

SCALE: _____ SHEET NO. ____ OF ____ SHEETS STA. _____ TO STA. _____

| | | | | |
|--------------------|------------|-----------|---------------------------|-----------|
| F.A.R. R.T.E. | SECTION | COUNTY | TOTAL SHEETS | SHEET NO. |
| 301 | (7, 40M-3) | WINNEBAGO | 19 | 6 |
| CONTRACT NO. 69815 | | | ILLINOIS FED. AID PROJECT | |

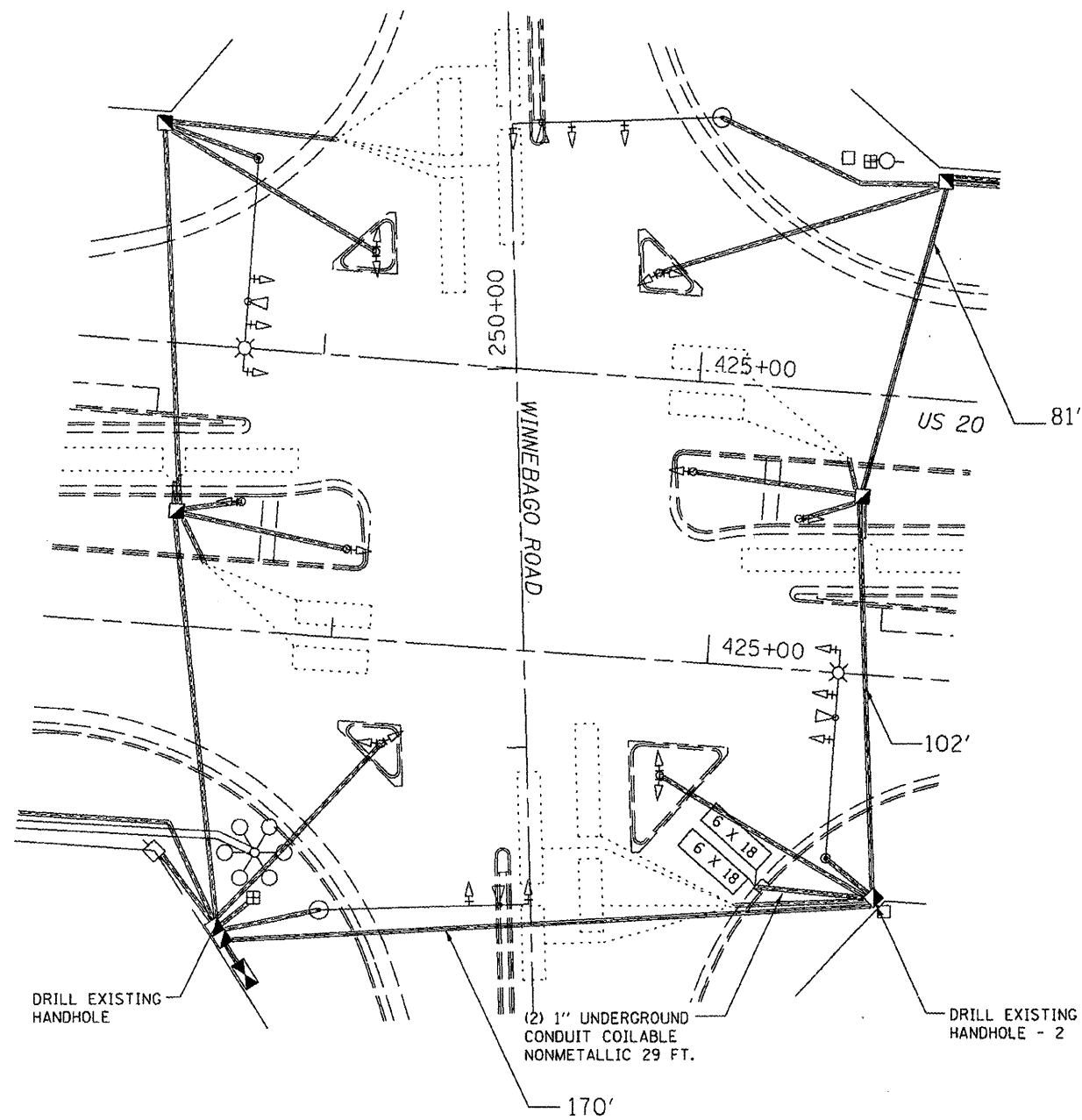

| | | | |
|--------------------------------------|--------------------------------------|------------|-----------|
| FILE NAME = | USER NAME = h11k1 | DESIGNED - | REVISED - |
| \\d2srv2\users\HILLK1\Projects\us 20 | pic and winn 2011\64H15.dgn | DRAWN - | REVISED - |
| | PLOT SCALE = 42.485' / 1" IN. | CHECKED - | REVISED - |
| | PLOT DATE = Wed Mar 14 10:36:41 2012 | DATE - | REVISED - |

**STATE OF ILLINOIS
DEPARTMENT OF TRANSPORTATION**

**US 20 AT WINNEBAGO RD
PLAN SHEET**

SCALE: _____ SHEET NO. _____ OF _____ SHEETS STA. _____ TO STA. _____

| | | | | |
|---------------------------|------------|-----------|--------------|-----------|
| F.A.P. RTE. | SECTION | COUNTY | TOTAL SHEETS | SHEET NO. |
| 301 | 117, 40M-3 | WINNEBAGO | 19 | 7 |
| CONTRACT NO. 64B15 | | | | |
| ILLINOIS FED. AID PROJECT | | | | |

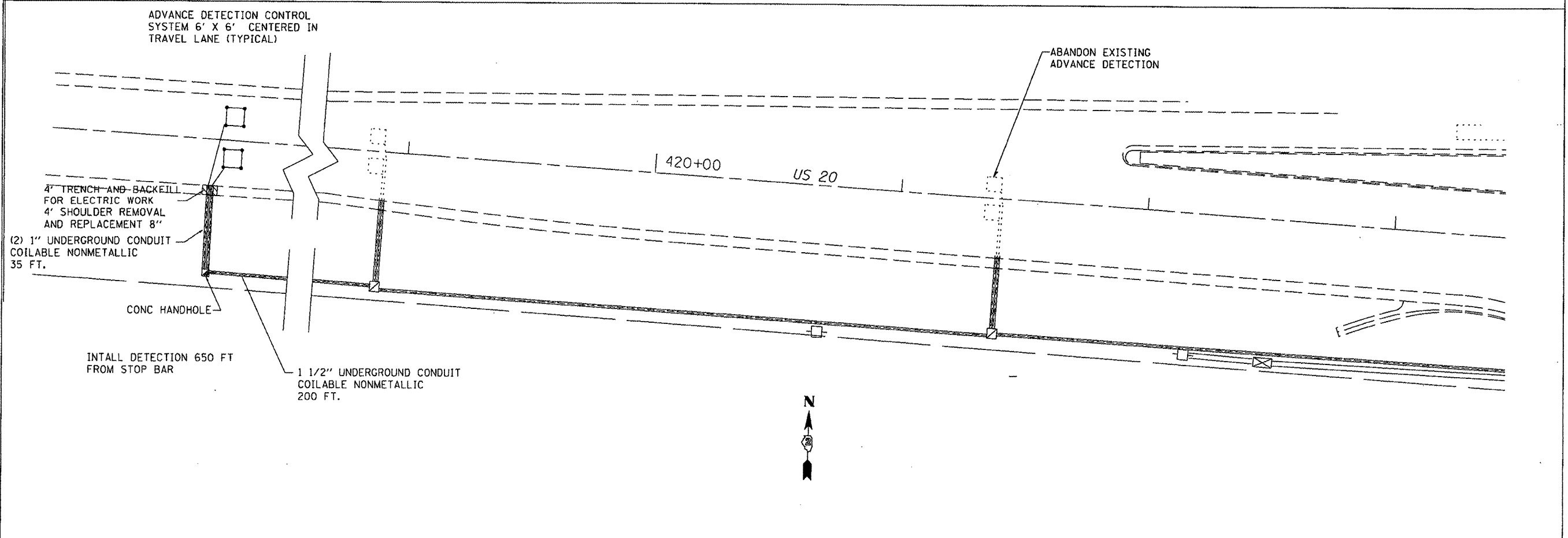
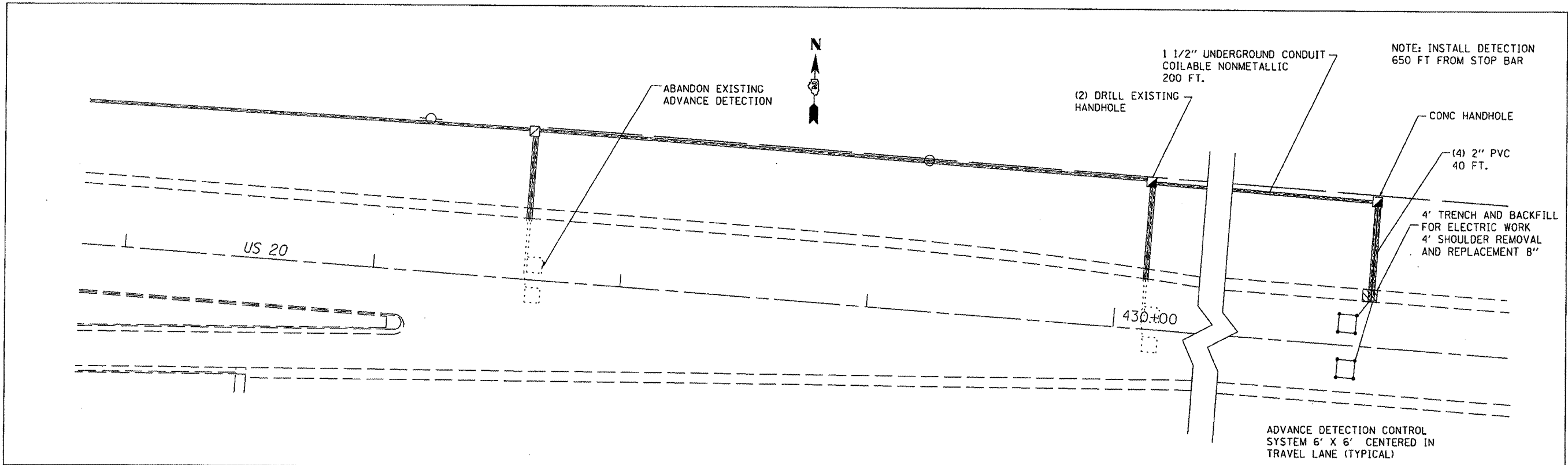

| | | | |
|--------------------------------------|--------------------------------------|------------------------|-----------------------|
| FILE NAME = | USER NAME = h11k1 | DESIGNED - Designed By | REVISED - Revised By1 |
| \\d2serv2\users\HILLK\Projects\us 20 | and vinn 2011\64115.dgn | DRAWN - Drawn By | REVISED - Revised By2 |
| | PLOT SCALE = 42.405' / in. | CHECKED - Checked By | REVISED - Revised By3 |
| | PLOT DATE = Wed Mar 14 10:36:52 2012 | DATE - Checked Date | REVISED - Revised By4 |

**STATE OF ILLINOIS
DEPARTMENT OF TRANSPORTATION**

**US 20 AT WINNEBAGO RD CABLE
DETAIL PLAN SHEET**

| | | | | |
|--------------------|-------------|-----------|---------------------------|-----------|
| F.A.P. RTE. | SECTION | COUNTY | TOTAL SHEETS | SHEET NO. |
| 301 | (17, 40M-3) | WINNEBAGO | 19 | 8 |
| CONTRACT NO. 64015 | | | ILLINOIS FED. AID PROJECT | |

SCALE: _____

CABLE PLAN

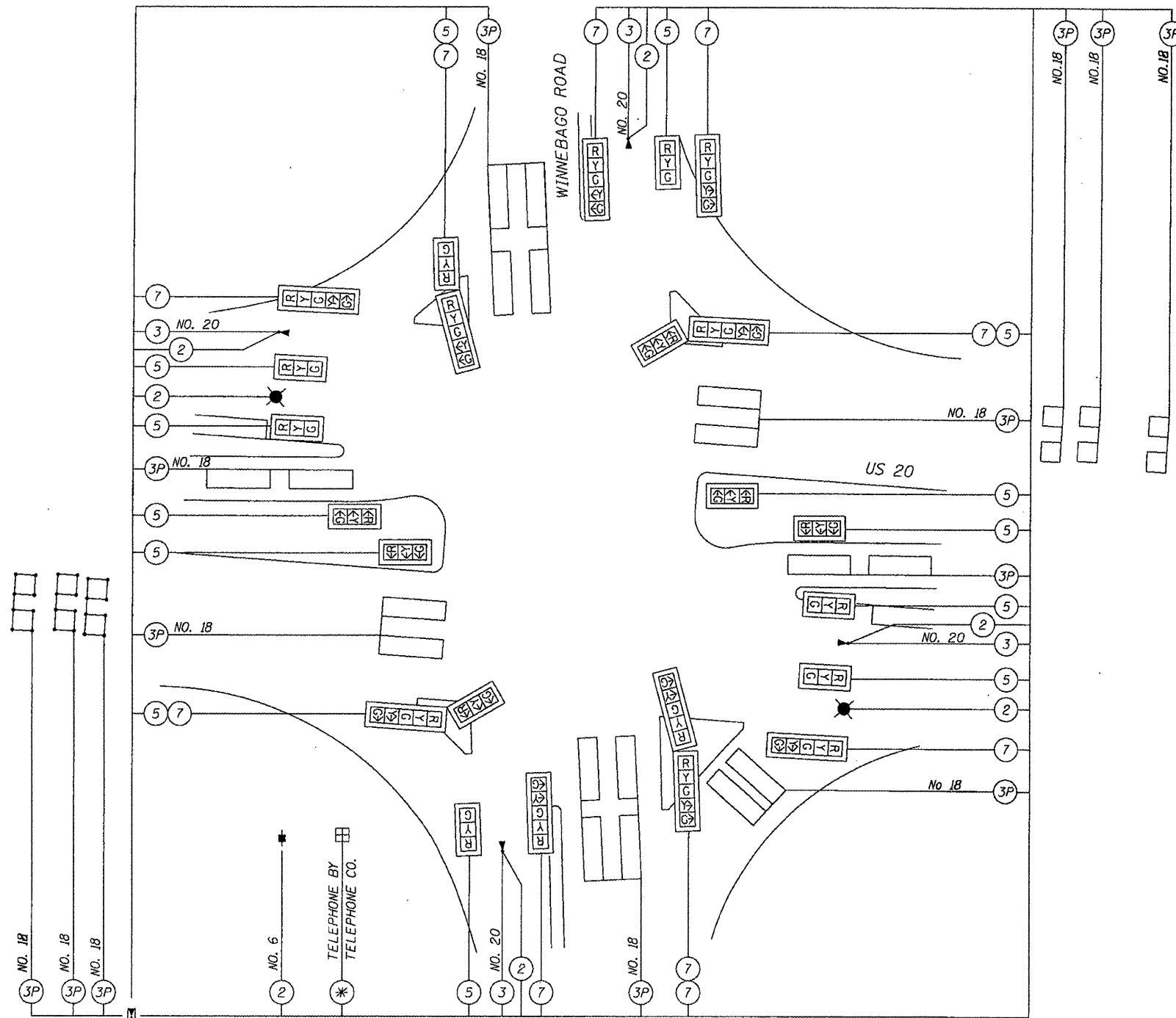

PHASE DESIGNATION DIAGRAM

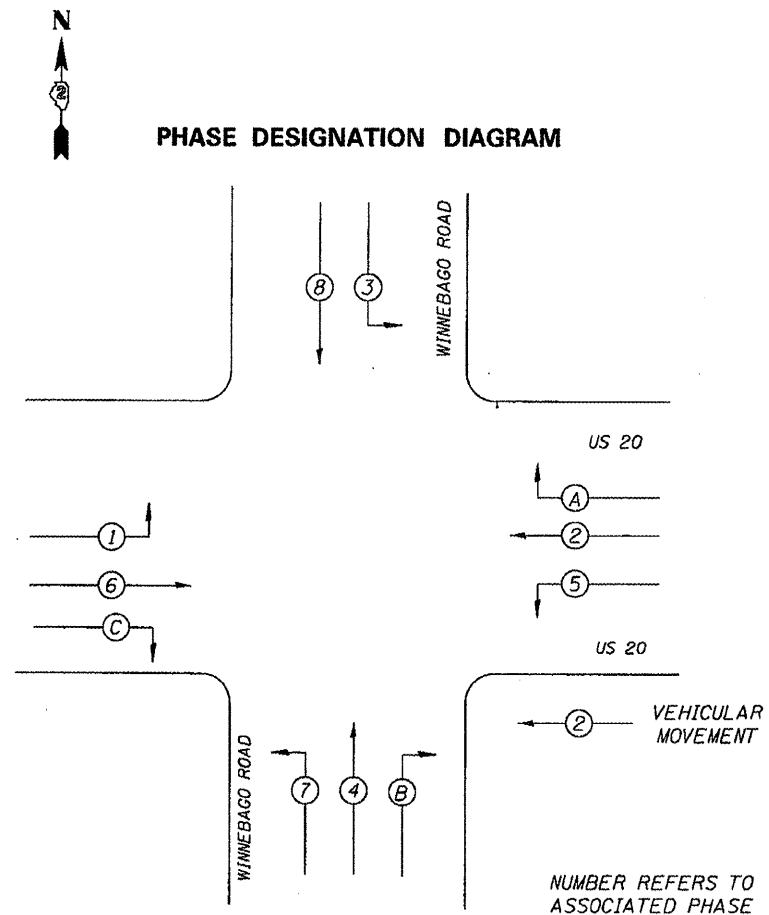

REFER TO STANDARD 857001

NOTE

1. PHASES 1 & 5 ARE PROTECTED PHASES ONLY
2. THERE WILL BE FOUR(4) SEPERATE EMERGENCY PREEMPTS.

LEGEND

- INDICATES NUMBER OF NEW CONDUCTORS. ALL CABLE IS NO. 14 EXCEPT AS INDICATED. "P" INDICATES PAIR CABLE
- NEW SIGNAL HEAD WITH OR WITHOUT BACKPLATE
- OPTICAL DETECTOR WITH CONFIRMATION BEACON
- STROBE LIGHT - WHITE

| | | | |
|--------------------------------------|--------------------------------------|------------|-----------|
| FILE NAME = | USER NAME = n11k1 | DESIGNED - | REVISED - |
| \\d2sarv2\users\WILLK\Projects\us 20 | and win 2811\64H15.dgn | DRAWN - | REVISED - |
| | PLOT SCALE = 42.485' / in. | CHECKED - | REVISED - |
| | PLOT DATE = Wed Mar 14 10:37:06 2012 | DATE - | REVISED - |

STATE OF ILLINOIS
DEPARTMENT OF TRANSPORTATION

US 20 AT PECATONICA RD CABLE
DETAIL PLAN SHEET

| | | | | |
|--|-------------|-----------|---------------------------------|-----------|
| F.A.R. RTE. | SECTION | COUNTY | TOTAL SHEETS | SHEET NO. |
| 301 | (17, 40)M-3 | WINNEBAGO | 19 | 9 |
| SCALE: _____ | | | SHEET NO. _____ OF _____ SHEETS | |
| | | | STA. _____ TO STA. _____ | |
| ILLINOIS FED. AID PROJECT CONTRACT NO. 64H15 | | | | |

THERMOPLASTIC PAVEMENT MARKING DETAILS

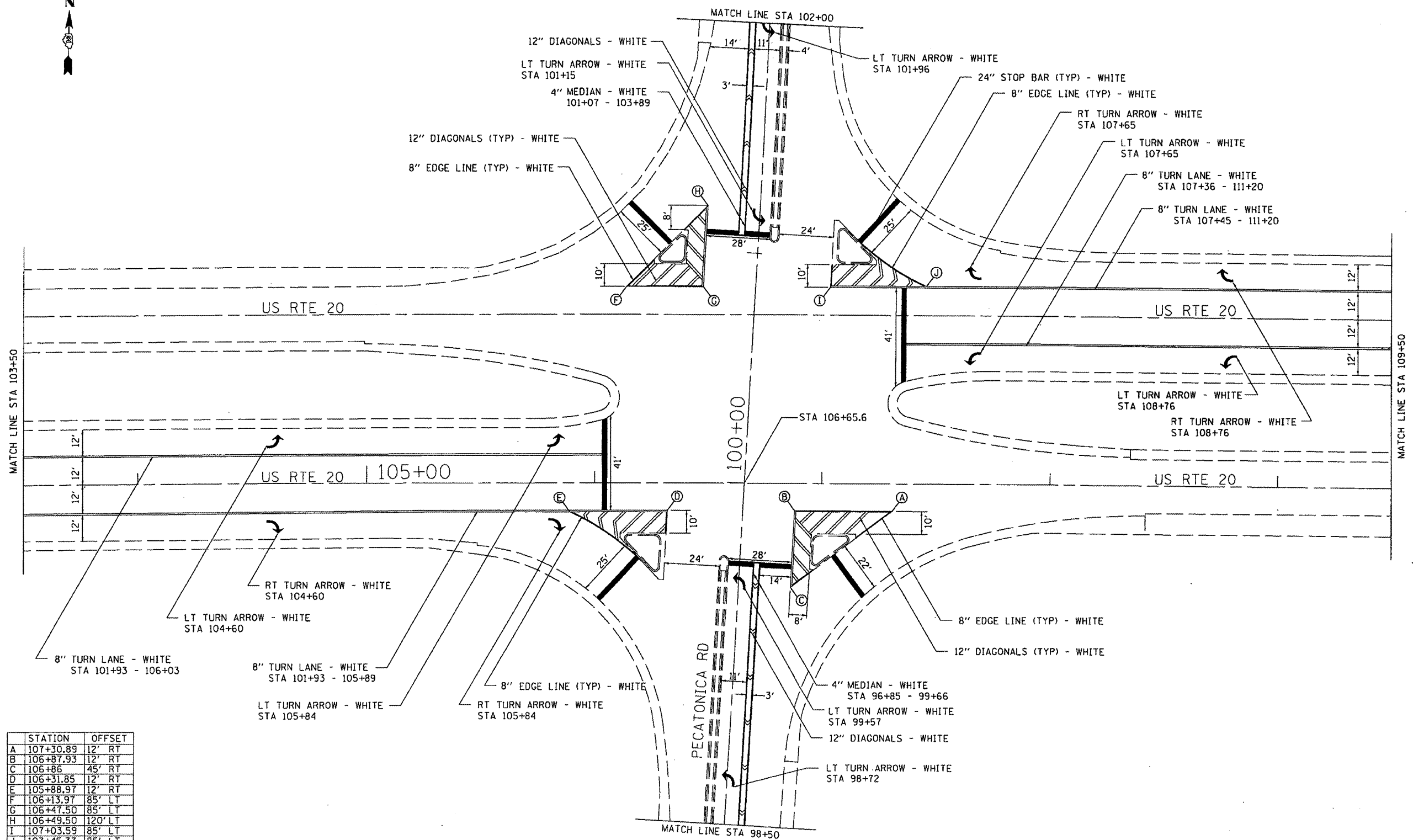

| STATION | OFFSET |
|-------------|---------|
| A 107+30.89 | 12' RT |
| B 106+87.93 | 12' RT |
| C 106+86 | 45' RT |
| D 106+31.85 | 12' RT |
| E 105+88.97 | 12' RT |
| F 106+13.97 | 85' LT |
| G 106+47.50 | 85' LT |
| H 106+49.50 | 120' LT |
| I 107+03.59 | 85' LT |
| J 107+45.37 | 85' LT |

| | | | |
|--|-------------------|------------|-----------|
| FILE NAME = \\d2serv2\users\HILLK\Projects\us 20 | USER NAME = h11k1 | DESIGNED - | REVISED - |
| and winn 2011\64MIS.dgn | | DRAWN - | REVISED - |
| PLOT SCALE = 43.998' / 1" | | CHECKED - | REVISED - |
| PLOT DATE = Tue Mar 13 14:51:24 2012 | | DATE - | REVISED - |

**STATE OF ILLINOIS
DEPARTMENT OF TRANSPORTATION**

**US 20 AT PECATONICA RD
PAVEMENT MARKING DETAILS**

SCALE: _____ SHEET NO. _____ OF _____ SHEETS STA. _____ TO STA. _____

| | | | | |
|---------------------------|-----------------------|--------------------|--------------------|----------------|
| F.A.R. RTE. - 301 | SECTION - (17, 40M-3) | COUNTY - WINNEBAGO | TOTAL SHEETS - 19 | SHEET NO. - 10 |
| ILLINOIS FED. AID PROJECT | | | CONTRACT NO. 69015 | |

THERMOPLASTIC PAVEMENT MARKING DETAILS

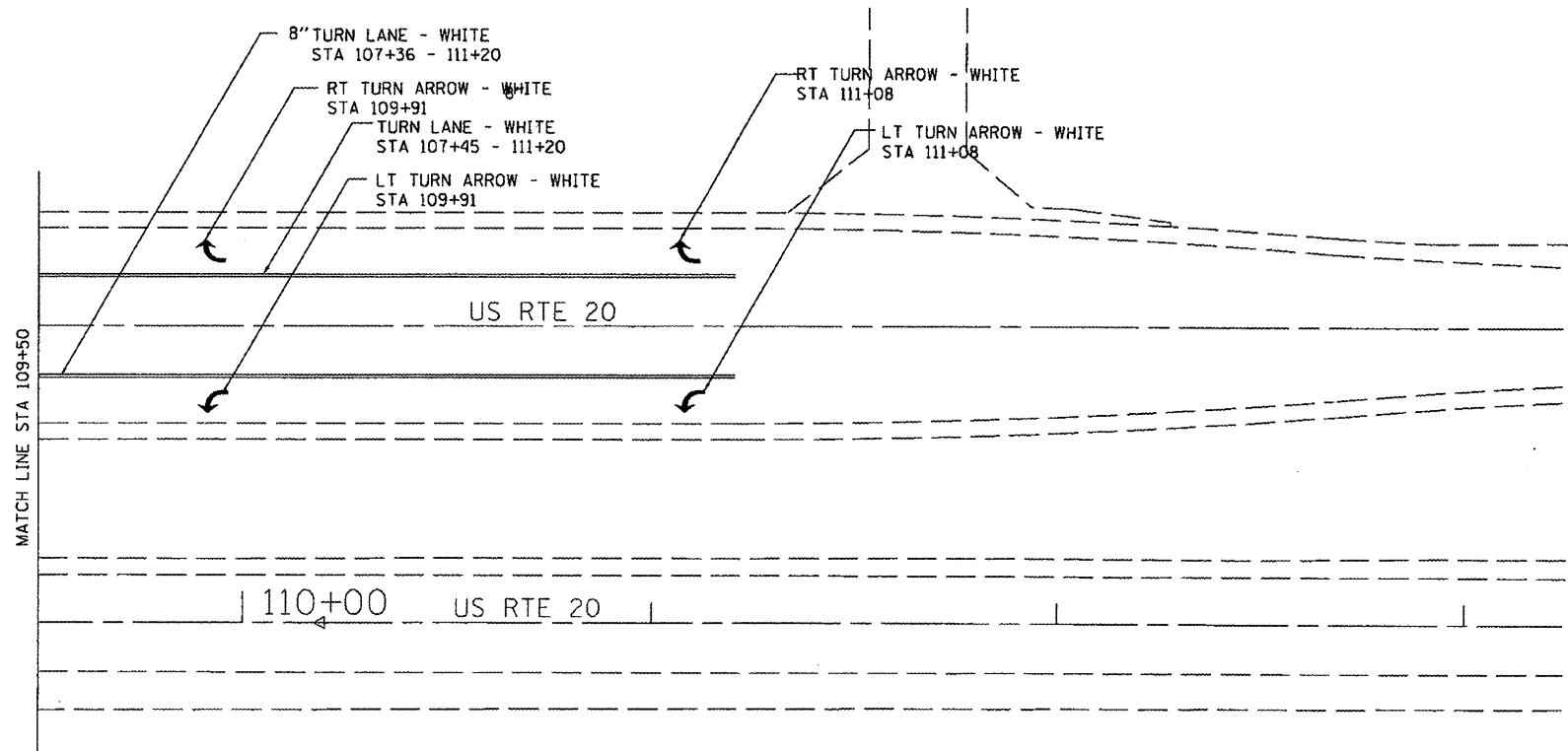
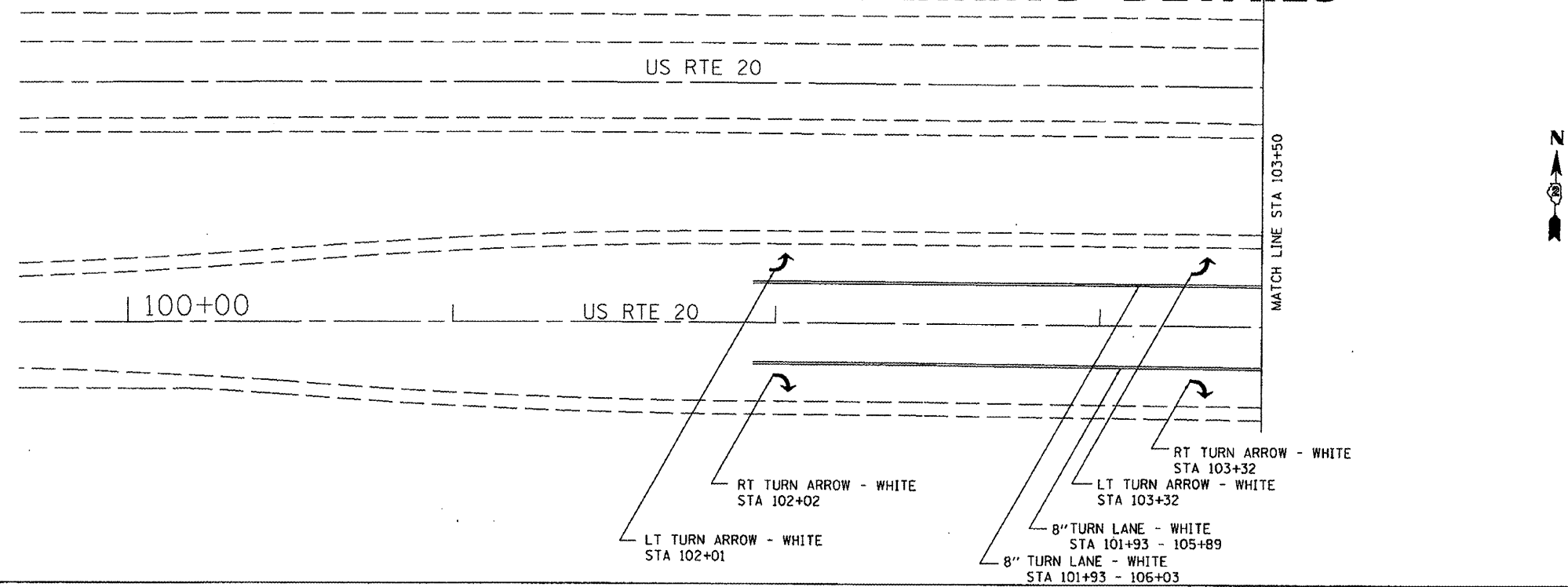

| | | | |
|--------------------------------------|--------------------------------------|------------|-----------|
| FILE NAME = | USER NAME = h11k1 | DESIGNED - | REVISED - |
| \\d2surv2\users\HILLK\Projects\us 20 | pc and winn 2011\64HIS.dgn | DRAWN - | REVISED - |
| | PLOT SCALE = 43.998' / in. | CHECKED - | REVISED - |
| | PLOT DATE = Tue Mar 13 14:51:34 2012 | DATE - | REVISED - |

**STATE OF ILLINOIS
DEPARTMENT OF TRANSPORTATION**

**US 20 AT WINNEBAGO RD
PAVEMENT MARKING DETAILS**

SCALE: _____ SHEET NO. _____ OF _____ SHEETS STA. _____ TO STA. _____

| | | | | |
|--------------------|-----------|-----------|---------------------------|-----------|
| F.A.P. RTE. | SECTION | COUNTY | TOTAL SHEETS | SHEET NO. |
| 301 | 07, 40M-3 | WINNEBAGO | 19 | 11 |
| CONTRACT NO. 64015 | | | ILLINOIS FED. AID PROJECT | |

THERMOPLASTIC PAVEMENT MARKING DETAILS

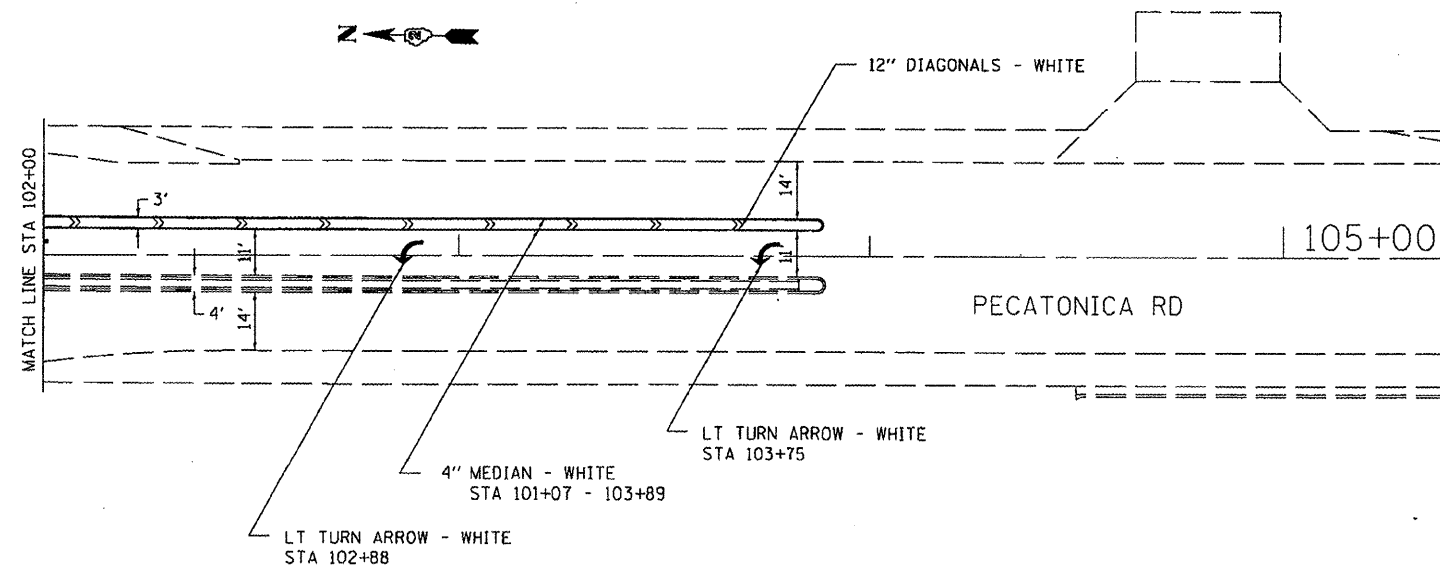
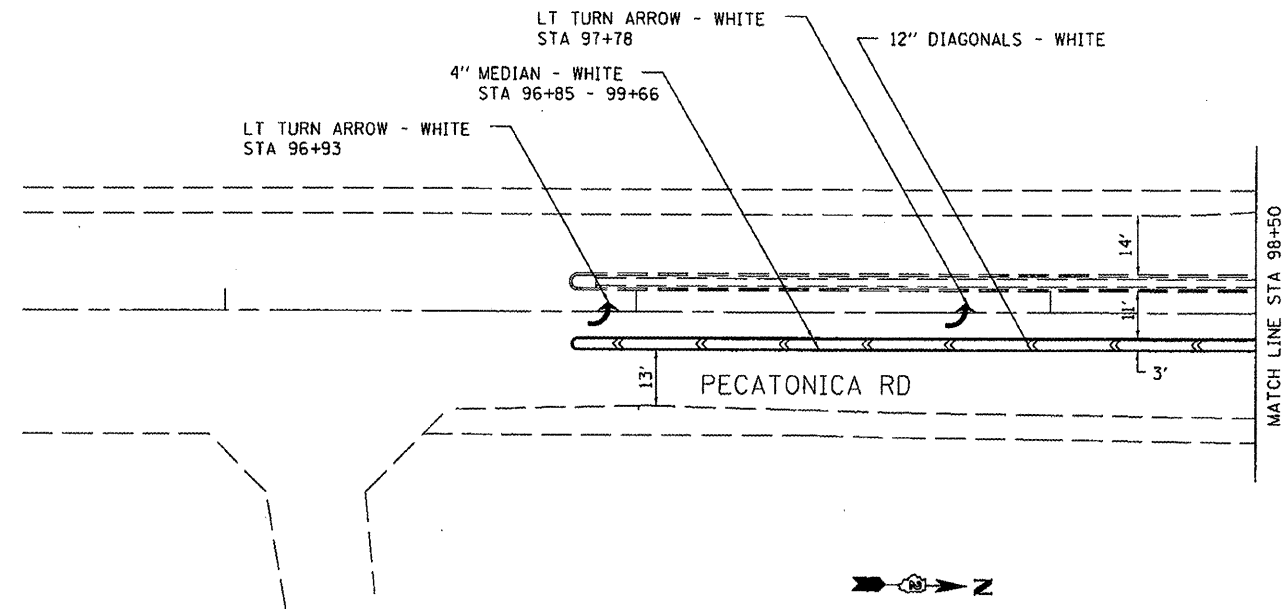

| | | | | | | | | | | |
|--------------------------------------|-------------------------|------------|-----------|---|---|---------------------------------|-----------|--------------------------|--------------|-----------|
| FILE NAME = | USER NAME = niki | DESIGNED = | REVISED = | STATE OF ILLINOIS DEPARTMENT OF TRANSPORTATION | US 20 AT WINNEBAGO RD PAVEMENT MARKING DETAILS | F.A.D. RTE. | SECTION | COUNTY | TOTAL SHEETS | SHEET NO. |
| \\d2srv2\user\HILLKLP\Projects\us 20 | and winn 2011\64HIS.dgn | DRAWN = | REVISED = | | | 301 | 07, 40M-3 | WINNEBAGO | 19 | 12 |
| PLOT SCALE = 43.998' / in. | CHECKED = | REVISED = | REVISED = | | | CONTRACT NO. 69015 | | | | |
| PLOT DATE = Tue Mar 13 14:51:42 2012 | DATE = | REVISED = | REVISED = | | | ILLINOIS FED. AID PROJECT | | | | |
| | | | | | SCALE: _____ | SHEET NO. _____ OF _____ SHEETS | | STA. _____ TO STA. _____ | | |

THERMOPLASTIC PAVEMENT MARKING DETAILS

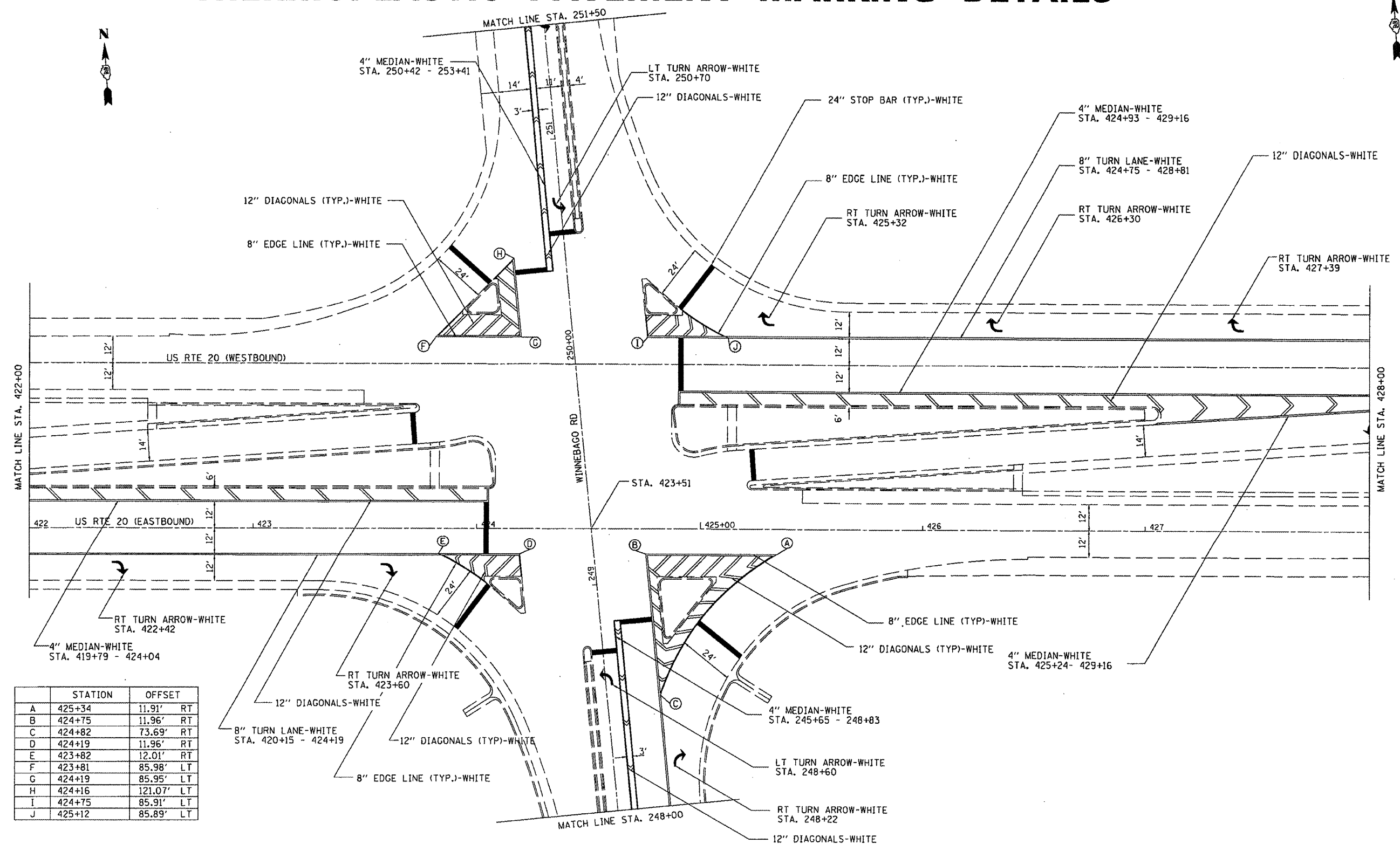

| | STATION | OFFSET |
|---|---------|------------|
| A | 425+34 | 11.91' RT |
| B | 424+75 | 11.96' RT |
| C | 424+82 | 73.69' RT |
| D | 424+19 | 11.96' RT |
| E | 423+82 | 12.01' RT |
| F | 423+81 | 85.98' LT |
| G | 424+19 | 85.95' LT |
| H | 424+16 | 121.07' LT |
| I | 424+75 | 85.91' LT |
| J | 425+12 | 85.89' LT |

FILE NAME = \\d2sr-v2\users\HILLK\Projects\us 20 at winn 2011\64H15.dgn
 USER NAME = h11k1
 PLOT SCALE = 43.998' / in.
 PLOT DATE = Tue Mar 13 14:51:53 2012

DESIGNED -
 DRAWN -
 CHECKED -
 DATE -

REVISED -
 REVISED -
 REVISED -
 REVISED -

STATE OF ILLINOIS
 DEPARTMENT OF TRANSPORTATION

US 20 AT WINNEBAGO RD
 PAVEMENT MARKING DETAILS
 SCALE: SHEET NO. OF SHEETS STA. TO STA.

| | | | | |
|---------------------------|-----------|-----------|--------------|-----------|
| F.A.P. RTE. | SECTION | COUNTY | TOTAL SHEETS | SHEET NO. |
| 301 | 07, 40M-3 | WINNEBAGO | 19 | 13 |
| CONTRACT NO. 64H15 | | | | |
| ILLINOIS FED. AID PROJECT | | | | |

THERMOPLASTIC PAVEMENT MARKING DETAILS

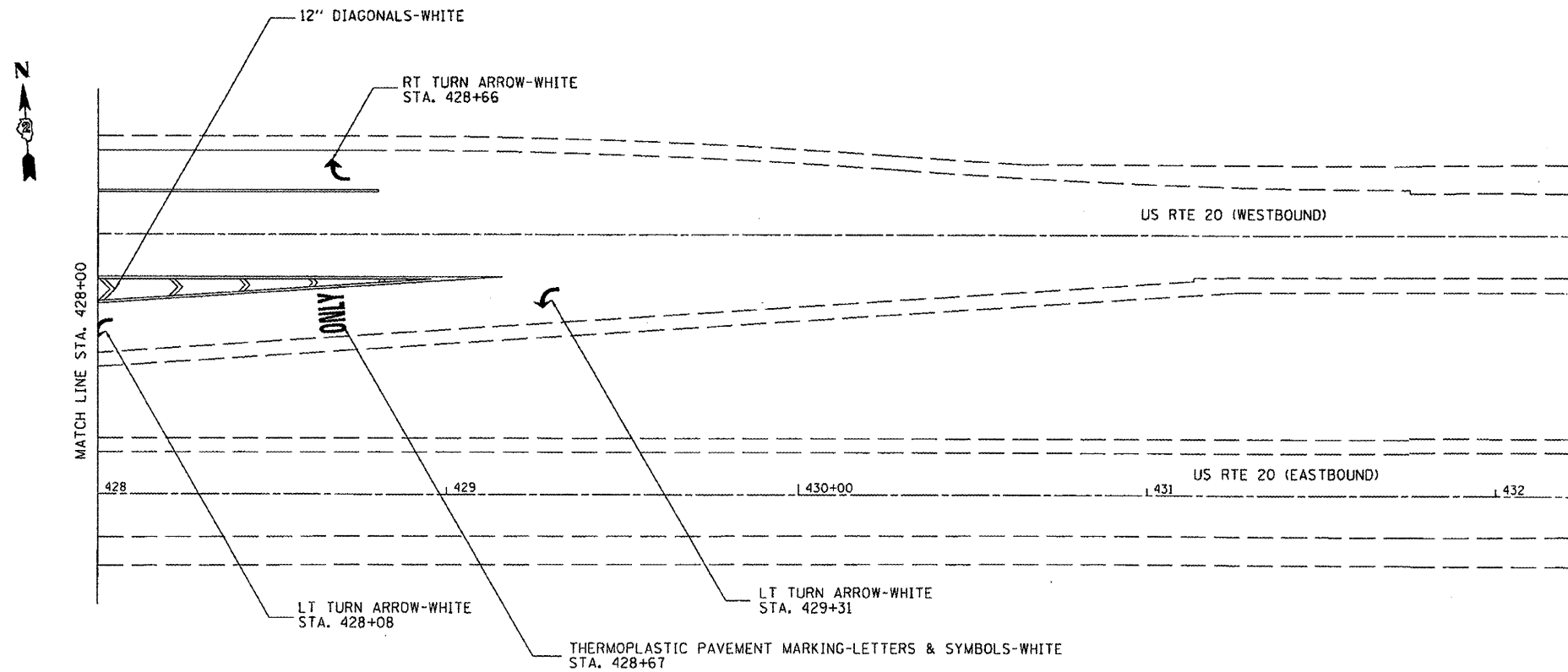
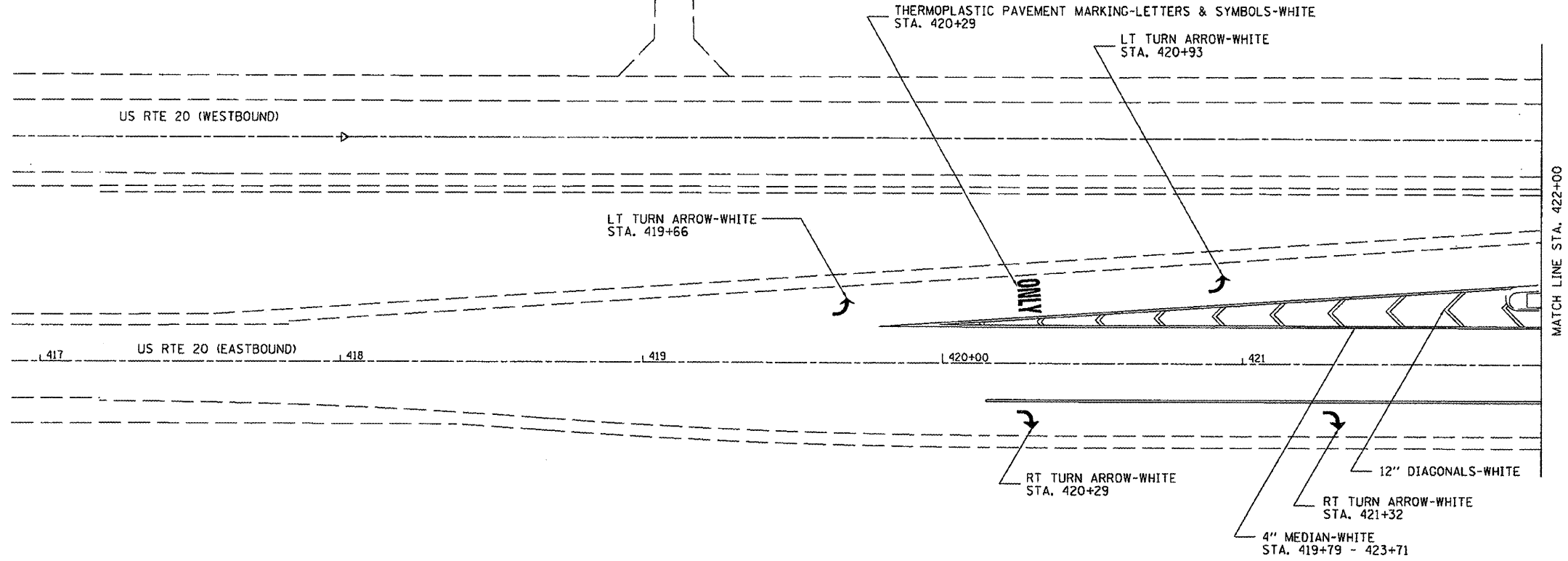

| | | | |
|------------------------------------|--------------------------------------|------------|-----------|
| FILE NAME = | USER NAME = h11k1 | DESIGNED - | REVISED - |
| \\d2s-r2\user\h11k1\Projects\us 20 | and winn 2811\64H15.dgn | DRAWN - | REVISED - |
| | PLOT SCALE = 43.998' / in. | CHECKED - | REVISED - |
| | PLOT DATE = Tue Mar 13 14:52:04 2012 | DATE - | REVISED - |

**STATE OF ILLINOIS
DEPARTMENT OF TRANSPORTATION**

**US 20 AT WINNEBAGO RD
PAVEMENT MARKING DETAILS**

SCALE: _____ SHEET NO. _____ OF _____ SHEETS STA. _____ TO STA. _____

| | | | |
|---------------------------|-------------|-----------|--------------------|
| F.A.P. RTE. | SECTION | COUNTY | TOTAL SHEET NO. |
| 301 | (17, 40M-3) | WINNEBAGO | 19 13 |
| | | | CONTRACT NO. 64H15 |
| ILLINOIS FED. AID PROJECT | | | |

THERMOPLASTIC PAVEMENT MARKING DETAILS

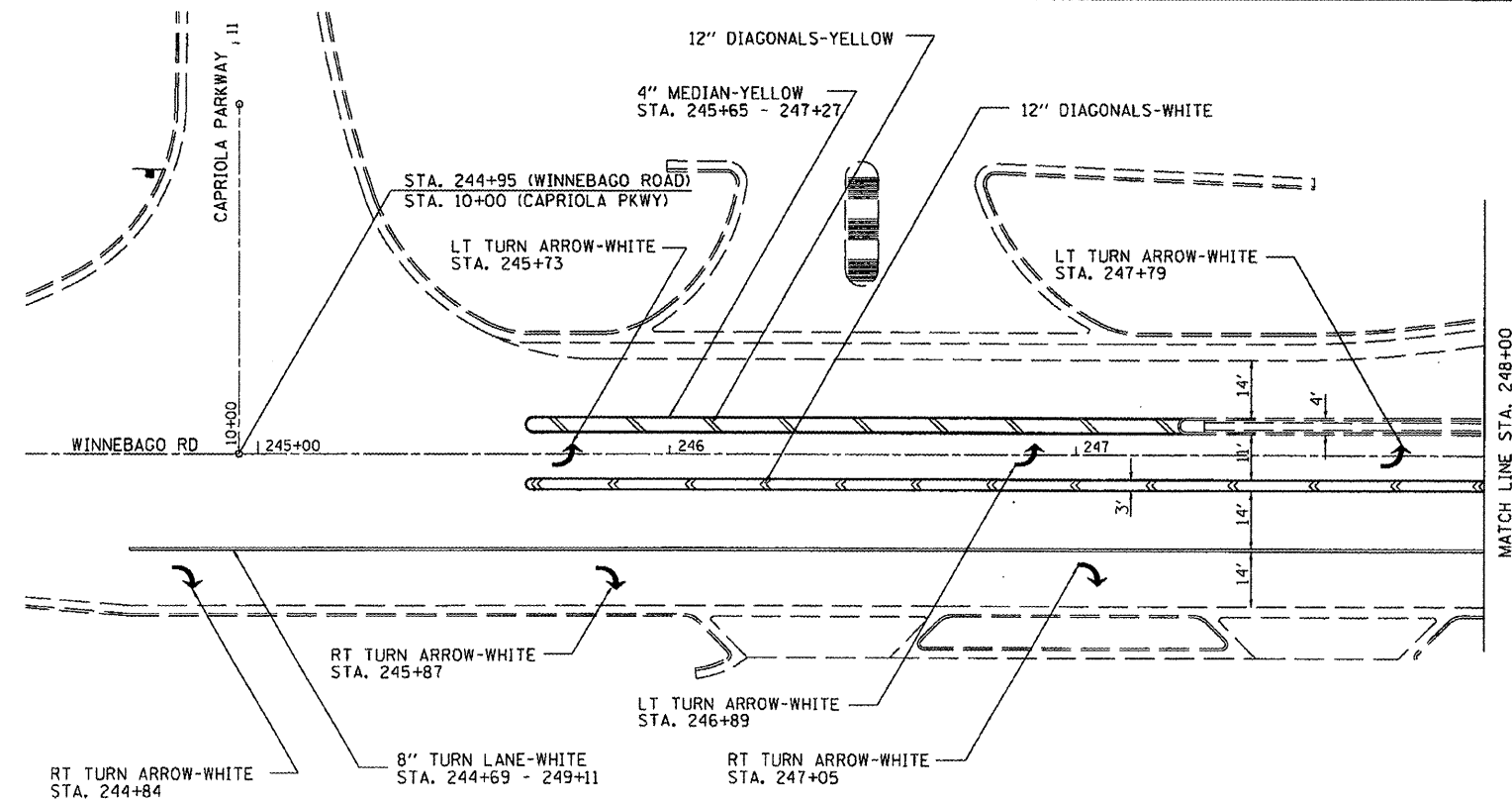
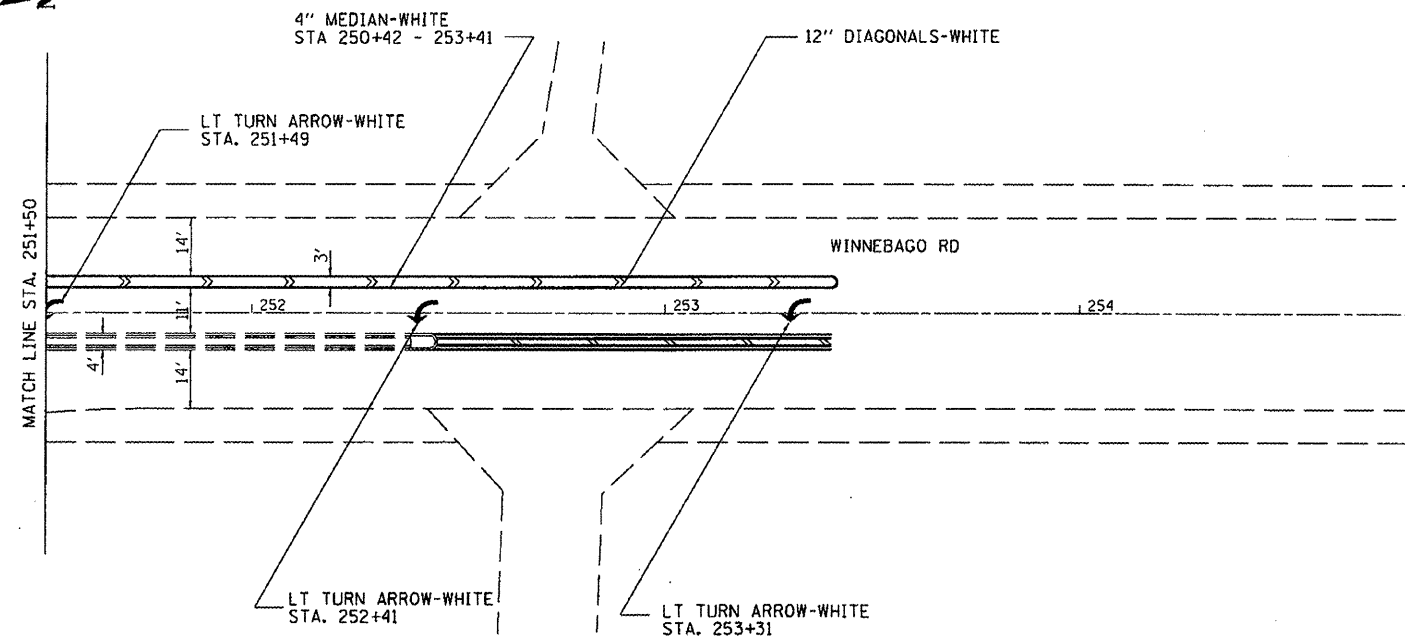

| | | | |
|---|-------------------|------------|-----------|
| FILE NAME : \\d2s1r-2\users\HILLKLV\Projects\2008\2008-03-13\2008-03-13.dgn | USER NAME : hllk1 | DESIGNED - | REVISED - |
| | | DRAWN - | REVISED - |
| | | CHECKED - | REVISED - |
| | | DATE - | REVISED - |
| | | | |

STATE OF ILLINOIS
DEPARTMENT OF TRANSPORTATION

| | |
|--------------------------|--|
| WINNEBAGO RD | |
| PAVEMENT MARKING DETAILS | |
| SCALE: _____ | SHEET NO. _____ OF _____ SHEETS STA. _____ TO STA. _____ |

| | | | | |
|---------------------------|-------------------|------------------|-----------------|--------------|
| F.A.R. RTE. 301 | SECTION 07, 40M-3 | COUNTY WINNEBAGO | TOTAL SHEETS 19 | SHEET NO. 14 |
| CONTRACT NO. 64015 | | | | |
| ILLINOIS FED. AID PROJECT | | | | |

SOLAR POWER FLASHER DETAIL

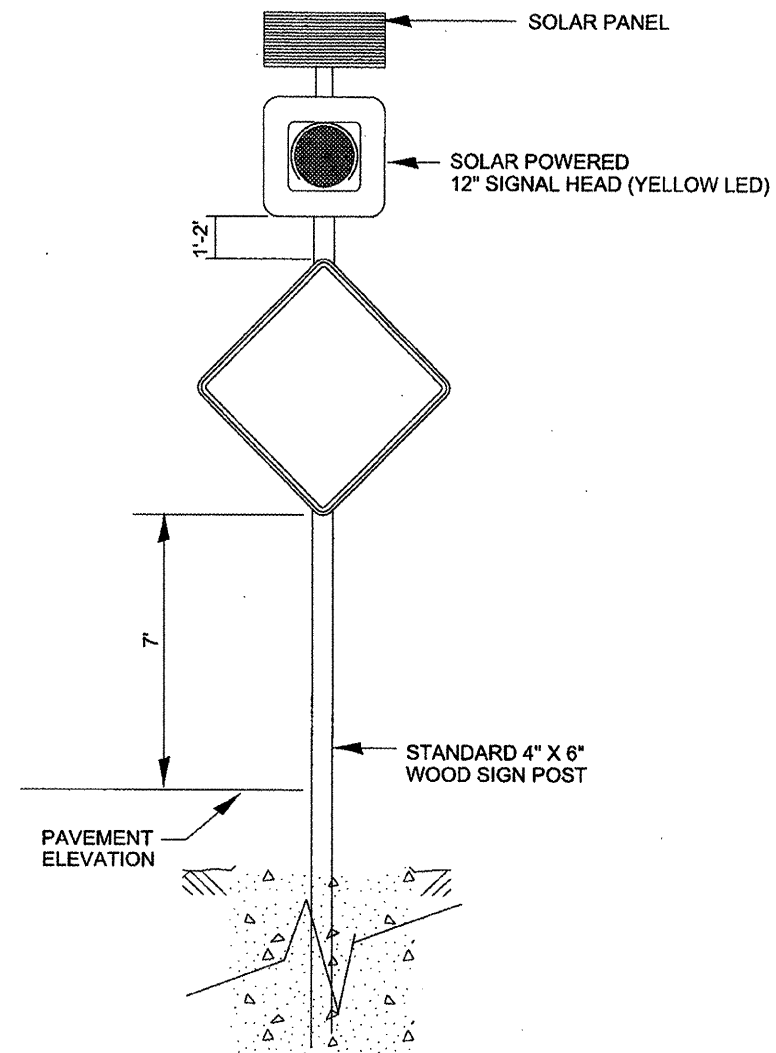

NOTE:
THE CONTRACTOR SHALL SUPPLY ALL NECESSARY
HARDWARE TO MOUNT THE SIGNS TO THE POST. THIS
MOUNTING HARDWARE SHALL BE SIMILAR TO THE SIGN
FIX BRAND MATERIAL.

| | | | | | | | | | | |
|---|--------------------------------------|------------|-----------|---|--|---------------------------|-------------|-----------|-----------------|--------------|
| FILE NAME = | USER NAME = hllkl | DESIGNED - | REVISED - | STATE OF ILLINOIS DEPARTMENT OF TRANSPORTATION | SOLAR POWER BEACON INSTALLATION | F.A.P. RTE. | SECTION | COUNTY | TOTAL SHEETS | SHEET NO. |
| \\d2sarv2\users\HLLKLV\Projects\us 20 | pic and winn 2011\64H15.dgn | DRAWN - | REVISED - | | | 301 | (17, 40M-3) | WINNEBAGO | 19 | 16 |
| | PLOT SCALE = 43.998 1/2 in. | CHECKED - | REVISED - | | | CONTRACT NO. 69H15 | | | | |
| | PLOT DATE = Tue Mar 13 14:52:24 2012 | DATE - | REVISED - | | | ILLINOIS FED. AID PROJECT | | | | |
| SCALE: _____ SHEET NO. _____ OF _____ SHEETS STA. _____ TO STA. _____ | | | | | | | | | | |

TYPICAL PAVEMENT MARKINGS

TYPICAL PAVEMENT MARKING FOR FLUSH MEDIAN AT LEFT TURN LANE

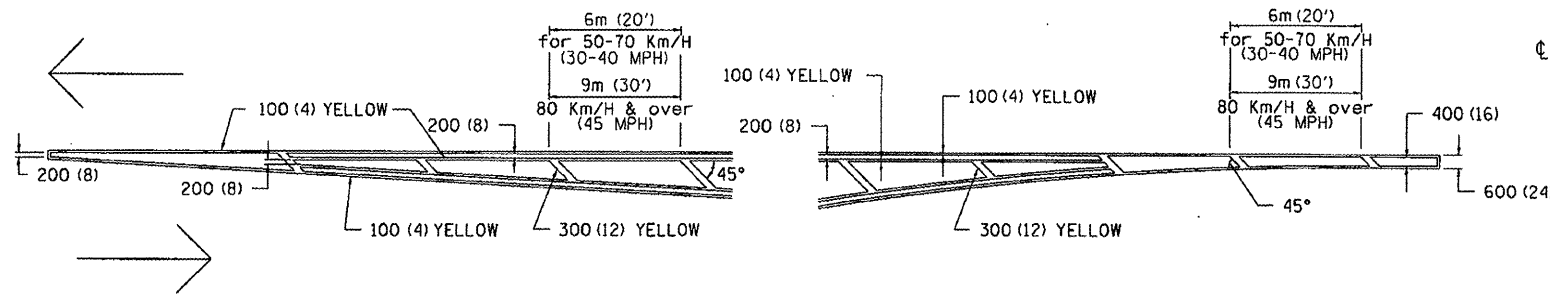

MEDIAN PAVEMENT MARKING

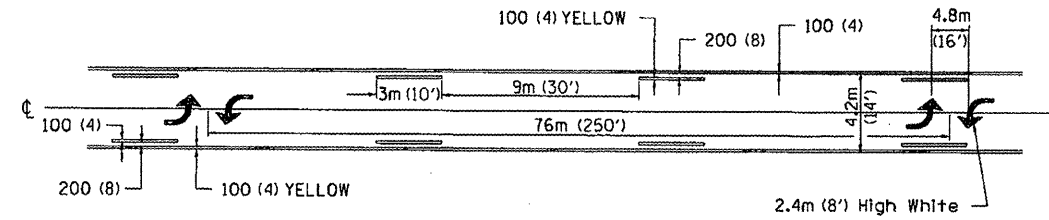

•• ALL DIMENSIONS ARE IN MILLIMETERS (INCHES) UNLESS OTHERWISE NOTED.

TYPICAL ISLAND OFFSET SHOULDER WIDTH

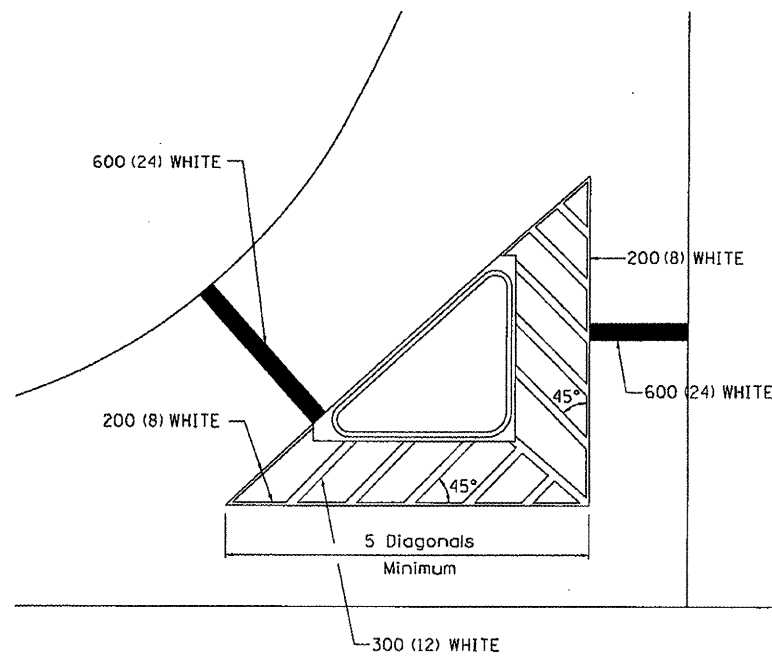

TYPICAL PARKING SPACING

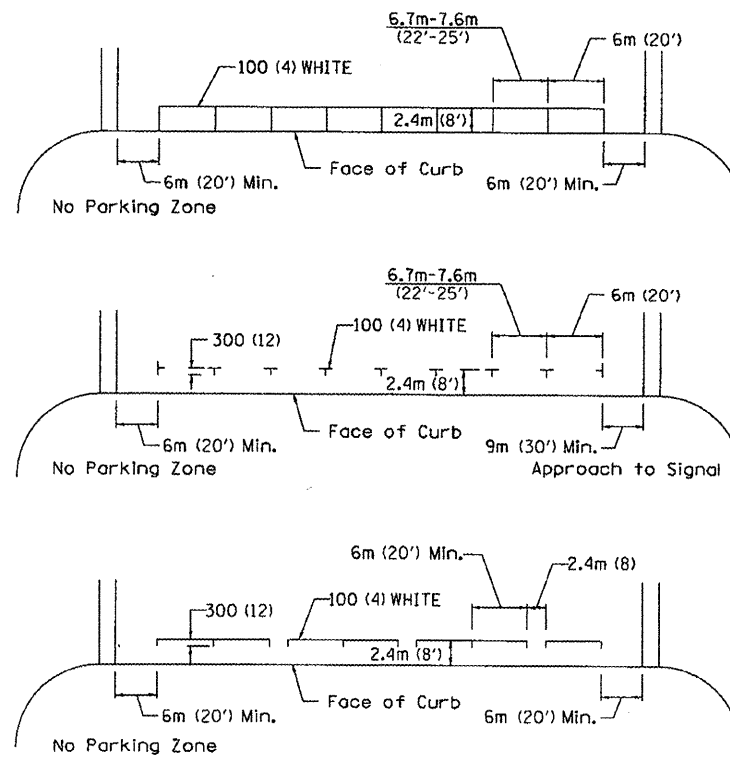

STANDARD CROSSWALK MARKING

See Schedules for Locations

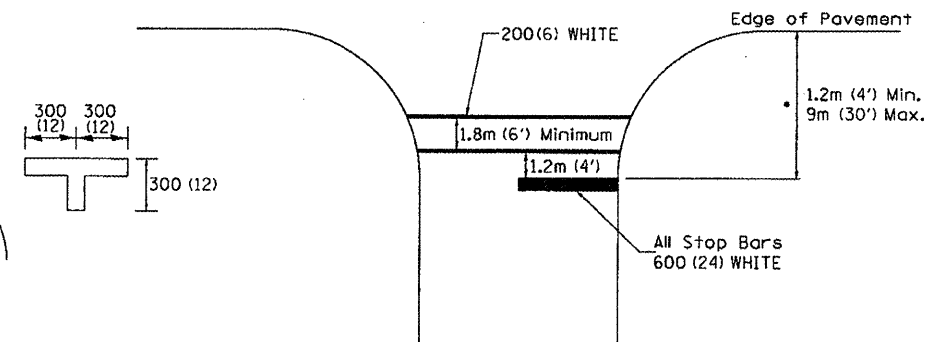

• Distance to the nearest edge of the intersecting roadway in the absence of a marked crosswalk.

| | | | |
|--------------------------------------|-------------------------|------------|--------------------|
| FILE NAME = | USER NAME = hllk1 | DESIGNED - | REVISED - 10-21-08 |
| \\d2s02\users\hllk1\Projects\us 28 | and winn 2011\64H15.dgn | DRAWN - | REVISED - |
| PLOT SCALE = 43.998 / in. | CHECKED - | REVISED - | REVISED - |
| PLOT DATE = Tue Mar 13 14:52:33 2012 | DATE - | REVISED - | REVISED - |

STATE OF ILLINOIS
DEPARTMENT OF TRANSPORTATION

REGION 2 / DISTRICT 2 STANDARD

SCALE: SHEET NO. OF SHEETS STA. TO STA.

| | | | | |
|---|-----------|-----------|--------------------|-----------|
| F.A.P. RTE. | SECTION | COUNTY | TOTAL SHEETS | SHEET NO. |
| 301 | 17, 40M-3 | WINNEBAGO | 19 | 17 |
| FED. ROAD DIST. NO. ILLINOIS FED. AID PROJECT | | | CONTRACT NO. 64H15 | |

TYPICAL PAVEMENT MARKINGS

ARROW LAYOUT

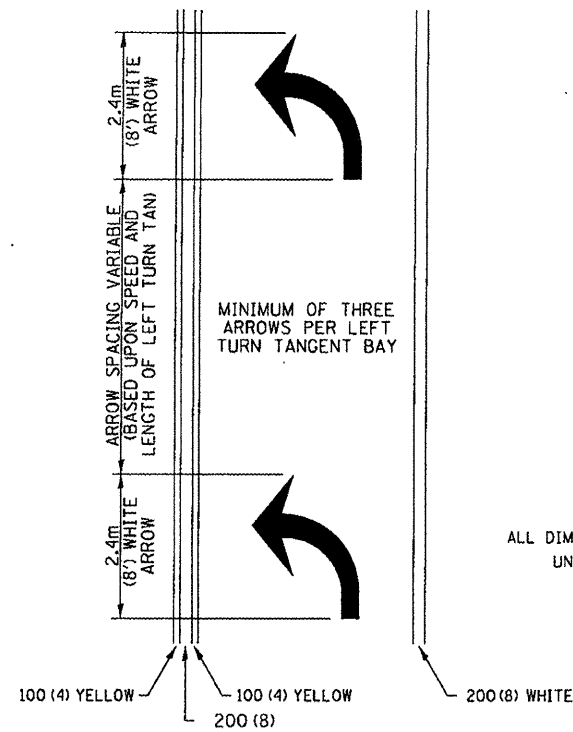

- ◀ ONE-WAY AMBER MARKER
- ◁ ONE-WAY CRYSTAL MARKER
- ◆ TWO-WAY AMBER MARKER

ALL DIMENSIONS ARE IN MILLIMETERS (INCHES) UNLESS OTHERWISE NOTED.

TYPICAL PAVEMENT MARKING FOR FLUSH MEDIAN

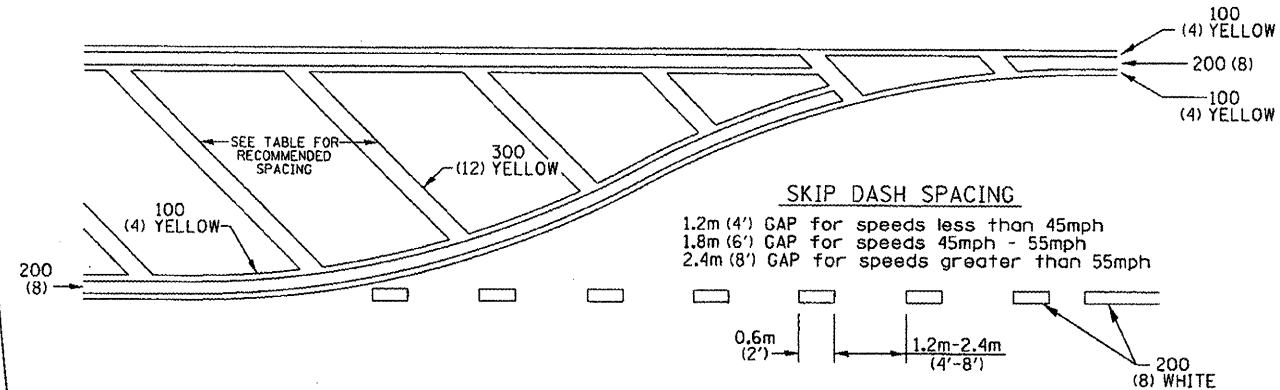

RECOMMENDED SPACING BETWEEN DIAGONALS (IN FEET)

| Speed Limit Range | Continuous Median Area | Intersection Channelization | Objects (Islands) |
|--------------------------|------------------------|-----------------------------|-------------------|
| less than 50Km/H (30MPH) | 15.3m (50') | 4.53m (15') | 3.05m (10') |
| 50-60Km/H (30-40MPH) | 22.9m (75') | 6.1m (20') | 4.53m (15') |
| 70Km/H (45MPH) & over | 22.9m (75') | 9.05m (30') | 6.1m (20') |

NOTE: if the spacing recommended in the Table does not permit at least five diagonal lines in the area being marked, the spacing from the next lowest speed range should be used. The recommended spacing is measured parallel to the pavement center line.

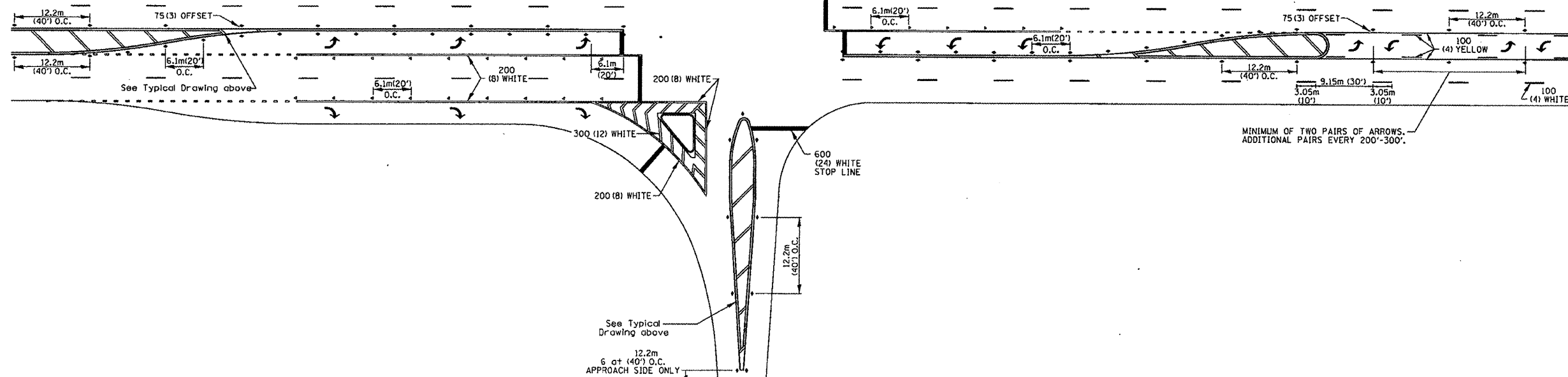

| | | | |
|--|------------------|------------|--------------------|
| FILE NAME = \\d2asr-2\users\HILLKLV\Projects\us 28 | USER NAME = NJIM | DESIGNED - | REVISED - 10-21-08 |
| and win 28116415.dgn | DRAWN - | REVISED - | REVISED - |
| PLOT SCALE = 43.998' / in. | CHECKED - | REVISED - | REVISED - |
| PLOT DATE = Tue Mar 13 14:52:41 2012 | DATE - | REVISED - | REVISED - |

STATE OF ILLINOIS
 DEPARTMENT OF TRANSPORTATION

REGION 2 / DISTRICT 2 STANDARD

| | | | | |
|---|-------------|-----------|--------------------|-----------|
| F.A.R. RTE. | SECTION | COUNTY | TOTAL SHEETS | SHEET NO. |
| 301 | (17, 40)M-3 | WINNEBAGO | 19 | 18 |
| FED. ROAD DIST. NO. [ILLINOIS] FED. AID PROJECT | | | CONTRACT NO. 64HIS | |

SCALE: _____ SHEET NO. _____ OF _____ SHEETS STA. _____ TO STA. _____

TYPICAL PAVEMENT MARKINGS

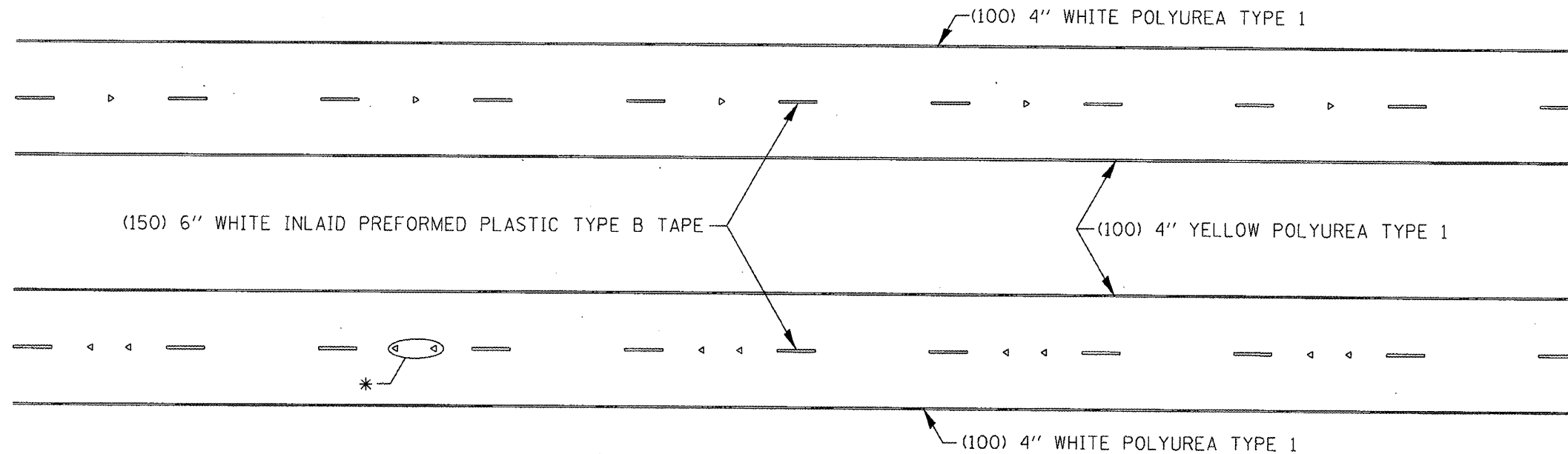

* SEE HIGHWAY STANDARD 781001 FOR SPACING DETAILS.
USE DOUBLE MARKERS WHEN ADT ≥ 25,000.

MULTI-LANE / DIVIDED

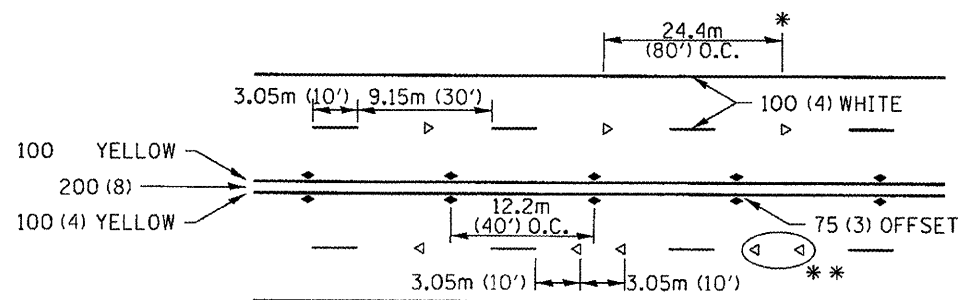

- * REDUCE TO 12.2m (40') O.C. ON CURVES WHERE ADVISORY SPEEDS ARE 15KM/H (10MPH) LOWER THAN POSTED SPEEDS.
- ** USE DOUBLE MARKERS WHEN ADT ≥ 25,000

MULTI-LANE / UNDIVIDED

TYPICAL PAVEMENT MARKING FOR TWO LANE SECTION - NO PASSING ZONES

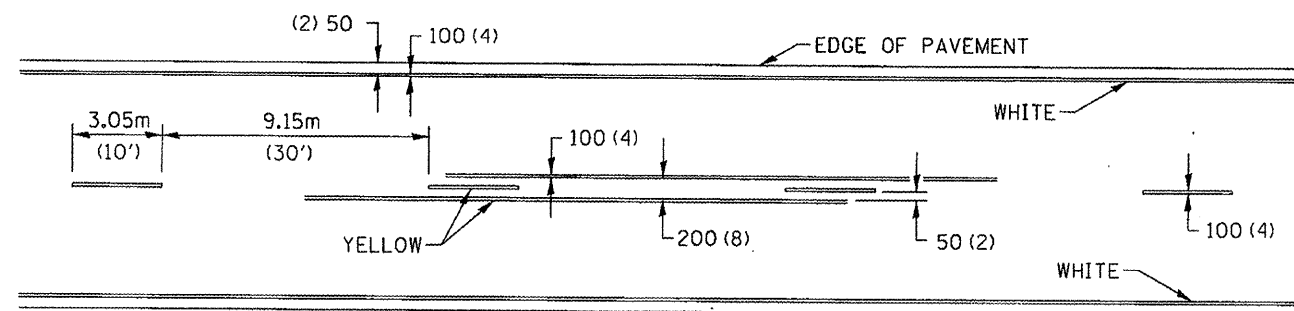

SYMBOLS

| | | | |
|-------------------------------------|--------------------------------------|------------|--------------------|
| FILE NAME = | USER NAME = h11k1 | DESIGNED - | REVISED - 10-21-08 |
| \\d2srv2\users\WILLK\Projects\us 28 | pic and winn 2011\64M5.dgn | DRAWN - | REVISED - |
| | PLOT SCALE = 43.948 / in. | CHECKED - | REVISED - |
| | PLOT DATE = Tue Mar 13 14:53:00 2012 | DATE - | REVISED - |

STATE OF ILLINOIS
DEPARTMENT OF TRANSPORTATION

REGION 2 / DISTRICT 2 STANDARD

SCALE: SHEET NO. OF SHEETS STA. TO STA.

| | | | | |
|---|---------|-----------|--------------------|-----------|
| F.A.P. RTE. | SECTION | COUNTY | TOTAL SHEETS | SHEET NO. |
| 301 | | WINNEBAGO | 19 | 19 |
| FED. ROAD DIST. NO. ILLINOIS FED. AID PROJECT | | | CONTRACT NO. 69015 | |