

Traffic barrier to be removed, stored and reattached, typ.
Cost included with Concrete Removal.

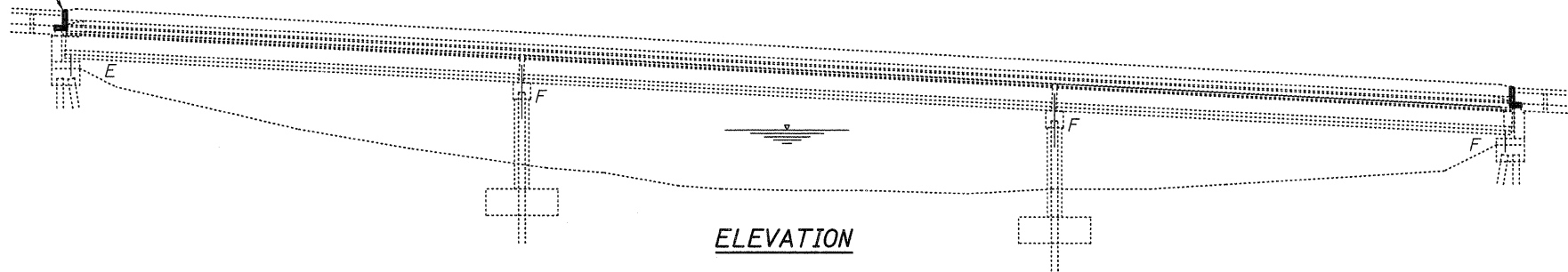

ELEVATION

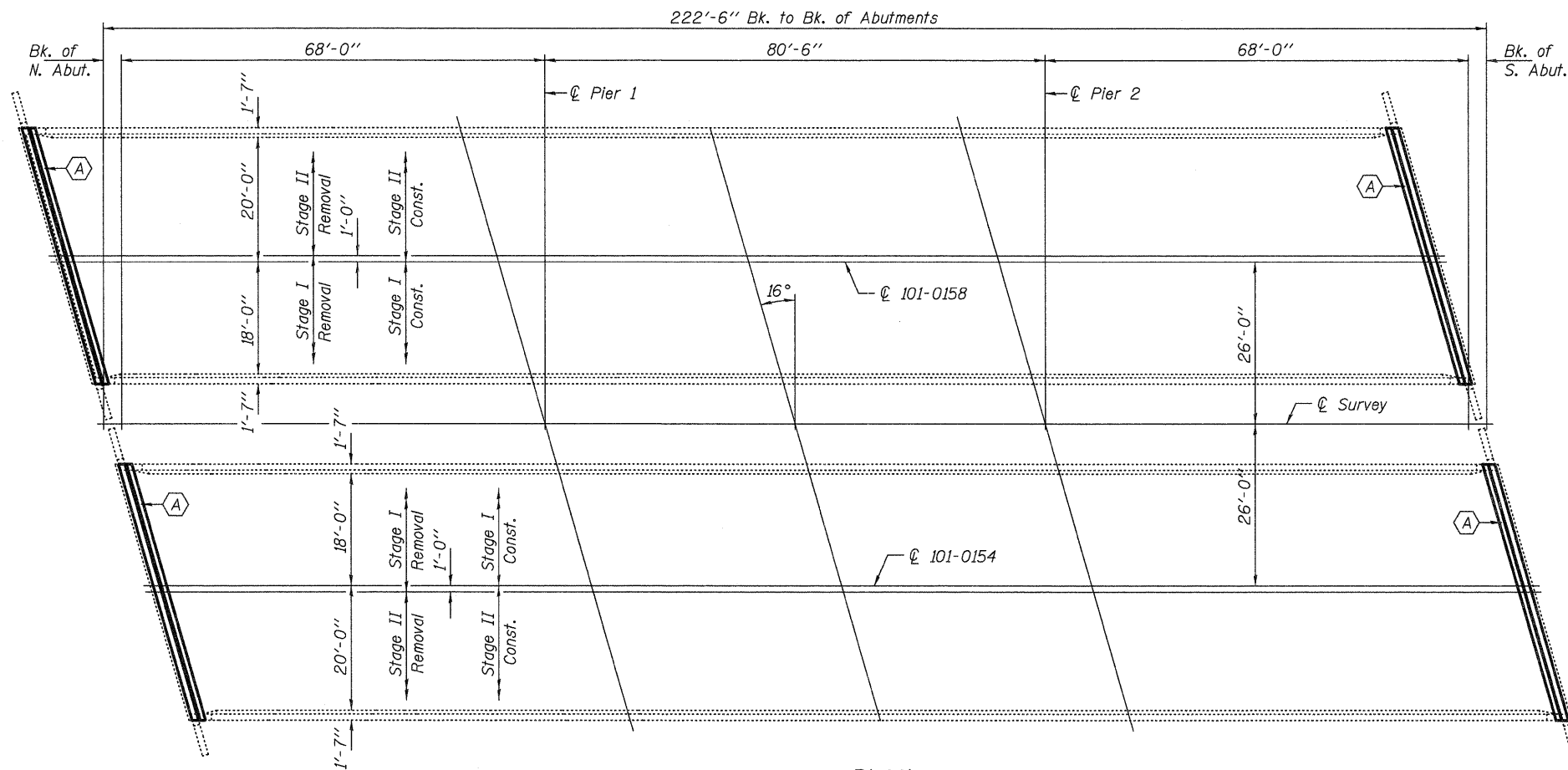

PLAN

(A) - Joint replacement

GENERAL NOTES

All structural steel shall conform to AASHTO Classification M-270 Gr. 36, unless otherwise noted.

Reinforcement bars designated (E) shall be epoxy coated.

Plan dimensions and details relative to existing plans are subject to nominal construction variations. The Contractor shall field verify existing dimensions and details affecting new construction and make necessary approved adjustments prior to construction or ordering of materials. Such variations shall not be cause for additional compensation for a change in scope of the work, however, the Contractor will be paid for the quantity actually furnished at the unit price bid for the work.

Existing reinforcement bars extending into the removal area shall be cleaned, straightened and incorporated into the new construction. Any reinforcement bars that are damaged during concrete removal shall be replaced with an approved bar splicer or anchorage system. Cost included with Concrete Removal.

Joint openings shall be adjusted according to Article 520.04 of the Standard Specifications when the deck is poured at an ambient temperature other than 50° F.

The deck surface shall have its final finish tined according to Article 420.09(e)(1) of the Standard Specifications. Cost included with Concrete Superstructures.

The Contractor shall use extreme care during concrete removal so as not to damage the PPC I-Beam.

TOTAL BILL OF MATERIAL

ITEM	UNIT	QUANTITY
Concrete Removal	Cu. Yd.	6.8
Concrete Superstructure	Cu. Yd.	6.6
Preformed Joint Strip Seal	Foot	167
Reinforcement Bars, Epoxy Coated	Pound	1150
Bar Splicers	Each	16
* Protective Coat	Sq. Yd.	37.9
Polymer Modified Portland Cement Mortar	Sq. Ft.	21.1
Structural Repair of Concrete ≤ 5 inches	Sq. Ft.	0.5

* New Concrete Only



EXPIRES 11-30-2012

DESIGNED <i>Jim D. Hayes</i>	EXAMINED <i>Jim F. [Signature]</i>	DATE <u>MAY 1, 2012</u>
CHECKED <i>Ally Spacy</i>	ACTING ENGINEER OF STRUCTURAL SERVICES	REVISED
DRAWN <i>baliva</i>	PASSED <i>David Carl Puze</i>	REVISED
CHECKED <i>ISL ADY</i>	ACTING ENGINEER OF BRIDGES AND STRUCTURES	

**STATE OF ILLINOIS
DEPARTMENT OF TRANSPORTATION**

**GENERAL PLAN AND ELEVATION
IL RTE 251 OVER KILBUCK CREEK
SN 101-0154 (SB) & 101-0158 (NB)**

SHEET NO. 1 OF 7 SHEETS

F.A.S. RTE.	SECTION	COUNTY	TOTAL SHEETS	SHEET NO.
1042	1B, 1BR, 1BR-2RM	WINNEBAGO	31	7
CONTRACT NO. 64H75				
ILLINOIS FED. AID PROJECT				