

STATE OF ILLINOIS  
DEPARTMENT OF TRANSPORTATION  
DIVISION OF HIGHWAYS

**PROPOSED  
HIGHWAY PLANS**

FAI ROUTE 55 (I-55)  
SECTION D3 PAVEMENT PATCHING 2013-5

**CRC PAVEMENT PATCHING  
LIVINGSTON COUNTY**  
C-93-113-12

F.A.I. RTE.	SECTION	COUNTY	TOTAL SHEETS	SHEET NO.
55	*	LIVINGSTON	11	1
		ILLINOIS	CONTRACT NO. 66C21	

\*D3 PAVEMENT PATCHING 2013-5

INDEX OF SHEETS

1. COVER SHEET
2. GENERAL NOTES
3. SUMMARY OF QUANTITIES
4. TYPICAL SECTIONS - FAI 55
5. PATCHING SCHEDULE - I-55 NB
6. PATCHING SCHEDULE - I-55 SB
7. PAVEMENT MARKING SCHEDULE - I-55
8. TRAFFIC CONTROL AND PROTECTION, STANDARD 701400 (SPECIAL)
9. CLASS A PATCHING DETAILS WITHOUT HMA OVERLAY
10. CLASS A PATCHING DETAILS WITH HMA OVERLAY
11. TYPICAL PAVEMENT MARKINGS

STANDARDS

- |           |  |
|-----------|--|
| 000001-06 | STANDARD SYMBOLS, ABBREVIATIONS AND PATTERNS   |
| 001001-02 | AREAS OF REINFORCEMENT BARS  |
| 001006    | DECIMAL OF AN INCH AND OF A FOOT   |
| 420001-07 | PAVEMENT JOINTS  |
| 420101-04 | 24' (7.2 m) JOINTED PCC PAVEMENT   |
| 420111-03 | PCC PAVEMENT ROUNDOUTS   |
| 421001-02 | BAR REINFORCEMENT FOR CRC PAVEMENT   |
| 442001-04 | CLASS A PATCHES  |
| 701101-02 | OFF-ROAD OPERATIONS MULTILANE, 15' (4.5 m) TO 24' (600 mm) FROM PAVEMENT EDGE        |
| 701106-02 | OFF-ROAD OPERATIONS, MULTILANE, MORE THAN 15' (4.5 m) AWAY                           |
| 701401-06 | LANE CLOSURE, FREEWAY/EXPRESSWAY   |
| 701411-08 | LANE CLOSURE, MULTILANE, AT ENTRANCE OR EXIT RAMP FOR SPEEDS $\Delta$ 45 MPH         |
| 701426-04 | LANE CLOSURE, MULTILANE INTERMITTENT OR MOVING OPERATION, FOR SPEEDS $\Delta$ 45 MPH |
| 701901-02 | TRAFFIC CONTROL DEVICES  |

DISTRICT 3 NO. (815) 434-6131

J.U.L.I.E.  
JOINT UTILITY LOCATION INFORMATION FOR EXCAVATION  
1-800-892-0123  
OR 811

PROJECT ENGINEER: JOE KANNEL, P.E.  
UNIT CHIEF: RON WOODSHANK  
TOWNSHIPS: VARIOUS  
CONTRACT NO. 66C21

BEGIN FAI 55 PROJECT  
CLASS A PATCHING  
MCLEAN COUNTY LINE  
(M.M. 187.70)

END FAI 55 PROJECT  
CLASS A PATCHING  
GRUNDY COUNTY LINE  
(M.M. 218.07)

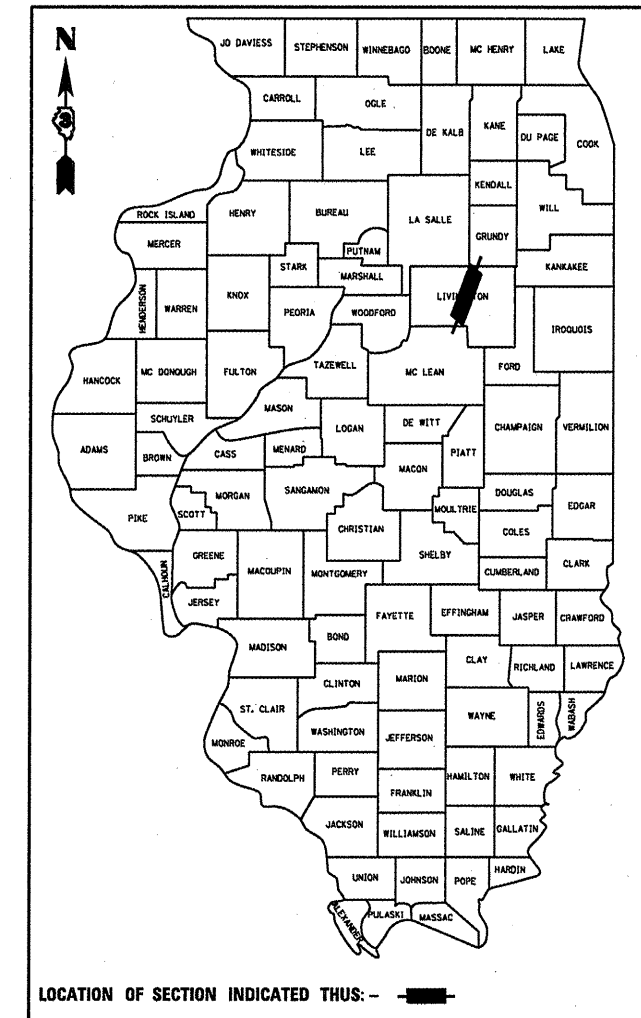

FUNCTIONAL CLASSIFICATION  
RURAL: INTERSTATE  
FAI ROUTE 55  
2011 ADT = 20100  
P.V = 74.9%    M.U. = 21.4%    S.U. = 3.7%

STATE OF ILLINOIS  
DEPARTMENT OF TRANSPORTATION  
DIVISION OF HIGHWAYS

SUBMITTED 4/6 20 12  
*Eric S. Herbolden*  
DEPUTY DIRECTOR OF HIGHWAYS, REGION ENGINEER

May 11 20 12  
*John D. Baranzelli, P.E.*  
ACTING ENGINEER OF DESIGN AND ENVIRONMENT

May 11 20 12  
*William R. Frezza*  
ACTING DIRECTOR OF HIGHWAYS, CHIEF ENGINEER

PRINTED BY THE AUTHORITY  
OF THE STATE OF ILLINOIS

**GENERAL NOTES**

PLAN DIMENSIONS AND DETAILS RELATIVE TO EXISTING ROADWAY OR STRUCTURE HAVE BEEN TAKEN FROM EXISTING PLANS AND ARE SUBJECT TO NOMINAL CONSTRUCTION VARIATIONS. IT SHALL BE THE CONTRACTOR'S RESPONSIBILITY TO VERIFY SUCH DIMENSIONS AND DETAILS IN THE FIELD AND TO MAKE NECESSARY APPROVED ADJUSTMENTS PRIOR TO CONSTRUCTION OR ORDERING OF MATERIALS. SUCH VARIATIONS SHALL NOT BE CAUSE FOR ADDITIONAL COMPENSATION FOR A CHANGE IN THE SCOPE OF THE WORK, HOWEVER, THE CONTRACTOR WILL BE PAID FOR THE QUANTITY ACTUALLY FURNISHED AT THE UNIT BID FOR THE WORK.

FOR STABILIZATION, ALL TYPE III BARRICADES SHALL REQUIRE A MINIMUM OF FOUR SAND BAGS PER BARRICADE.

ABANDONED UNDERGROUND UTILITIES THAT CONFLICT WITH CONSTRUCTION SHALL BE DISPOSED OF OUTSIDE THE LIMITS OF THE RIGHT OF WAY ACCORDING TO ARTICLE 202.03 OF THE STANDARD SPECIFICATIONS AND AS DIRECTED BY THE ENGINEER. THIS WORK WILL NOT BE PAID FOR SEPARATELY BUT SHALL BE INCLUDED IN THE COST OF CLASS A PATCHING.

ANY REFERENCE TO A STANDARD IN THESE PLANS SHALL BE INTERPRETED TO MEAN THE EDITION AS INDICATED BY THE SUBNUMBER LISTED ON THE INDEX OF SHEETS OR THE COPY OF THE STANDARD INCLUDED IN THESE PLANS.

EXISTING REINFORCEMENT BARS EXTENDING INTO REMOVAL AREA SHALL BE CLEANED, STRAIGHTENED AND INCORPORATED INTO THE NEW CONSTRUCTION. ANY REINFORCEMENT BARS THAT ARE DAMAGED DURING CONCRETE REMOVAL SHALL BE REPLACED WITH AN APPROVED BAR SPLICER OR ANCHORAGE SYSTEM. COST INCLUDED WITH CONCRETE REMOVAL.

THE CONTRACTOR SHALL CONTACT JULIE AT LEAST 48 HOURS PRIOR TO EXCAVATION TO DETERMINE WHICH UTILITIES ARE IN THE AREA.

**COMMITMENTS**

DATE: 4-6-12

PREPARED BY: Tom Brown  
DISTRICT STUDIES & PLANS ENGINEER

EXAMINED BY: Herbert K. Jung  
DISTRICT CONSTRUCTION ENGINEER

Ray J. Collins  
DISTRICT MATERIALS ENGINEER

James A. Huber  
DISTRICT OPERATIONS ENGINEER

FILE NAME =	USER NAME = potelyj	DESIGNED - RON WOODSHANK	REVISED -
ci\p\work\p\pidot\potelyj\d0301955\036621-shtr\details.dgn		DRAWN - RON WOODSHANK	REVISED -
	PLOT SCALE = 100.0000' / 1" =	CHECKED -	REVISED -
	PLOT DATE = 4/5/2012	DATE -	REVISED -

**STATE OF ILLINOIS  
DEPARTMENT OF TRANSPORTATION**

**GENERAL NOTES**

SCALE: SHEET NO. 1 OF 1 SHEETS STA. TO STA.

F.A.I. RTE.	SECTION	COUNTY	TOTAL SHEETS	SHEET NO.
55	*	LIVINGSTON	11	2
*03 PAVEMENT PATCHING 2013-5			CONTRACT NO. 66C21	
[ILLINOIS]				

CODE NO.	ITEM	UNIT	TOTAL QUANTITY	CONSTR. CODE
				STATE FUNDS 100% STATE ROADWAY 0005 RURAL
44200541	CLASS A PATCHES, TYPE II, 9 INCH	SQ YD	64	64
44200545	CLASS A PATCHES, TYPE III, 9 INCH	SQ YD	48	48
44200620	CLASS A PATCHES, TYPE II, 14 INCH	SQ YD	400	400
44200624	CLASS A PATCHES, TYPE III, 14 INCH	SQ YD	174	174
44213000	PATCHING REINFORCEMENT	SQ YD	686	686
44213100	PAVEMENT FABRIC	SQ YD	574	574
44213200	SAW CUTS	FOOT	4412	4412
67100100	MOBILIZATION	L SUM	1	1
70100420	TRAFFIC CONTROL AND PROTECTION, STANDARD 701411	EACH	16	16
70103815	TRAFFIC CONTROL SURVEILLANCE	CAL DA	20	20
* 78009004	MODIFIED URETHANE PAVEMENT MARKING - LINE 4"	FOOT	551	551
* 78009006	MODIFIED URETHANE PAVEMENT MARKING - LINE 6"	FOOT	155	155
X0326880	MESSAGE BOARD VEHICLE DRIVER	HOUR	120	120
X0326907	PORTABLE, VEHICLE MOUNTED, CHANGEABLE MESSAGE SIGN	CAL MO	0.5	0.5
X7010805	TRAFFIC CONTROL AND PROTECTION, STANDARD 701401 (SPECIAL)	L SUM	1	1

\* SPECIALITY ITEMS

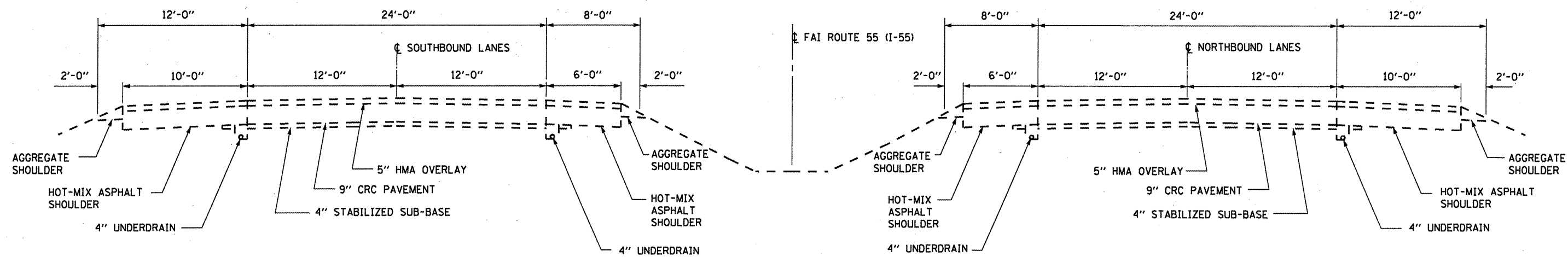

**TYPICAL SECTION  
MAINLINE**

M.M. 187.70 TO M.M. 215.40

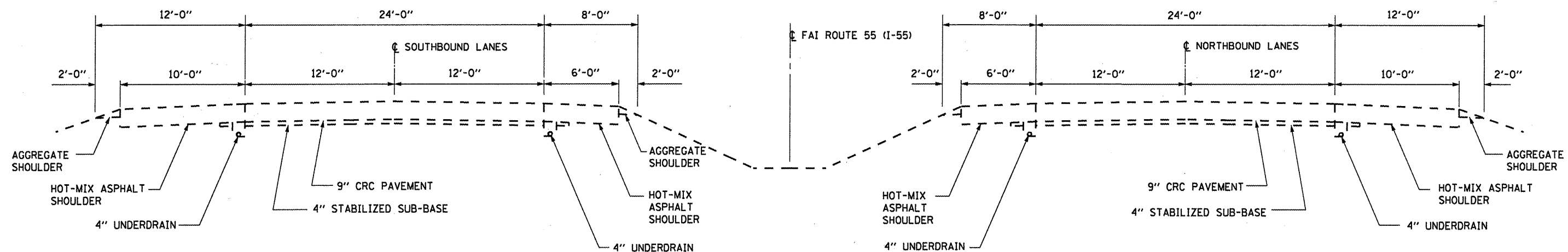

**TYPICAL SECTION  
MAINLINE**

M.M. 215.40 TO M.M. 218.07

FILE NAME =	USER NAME = petelj	DESIGNED - RON WOODSHANK	REVISED -
c:\pwwork\p\petelj\d0301955\036621-shd-details.dgn		DRAWN - RON WOODSHANK	REVISED -
	PLOT SCALE = 100.0000' / 1in.	CHECKED -	REVISED -
	PLOT DATE = 4/5/2012	DATE -	REVISED -

STATE OF ILLINOIS  
DEPARTMENT OF TRANSPORTATION

TYPICAL SECTIONS - FAI 55

SCALE: SHEET NO. 1 OF 1 SHEETS STA. TO STA.

F.A.I. RTE.	SECTION	COUNTY	TOTAL SHEETS	SHEET NO.
55	*	LIVINGSTON	11	4
*D3 PAVEMENT PATCHING 2013-5			CONTRACT NO. 66C21	
ILLINOIS				

PATCHING SCHEDULE - NBL															
LOCATION BY MILE POST	PASS LANE	DRIVE LANE	PASSING LANE					DRIVING LANE					REMARKS		
			CLASS A 14"		PATCH REINF. SQ YD	PVMT FABRIC	SAW CUTS FOOT	TIE BARS EACH	CLASS A 14"		PATCH REINF. SQ YD	PVMT FABRIC		SAW CUTS FOOT	TIE BARS EACH
			TYPE II SQ YD	TYPE III SQ YD					TYPE II SQ YD	TYPE III SQ YD					
187.70														MCLEAN COUNTY LINE	
195.50		15							20	20	20	78			
195.60		17							23	23	23	82			
195.60		17							23	23	23	82			
195.60		17							23	23	23	82			
196.30		18								0		84			
196.40		6						8		8	8	60			
196.50		6						8		8	8	60			
196.70	6	6	8		8	8	60	8		8	8	60			
197.20		17							23	23	23	82			
198.40	6		8		8	8	60								
198.80	8	6	11		11	11	64	8		8	8	60			
198.90		6						8		8	8	60			
199.10		6						8		8	8	60			
199.10		6						8		8	8	60			
199.10		6						8		8	8	60			
200.10		17							23	23	23	82			
200.30		6						8		8	8	60			
200.30		8						11		11	11	64			
200.60		18										84			
202.20		6						8		8	8	60			
202.40		6						8		8	8	60			
202.40		6						8		8	8	60			
202.40		6						8		8	8	60			
202.50		6						8		8	8	60			
202.80		6						8		8	8	60			
202.90		6						8		8	8	60			
202.90		6						8		8	8	60			
203.00		6						8		8	8	60			
203.10		6						8		8	8	60			
203.10		6						8		8	8	60			
203.20		6						8		8	8	60			
203.40		15							20	20	20	78			
203.40		6						8		8	8	60			
203.70		6						8		8	8	60			
203.80		6						8		8	8	60			
203.90		6						8		8	8	60			
203.90		6						8		8	8	60			
204.10		6						8		8	8	60			
204.20		8						11		11	11	64			
207.75														END HMA SEC; BEGIN CONCRETE SEC;	
TOTALS			27		27	27	184		237	154	391	391	2482		

PATCHING SCHEDULE - NBL															
LOCATION BY MILE POST	PASS LANE	DRIVE LANE	PASSING LANE					DRIVING LANE					REMARKS		
			CLASS A 9"		PATCH REINF. SQ YD	PVMT FABRIC	SAW CUTS FOOT	TIE BARS EACH	CLASS A 9"		PATCH REINF. SQ YD	PVMT FABRIC		SAW CUTS FOOT	TIE BARS EACH
			TYPE II SQ YD	TYPE III SQ YD					TYPE II SQ YD	TYPE III SQ YD					
207.75														END HMA SEC; BEGIN CONCRETE SEC;	
208.40		6							8		8		60		
214.80		6							8		8		60		
215.30		6							8		8		60		
218.70														GRUNDY COUNTY LINE	
TOTALS									24		24		180		

PATCHING SCHEDULE - SBL															
LOCATION BY MILE POST	PASS LANE	DRIVE LANE	PASSING LANE						DRIVING LANE						REMARKS
			CLASS A 9"		PATCH REINF. SQ YD	PVMT FABRIC	SAW CUTS FOOT	TIE BARS EACH	CLASS A 9"		PATCH REINF. SQ YD	PVMT FABRIC	SAW CUTS FOOT	TIE BARS EACH	
			TYPE II SQ YD	TYPE III SQ YD					TYPE II SQ YD	TYPE III SQ YD					
218.07															GRUNDY COUNTY LINE
215.30	18	18		24	24			84			24	24		84	
215.30	6		8		8			60							
215.20		6							8		8		60		
208.30		6							8		8		60		
208.10		6							8		8		60		
208.60	6		8		8			60							
207.75															END CONCRETE SEC: BEGIN HMA SECTION
TOTALS			16	24	40			204		24	24	48		264	

PATCHING SCHEDULE - SBL															
LOCATION BY MILE POST	PASS LANE	DRIVE LANE	PASSING LANE						DRIVING LANE						REMARKS
			CLASS A 14"		PATCH REINF. SQ YD	PVMT FABRIC	SAW CUTS FOOT	TIE BARS EACH	CLASS A 14"		PATCH REINF. SQ YD	PVMT FABRIC	SAW CUTS FOOT	TIE BARS EACH	
			TYPE II SQ YD	TYPE III SQ YD					TYPE II SQ YD	TYPE III SQ YD					
207.75															END CONCRETE SEC: BEGIN HMA SECTION
204.70		6							8		8	8	60		
204.60		15								20	20	20	78		
204.30		6							8		8	8	60		
204.20		6							8		8	8	60		
204.20		6							8		8	8	60		
203.90		6							8		8	8	60		
203.60		6							8		8	8	60		
202.90		6							8		8	8	60		
202.60		6							8		8	8	60		
202.40		6							8		8	8	60		
202.10		6							8		8	8	60		
200.60		6							8		8	8	60		
200.40		6							8		8	8	60		
199.80		6							8		8	8	60		
199.60		6							8		8	8	60		
199.50		6							8		8	8	60		
198.70		6							8		8	8	60		
198.30		6							8		8	8	60		
187.70															MCLEAN COUNTY LINE
TOTALS									136	20	156	156	1098		

PAVEMENT MARKING SCHEDULE - NBL			
LOCATION  MILE POST	URETHANE PAVEMENT MARKING LINE 4"		URETHANE PAVEMENT MARKING LINE 6"
	FEET		FEET
	YELLOW	WHITE	WHITE
187.70			
195.50		15	4
195.60		17	4
195.60		17	4
195.60		17	4
196.30		19	5
196.40		6	2
196.50		6	2
196.70	6	6	2
197.20		17	4
198.40	6		
198.80	6	6	2
198.90		6	2
199.10		6	2
199.10		6	2
199.10		6	2
200.10		17	4
200.30		6	2
200.30		8	2
200.60		20	5
202.20		6	2
202.40		6	2
202.40		6	2
202.40		6	2
202.40		6	2
202.50		6	2
202.80		6	2
202.90		6	2
202.90		6	2
203.00		6	2
203.10		6	2
203.10		6	2
203.20		6	2
203.40		15	4
203.40		6	2
203.70		6	2
203.80		6	2
203.90		6	2
203.90		6	2
204.10		6	2
204.20		8	2
207.75			
208.40		6	2
214.80		6	2
215.30		6	2
218.70			
SUBTOTAL	18	350	
TOTAL		368	102

PAVEMENT MARKING SCHEDULE - NBL			
LOCATION  MILE POST	URETHANE PAVEMENT MARKING LINE 4"		URETHANE PAVEMENT MARKING LINE 6"
	FEET		FEET
	YELLOW	WHITE	WHITE
215.30	18	18	5
215.30	6		2
215.20		6	2
208.30		6	2
208.10		6	2
208.60	6		2
204.70		6	2
204.60		15	4
204.30		6	2
204.20		6	2
204.20		6	2
203.90		6	2
203.60		6	2
202.90		6	2
202.60		6	2
202.40		6	2
202.10		6	2
200.60		6	2
200.40		6	2
199.80		6	2
199.60		6	2
199.50		6	2
198.70		6	2
198.30		6	2
SUBTOTAL	30	153	
TOTAL		183	53

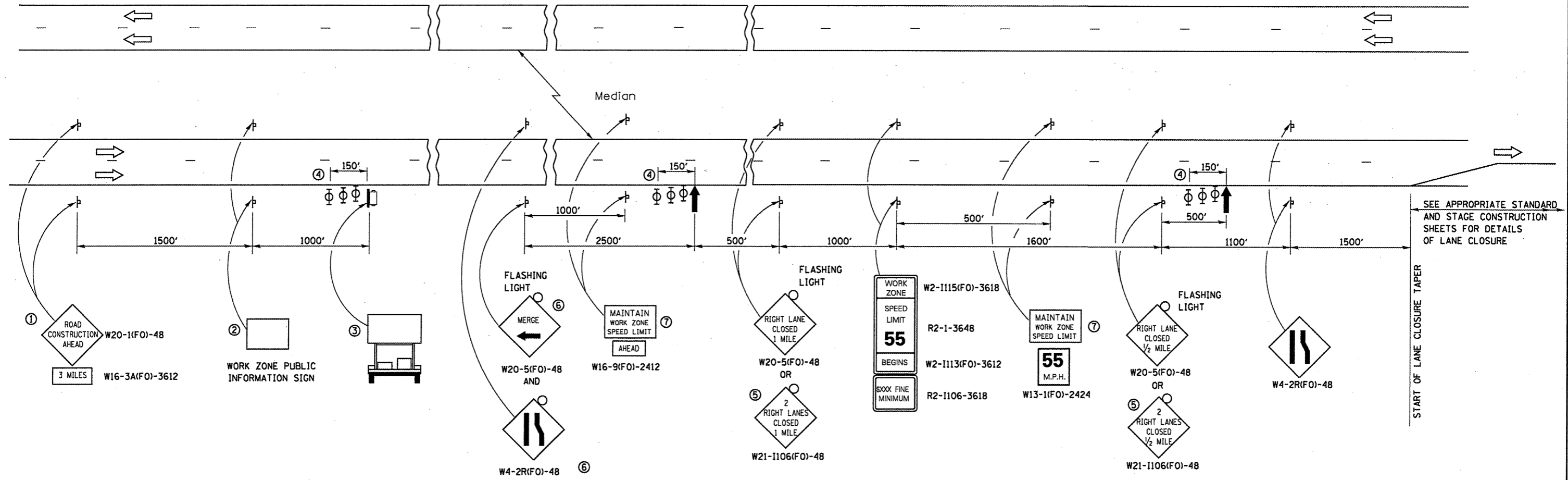

SEE APPROPRIATE STANDARD AND STAGE CONSTRUCTION SHEETS FOR DETAILS OF LANE CLOSURE

- ① THE ROAD CONSTRUCTION AHEAD SIGN SHALL BE LOCATED 3 MILES IN ADVANCE OF THE PROJECT LIMITS.
- ② THE MESSAGE AND SIZE OF THE WORK ZONE PUBLIC INFORMATION SIGN SHALL BE AS SPECIFIED BY THE DEPARTMENT.
- ③ TO BE PLACED IN THE MEDIAN WHEN FEASIBLE, THE MESSAGE BOARD SHALL BE USED TO DISPLAY STATUS OF LANES WITHIN THE PROJECT. THE PRIMARY MESSAGES SHALL BE:  
"RIGHT LANE CLOSED" / " x MILES AHEAD"  
"LEFT LANE CLOSED" / " x MILES AHEAD"  
"ALL LANES OPEN"
- ④ THREE, TYPE II BARRICADES, DRUMS, OR VERTICAL BARRICADES AT 50' CENTERS.
- ⑤ THIS SIGN SHALL BE USED WHEN 2 LANES ARE CLOSED.
- ⑥ WHEN THE LEFT LANE IS CLOSED, SWITCH THESE TWO SIGNS AND THE DIRECTION OF THE MERGE ARROW.

⑦ 48"x36" FLUORESCENT ORANGE SIGN WITH BLACK LETTERS.

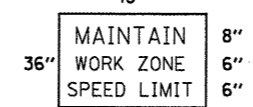

- ↑ ARROW BOARD
- ☐ PORTABLE CHANGEABLE MESSAGE SIGN
- ⊥ SIGN
- ⊕ TYPE II BARRICADE, DRUM, OR VERTICAL BARRICADE WITH MONODIRECTIONAL FLASHING LIGHT

**GENERAL NOTE:**

THIS STANDARD IS USED WHERE AT ANY TIME A LANE IS CLOSED ON A FREEWAY/EXPRESSWAY.

WHEN THE LEFT LANE IS CLOSED, LEFT LANE CLOSED SIGNS SHALL BE SUBSTITUTED FOR THE RIGHT LANE CLOSED SIGNS.

THE FIRST TWO SIGNS AND THE MESSAGE BOARD ARE STATIONARY. THE OTHER SIGNS AND ARROWBOARDS SHALL BE MOVED AS NECESSARY TO MAINTAIN THE REQUIRED DISTANCE FROM THE START OF THE LANE CLOSURE TAPER(S).

SEE SPECIAL PROVISIONS.

ALL DIMENSIONS ARE IN INCHES UNLESS OTHERWISE SHOWN.

FILE NAME =	USER NAME = potelyj	DESIGNED - RON WOODSHANK	REVISED -	<b>STATE OF ILLINOIS DEPARTMENT OF TRANSPORTATION</b>	<b>TRAFFIC CONTROL AND PROTECTION STANDARD 701400 (SPECIAL)</b>	F.A.I. RTE. 55	SECTION *	COUNTY LIVINGSTON	TOTAL SHEETS 11	SHEET NO. 8
cr:\pw\work\p1dot\potelyj\d0381955\0366021-sht-details.dgn	DRAWN - RON WOODSHANK	REVISED -	#03 PAVEMENT PATCHING 2013-5			CONTRACT NO. 66C21				
PLOT SCALE = 100.0000' / 1"	CHECKED -	REVISED -	ILLINOIS							
PLOT DATE = 4/5/2012	DATE -	REVISED -								



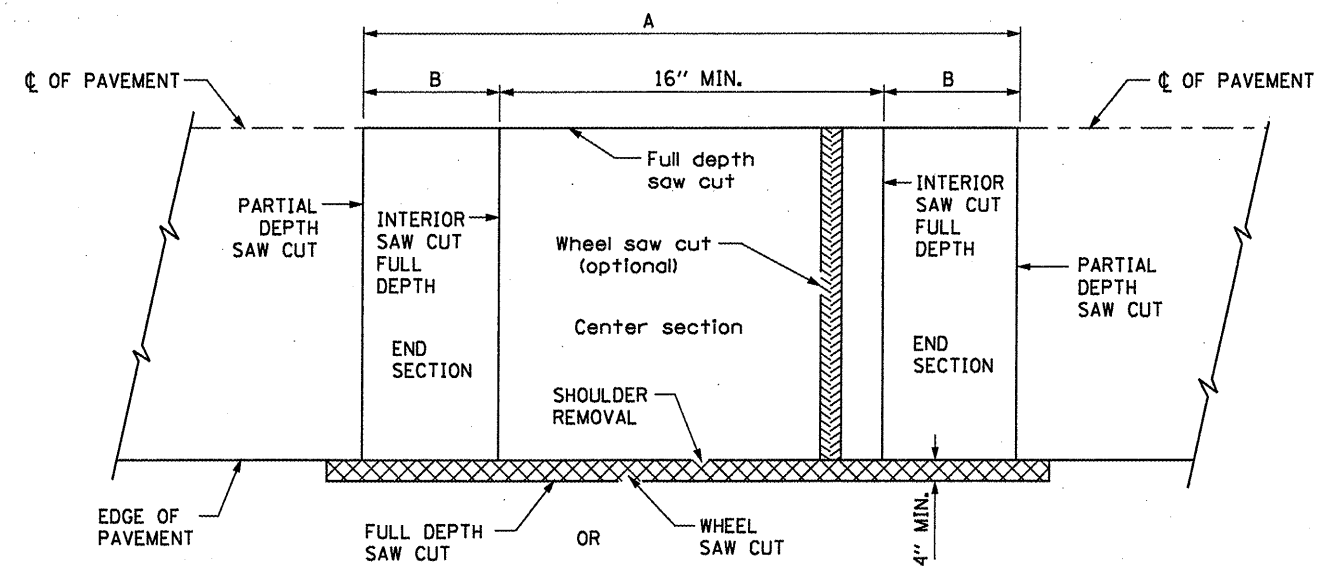

**EXISTING PAVEMENT SAWING DETAIL**  
(AGAINST BITUMINOUS SHOULDER)

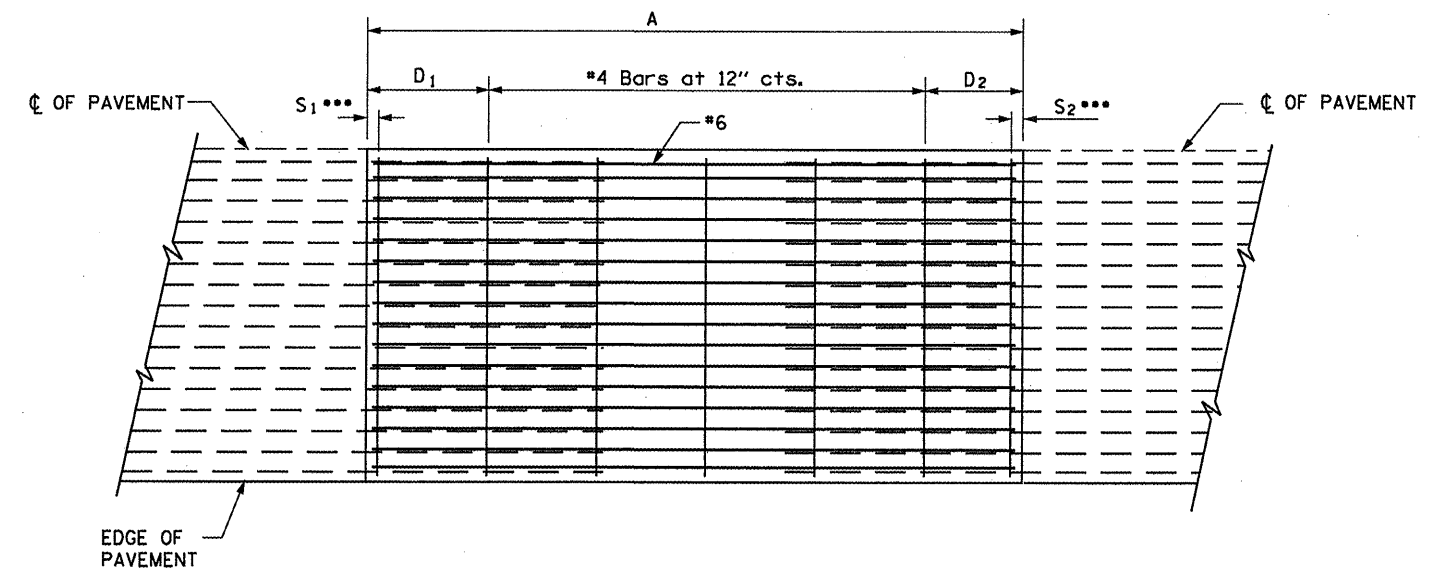

**PROPOSED PAVEMENT DETAIL**  
(AGAINST CONCRETE SHOULDER)

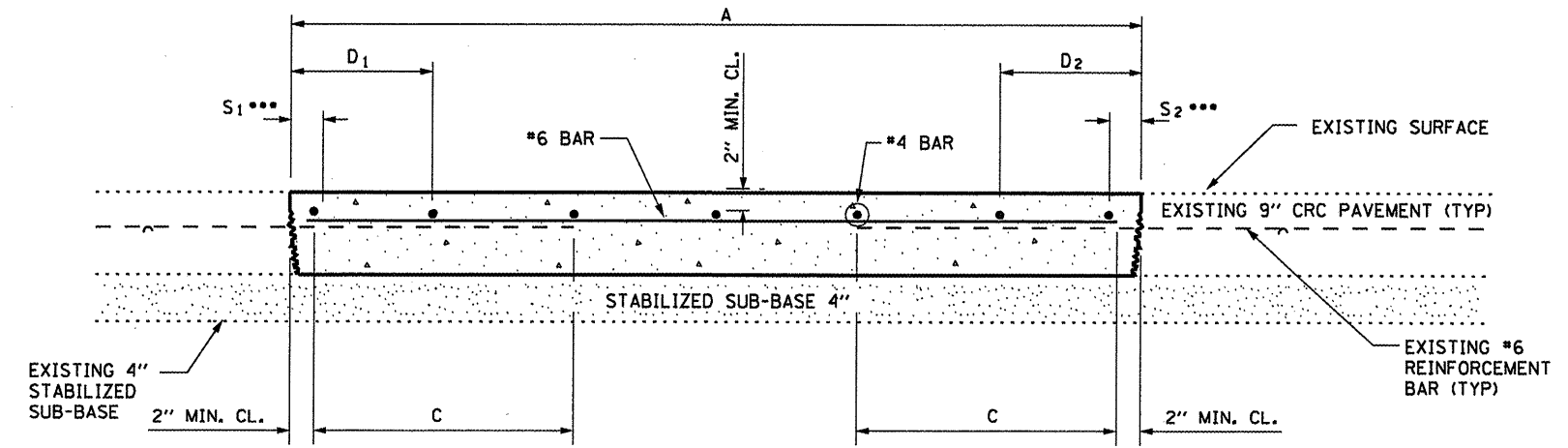

**PROPOSED CLASS A PATCHING DETAIL**

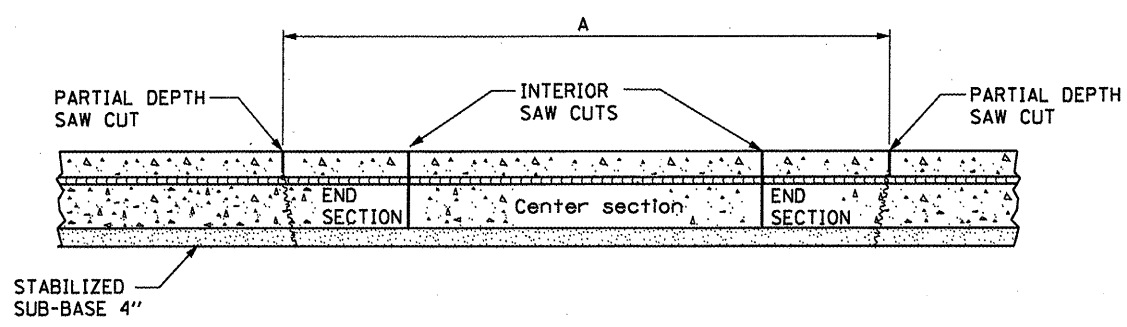

**REMOVAL DETAIL**

EXISTING LONGITUDINAL REINFORCEMENT BARS	A (min.)	B (min.)	C (min.)
No. 6	6'-0"	21"	19"

- NOTES:**
- EVERY 3rd INTERSECTION MUST BE TIED
  - LAP NEW REINFORCEMENT WITH EXISTING LONGITUDINAL REINFORCEMENT
  - VARIABLES: WHERE  $S_1$  AND  $S_2$  ARE  $2\frac{1}{2}$ " MIN. AND 12" MAX.  $D_1 = 2(S_1)$  AND  $D_2 = 2(S_2)$

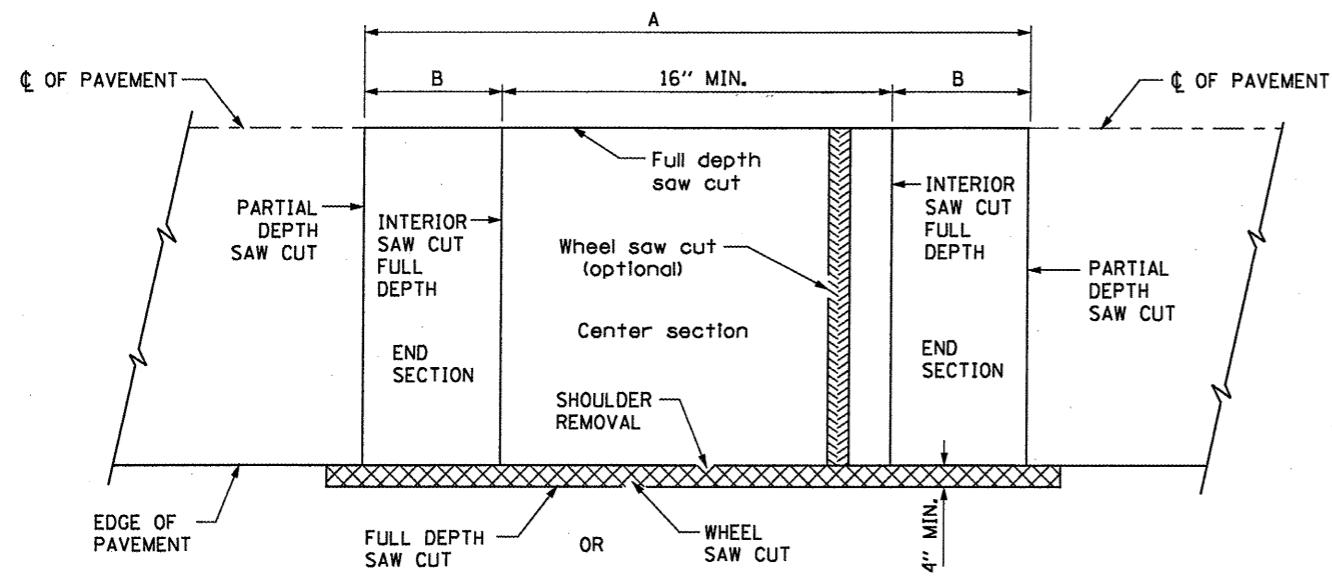

**EXISTING PAVEMENT SAWING DETAIL**  
(AGAINST BITUMINOUS SHOULDER)

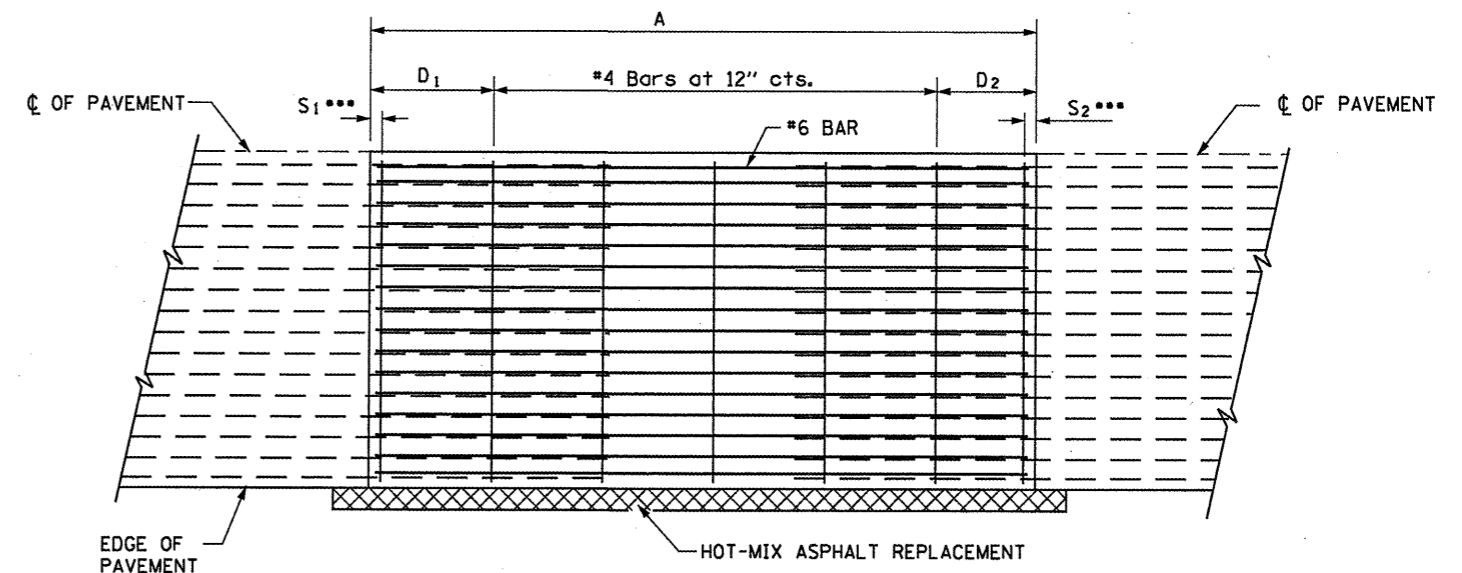

**PROPOSED PAVEMENT DETAIL**  
(AGAINST BITUMINOUS SHOULDER)

EXISTING LONGITUDINAL REINFORCEMENT BARS	A (min.)	B (min.)	C (min.)
No. 6	6'-0"	24"	19"

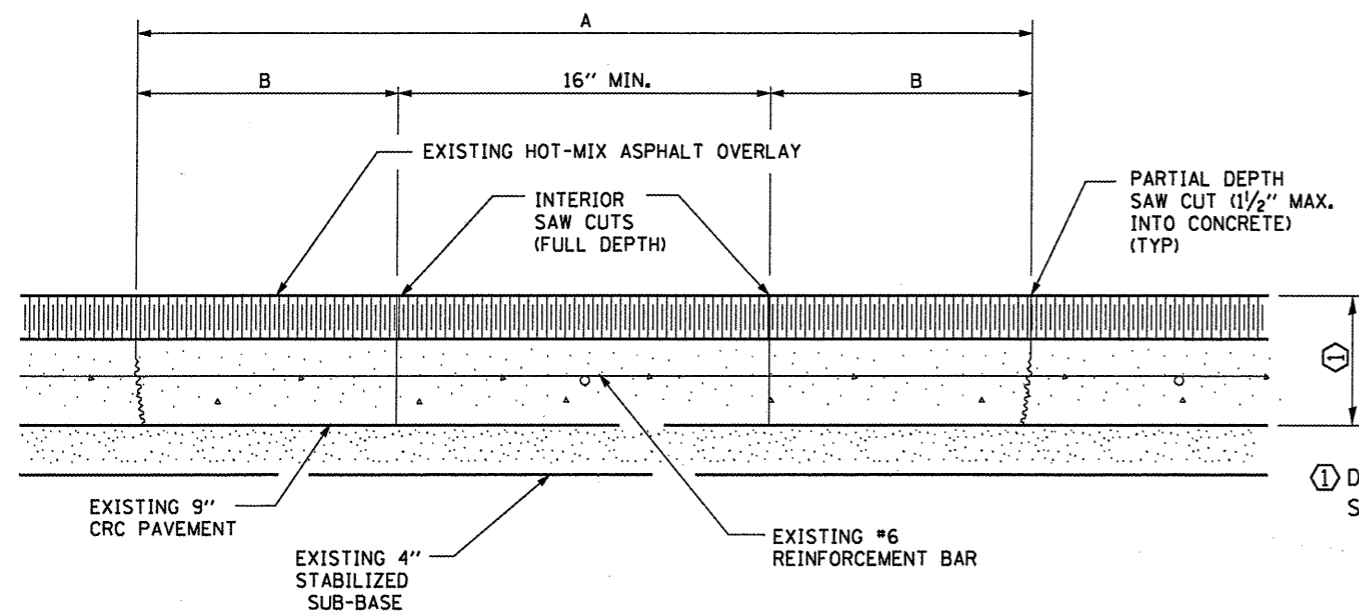

**EXISTING PAVEMENT**  
**SAW CUTTING DETAIL**

① DEPTH VARIES  
SEE TYPICAL SECTIONS

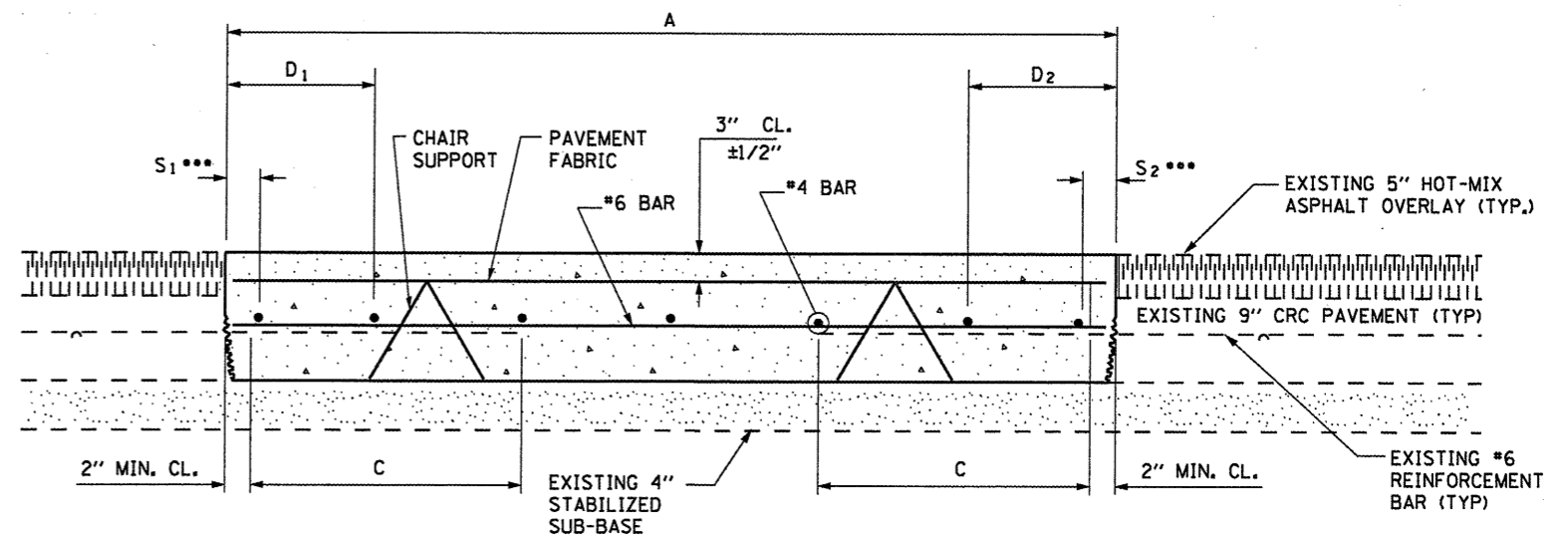

**PROPOSED CLASS A PATCHING DETAIL**

**NOTES:**

- EVERY 3rd INTERSECTION MUST BE TIED
- LAP NEW REINFORCEMENT WITH EXISTING LONGITUDINAL REINFORCEMENT
- VARIABLES: WHERE S<sub>1</sub> AND S<sub>2</sub> ARE 2 1/2" MIN. AND 12" MAX. D<sub>1</sub> = 2(S<sub>1</sub>) AND D<sub>2</sub> = 2(S<sub>2</sub>)

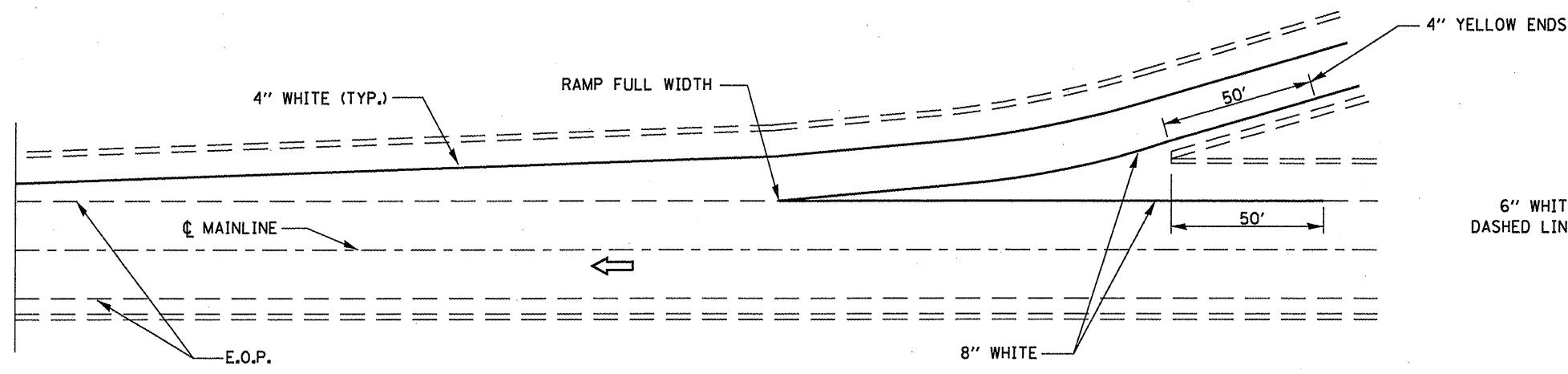

**TYPICAL PAVEMENT MARKING FOR ENTRANCE RAMP TERMINALS**

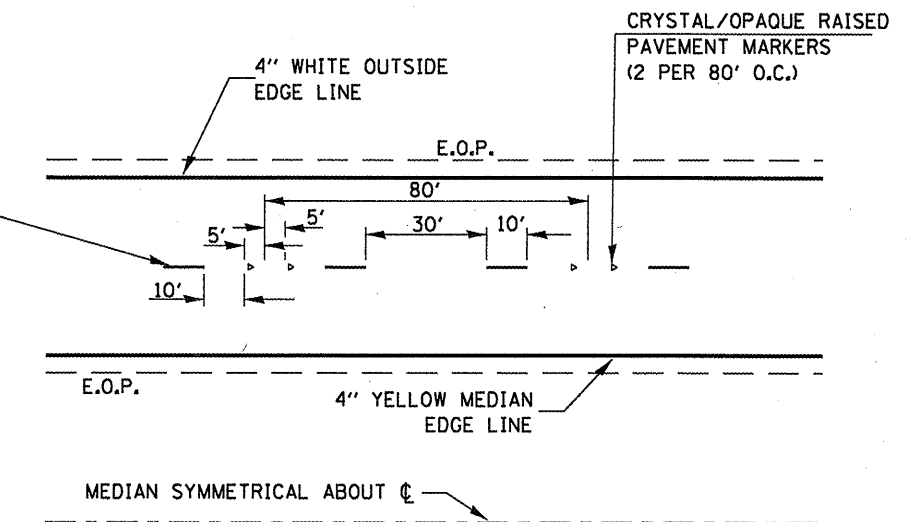

**TYPICAL PAVEMENT MARKINGS**

**NOTE:**  
 WHEN PATCHING IS ADJACENT TO 8" PAVEMENT MARKING LINE THE 8" STRIP SHALL BE REPLACED WITH TWO 4" LINES.  
 RAISED REFLECTIVE PAVEMENT MARKERS THAT FALL WITHIN PATCHED BOUNDARIES WILL NOT BE REPLACED.

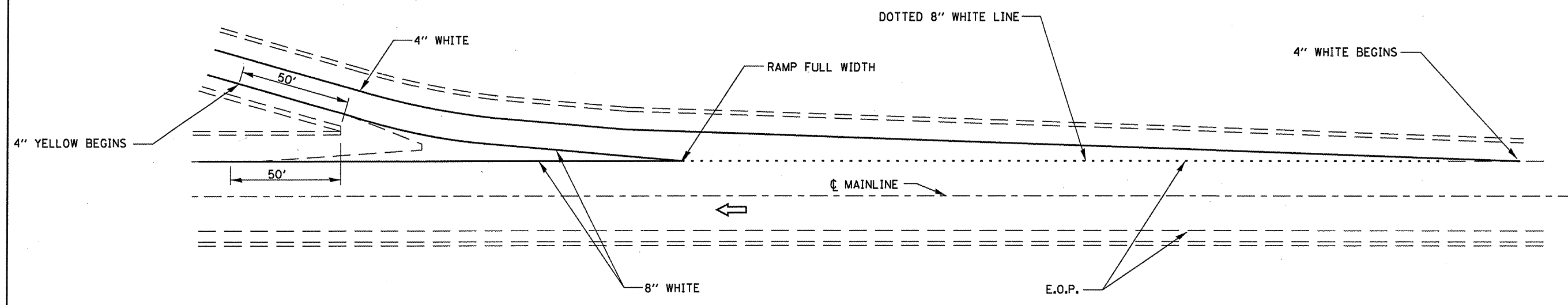

**TYPICAL PAVEMENT MARKINGS FOR EXIT RAMP TERMINALS**

FILE NAME =	USER NAME = potelyj	DESIGNED - RON WOODSHANK	REVISED -	<b>STATE OF ILLINOIS DEPARTMENT OF TRANSPORTATION</b>	<b>TYPICAL PAVEMENT MARKING</b>	F.A.I. RTE.	SECTION	COUNTY	TOTAL SHEETS	SHEET NO.
c:\pwork\pwork\potelyj\d0301955\0366021-ahd-details.dgn	DRAWN - RON WOODSHANK	REVISED -	55			*	LIVINGSTON	11	11	
PLOT SCALE = 100.0000 ' / in.	CHECKED -	REVISED -	#03 PAVEMENT PATCHING 2013-5				CONTRACT NO. 66C21			
PLOT DATE = 4/5/2012	DATE -	REVISED -	ILLINOIS							
					SCALE:	SHEET NO. 1 OF 1 SHEETS	STA.	TO STA.		