

EXISTING PAVEMENT SAWING DETAIL
(AGAINST BITUMINOUS SHOULDER)

EXISTING LONGITUDINAL REINFORCEMENT BARS	A (min.)	B (min.)	C (min.)
No. 6	6'-0"	24"	19"

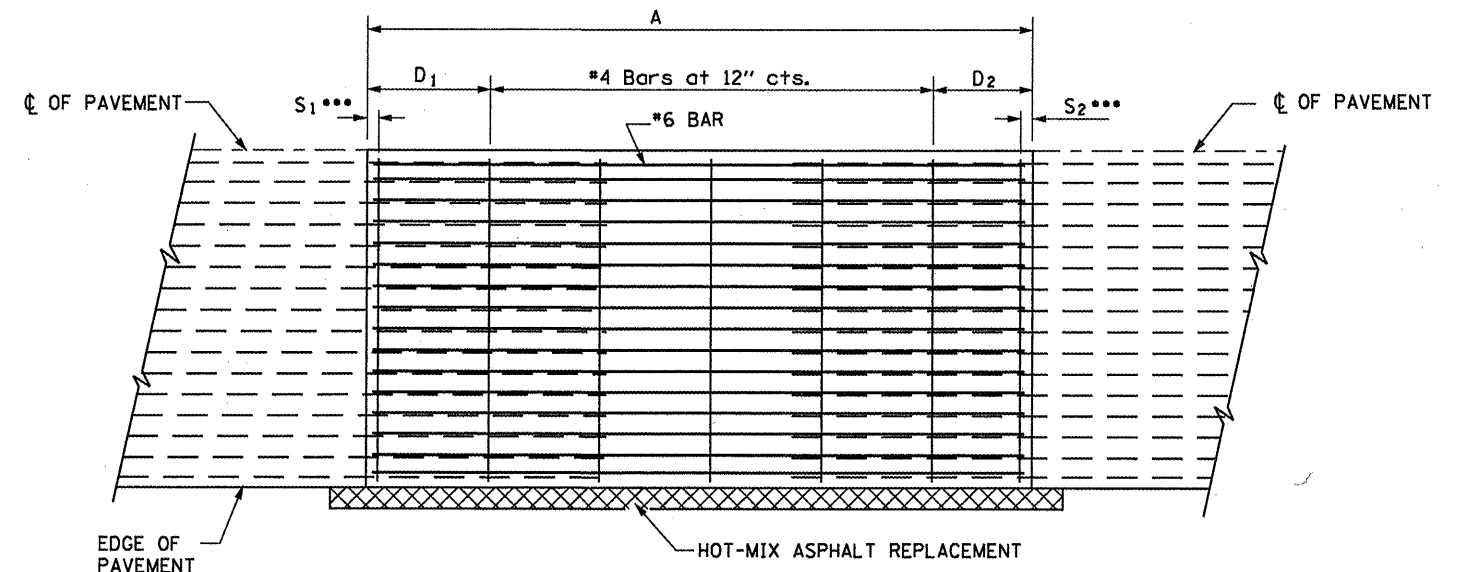

PROPOSED PAVEMENT DETAIL
(AGAINST BITUMINOUS SHOULDER)

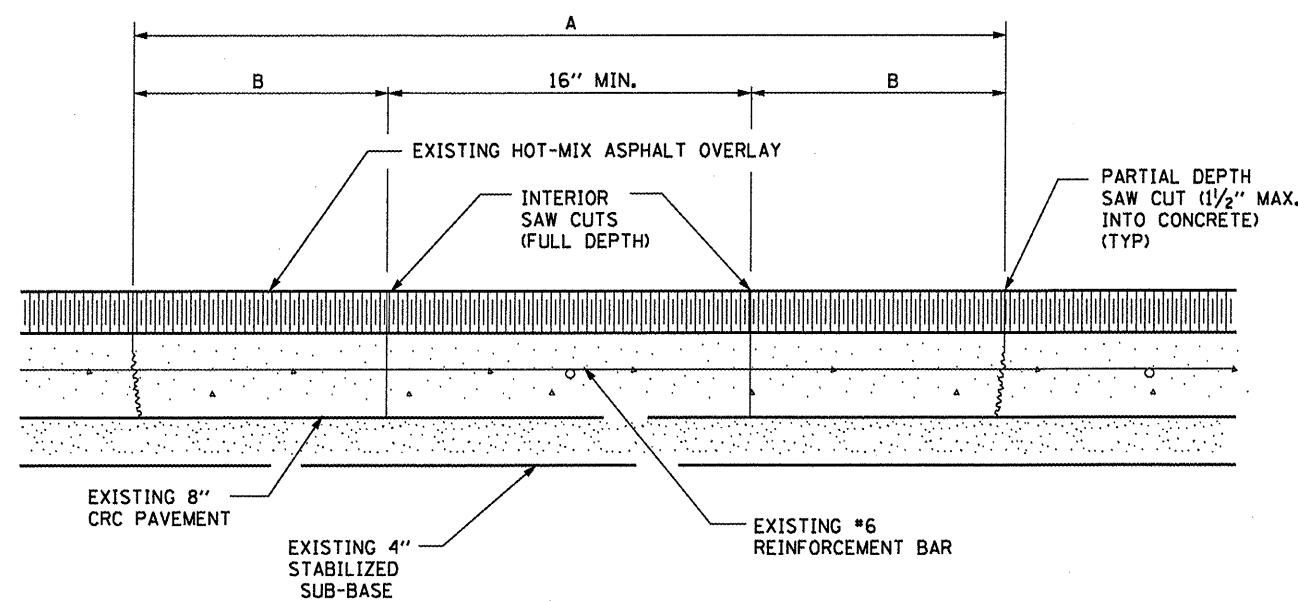

EXISTING PAVEMENT SAW CUTTING DETAIL

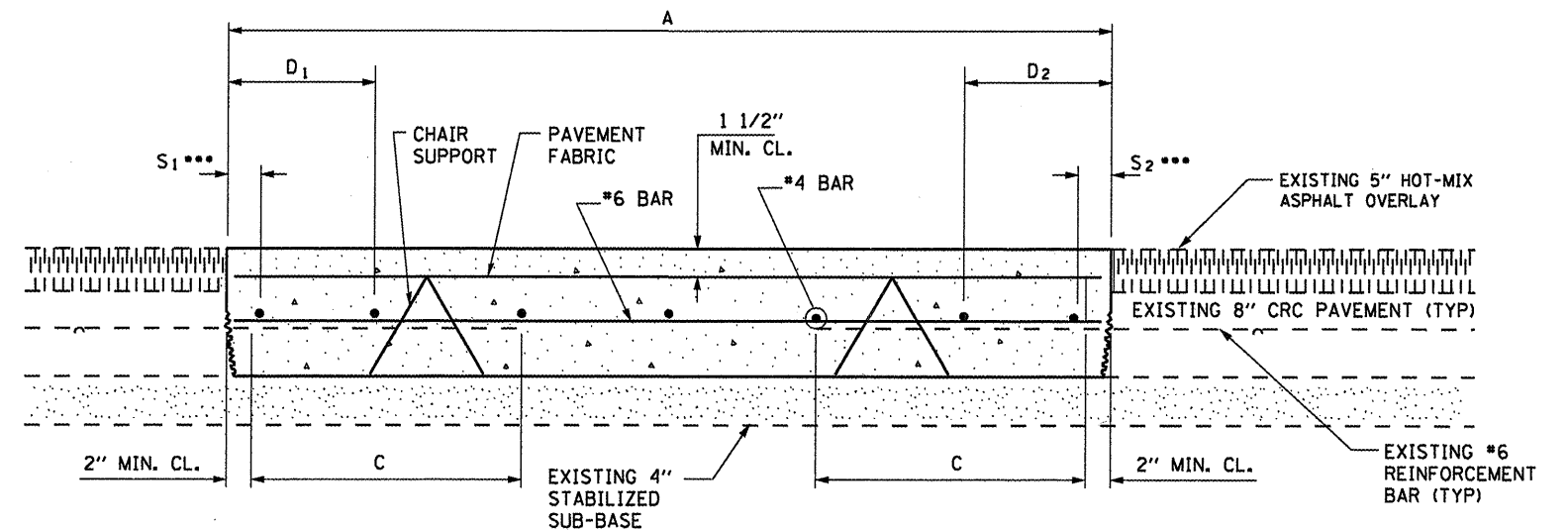

PROPOSED CLASS A PATCHING DETAIL

NOTES:

- EVERY 3rd INTERSECTION MUST BE TIED
- LAP NEW REINFORCEMENT WITH EXISTING LONGITUDINAL REINFORCEMENT
- VARIABLES: WHERE S₁ AND S₂ ARE 2 1/2" MIN. AND 12" MAX. D₁ = 2(S₁) AND D₂ = 2(S₂)

FILE NAME =	USER NAME = potelyj	DESIGNED - RON WOODSHANK	REVISED -
c:\pwork\pwork\potelyj\08300133\0366024-sht-details.dgn		DRAWN - RON WOODSHANK	REVISED -
PLOT SCALE = 100.0000' / in.		CHECKED -	REVISED -
PLOT DATE = 4/5/2012		DATE -	REVISED -

STATE OF ILLINOIS
DEPARTMENT OF TRANSPORTATION

CLASS A PATCHING DETAIL

SCALE: SHEET NO. 1 OF 1 SHEETS STA. TO STA.

F.A.I. RTE. 57	SECTION *	COUNTY IROQUOIS	TOTAL SHEETS 10	SHEET NO. 9
*D3 PAVEMENT PATCHING 2013-4			CONTRACT NO. 66C24	
ILLINOIS				