

DATE	
BY	
FINISHED SURVEY	
PLOTTED	
NOTE BOOK	
AREAS CHECKED	
NO.	

DATE	
BY	
ORIGINAL SURVEY	
TEMPLATE	
NOTE BOOK	
AREAS CHECKED	
NO.	

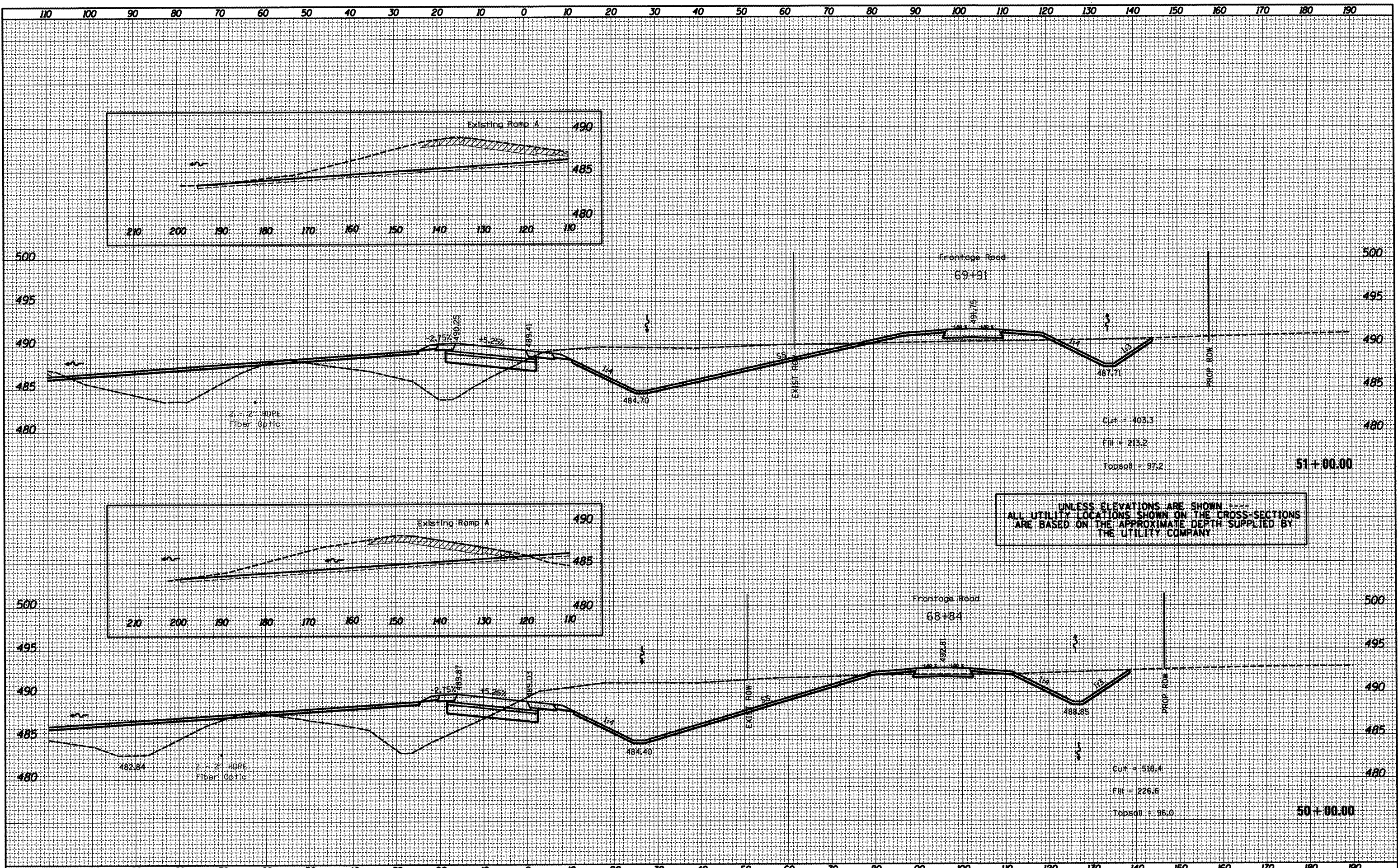

UNLESS ELEVATIONS ARE SHOWN ---
 ALL UTILITY LOCATIONS SHOWN ON THE CROSS-SECTIONS
 ARE BASED ON THE APPROXIMATE DEPTH SUPPLIED BY
 THE UTILITY COMPANY

FILE NAME = x0468475-new_topo2d.dgn	USER NAME = eversal	DESIGNED - DRAWN - CHECKED - DATE -	REVISED - REVISED - REVISED - REVISED -	STATE OF ILLINOIS DEPARTMENT OF TRANSPORTATION		PROPOSED CROSS SECTION RAMP D		F.A.P. RTE. 318	SECTION (72-6)R	COUNTY PEORIA	TOTAL SHEETS 117	SHEET NO. 76
PLOT SCALE = 20.0000' / 1" / 31.8				SCALE: SHEET OF SHEETS STA. 50+00.00 TO STA. 51+00.00				CONTRACT NO. 68A30				
PLOT DATE = 3/15/2012								ILLINOIS FED. AID PROJECT				