

DATE	
BY	
FINAL SURVEY	
SURVEYED	
PLOTTED	
TEMPLATE	
NOTE BOOK	
AREAS	
CHECKED	
NO.	

DATE	
BY	
ORIGINAL SURVEY	
SURVEYED	
PLOTTED	
TEMPLATE	
NOTE BOOK	
AREAS	
CHECKED	
NO.	

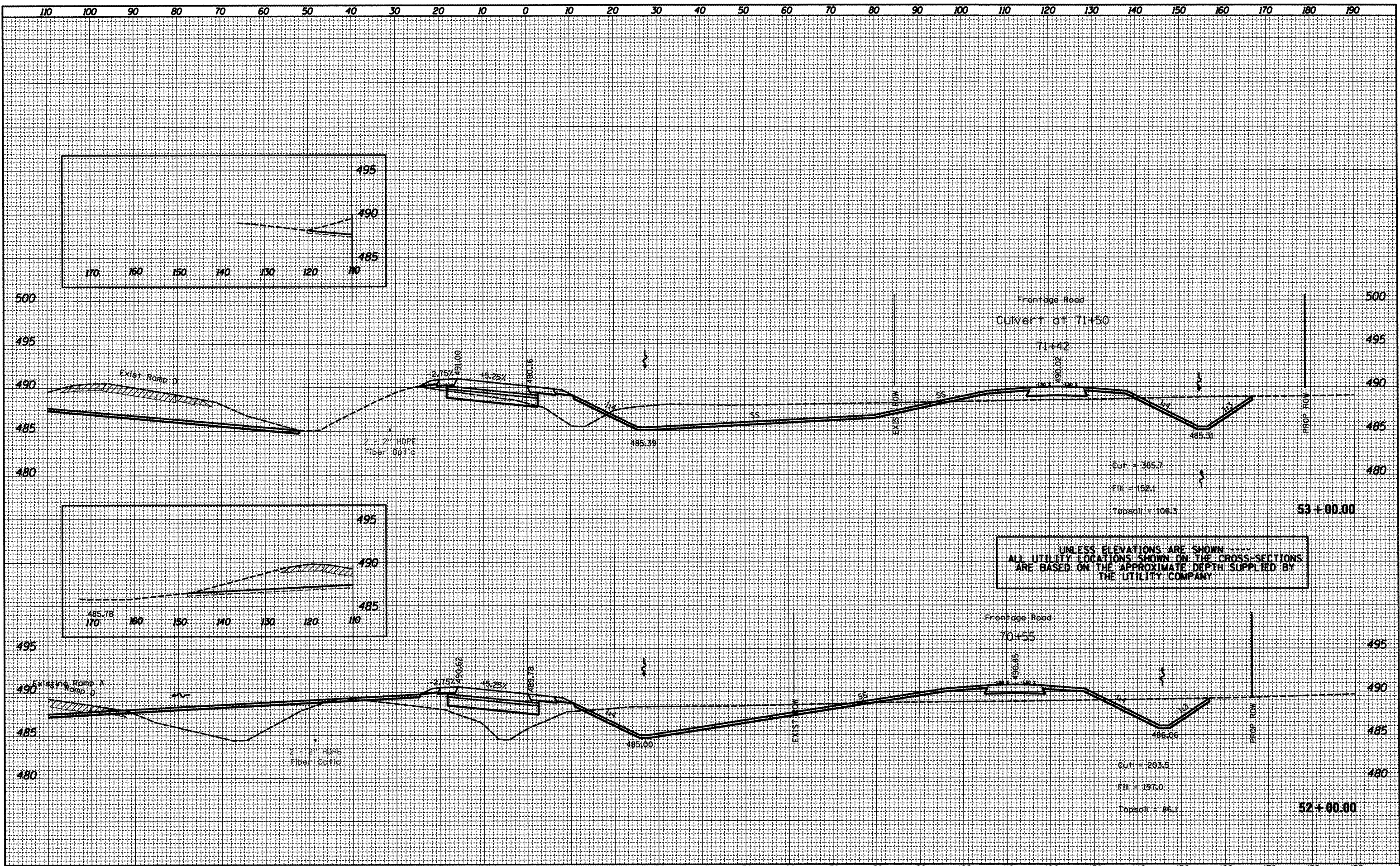

UNLESS ELEVATIONS ARE SHOWN
 ALL UTILITY LOCATIONS SHOWN ON THE CROSS-SECTIONS
 ARE BASED ON THE APPROXIMATE DEPTH SUPPLIED BY
 THE UTILITY COMPANY

FILE NAME = x:\D468475-new-topo2d.dgn	USER NAME = everest	DESIGNED -	REVISED -	STATE OF ILLINOIS DEPARTMENT OF TRANSPORTATION	PROPOSED CROSS SECTION RAMP D		F.A.P. RTE. 318	SECTION (72-6)R	COUNTY PEORIA	TOTAL SHEETS 117	SHEET NO. 77	
	PLOT SCALE = 20.0000' / 1" =	DRAWN -	REVISED -		SCALE:	SHEET	OF	SHEETS	STA. 52+00.00	TO STA. 53+00.00	CONTRACT NO. 68A30	
	PLOT DATE = 3/15/2012	CHECKED -	REVISED -		ILLINOIS FED. AID PROJECT							
		DATE -	REVISED -									