

Legend	
	Safety Zone
	Cone

Traffic Control Detail

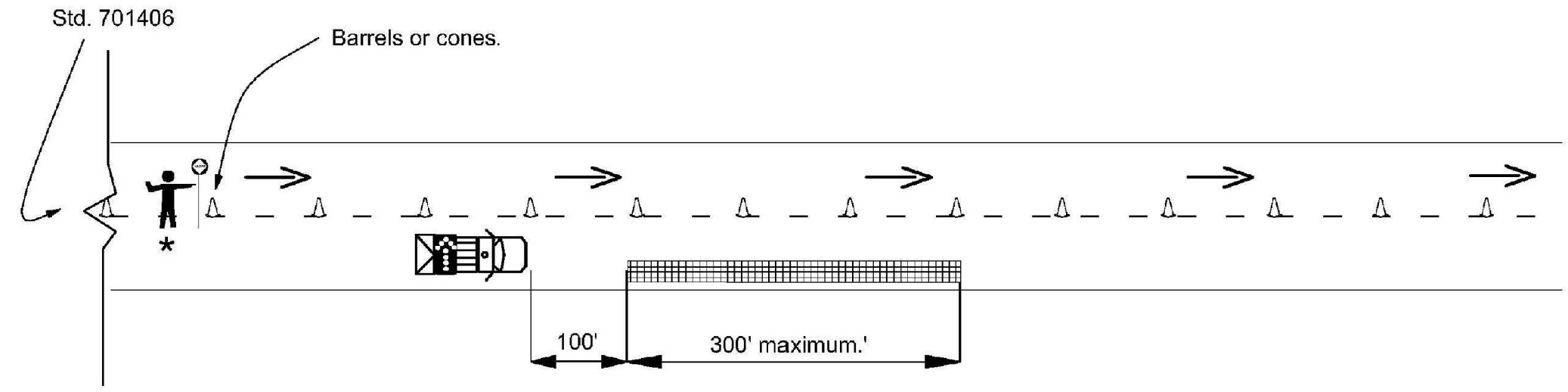

NOTES:

This detail shall be used when no means of escape, from an errant vehicle, exists. This includes work areas on the bridge and when there is a concrete wall on the shoulder or median of the closed lane.

Multiple attenuators may be necessary when the work area extends beyond 400' at one location or when additional crews working at an alternate location.

TIME RESTRICTIONS:

Lane reductions shall only be allowed from 8:30 a.m. to 3:30 p.m. Monday thru Friday. There shall be no time restrictions on weekends.

* = Shall not be required when workers are along shoulder. Vehicles and equipment may be in the closed lane but the predominant work must be near the shoulder to not warrant a flagger.

	= Attenuator truck with arrow board.
	= work area.

THE COST OF ATTENUATOR TRUCK SHALL BE INCLUDED IN THE BID PRICE FOR TRAFFIC CONTROL AND PROTECTION, STANDARDS 701406, 701421, AND 701602.