

F.A.P. RTE.	SECTION	COUNTY	TOTAL SHEETS	SHEET NO.
75	84-12: 11-3	•	729	139
STA. 100+00		TO STA. 115+00		
FED. ROAD DIST. NO. 5 ILLINOIS FED. AID PROJECT				
• SANGAMON AND CHRISTIAN				

ELIZABETH G. REISCH, (TRUSTEE)
UNDER THE ELIZABETH G. REISCH 1998 TRUST
PARCEL NO. 6041331

ELIZABETH G. REISCH, (TRUSTEE)
UNDER THE ELIZABETH G. REISCH 1998 TRUST
PARCEL NO. 6041331

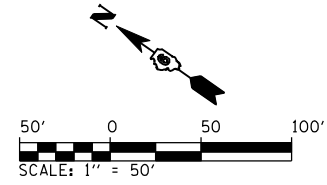

PLAN	SURVEYED	BY	DATE
	PLOTTED		
	CHECKED		
	BY		
	NO. OF WAY CHECKED		
	NO.		
	FILE NAME		

PROFILE	SURVEYED	BY	DATE
	PLOTTED		
	CHECKED		
	BY		
	NO. OF STRUCTURE		
	NO.		

PinProf5hts065
L:\1001\0306600\Draw\Sheet.s\Draw\Sheet.s\672829-sht-PinProf5hts030.dgn
3/16/2012

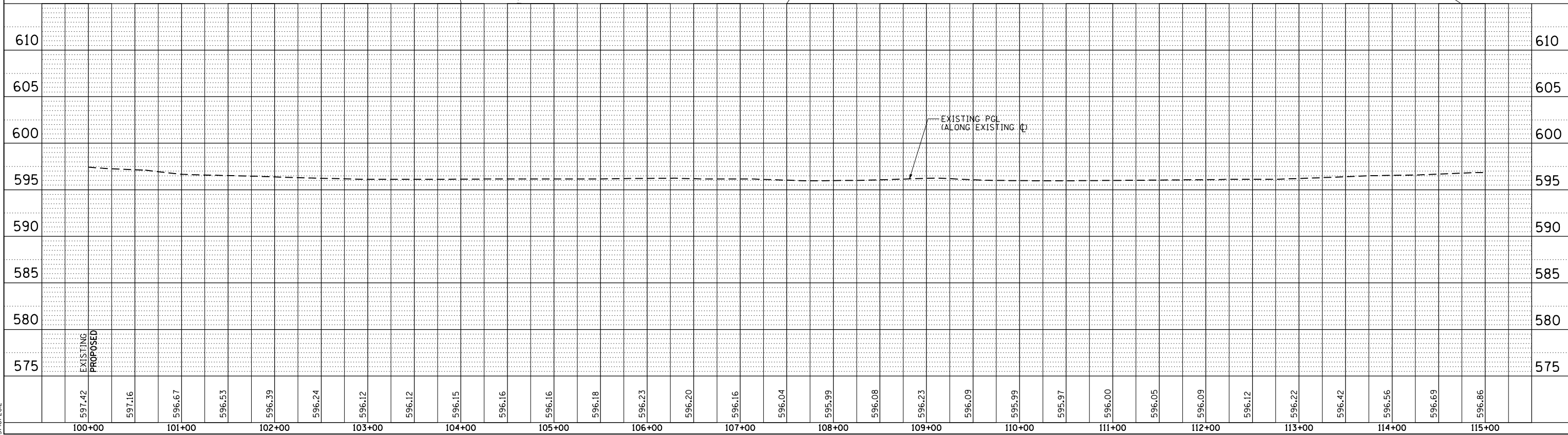
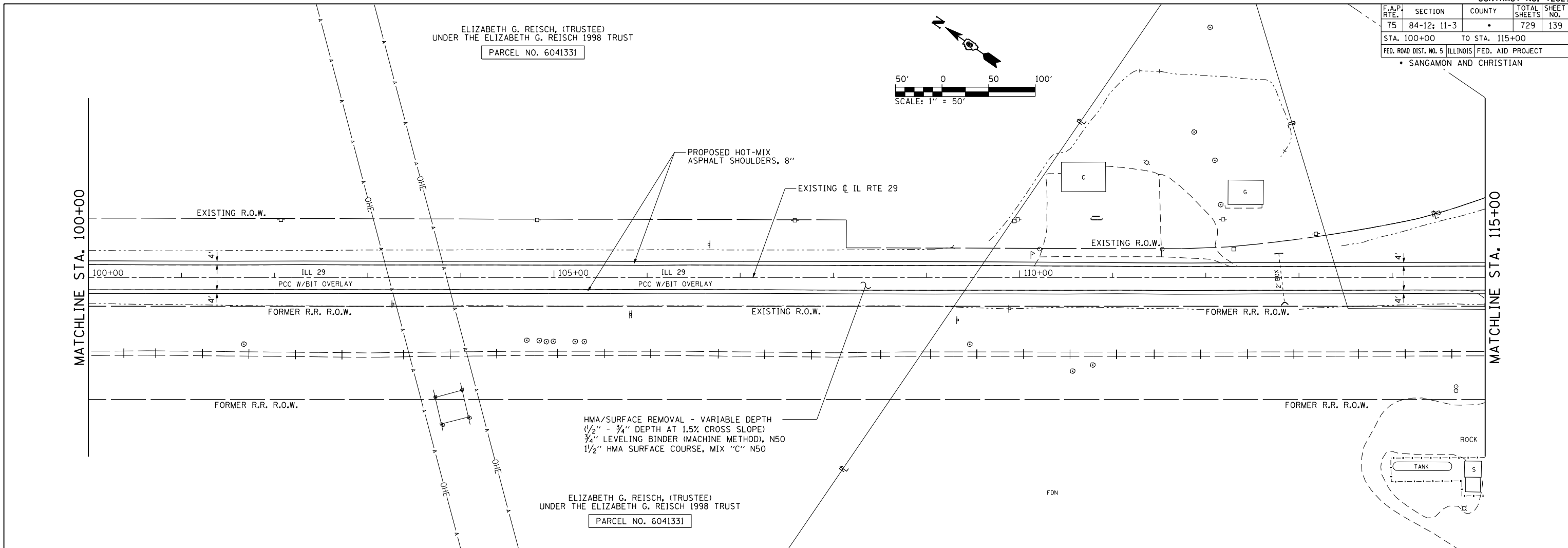

PLAN & PROFILE: EXISTING IL. RTE 29 - STA. 100+00 TO STA. 115+00