

F.A.P. RTE.	SECTION	COUNTY	TOTAL SHEETS	SHEET NO.
75	84-12: 11-3	•	729	140
STA. 115+00		TO STA. 130+00		
FED. ROAD DIST. NO. 5 (ILLINOIS) FED. AID PROJECT				
• SANGAMON AND CHRISTIAN				

ELIZABETH G. REISCH, (TRUSTEE)
 UNDER THE ELIZABETH G. REISCH 1998 TRUST
 PARCEL NO. 6041331

EDINBURG

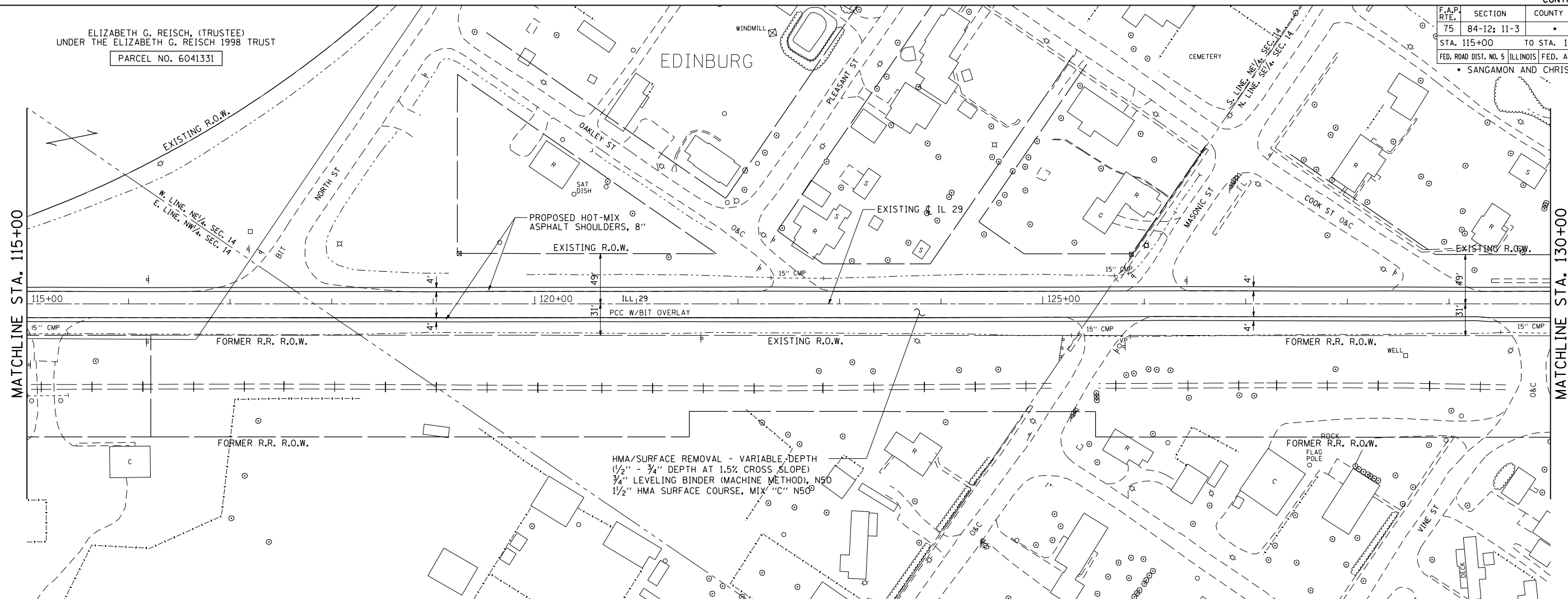

HMA/SURFACE REMOVAL - VARIABLE DEPTH
 (1/2" - 3/4" DEPTH AT 1.5% CROSS SLOPE)
 3/4" LEVELING BINDER (MACHINE METHOD), N50
 1 1/2" HMA SURFACE COURSE, MIX "C" N50

PLAN	SURVEYED	BY	DATE
NOTED			
CHECKED			
BY			
NO.			

PROFILE	SURVEYED	BY	DATE
NOTED			
CHECKED			
BY			
NO.			

PinProf5hts066
 L:\DOT\03066001.dwg sheet.s.d672829-sht-PinProf5hts030.dgn
 3/16/2012

