

F.A. RTE.	SECTION	COUNTY	TOTAL SHEETS	SHEET NO.
75	84-12: 11-3	•	729	162
STA. 122+00		TO STA. 182+00		
FED. ROAD DIST. NO. 5 ILLINOIS FED. AID PROJECT				
• SANGAMON AND CHRISTIAN				

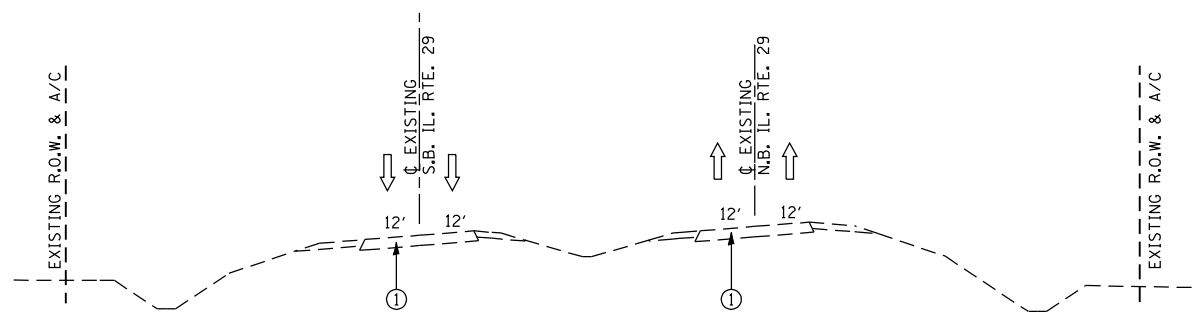

STAGE I, IL RTE 29 TYPICAL SECTION  
STA. 122+00 TO STA. 182+00  
① MAINTAIN NORTHBOUND & SOUTHBOUND TRAFFIC ON EXISTING LANES

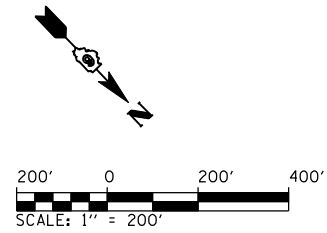
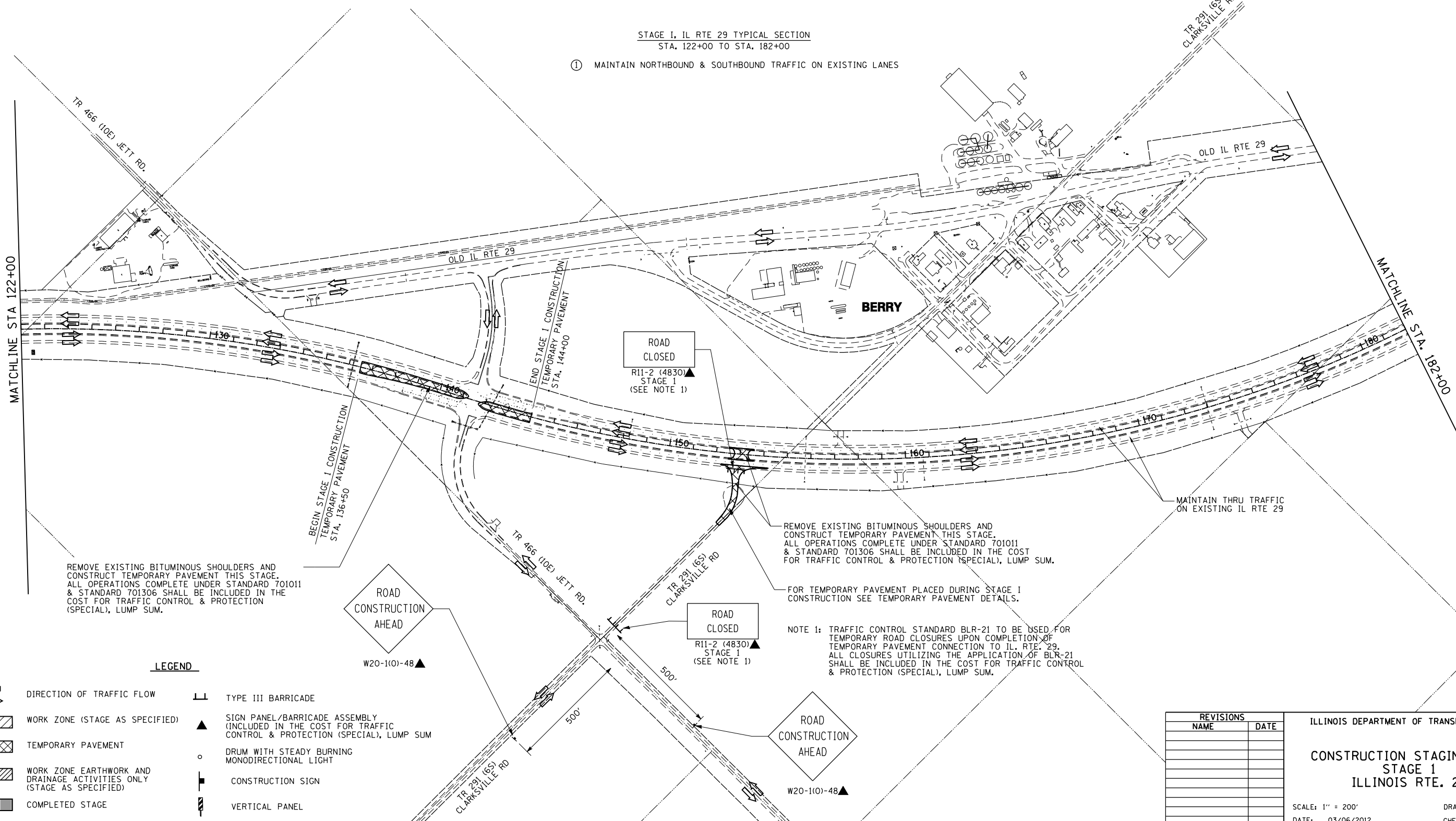

REMOVE EXISTING BITUMINOUS SHOULDERS AND CONSTRUCT TEMPORARY PAVEMENT THIS STAGE. ALL OPERATIONS COMPLETE UNDER STANDARD 701011 & STANDARD 701306 SHALL BE INCLUDED IN THE COST FOR TRAFFIC CONTROL & PROTECTION (SPECIAL), LUMP SUM.

REMOVE EXISTING BITUMINOUS SHOULDERS AND CONSTRUCT TEMPORARY PAVEMENT THIS STAGE. ALL OPERATIONS COMPLETE UNDER STANDARD 701011 & STANDARD 701306 SHALL BE INCLUDED IN THE COST FOR TRAFFIC CONTROL & PROTECTION (SPECIAL), LUMP SUM.

NOTE 1: TRAFFIC CONTROL STANDARD BLR-21 TO BE USED FOR TEMPORARY ROAD CLOSURES UPON COMPLETION OF TEMPORARY PAVEMENT CONNECTION TO IL. RTE. 29. ALL CLOSURES UTILIZING THE APPLICATION OF BLR-21 SHALL BE INCLUDED IN THE COST FOR TRAFFIC CONTROL & PROTECTION (SPECIAL), LUMP SUM.

**LEGEND**

- DIRECTION OF TRAFFIC FLOW
- WORK ZONE (STAGE AS SPECIFIED)
- TEMPORARY PAVEMENT
- WORK ZONE EARTHWORK AND DRAINAGE ACTIVITIES ONLY (STAGE AS SPECIFIED)
- COMPLETED STAGE
- TYPE III BARRICADE
- SIGN PANEL/BARRICADE ASSEMBLY (INCLUDED IN THE COST FOR TRAFFIC CONTROL & PROTECTION (SPECIAL), LUMP SUM)
- DRUM WITH STEADY BURNING MONODIRECTIONAL LIGHT
- CONSTRUCTION SIGN
- VERTICAL PANEL

REVISIONS	
NAME	DATE

ILLINOIS DEPARTMENT OF TRANSPORTATION  
**CONSTRUCTION STAGING PLAN  
STAGE 1  
ILLINOIS RTE. 29**  
SCALE: 1" = 200'  
DATE: 03/06/2012  
DRAWN BY: R.A.H.  
CHECKED BY: J.M.M.

Sheet 008  
L:\DOT\030601\Draw\Sheets\030601-sht-Cons\Stg\_AllSheets.dgn  
3/6/2012