

F.A. RTE.	SECTION	COUNTY	TOTAL SHEETS	SHEET NO.
75	84-12; 11-3	•	729	164
STA. 1380+00 TO STA. 1440+00				
FED. ROAD DIST. NO. 5 ILLINOIS FED. AID PROJECT				
• SANGAMON AND CHRISTIAN				

LEGEND

- TYPE III BARRICADE
- SIGN PANEL/BARRICADE ASSEMBLY (INCLUDED IN THE COST FOR TRAFFIC CONTROL & PROTECTION (SPECIAL), LUMP SUM)
- DRUM WITH STEADY BURNING MONODIRECTIONAL LIGHT
- CONSTRUCTION SIGN
- VERTICAL PANEL
- DIRECTION OF TRAFFIC FLOW
- WORK ZONE (STAGE AS SPECIFIED)
- TEMPORARY PAVEMENT
- WORK ZONE EARTHWORK AND DRAINAGE ACTIVITIES ONLY (STAGE AS SPECIFIED)
- COMPLETED STAGE

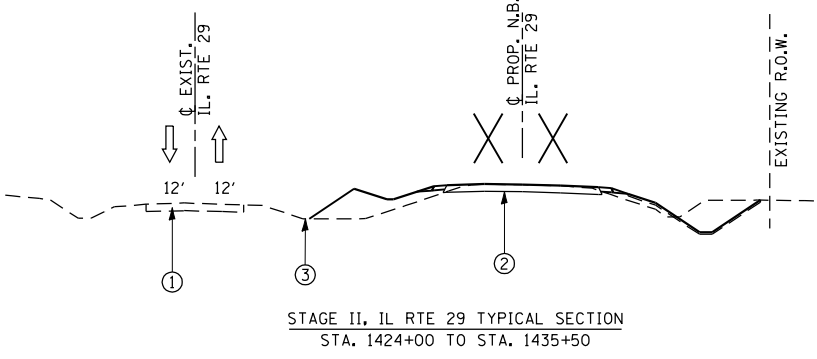
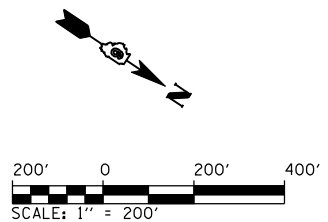

- ① MAINTAIN NORTHBOUND & SOUTHBOUND TRAFFIC ON EXISTING IL. RTE. 29 LANES
- ② PROPOSED CONSTRUCTION THIS STAGE - COMPLETE EARTHWORK, DRAINAGE, AND BITUMINOUS PAVEMENT, EXCLUDING FINAL SURFACE COURSE.
- ③ PROPOSED TEMPORARY DITCH

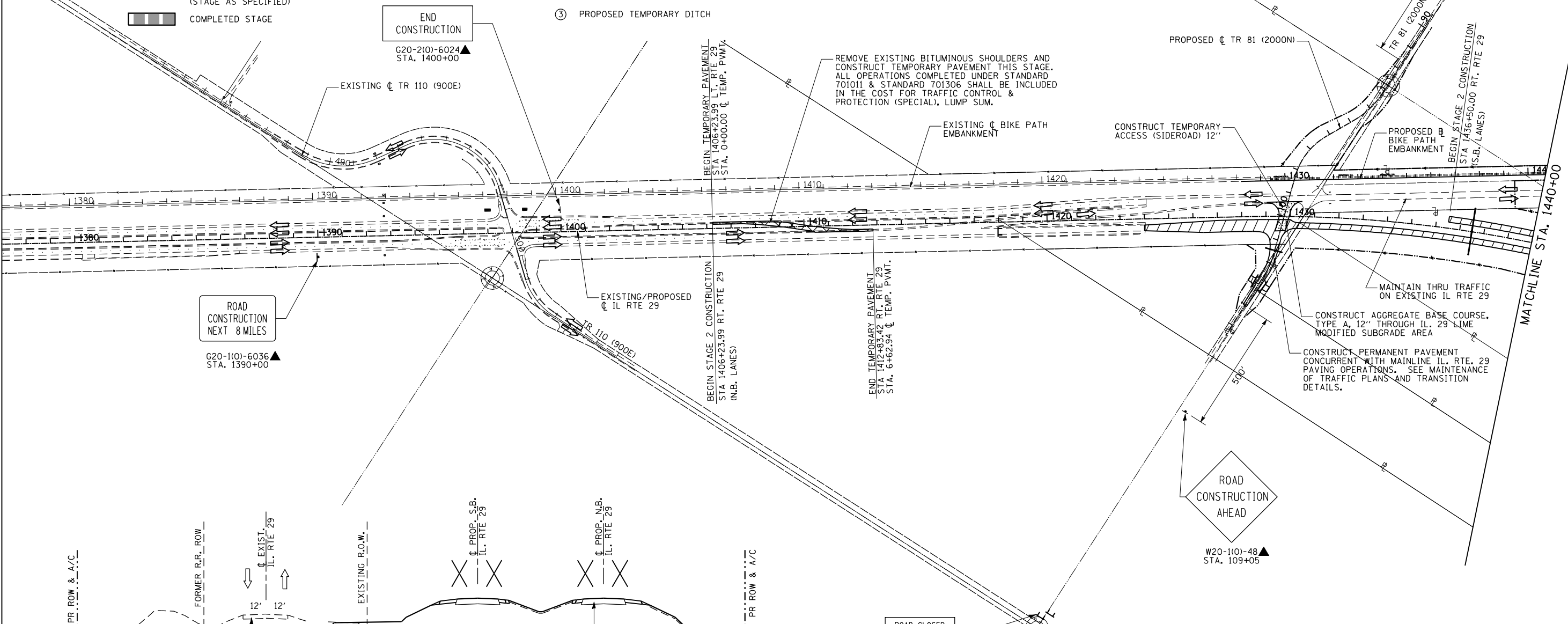

- ① MAINTAIN NORTHBOUND & SOUTHBOUND TRAFFIC ON EXISTING IL. RTE. 29 LANES
- ② PROPOSED CONSTRUCTION THIS STAGE - COMPLETE EARTHWORK, DRAINAGE, AND BITUMINOUS PAVEMENT, EXCLUDING FINAL SURFACE COURSE.
- ③ PROPOSED TEMPORARY DITCH

NOTE 1: TRAFFIC CONTROL STANDARD BLR-22 TO BE USED FOR TEMPORARY ROAD CLOSURE. ALL CLOSURES UTILIZING THE APPLICATION OF STANDARD BLR-22 SHALL BE INCLUDED IN THE COST FOR TRAFFIC CONTROL & PROTECTION (SPECIAL), LUMP SUM.

REVISIONS	
NAME	DATE

ILLINOIS DEPARTMENT OF TRANSPORTATION
**CONSTRUCTION STAGING PLAN
 STAGE 2
 ILLINOIS RTE. 29**
 SCALE: 1" = 200'
 DATE: 03/06/2012
 DRAWN BY: R.A.H.
 CHECKED BY: J.M.M.

Sheet 001
 L:\DOT\030601\Draw\Sheets\030601\Draw\72829-snt-ConStg2-AllSheets.dgn
 3/6/2012