

F.A. RTE.	SECTION	COUNTY	TOTAL SHEETS	SHEET NO.
75	84-12: 11-3	•	729	168
STA. 1615+00		TO STA. 10+00		
FED. ROAD DIST. NO. 5 ILLINOIS FED. AID PROJECT				
• SANGAMON AND CHRISTIAN				

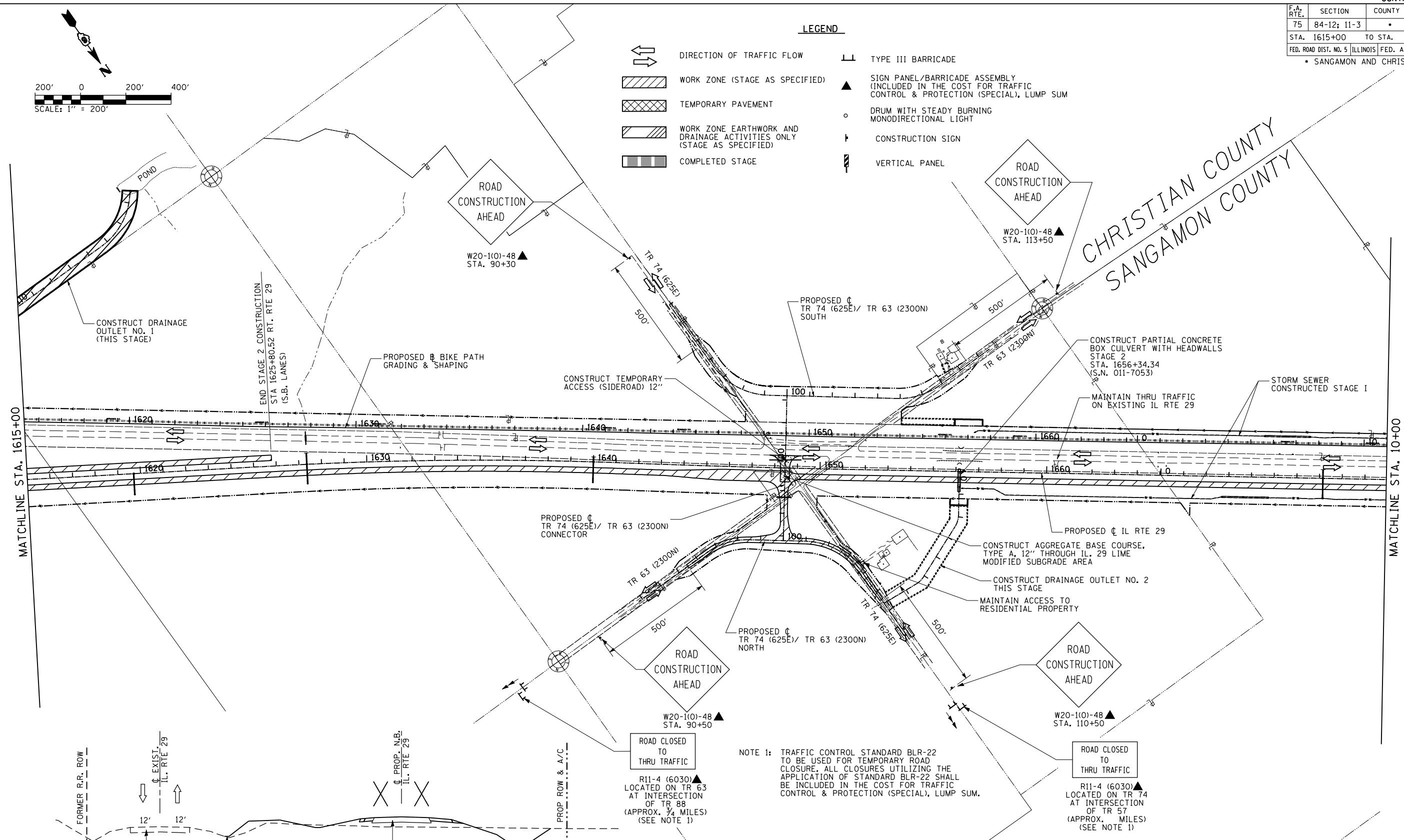

LEGEND

- DIRECTION OF TRAFFIC FLOW
- WORK ZONE (STAGE AS SPECIFIED)
- TEMPORARY PAVEMENT
- WORK ZONE EARTHWORK AND DRAINAGE ACTIVITIES ONLY (STAGE AS SPECIFIED)
- COMPLETED STAGE
- TYPE III BARRICADE
- SIGN PANEL/BARRICADE ASSEMBLY (INCLUDED IN THE COST FOR TRAFFIC CONTROL & PROTECTION (SPECIAL), LUMP SUM)
- DRUM WITH STEADY BURNING MONODIRECTIONAL LIGHT
- CONSTRUCTION SIGN
- VERTICAL PANEL



NOTE 1: TRAFFIC CONTROL STANDARD BLR-22 TO BE USED FOR TEMPORARY ROAD CLOSURE. ALL CLOSURES UTILIZING THE APPLICATION OF STANDARD BLR-22 SHALL BE INCLUDED IN THE COST FOR TRAFFIC CONTROL & PROTECTION (SPECIAL), LUMP SUM.

- STAGE II, IL RTE 29 TYPICAL SECTION**
STA. 1625+80.52 TO STA. 10+00
- ① MAINTAIN NORTHBOUND & SOUTHBOUND TRAFFIC ON EXISTING IL. RTE. 29 LANES
 - ② PROPOSED CONSTRUCTION THIS STAGE - COMPLETE EARTHWORK, DRAINAGE, AND BITUMINOUS PAVEMENT, EXCLUDING FINAL SURFACE COURSE.
 - ③ CONSTRUCT PROPOSED 18" STORM SEWER, RT. & LT. (STAGE 1)
 - ④ PROPOSED TEMPORARY DITCH

REVISIONS	
NAME	DATE

ILLINOIS DEPARTMENT OF TRANSPORTATION
CONSTRUCTION STAGING PLAN
STAGE 2
ILLINOIS RTE. 29
SCALE: 1" = 200'
DATE: 03/06/2012
DRAWN BY: R.A.H.
CHECKED BY: J.M.M.

Sheet 005
L:\DOT\030601\Draw\Sheets\030601.dwg
3/6/2012