

F.A. RTE.	SECTION	COUNTY	TOTAL SHEETS	SHEET NO.
75	84-12; 11-3	•	729	175
STA. 1440+00 TO STA. 1495+00				
FED. ROAD DIST. NO. 5 ILLINOIS FED. AID PROJECT				
• SANGAMON AND CHRISTIAN				

STAGE III, IL RTE 29 TYPICAL SECTION
STA. 1440+00 TO STA. 1495+00

- ① PROPOSED CONSTRUCTION THIS STAGE - COMPLETE EARTHWORK, DRAINAGE, AND BITUMINOUS PAVEMENT, EXCLUDING FINAL SURFACE COURSE.
- ② PROPOSED BIKE PATH EMBANKMENT FOR STA. 1440+00 TO STA. 1458+56.61
- Ⓐ TEMPORARY DOUBLE 5" SOLID YELLOW PAVEMENT MARKING LINE (SEE MOT PLANS FOR EXACT LOCATIONS)
- Ⓑ TEMPORARY 5" SOLID WHITE PAVEMENT MARKING LINE (SEE MOT PLANS FOR EXACT LOCATIONS)

NOTE 2: TRAFFIC CONTROL STANDARD BLR-22 TO BE USED FOR TEMPORARY ROAD CLOSURE. ALL CLOSURES UTILIZING THE APPLICATION OF STANDARD BLR-22 SHALL BE INCLUDED IN THE COST FOR TRAFFIC CONTROL & PROTECTION (SPECIAL), LUMP SUM.

NOTE 1: TRAFFIC CONTROL STANDARD BLR-21 TO BE USED FOR TEMPORARY ROAD CLOSURE. ALL CLOSURES UTILIZING THE APPLICATION OF STANDARD BLR-21 SHALL BE INCLUDED IN THE COST FOR TRAFFIC CONTROL & PROTECTION (SPECIAL), LUMP SUM.

POST STAGE 3: CONSTRUCT HMA SHOULDERS, OVERLAY, GUARDRAIL & PAVEMENT MARKING ALONG EXISTING IL 29 THIS STAGE USING HIGHWAY STANDARDS, 701201, 701306, 701326, 701336, 701311 INCLUDED IN THE COST FOR TRAFFIC CONTROL & PROTECTION (SPECIAL), LUMP SUM

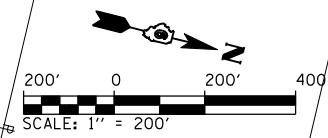
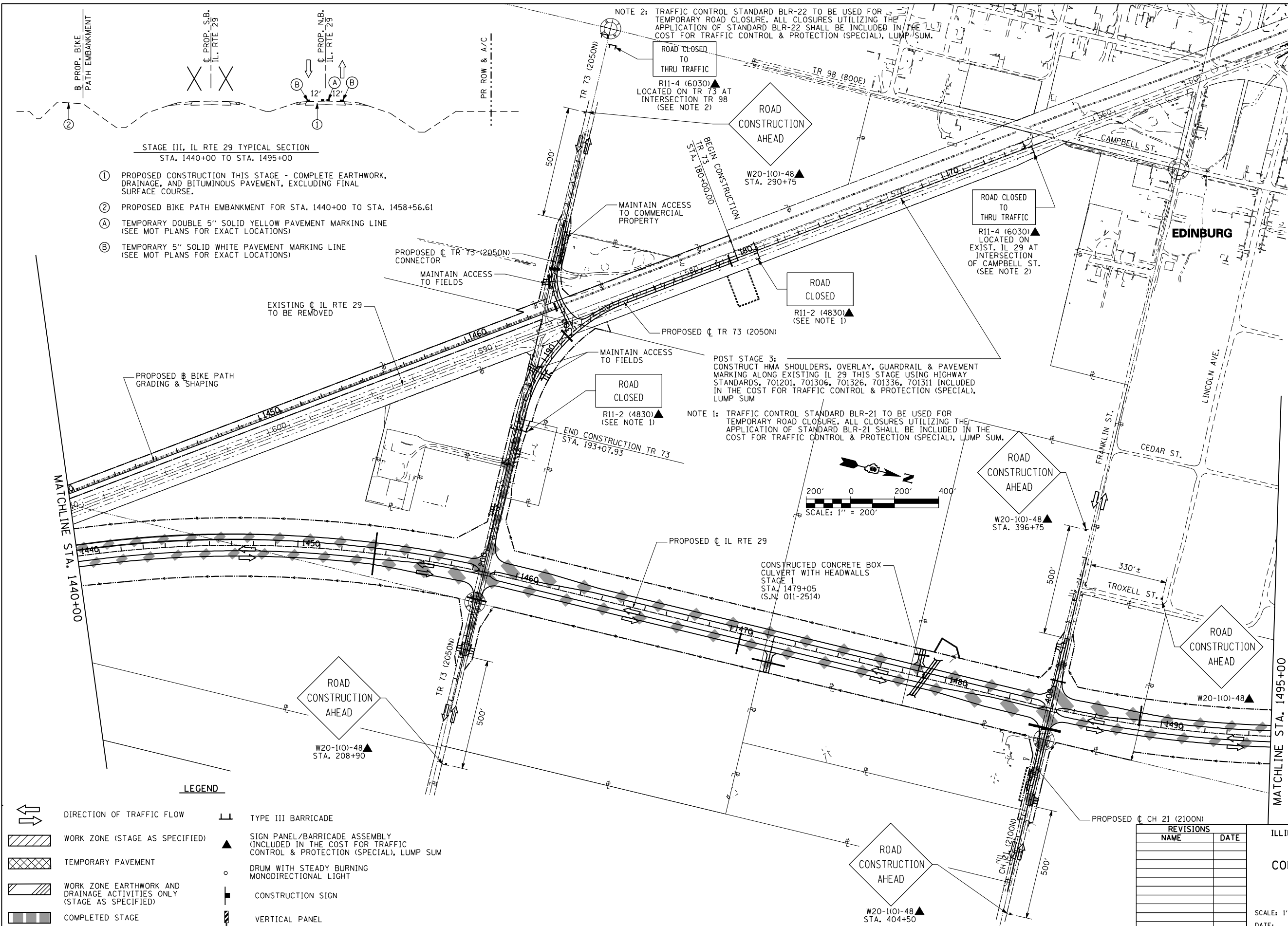

LEGEND

- DIRECTION OF TRAFFIC FLOW
- WORK ZONE (STAGE AS SPECIFIED)
- TEMPORARY PAVEMENT
- WORK ZONE EARTHWORK AND DRAINAGE ACTIVITIES ONLY (STAGE AS SPECIFIED)
- COMPLETED STAGE
- TYPE III BARRICADE
- SIGN PANEL/BARRICADE ASSEMBLY (INCLUDED IN THE COST FOR TRAFFIC CONTROL & PROTECTION (SPECIAL), LUMP SUM)
- DRUM WITH STEADY BURNING MONODIRECTIONAL LIGHT
- CONSTRUCTION SIGN
- VERTICAL PANEL

REVISIONS	
NAME	DATE

ILLINOIS DEPARTMENT OF TRANSPORTATION
**CONSTRUCTION STAGING PLAN
 STAGE 3
 ILLINOIS RTE. 29**
 SCALE: 1" = 200'
 DATE: 03/06/2012
 DRAWN BY: R.A.H.
 CHECKED BY: J.M.M.

Sheet 002
L:\D01\030601\Draw\Sheets\0672829-sht-ConStg3-AllSheets.dgn
3/23/2012