

F.A. RTE.	SECTION	COUNTY	TOTAL SHEETS	SHEET NO.
75	84-12: 11-3	•	729	180
STA. 62+00 TO STA. 122+00		FED. ROAD DIST. NO. 5 ILLINOIS FED. AID PROJECT		
• SANGAMON AND CHRISTIAN				

NOTE: MAINTAIN TEMPORARY SIGNAGE UNTIL COMPLETION OF CONTRACT AND PERMANENT SIGNAGE IS INSTALLED.

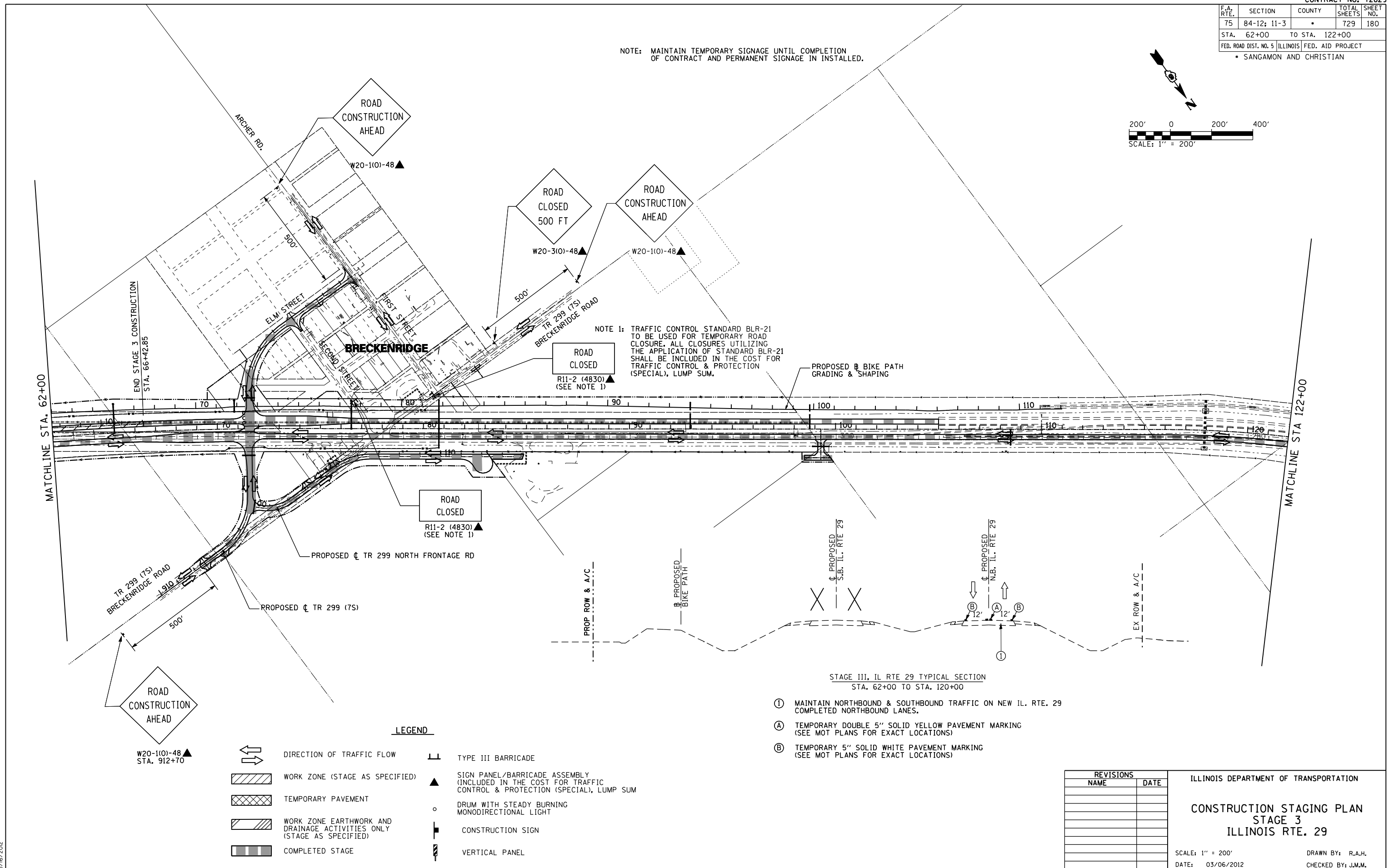
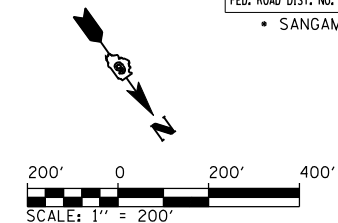

NOTE 1: TRAFFIC CONTROL STANDARD BLR-21 TO BE USED FOR TEMPORARY ROAD CLOSURE. ALL CLOSURES UTILIZING THE APPLICATION OF STANDARD BLR-21 SHALL BE INCLUDED IN THE COST FOR TRAFFIC CONTROL & PROTECTION (SPECIAL), LUMP SUM.

STAGE III, IL RTE 29 TYPICAL SECTION
STA. 62+00 TO STA. 120+00

- ① MAINTAIN NORTHBOUND & SOUTHBOUND TRAFFIC ON NEW IL. RTE. 29 COMPLETED NORTHBOUND LANES.
- Ⓐ TEMPORARY DOUBLE 5" SOLID YELLOW PAVEMENT MARKING (SEE MOT PLANS FOR EXACT LOCATIONS)
- Ⓑ TEMPORARY 5" SOLID WHITE PAVEMENT MARKING (SEE MOT PLANS FOR EXACT LOCATIONS)

LEGEND

- DIRECTION OF TRAFFIC FLOW
- WORK ZONE (STAGE AS SPECIFIED)
- TEMPORARY PAVEMENT
- WORK ZONE EARTHWORK AND DRAINAGE ACTIVITIES ONLY (STAGE AS SPECIFIED)
- COMPLETED STAGE
- TYPE III BARRICADE
- SIGN PANEL/BARRICADE ASSEMBLY (INCLUDED IN THE COST FOR TRAFFIC CONTROL & PROTECTION (SPECIAL), LUMP SUM)
- DRUM WITH STEADY BURNING MONODIRECTIONAL LIGHT
- CONSTRUCTION SIGN
- VERTICAL PANEL

REVISIONS	
NAME	DATE

ILLINOIS DEPARTMENT OF TRANSPORTATION
**CONSTRUCTION STAGING PLAN
STAGE 3
ILLINOIS RTE. 29**
SCALE: 1" = 200'
DATE: 03/06/2012
DRAWN BY: R.A.H.
CHECKED BY: J.M.M.

Sheet 007
L:\DOT\030601\Draw\Sheets\030601.dwg
3/6/2012