

F.A. RTE.	SECTION	COUNTY	TOTAL SHEETS	SHEET NO.
75	84-12; 11-3		729	261
STA. 93+56.31 TO STA. 106+05.38				
FED. ROAD DIST. NO. 5 ILLINOIS FED. AID PROJECT				
• SANGAMON AND CHRISTIAN				

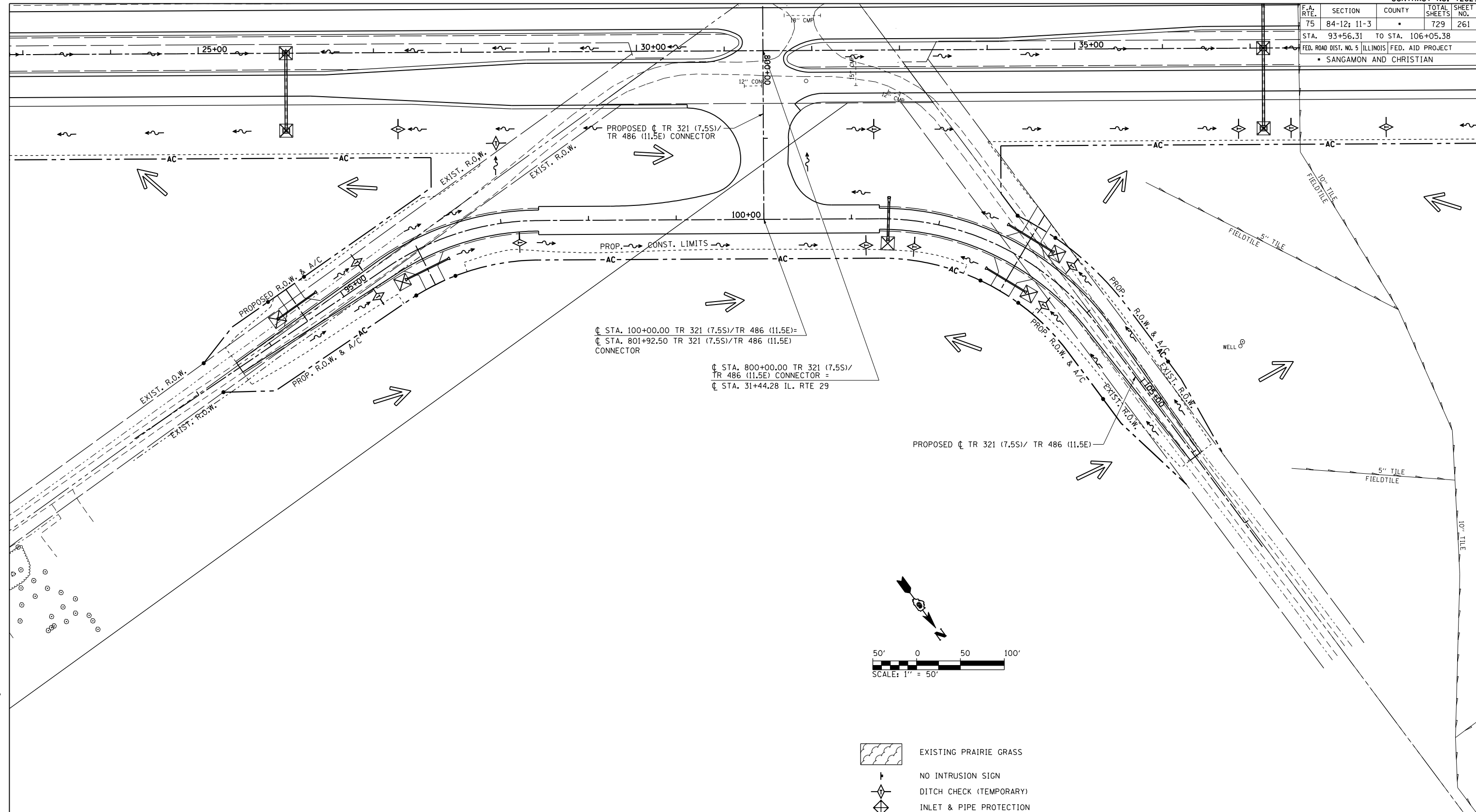

Q STA. 100+00.00 TR 321 (7.5S)/TR 486 (11.5E) =
 Q STA. 801+92.50 TR 321 (7.5S)/TR 486 (11.5E)
 CONNECTOR

 Q STA. 800+00.00 TR 321 (7.5S)/
 TR 486 (11.5E) CONNECTOR =
 Q STA. 31+44.28 IL. RTE 29

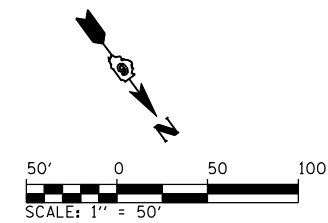

- EXISTING PRAIRIE GRASS
- NO INTRUSION SIGN
- DITCH CHECK (TEMPORARY)
- INLET & PIPE PROTECTION
- SEDIMENT BASIN
- PERIMETER EROSION BARRIER
- TEMPORARY FENCE

NOTE: ALL DITCHES CONSTRUCTED TO FINAL CROSS SECTION SHALL BE STABILIZE WITH EROSION CONTROL BLANKET & FINAL SEEDING

REVISIONS	
NAME	DATE

ILLINOIS DEPARTMENT OF TRANSPORTATION

STORM WATER POLLUTION PREVENTION PLAN
 TR 321 (7.5 S) - TR 486 (11.5 E)

SCALE: 1" = 50'
 DATE: 03/06/2012

DRAWN BY: R.A.H.
 CHECKED BY: J.M.M.

SWPPP_026
 L:\DOT\0306601\Draw\Drawings\SWPPP_026\TR321-486.dgn
 3/28/2012