

F.A. RTE.	SECTION	COUNTY	TOTAL SHEETS	SHEET NO.
75	84-12; 11-3		729	355
STA.	N/A	TO STA.	N/A	
FED. ROAD DIST. NO. 5 ILLINOIS FED. AID PROJECT				
• SANGAMON AND CHRISTIAN				

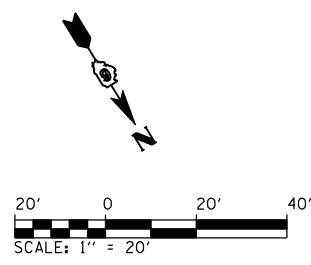

- 1 STA. 1585+92.83, 61.00' LT.
- 2 STA. 598+85.00, 31.00' RT. (TR 88)
- 3 STA. 598+60.00, 25.00' RT. (TR 88)

- PR MEDIAN RADIUS POINTS
- (N) STA. 1585+93.05, 25.00' LT.
  - (O) STA. 1586+26.57, 15.70' LT.
  - (P) STA. 1586+26.97, 1.19' RT.
  - (Q) STA. 1585+88.05, 13.00' RT.

- PR 2-CC RADIUS POINTS
- (A) STA. 1584+94.37, 49.00' LT.
  - (B) STA. 1585+95.64, 61.70' LT.
  - (C) STA. 598+85.00, 21.00' RT. (TR 88)

- PR 3-CC  
160' - 60' - 640'  
Ø1 = 1'  
Ø2 = 10'

- PR 3-CC RADIUS POINTS
- (D) STA. 597+70.76, 21.00' LT. (TR 88)
  - (E) STA. 598+89.09, 32.03' LT. (TR 88)
  - (F) STA. 1587+40.59, 62.60' LT.
  - (G) STA. 1587+63.16, 61.00' LT.

- 4 STA. 1587+00.03, 61.00' RT.
- 5 STA. 601+07.57, 28.00' LT. (TR 88)
- 6 STA. 601+32.40, 21.28' LT. (TR 88)

- PR MEDIAN RADIUS POINTS
- (R) STA. 1587+33.05, 13.00' LT.
  - (S) STA. 1586+94.98, 2.62' LT.
  - (T) STA. 1586+94.98, 14.62' RT.
  - (U) STA. 1587+33.05, 25.00' RT.

- PR 3-CC RADIUS POINTS
- (J) STA. 1585+56.59, 61.00' RT.
  - (K) STA. 1585+79.78, 62.50' RT.
  - (L) STA. 601+09.05, 27.41' RT. (TR 88)
  - (M) STA. 601+89.21, 15.67' RT. (TR 88)

PROP. TR 88 CURVE-3 DATA  
 PI STA. = 602+56.99  
 Δ = 33° 06' 17" (LT)  
 D = 20° 32' 44"  
 R = 278.87'  
 T = 82.88'  
 L = 161.13'  
 E = 12.06'  
 e = 4.0%  
 T.R. = 48.75'  
 S.E. RUN = 130.00'  
 P.C. STA = 601+74.11  
 P.T. STA = 603+35.23

NOTE: SEE ALIGNMENT SHEETS FOR Ç ALIGNMENT DATA

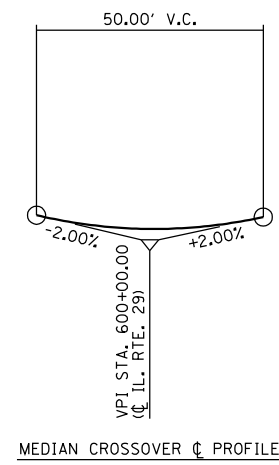

REVISIONS	
NAME	DATE

ILLINOIS DEPARTMENT OF TRANSPORTATION

INTERSECTION DETAIL  
 IL. RTE. 29 / TR 88 (725E)

SCALE: 1" = 20'  
 DATE: 03/06/2012

DRAWN BY: B.M.B.  
 CHECKED BY: J.M.M.

INTERSECTION DETAIL: IL. RTE. 29 / TR 88 (725E)

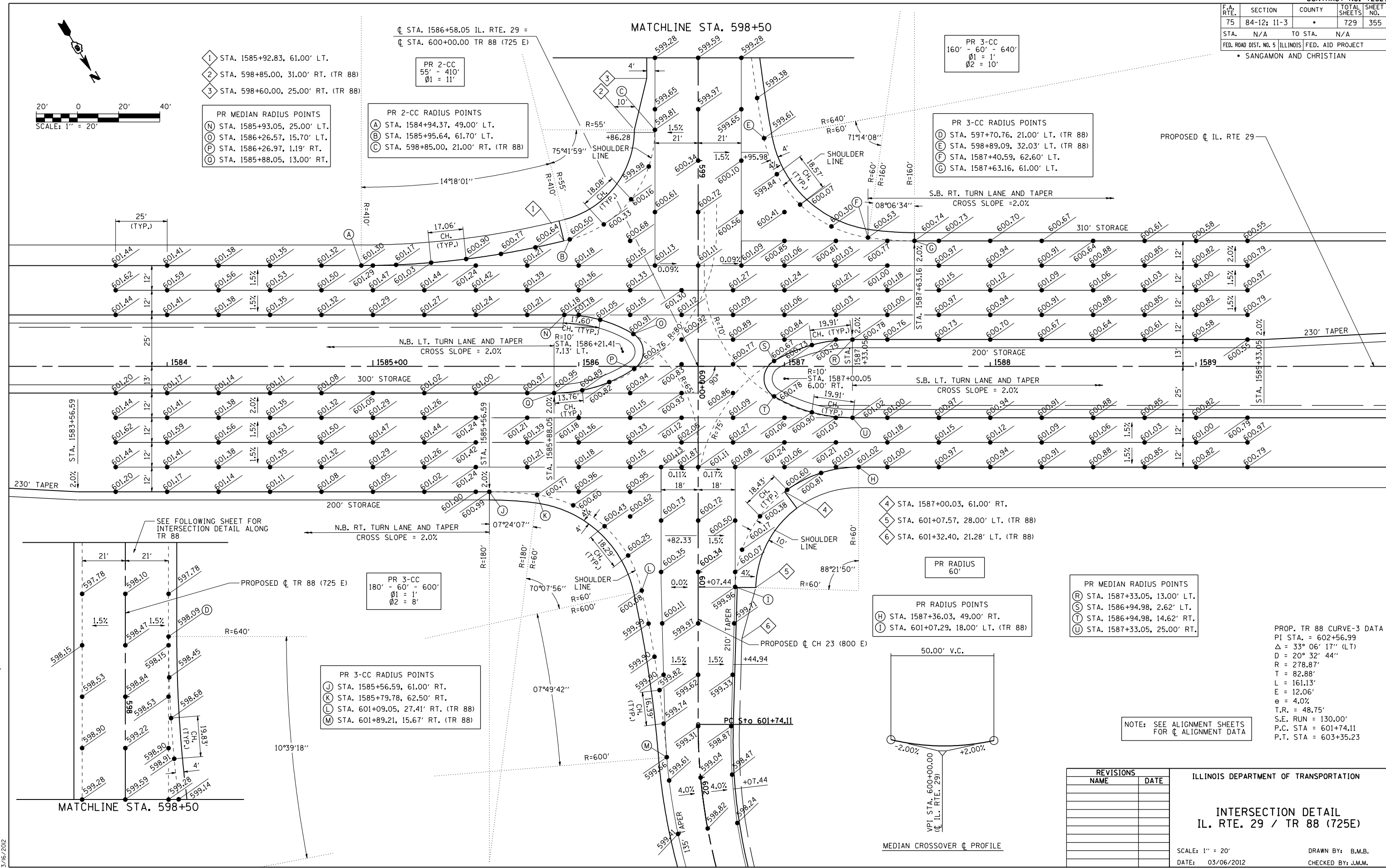

Default L:\DOT\030601\Draw\Sheets\030601\Draw\IntSec\DeTR88.cdw  
 3/6/2012