

F.A. RTE.	SECTION	COUNTY	TOTAL SHEETS	SHEET NO.
75	84-12; 11-3	•	729	359
STA.	N/A	TO STA.	N/A	
FED. ROAD DIST. NO. 5 ILLINOIS FED. AID PROJECT				
• SANGAMON AND CHRISTIAN				

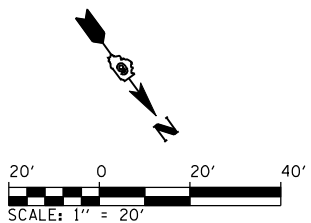

- PR MEDIAN RADIUS POINTS
- (A) STA. 30+54.28, 25.00' LT.
 - (B) STA. 31+03.58, 10.30' LT.
 - (C) STA. 31+02.08, 7.25' LT.
 - (D) STA. 30+74.28, 13.00' RT.

- PR MEDIAN RADIUS POINTS
- (E) STA. 32+14.28, 13.00' LT.
 - (F) STA. 31+86.49, 7.25' LT.
 - (G) STA. 31+84.99, 10.30' RT.
 - (H) STA. 32+34.28, 25.00' RT.

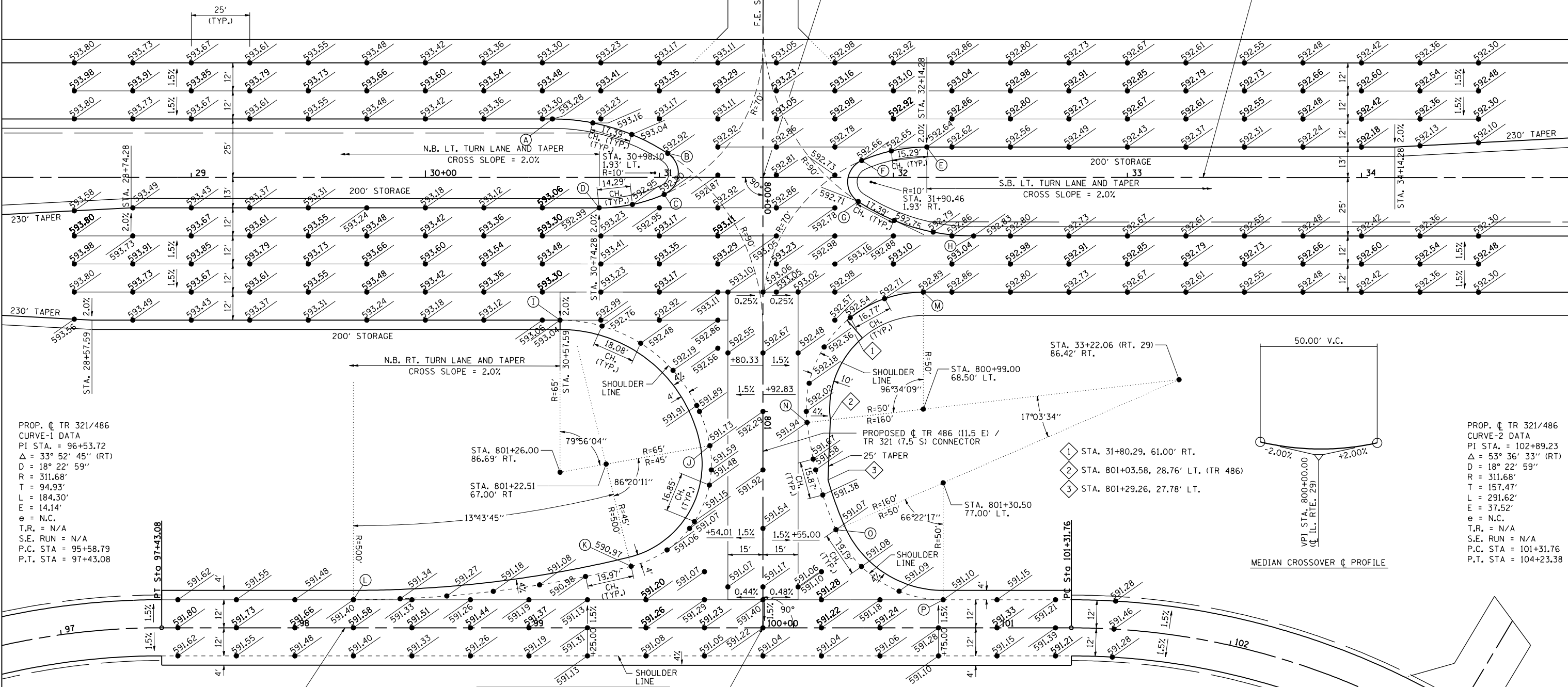

PROP. \dot{C} TR 321/486
 CURVE-1 DATA
 PI STA. = 96+53.72
 Δ = 33° 52' 45" (RT)
 D = 18° 22' 59"
 R = 311.68'
 T = 94.93'
 L = 184.30'
 E = 14.14'
 e = N.C.
 T.R. = N/A
 S.E. RUN = N/A
 P.C. STA = 95+58.79
 P.T. STA = 97+43.08

PROP. \dot{C} TR 321/486
 CURVE-2 DATA
 PI STA. = 102+89.23
 Δ = 53° 36' 33" (RT)
 D = 18° 22' 59"
 R = 311.68'
 T = 157.47'
 L = 291.62'
 E = 37.52'
 e = N.C.
 T.R. = N/A
 S.E. RUN = N/A
 P.C. STA = 101+31.76
 P.T. STA = 104+23.38

PR 3-CC
 65' - 45' - 500'

- PR 3-CC RADIUS POINTS
- (I) STA. 30+57.59, 61.00' RT.
 - (J) STA. 801+14.64, 22.69' RT. (TR 486)
 - (K) STA. 99+43.68, 26.29' LT. (TR 321)
 - (L) STA. 98+25.01, 12.00' LT. (TR 321)

- PR 3-CC RADIUS POINTS
- (M) STA. 32+12.78, 49.00' RT.
 - (N) STA. 801+04.72, 18.83' RT. (TR 486)
 - (O) STA. 801+50.55, 31.19' LT. (TR 486)
 - (P) STA. 100+77.00, 12.00' LT. (TR 321)

PR 3-CC
 50' - 160' - 50'

REVISIONS	
NAME	DATE

ILLINOIS DEPARTMENT OF TRANSPORTATION

**INTERSECTION DETAIL IL. RTE. 29
 /TR 486 (11.5E) - TR 321 (7.5S)**

SCALE: 1" = 20'
 DATE: 03/06/2012

DRAWN BY: B.M.B.
 CHECKED BY: J.M.M.

Default
 L:\DOT\030601\Draw\Sheets\030601\Draw\IntSec\Det\TR486_321.cdw
 4/23/2012