

F.A.P. RTE.	SECTION	COUNTY	TOTAL SHEETS	SHEET NO.
75	84-12; 11-3		729	378
STA. 1553+00		TO STA. 1583+00		
FED. ROAD DIST. NO. 5 ILLINOIS FED. AID PROJECT				
• SANGAMON AND CHRISTIAN				

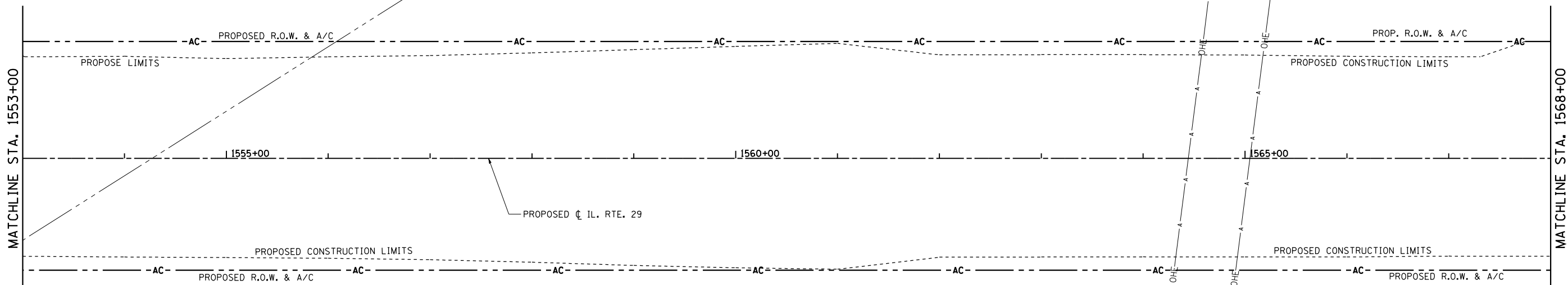

**REMOVAL LEGEND**

- |   |   |  |   |
|---|---|--|---|
|   | ILLINOIS NATIVE PRARIE GRASS  |  | EXISTING OIL & CHIP PAVEMENT TO BE REMOVED. COST INCLUDED IN EARTH EXCAVATION |
|   | PAVEMENT REMOVAL  |  | GRAVEL DRIVEWAY REMOVAL. COST INCLUDED IN EARTH EXCAVATION.                   |
|   | PAVEMENT BREAKING IN ACCORDANCE WITH ARTICLE 205.03. COST INCLUDED IN EMBANKMENT. |  | PAVED SHOULDER REMOVAL  |
|   | TREE REMOVAL ACRES  |  | HMA SURFACE REMOVAL   |
| X | TREE REMOVAL (UNITS)  |  |   |

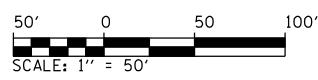
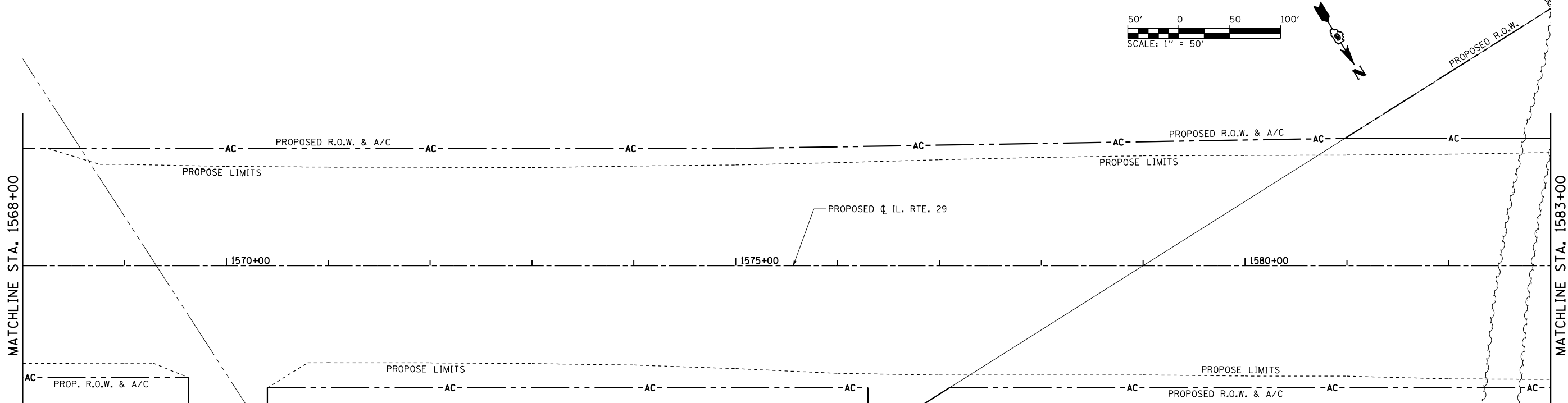
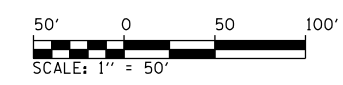

REVISIONS	
NAME	DATE

ILLINOIS DEPARTMENT OF TRANSPORTATION

**REMOVAL PLAN**  
IL. RTE 29

SCALE: 1" = 50'  
DATE: 03/06/2012

DRAWN BY: R.A.H.  
CHECKED BY: J.M.M.

Default: Li:\D01\0306601\Draw\Sheets\D672829-sht-REM\_006.dgn 4/23/2012