

F.A. RTE.	SECTION	COUNTY	TOTAL SHEETS	SHEET NO.
75	84-12; 11-3		729	437
STA. 122+00.00 TO STA. 152+00.00				
FED. ROAD DIST. NO. 5 ILLINOIS FED. AID PROJECT				
SANGAMON AND CHRISTIAN				

LEGEND

- ① GROOVED IN URETHANE PAVEMENT MARKING - LINE 5"
- ② PREFORMED PLASTIC PAVEMENT MARKING, TYPE B - INLAID - LINE 5"
- ③ PREFORMED PLASTIC PAVEMENT MARKING, TYPE B - INLAID - LINE 6"
- ④ PREFORMED PLASTIC PAVEMENT MARKING, TYPE B - INLAID - LINE 8"
- ⑤ PREFORMED PLASTIC PAVEMENT MARKING, TYPE B - INLAID - LINE 12"
- ⑥ PREFORMED PLASTIC PAVEMENT MARKING, TYPE B - INLAID - LINE 24"
- ⑦ PREFORMED PLASTIC PAVEMENT MARKING, TYPE B - INLAID - LETTERS & SYMBOLS
- ⑧ PAINT PAVEMENT MARKING - LINE 5"
- ◊ RAISED REFLECTIVE PAVEMENT MARKER (ONE-WAY CRYSTAL)
- ◊ RAISED REFLECTIVE PAVEMENT MARKER (ONE-WAY AMBER)
- ◊ RAISED REFLECTIVE PAVEMENT MARKER (TWO-WAY AMBER)
- ↑ PROPOSED SIGN PANEL AND POST
- ↓ EXISTING SIGN PANEL AND POST

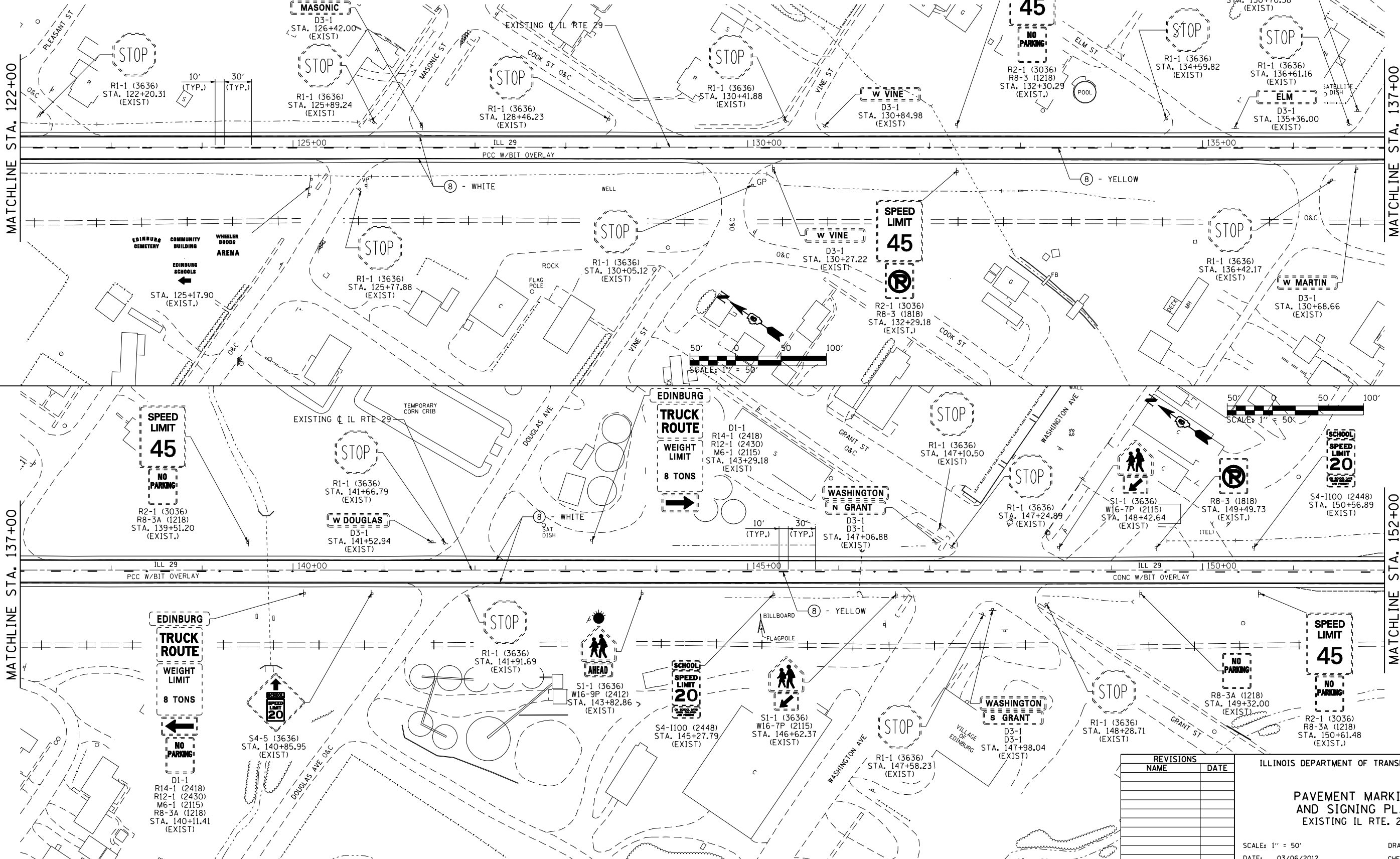

MATCHLINE STA. 122+00

MATCHLINE STA. 137+00

MATCHLINE STA. 137+00

MATCHLINE STA. 152+00

Default L:\DOT\030601\Draw\Sheets\030601\Draw\72829-sht-PK-032.dgn 3/6/2012

REVISIONS	
NAME	DATE

ILLINOIS DEPARTMENT OF TRANSPORTATION

**PAVEMENT MARKING AND SIGNING PLAN**  
EXISTING IL RTE. 29

SCALE: 1" = 50'  
DATE: 03/06/2012

DRAWN BY: B.M.B.  
CHECKED BY: J.M.M.