

F.A. RTE.	SECTION	COUNTY	TOTAL SHEETS	SHEET NO.
75	84-12; 11-3	•	729	468
STA.	N/A	TO STA.	N/A	
FED. ROAD DIST. NO. 5 ILLINOIS FED. AID PROJECT				
• SANGAMON AND CHRISTIAN				

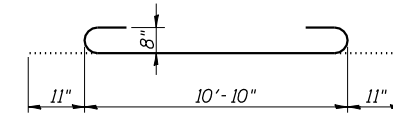

**BAR a1**

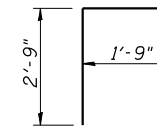

**BAR d**

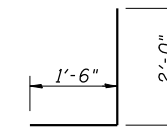

**BAR d1**

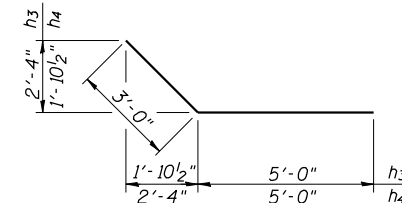

**BAR h3 & h4**

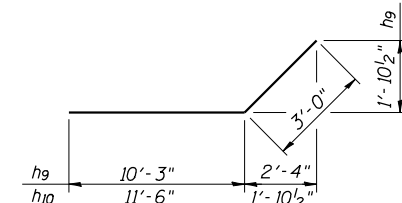

**BAR h9 & h10**

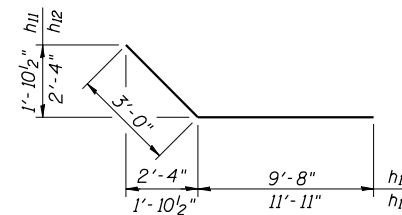

**BAR h11 & h12**

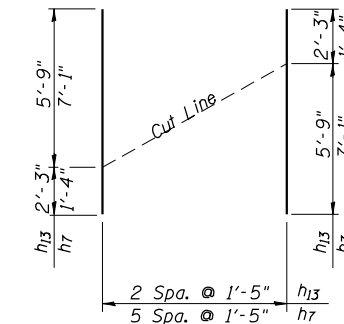

**BAR h7 & h13**

**BILL OF MATERIAL**

Bar	No.	Size	Length	Shape
a	140	#4	10'-10"	—
a1	1,116	#8	12'-8"	—
a2	4	#4	12'-10"	—
a3	7	#4	25'-6"	—
a4	2	#4	23'-2"	—
a5	2	#4	19'-1"	—
a6	2	#4	15'-0"	—
a7	24	#8	8'-0"	—
a8	2	#4	11'-3"	—
d	48	#4	4'-6"	—
d1	15	#4	3'-6"	—
d2	26	#4	4'-6"	—
h	39	#6	31'-6"	—
h1	72	#5	23'-11"	—
h2	48	#5	23'-11"	—
h3	28	#7	8'-0"	—
h4	28	#7	8'-0"	—
h5	12	#6	11'-0"	—
h6	16	#5	4'-0"	—
h7	6	#5	8'-5"	—
h8	18	#5	9'-4"	—
h9	11	#7	13'-3"	—
h10	11	#7	14'-6"	—
h11	11	#7	12'-8"	—
h12	11	#7	14'-11"	—
h13	3	#5	8'-0"	—
h14	78	#6	33'-7"	—
h15	126	#5	28'-9"	—
h16	84	#5	28'-9"	—
h17	4	#6	10'-10"	—
v	1,844	#4	8'-1"	—
v1	16	#4	11'-1"	—
v2	8	#5	4'-0"	—
v3	32	#5	8'-1"	—
Concrete Box Culverts		Cu. Yd.	273.8	
Reinforcement Bars		Lbs.	67,970	

REVISIONS	
NAME	DATE

ILLINOIS DEPARTMENT OF TRANSPORTATION

**BOX CULVERT DETAILS**  
**PROPOSED STRUCTURE NO. 011-7053**  
**STA. 1656+34.34**

SCALE: NONE  
 DATE: 03/06/2012

DRAWN BY: GLD  
 CHECKED BY: ALY