

F.A. RTE.	SECTION	COUNTY	TOTAL SHEETS	SHEET NO.
75	84-12; 11-3		729	641
STA. 111+00.00		TO STA. 114+00.00		
FED. ROAD DIST. NO. 5 ILLINOIS FED. AID PROJECT				

SANGAMON AND CHRISTIAN

STAGE-1	STAGE-2	STAGE-3
EXCAVATION= 0.0	7.0	0.0
EMBANKMENT= 0.0	207.3	0.0

DATE	
BY	
NO.	
NO.	
NO.	
NO.	
NO.	

DATE	
BY	
NO.	
NO.	
NO.	
NO.	
NO.	

PLOT DATE = 1/27/2012
 PLOT TIME = 10:00 AM
 PLOT SCALE = 1" = 20'
 REFERENCE = SHEET #

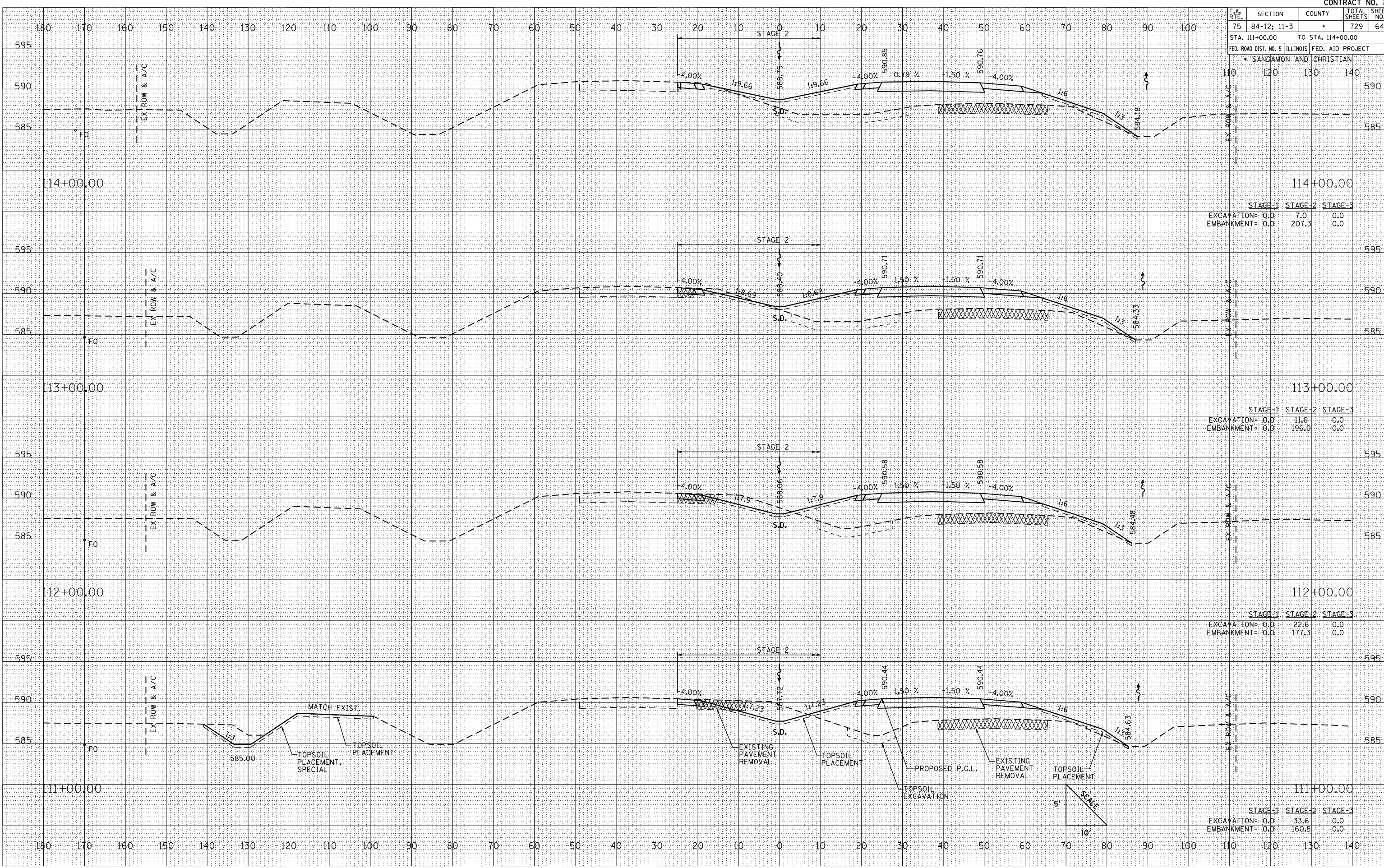

CROSS SECTIONS: IL. RTE. 29 - STA. 111+00 TO STA. 114+00