

BILL OF MATERIALS (THIS SHEET ONLY)			
PAY CODE	ITEM DESCRIPTION	UNIT	QUANTITY
72000100	SIGN PANEL - TYPE 1	SQ FT	7.6
72800100	TELESCOPING STEEL SIGN SUPPORT	FOOT	19.0

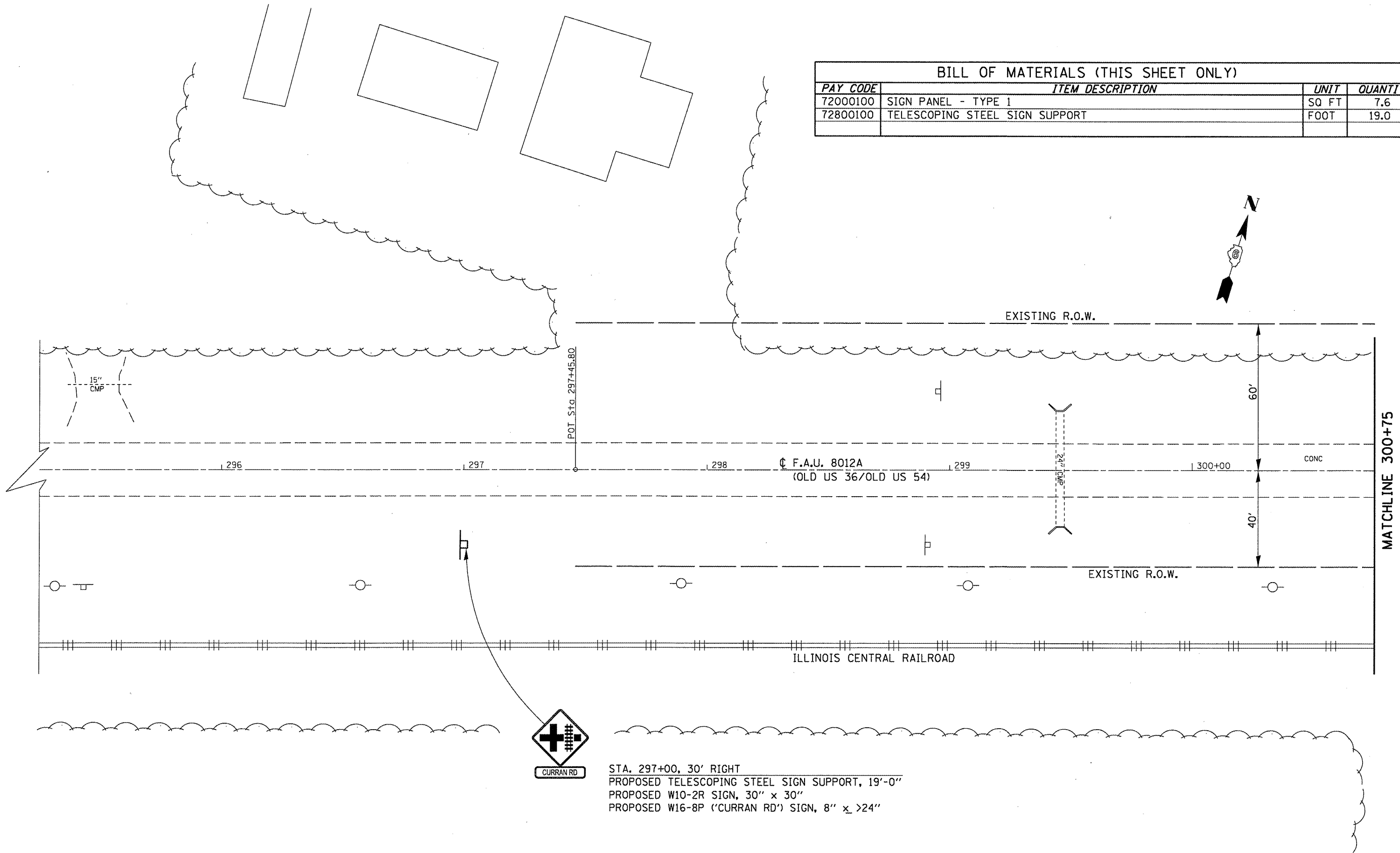

CURRAN RD

STA. 297+00, 30' RIGHT
 PROPOSED TELESCOPING STEEL SIGN SUPPORT, 19'-0"
 PROPOSED W10-2R SIGN, 30" x 30"
 PROPOSED W16-8P ('CURRAN RD') SIGN, 8" x >24"

FILE NAME =	USER NAME = Slegler	DESIGNED -	REVISD -	STATE OF ILLINOIS DEPARTMENT OF TRANSPORTATION	LIGHTING PLAN SHEET			F.A.U. RTE. 8012A	SECTION 21L	COUNTY SANGAMON	TOTAL SHEETS 10	SHEET NO. 5
CONTRACT NO. 72F06	CONTRACT NO. 72F06	DRAWN - RTS	REVISD -		SCALE:	SHEET 1	OF 4	SHEETS	STA.	TO STA.	ILLINOIS FED. AID PROJECT	
		CHECKED -	REVISD -									
		DATE - 10-11-11	REVISD -									