

NOTE: Contractor to provide proper connections to install the 3 section head that was mast arm mounted to be bracket mounted on the proposed post in the median. This work shall be considered part of the relocation of the TRAFFIC SIGNAL HEAD.

NOTE: THE INTENT OF THE RELOCATION OF THE TRAFFIC SIGNAL HEADS, IS TO CENTER EACH HEAD IN THE CENTER OF ITS RESPECTIVE TRAVEL LANE.

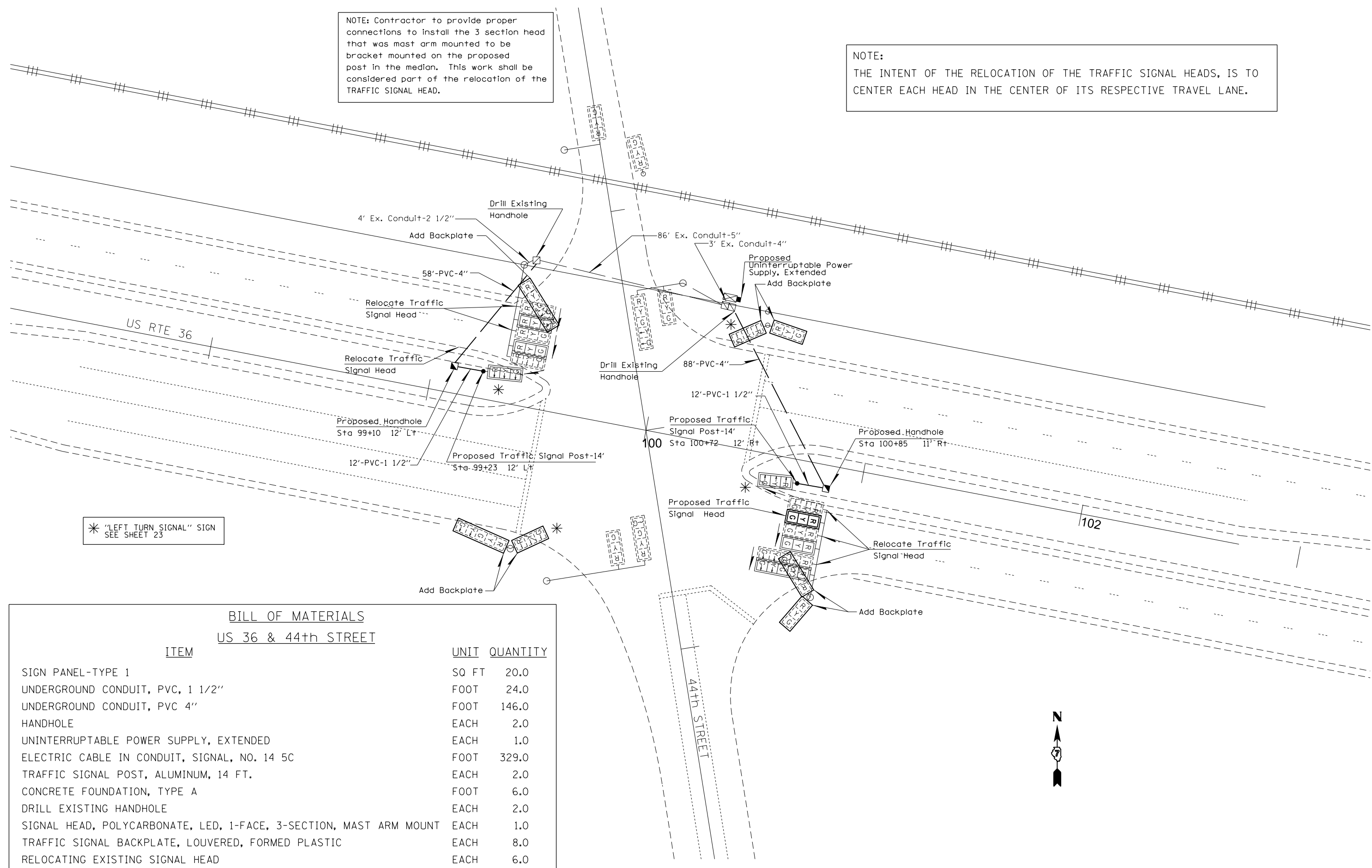

\* "LEFT TURN SIGNAL" SIGN SEE SHEET 23

**BILL OF MATERIALS**  
**US 36 & 44th STREET**

ITEM	UNIT	QUANTITY
SIGN PANEL-TYPE 1	SQ FT	20.0
UNDERGROUND CONDUIT, PVC, 1 1/2"	FOOT	24.0
UNDERGROUND CONDUIT, PVC 4"	FOOT	146.0
HANDHOLE	EACH	2.0
UNINTERRUPTABLE POWER SUPPLY, EXTENDED	EACH	1.0
ELECTRIC CABLE IN CONDUIT, SIGNAL, NO. 14 5C	FOOT	329.0
TRAFFIC SIGNAL POST, ALUMINUM, 14 FT.	EACH	2.0
CONCRETE FOUNDATION, TYPE A	FOOT	6.0
DRILL EXISTING HANDHOLE	EACH	2.0
SIGNAL HEAD, POLYCARBONATE, LED, 1-FACE, 3-SECTION, MAST ARM MOUNT	EACH	1.0
TRAFFIC SIGNAL BACKPLATE, LOUVERED, FORMED PLASTIC	EACH	8.0
RELOCATING EXISTING SIGNAL HEAD	EACH	6.0



FILE NAME =	USER NAME = steffenmk	DESIGNED -	REVISED -
c:\pwwork\pwwork\steffenmk\d0273662\0774539-sht-ts.dgn		DRAWN -	REVISED -
	PLOT SCALE = 40.0000' / in.	CHECKED -	REVISED -
	PLOT DATE = 3/27/2012	DATE -	REVISED -

**STATE OF ILLINOIS**  
**DEPARTMENT OF TRANSPORTATION**

**TRAFFIC SIGNAL LAYOUT**  
**INTERSECTION US 36 & 44TH ST**

SCALE: 20 SHEET 11 OF 12 SHEETS STA. TO STA.

F.A.P. RTE.	SECTION	COUNTY	TOTAL SHEETS	SHEET NO.
320	(137Z,139-X-2N)	MACON	39	33
CONTRACT NO. 74539				
ILLINOIS FED. AID PROJECT				