

IL 15 WB ENTRANCE RAMP

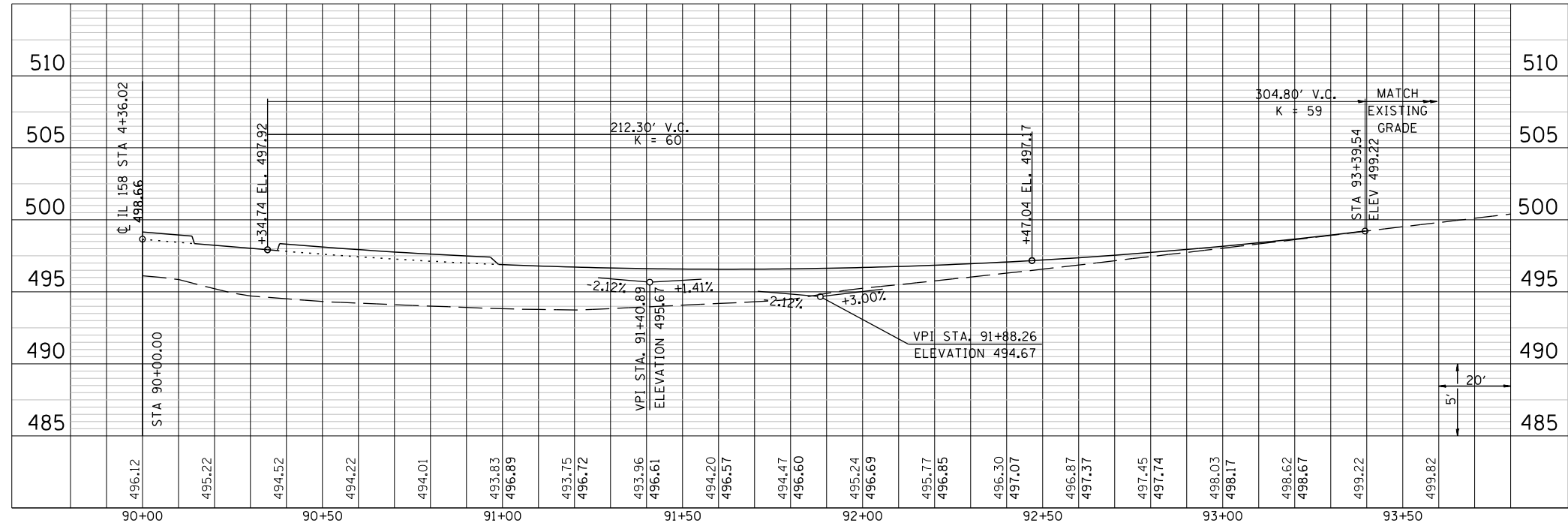

IL 15 WB EXIT RAMP

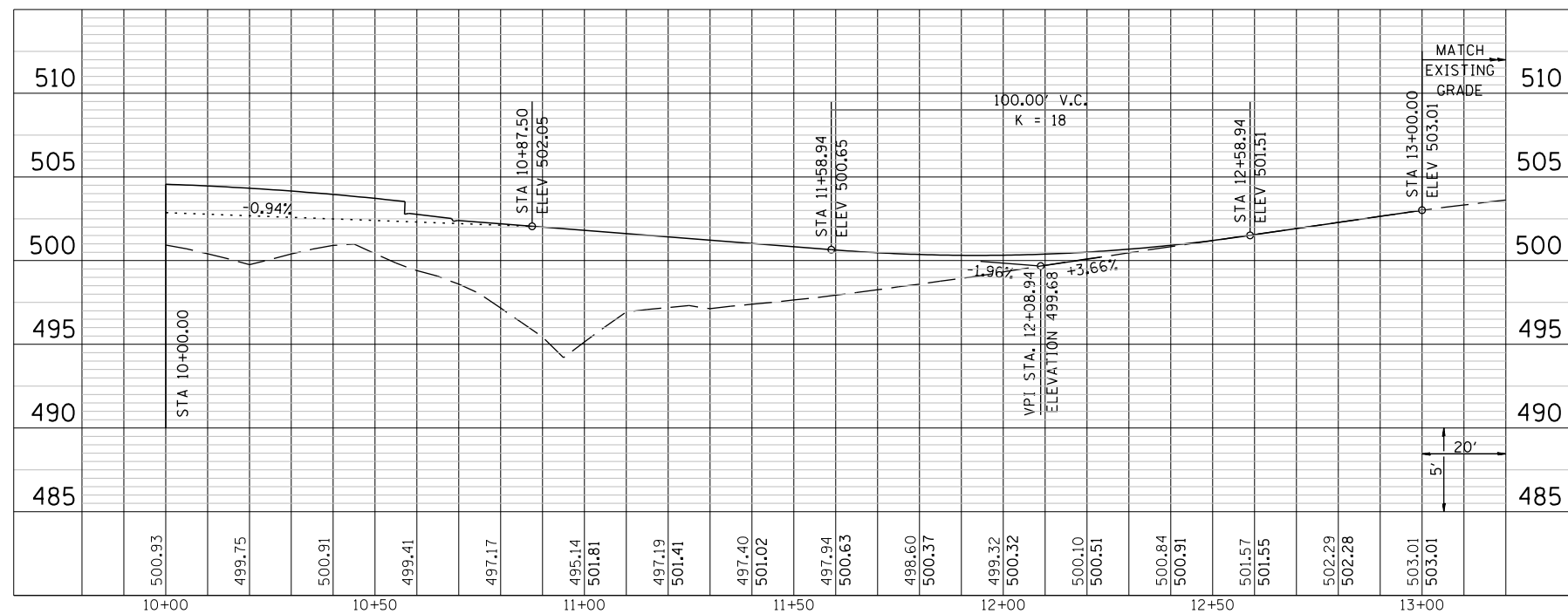

LAST SAVED = 3/20/2012
 PEN TABLE = W8-HaIF.tbl
 PLOT DRIVER = IR-V8pdf-Black-HaIF.plt

FILE NAME =	USER NAME = beriechmann	DESIGNED -	REVISED -
\\s:\0906600\0906603\cad\t\plans\015-D876006-Sht-Profile-02.dgn		DRAWN -	REVISED -
PLOT SCALE = 40.0000' / IN.		CHECKED -	REVISED -
PLOT DATE = 3/20/2012 4:10:34 PM		DATE -	REVISED -

STATE OF ILLINOIS
DEPARTMENT OF TRANSPORTATION



PROFILES
 IL 15 WESTBOUND ENTRANCE AND EXIT RAMPS
 SCALE: 20H : 5V SHEET NO. 3 OF 5 SHEETS STA. TO STA.

① F.A.P. RTE 809 / F.A.U. RTE 9251 / F.A.U. RTE 9269

F.A. RTE.	SECTION	COUNTY	TOTAL SHEETS	SHEET NO.
①	135-N	ST. CLAIR	206	45
CONTRACT NO. 76D06				
ILLINOIS FED. AID PROJECT				