

BYPASS LANE

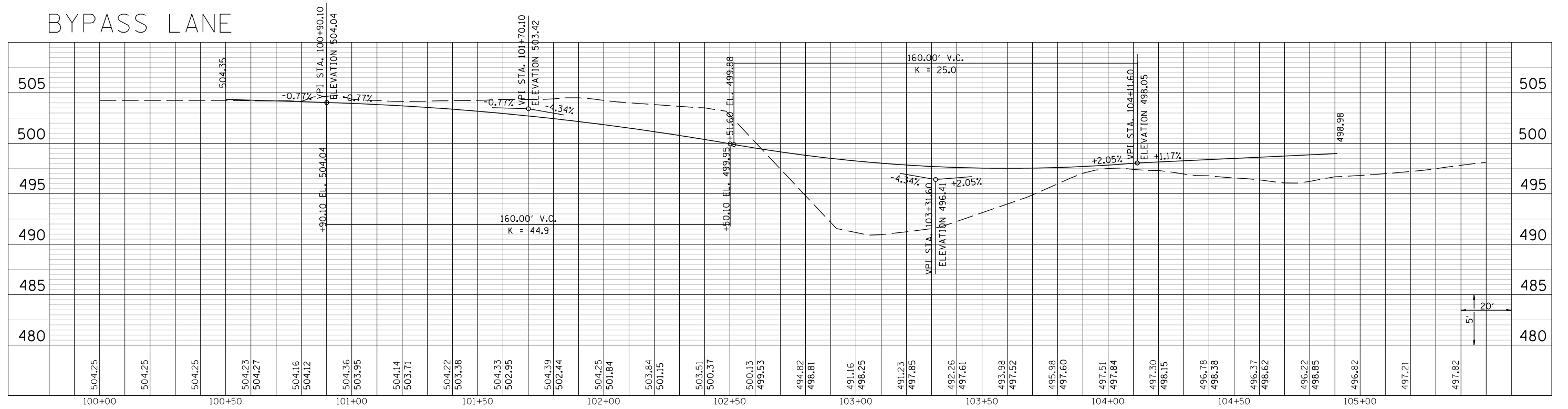

WHISKEY ROAD

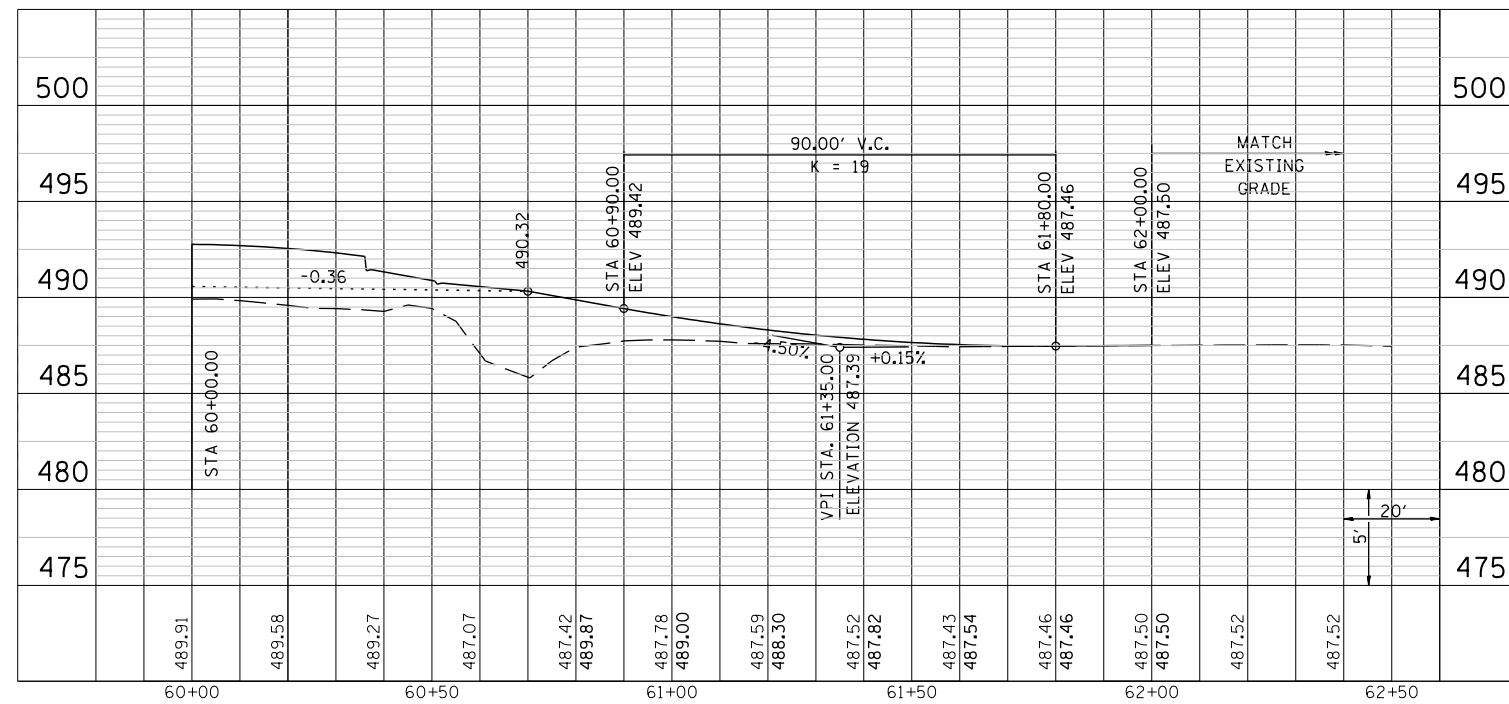

LAST SAVED = 3/20/2012
 PEN TABLE = W8-Haif.tbl
 PLOT DRIVER = IR-V8pdf-Black-Haif.plt

FILE NAME =	USER NAME = beriechmann	DESIGNED -	REVISED -
\\0906600\0906603\cad\1\plans\015-0876006-Sht-Profile-02.dgn		DRAWN -	REVISED -
PLOT SCALE = 40.0000' / IN.		CHECKED -	REVISED -
PLOT DATE = 3/20/2012 4:10:35 PM		DATE -	REVISED -

**STATE OF ILLINOIS
 DEPARTMENT OF TRANSPORTATION**



PROFILES
 BYPASS LANE AND WHISKEY ROAD

SCALE: 20H : 5V SHEET NO. 5 OF 5 SHEETS STA. TO STA.

① F.A.P. RTE 809 / F.A.U. RTE 9251 / F.A.U. RTE 9269

F.A. RTE.	SECTION	COUNTY	TOTAL SHEETS	SHEET NO.
①	135-N	ST. CLAIR	206	47
CONTRACT NO. 76D06				
ILLINOIS FED. AID PROJECT				