

CONSTRUCTION SIGNAL PHASING

	PHASE 1			PHASE 2			
	YELLOW	ALL RED		YELLOW	ALL RED		
A.M.	42	4	1	8	4	1	60 SEC.
P.M.	36	4	1	14	4	1	60 SEC.

STAGE C2

- WORK AREA
- TEMPORARY PAVEMENT
- TRAFFIC FLOW DIRECTION ARROWS
- TEMPORARY PAVEMENT MARKING - SYMBOLS
- TYPE III BARRICADE

RAMP CLOSURES

WB IL 15 ENTRANCE
WB IL 15 EXIT

ROAD CLOSURES

IL 13 (TO THE WEST)

PROHIBITED MOVEMENTS

LT FROM SB CENTREVILLE AVENUE TO EB IL 158/IL 13

DETOURS

ACCESS TO/ FROM WB IL 15 VIA IL 158 TO IL 159

WORKFLOW

- 1) SHIFT TRAFFIC TO TEMPORARY RUN AROUND
- 2) CONSTRUCT REMAINING 19" PCC PAVEMENT SECTION
- 3) CONSTRUCT REMAINING BARRIER WALL
- 4) CONSTRUCT MAJORITY OF ROUNDABOUT

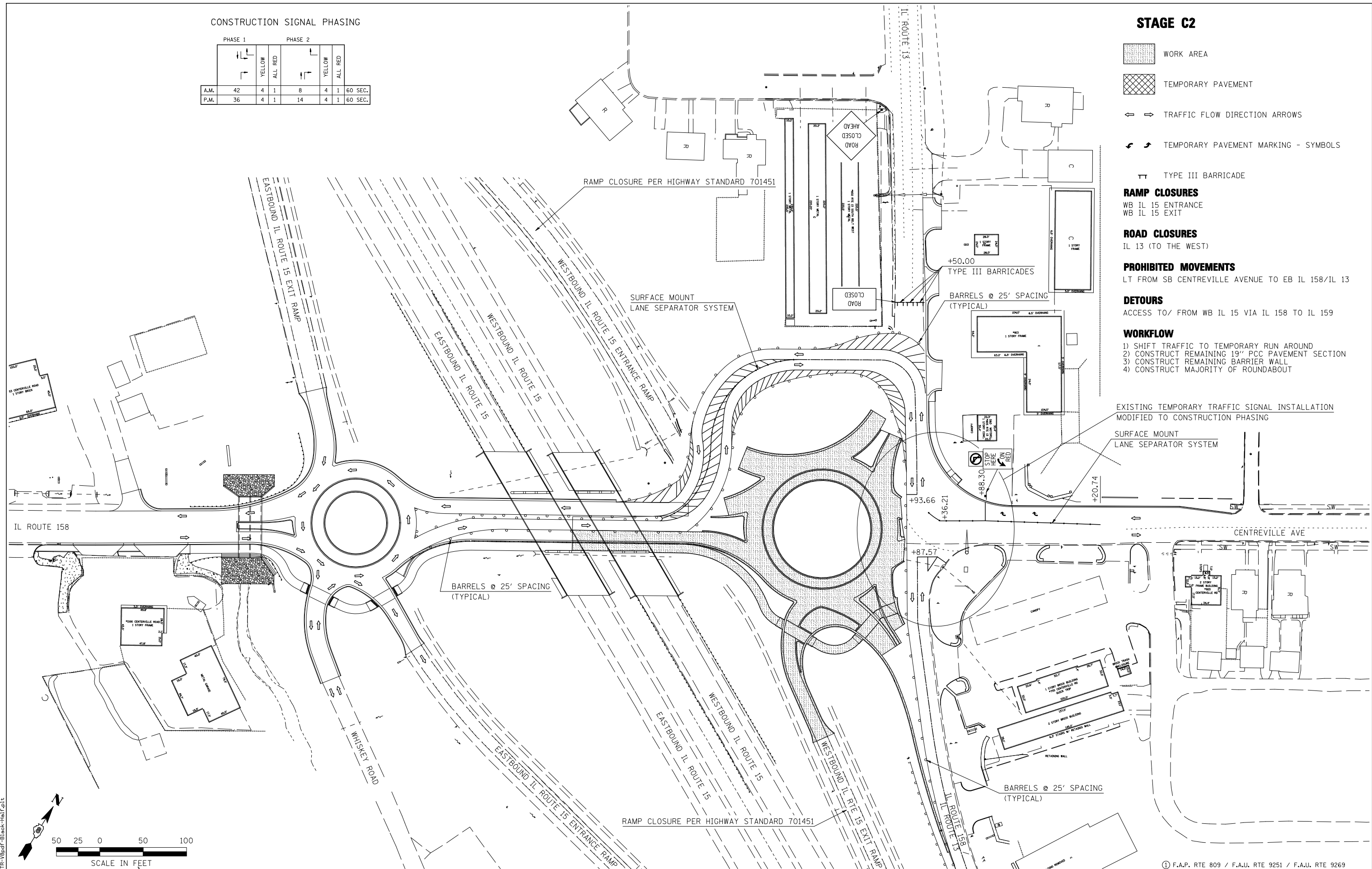

LAST SAVED = 2/20/2012
 PEN TABLE = V8-HA-1C-143
 PLOT DRIVER = TR-18pdf-Block-Half.plt

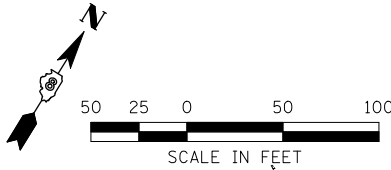

FILE NAME =	USER NAME = beriechmann	DESIGNED -	REVISED -
1:\0906600\0906603\cad\1\plans\026-D876D06-Sht-Staging-C2.dgn		DRAWN -	REVISED -
PLOT SCALE = 100.0000' / IN.		CHECKED -	REVISED -
PLOT DATE = 3/20/2012 4:11:13 PM		DATE -	REVISED -

STATE OF ILLINOIS
DEPARTMENT OF TRANSPORTATION

HORNER & SHIRN, INC.
ENGINEERS

SUGGESTED STAGES OF CONSTRUCTION AND TRAFFIC CONTROL
STAGE C2

SCALE: 1"=50' SHEET NO. 8 OF 23 SHEETS STA. TO STA.

① F.A.P. RTE 809 / F.A.U. RTE 9251 / F.A.U. RTE 9269			
F.A. RTE.	SECTION	COUNTY	TOTAL SHEETS
①	135-N	ST. CLAIR	206
			SHEET NO. 58
CONTRACT NO. 76D06			
ILLINOIS FED. AID PROJECT			