

# STAGE C1 - DETOUR SIGNING

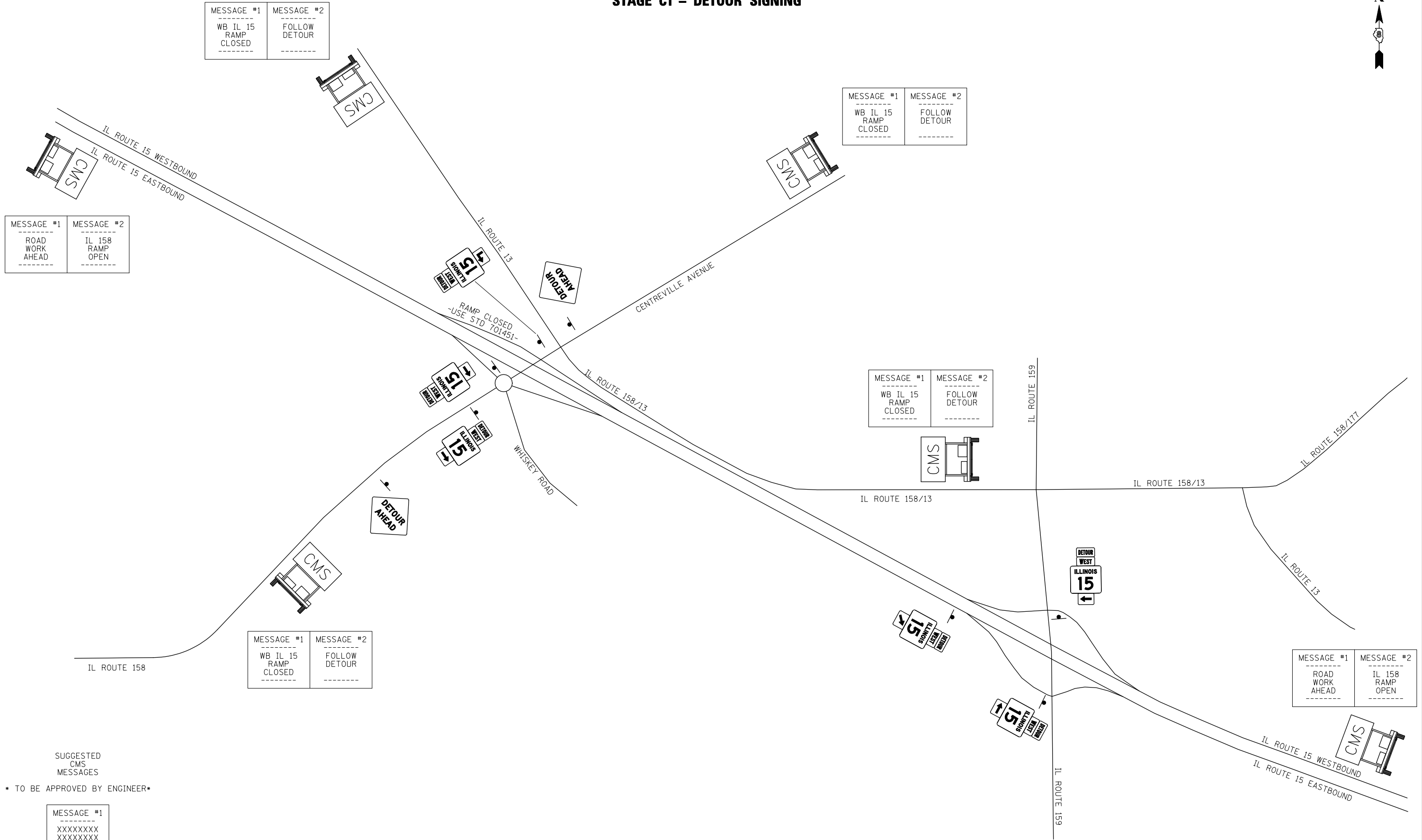

MESSAGE #1  
ROAD WORK AHEAD

MESSAGE #2  
IL 158 RAMP OPEN

MESSAGE #1  
WB IL 15 RAMP CLOSED

MESSAGE #2  
FOLLOW DETOUR

MESSAGE #1  
WB IL 15 RAMP CLOSED

MESSAGE #2  
FOLLOW DETOUR

MESSAGE #1  
WB IL 15 RAMP CLOSED

MESSAGE #2  
FOLLOW DETOUR

MESSAGE #1  
WB IL 15 RAMP CLOSED

MESSAGE #2  
FOLLOW DETOUR

MESSAGE #1  
ROAD WORK AHEAD

MESSAGE #2  
IL 158 RAMP OPEN

SUGGESTED CMS MESSAGES

\* TO BE APPROVED BY ENGINEER \*

MESSAGE #1  
XXXXXXXXXX  
XXXXXXXXXX  
XXXXXXXXXX

NOT TO SCALE

LAST SAVED = 3/20/2012  
PEN TABLE = V8-HA-F-143  
PLOT DRIVER = TR-18pdf-Block-Half.plt

FILE NAME =	USER NAME = beriechmann	DESIGNED -	REVISED -
1:\0906600\0906603\cad\t\plans\031-0876006-Sht-Staging-Detours.dgn		DRAWN -	REVISED -
	PLOT SCALE = 100.0000' / IN.	CHECKED -	REVISED -
	PLOT DATE = 3/20/2012 4:11:45 PM	DATE -	REVISED -

**STATE OF ILLINOIS**  
**DEPARTMENT OF TRANSPORTATION**

**HORNER & SHIRIN, INC.**  
**ENGINEERS**

**DETOUR ROUTE PLANS**  
STAGE C1 - DETOUR SIGNING

① F.A.P. RTE 809 / F.A.U. RTE 9251 / F.A.U. RTE 9269			
F.A. RTE.	SECTION	COUNTY	TOTAL SHEETS
①	135-N	ST. CLAIR	206
			SHEET NO. 66
CONTRACT NO. 76D06			
ILLINOIS FED. AID PROJECT			

SCALE: NONE SHEET NO. 16 OF 23 SHEETS STA. TO STA.