

STAGE C3 - DETOUR SIGNING

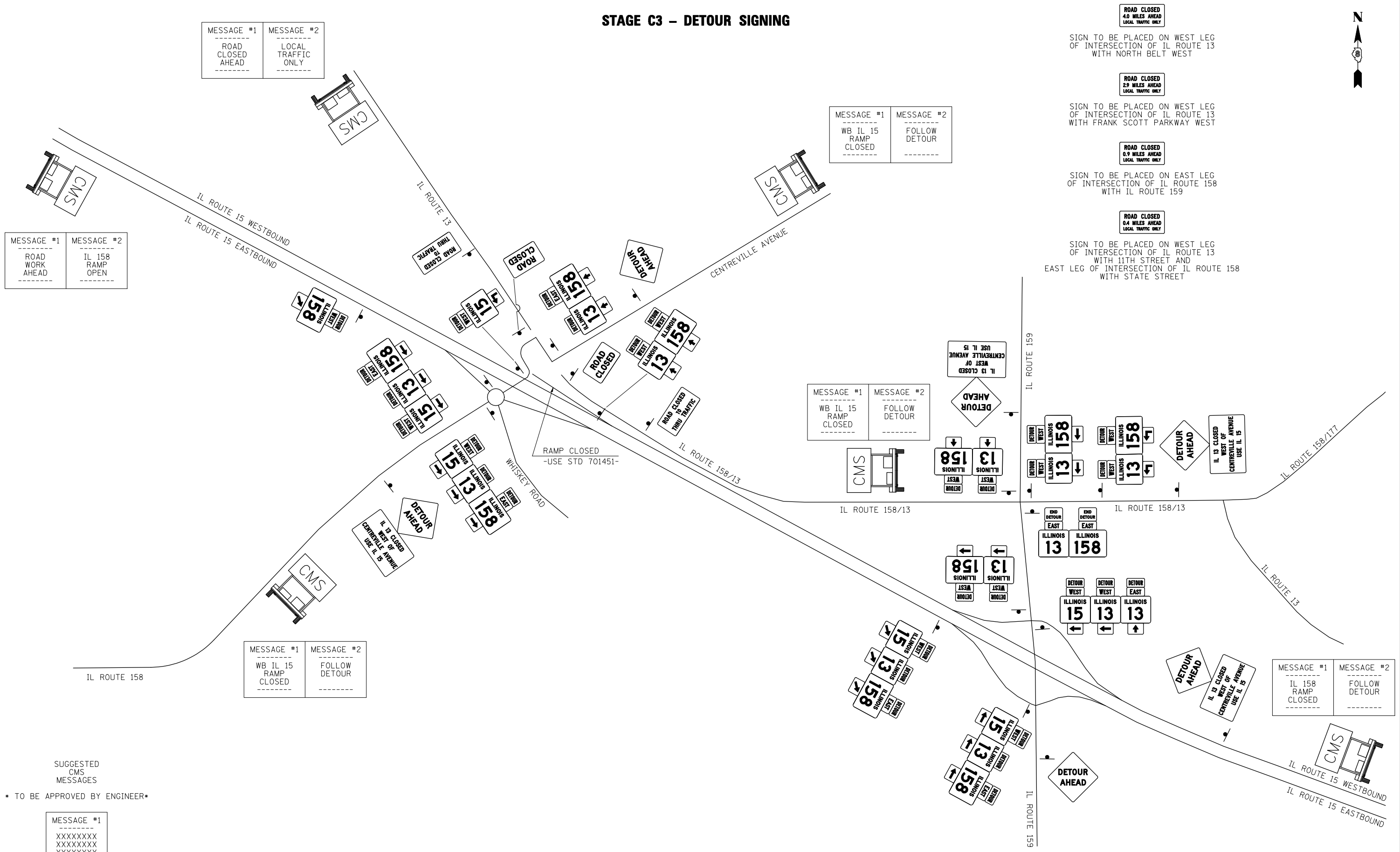

MESSAGE #1
ROAD CLOSED AHEAD
MESSAGE #2
LOCAL TRAFFIC ONLY

MESSAGE #1
WB IL 15 RAMP CLOSED
MESSAGE #2
FOLLOW DETOUR

ROAD CLOSED
4.0 MILES AHEAD
LOCAL TRAFFIC ONLY
SIGN TO BE PLACED ON WEST LEG OF INTERSECTION OF IL ROUTE 13 WITH NORTH BELT WEST

ROAD CLOSED
2.9 MILES AHEAD
LOCAL TRAFFIC ONLY
SIGN TO BE PLACED ON WEST LEG OF INTERSECTION OF IL ROUTE 13 WITH FRANK SCOTT PARKWAY WEST

ROAD CLOSED
0.9 MILES AHEAD
LOCAL TRAFFIC ONLY
SIGN TO BE PLACED ON EAST LEG OF INTERSECTION OF IL ROUTE 158 WITH IL ROUTE 159

ROAD CLOSED
0.4 MILES AHEAD
LOCAL TRAFFIC ONLY
SIGN TO BE PLACED ON WEST LEG OF INTERSECTION OF IL ROUTE 13 WITH 11TH STREET AND EAST LEG OF INTERSECTION OF IL ROUTE 158 WITH STATE STREET

MESSAGE #1
ROAD WORK AHEAD
MESSAGE #2
IL 158 RAMP OPEN

MESSAGE #1
WB IL 15 RAMP CLOSED
MESSAGE #2
FOLLOW DETOUR

MESSAGE #1
WB IL 15 RAMP CLOSED
MESSAGE #2
FOLLOW DETOUR

MESSAGE #1
IL 158 RAMP CLOSED
MESSAGE #2
FOLLOW DETOUR

SUGGESTED CMS MESSAGES
* TO BE APPROVED BY ENGINEER *

MESSAGE #1
XXXXXXXXXX
XXXXXXXXXX
XXXXXXXXXX

NOT TO SCALE

LAST SAVED = 2/20/2012
PEN TABLE = V8-HA-1F-143
PLOT DRIVER = TR-18pdf-Block-Half.plt

FILE NAME =	USER NAME = beriechmann	DESIGNED -	REVISED -
1:\0906600\0906603\cad\plans\031-0876006-Sht-Staging-DeTours.dgn		DRAWN -	REVISED -
PLOT SCALE = 100.0000' / IN.		CHECKED -	REVISED -
PLOT DATE = 3/20/2012 4:11:50 PM		DATE -	REVISED -

STATE OF ILLINOIS
DEPARTMENT OF TRANSPORTATION

HORNER & SHIPP, INC.
ENGINEERS

DETOUR ROUTE PLANS
STAGE C3 - DETOUR SIGNING
SCALE: NONE SHEET NO. 18 OF 23 SHEETS STA. TO STA.

① F.A.P. RTE 809 / F.A.U. RTE 9251 / F.A.U. RTE 9269			
F.A. RTE.	SECTION	COUNTY	TOTAL SHEETS
①	135-N	ST. CLAIR	206
			SHEET NO. 69
CONTRACT NO. 76D06			
ILLINOIS FED. AID PROJECT			