

CONTROL POINT CROSS TIES

N.T.S.

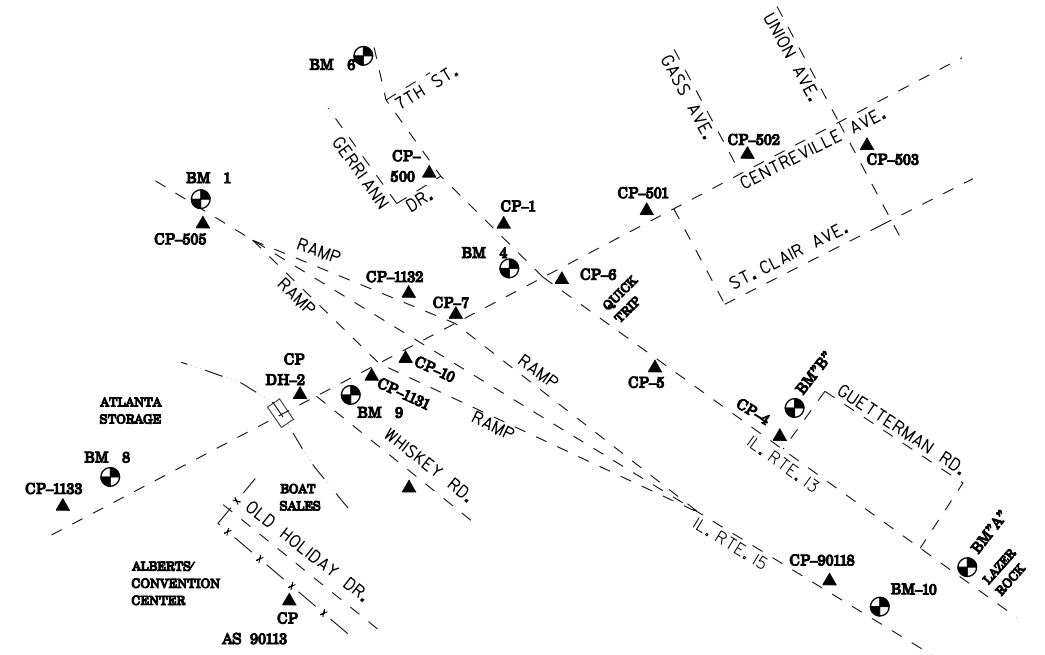

CONTROL POINT LOCATION MAP

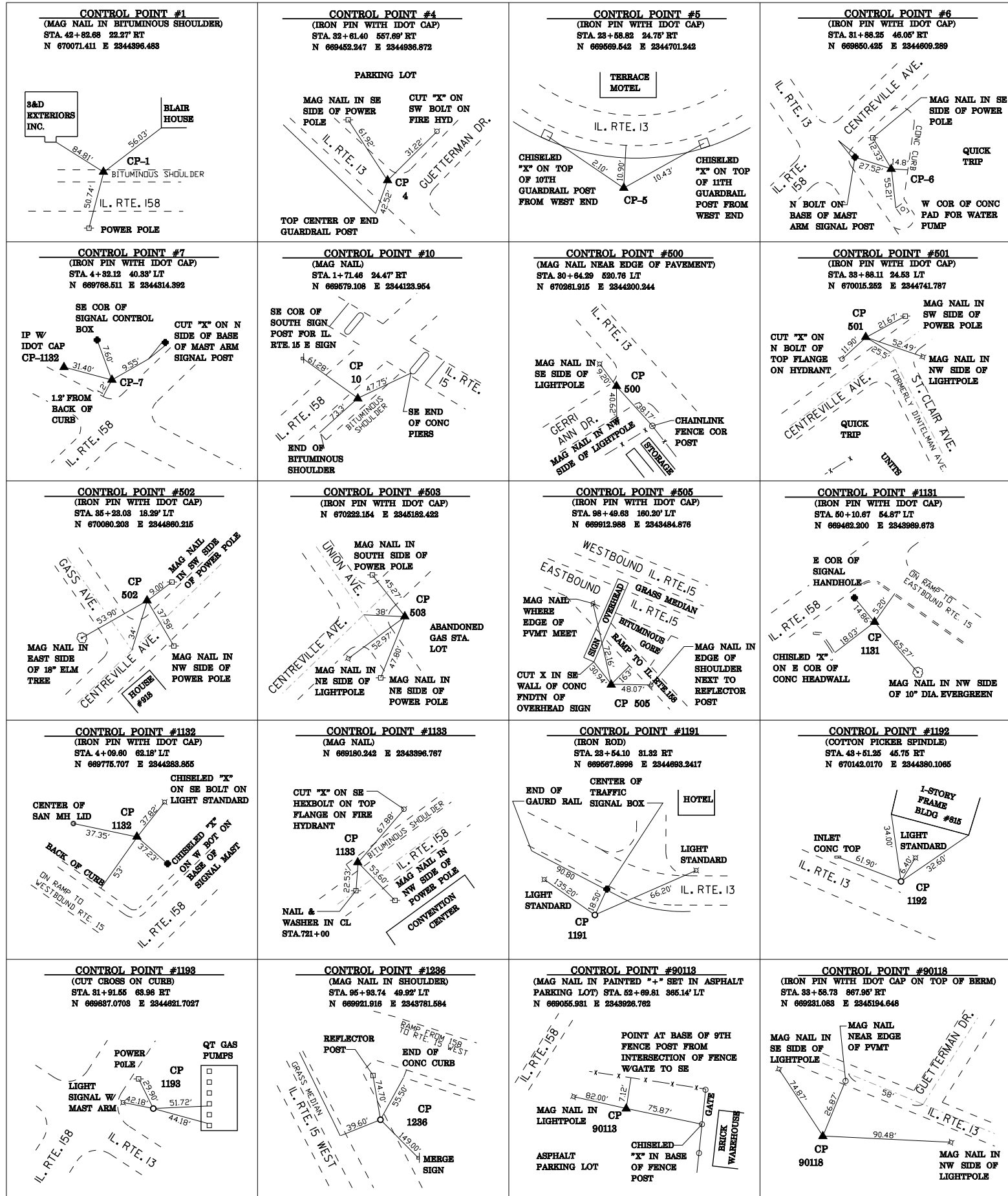

Engineering
Architecture
Surveying
800 South Vandeventer Avenue
St. Louis, MO 63110
(314) 534-1030
ILLINOIS LICENCE NO: 184-000485
Expiration Date: November 30, 2012

STATE OF MISSOURI)
) SS
CITY OF ST. LOUIS)

I, RONNIE D. LOWE, AN ILLINOIS PROFESSIONAL LAND SURVEYOR, CERTIFY THAT I HAVE SURVEYED THE PLAT OF HIGHWAY SHOWN HEREON AND THAT THIS PROFESSIONAL SERVICE CONFORMS TO THE CURRENT ILLINOIS MINIMUM STANDARDS FOR A BOUNDARY SURVEY FOR THE PROPOSED PARCEL(S) TO BE ACQUIRED BY THE STATE OF ILLINOIS, DEPARTMENT OF TRANSPORTATION, SHOWN HEREON.

DATED _____
RONNIE D. LOWE, PLS NO. 035-003363
LICENSE EXPIRATION DATE: 11/30/2012

ILLINOIS DEPARTMENT OF TRANSPORTATION
PLAT OF HIGHWAYS
FAP ROUTE 809 (IL 158) AT
IL 15 & IL 13
SECTION 135-N
ST. CLAIR COUNTY
JOB NO. R-98-001-10

SCALE: 1" = 20'

SHEET 10 OF 10

ILLINOIS DEPARTMENT OF TRANSPORTATION
DIVISION OF HIGHWAYS/REGION 5/DISTRICT 8
1102 EASTPORT PLAZA DRIVE
COLLINSVILLE, ILLINOIS 62234-6198

F.A. RTE.	SECTION	COUNTY	TOTAL SHEETS	SHEET NO.
809	135-N	ST. CLAIR	206	98

COMPLETION DATE OF FIELD WORK PERFORMED _____
LAND SURVEY: _____ ROW STAKING: _____
FED. ROAD DIST. NO. _____ ILLINOIS FED. AID PROJECT _____