

FINAL SURVEY	SURVEYED	BY	DATE
NOTE BOOK	PLOTTED		
NO.	TEMPLATE		
	AREAS		
	CHECKED		

ORIGINAL SURVEY	SURVEYED	BY	DATE
NOTE BOOK	PLOTTED		
NO.	TEMPLATE		
	AREAS		
	CHECKED		

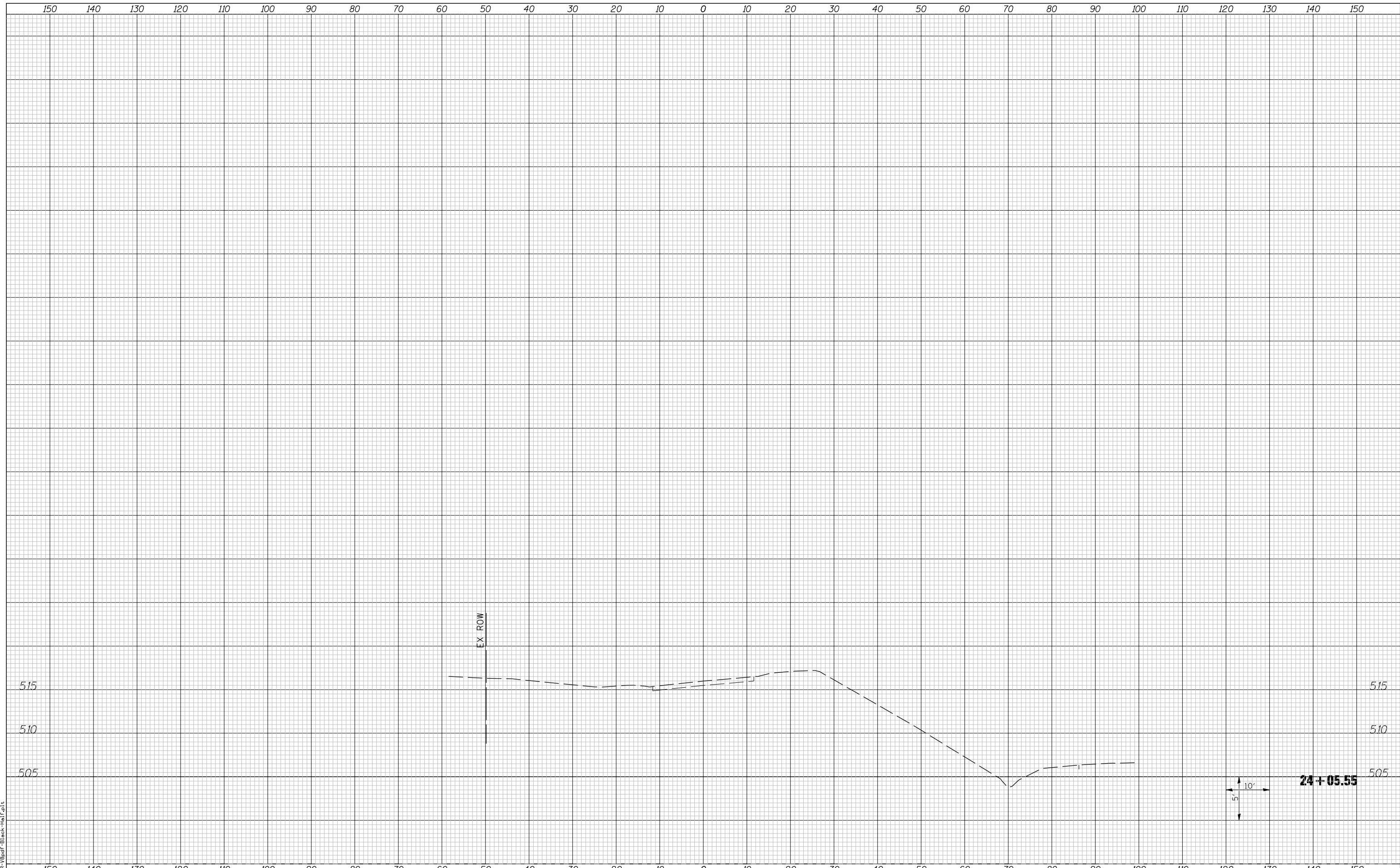

LAST SAVED = 3/20/2012
 PEN TABLE = 10-Half-163
 PLOT DRIVER = P:\3rdp\Black-Half.plt

FILE NAME =	USER NAME = beriechmann	DESIGNED -	REVISED -	STATE OF ILLINOIS DEPARTMENT OF TRANSPORTATION		CROSS SECTIONS FAP 809, FAU 9269 IL ROUTE 158, IL ROUTE 13		F.A. RTE.	SECTION	COUNTY	TOTAL SHEETS	SHEET NO.
		DRAWN -	REVISED -			①	135-N	ST. CLAIR	206	191		
		CHECKED -	REVISED -			① F.A.P. RTE 809 / F.A.U. RTE 9251		CONTRACT NO. 76D06				
		DATE -	REVISED -			/ F.A.U. RTE 9269 ILLINOIS FED. AID PROJECT						
PLOT SCALE = 20.0000 ' / IN. PLOT DATE = 3/20/2012 4:13:29 PM				SCALE:		SHEET NO. 4 OF 4 SHEETS		STA. 24+05.55 TO STA. 24+05.55				