

- NOTES: 1. SEE TYPICAL SECTIONS, SCHEDULES, GENERAL NOTES, AND DETAILS FOR PAVEMENT PATCHING, HMA SURFACE REMOVAL, AND PAVING REQUIREMENTS.
2. EOP LINES DO NOT GO THROUGH INTERSECTING SIDE ROADS.

STA. 1148+08.8  
SB SOLID YELLOW (NPZ) STARTS  
YELLOW SKIP DASH ENDS

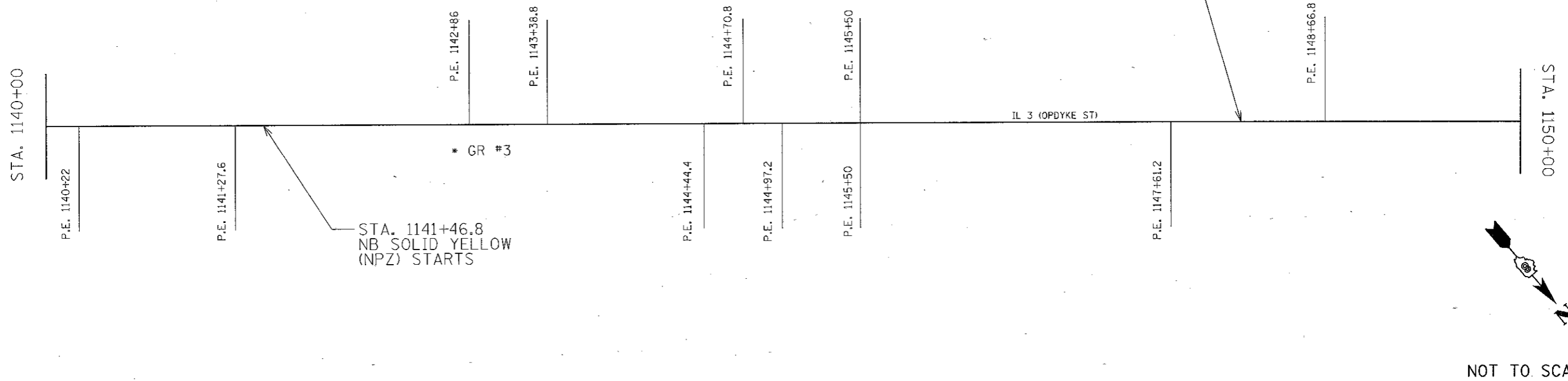

NOT TO SCALE

STA. 1152+16.8  
NB SOLID YELLOW (NPZ) ENDS  
YELLOW SKIP DASH (10' - 30') STARTS

STA. 1158+29.8  
NB SOLID YELLOW (NPZ) STARTS

STA. 1157+46.8  
SB SOLID YELLOW (NPZ) ENDS

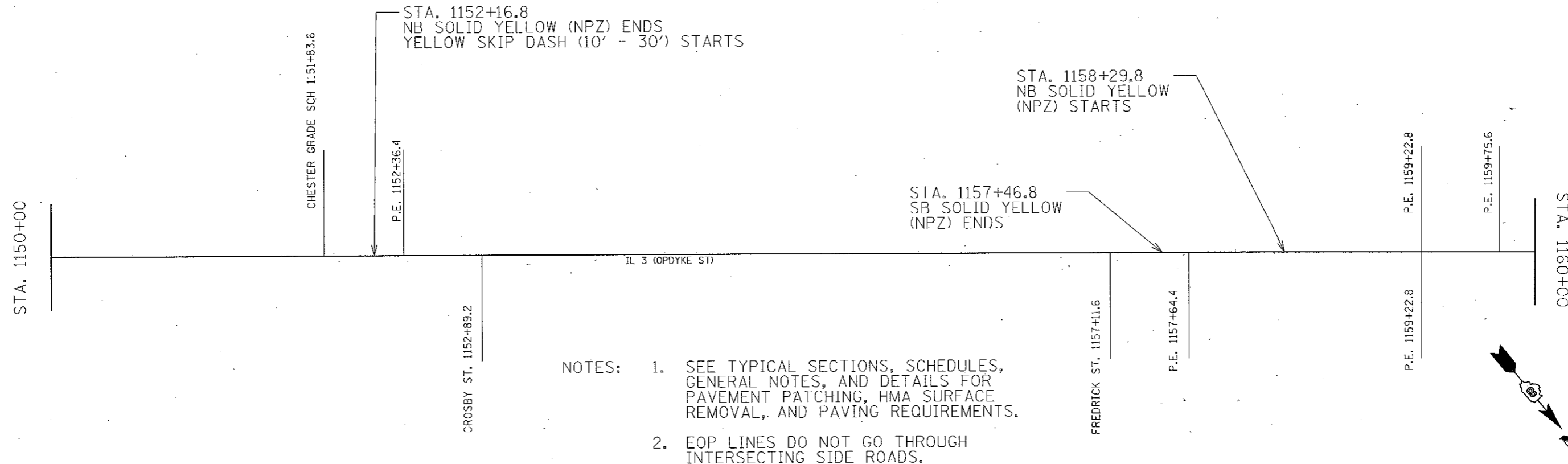

- NOTES: 1. SEE TYPICAL SECTIONS, SCHEDULES, GENERAL NOTES, AND DETAILS FOR PAVEMENT PATCHING, HMA SURFACE REMOVAL, AND PAVING REQUIREMENTS.
2. EOP LINES DO NOT GO THROUGH INTERSECTING SIDE ROADS.

NOT TO SCALE

FILE NAME =	USER NAME = karlasal	DESIGNED -	REVISED -	<b>STATE OF ILLINOIS DEPARTMENT OF TRANSPORTATION</b>	<b>PLAN DIAGRAM</b>			*FAP 312/FAP 861/FAU 9414/FAU 9415	
ca:\pwork\pudot\karlasal\1148254790\1148254790-Design\lincal.dgn		DRAWN -	REVISED -		F.A.P. RTE.	SECTION	COUNTY	TOTAL SHEETS	SHEET NO.
PLOT SCALE = 1/8" = 100.0000' / in.		CHECKED -	REVISED -		• 119, 119-1RS-2, (75-1RS-2)		RANDOLPH	37	20
PLOT DATE = 3/14/2012		DATE -	REVISED -					CONTRACT NO. 76E90	
				SCALE: NONE	SHEET NO. 6 OF 11 SHEETS	STA. 1140+00 TO STA. 1160+00	FED. ROAD DIST. NO. [ILLINOIS] FED. AID PROJECT		