

- NOTES: 1. SEE TYPICAL SECTIONS, SCHEDULES, GENERAL NOTES, AND DETAILS FOR PAVEMENT PATCHING, HMA SURFACE REMOVAL, AND PAVING REQUIREMENTS.
2. EOP LINES DO NOT GO THROUGH INTERSECTING SIDE ROADS.

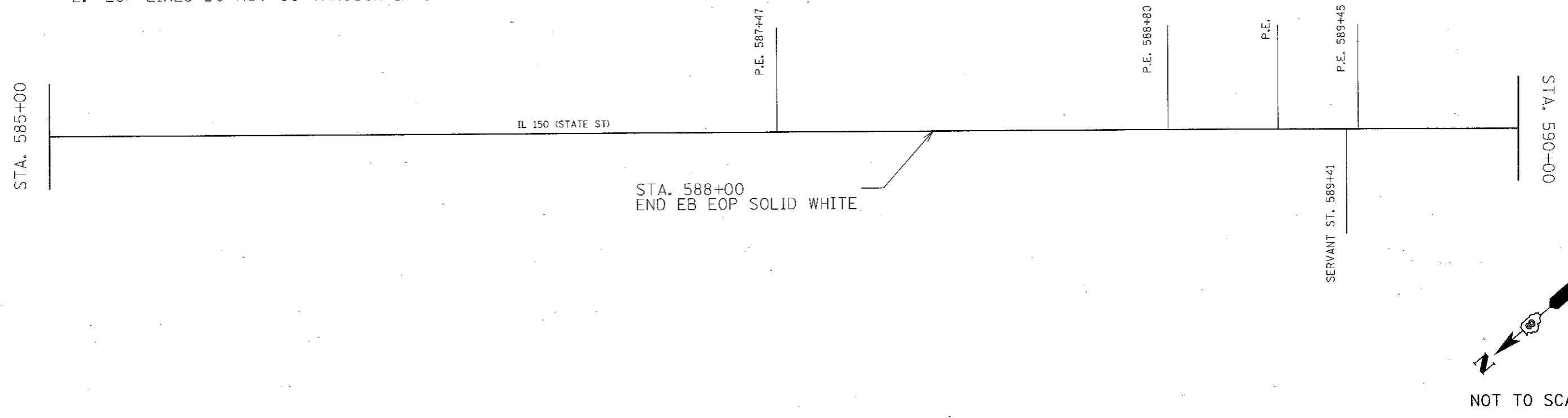

- NOTES: 1. SEE TYPICAL SECTIONS, SCHEDULES, GENERAL NOTES, AND DETAILS FOR PAVEMENT PATCHING, HMA SURFACE REMOVAL, AND PAVING REQUIREMENTS.
2. EOP LINES DO NOT GO THROUGH INTERSECTING SIDE ROADS.

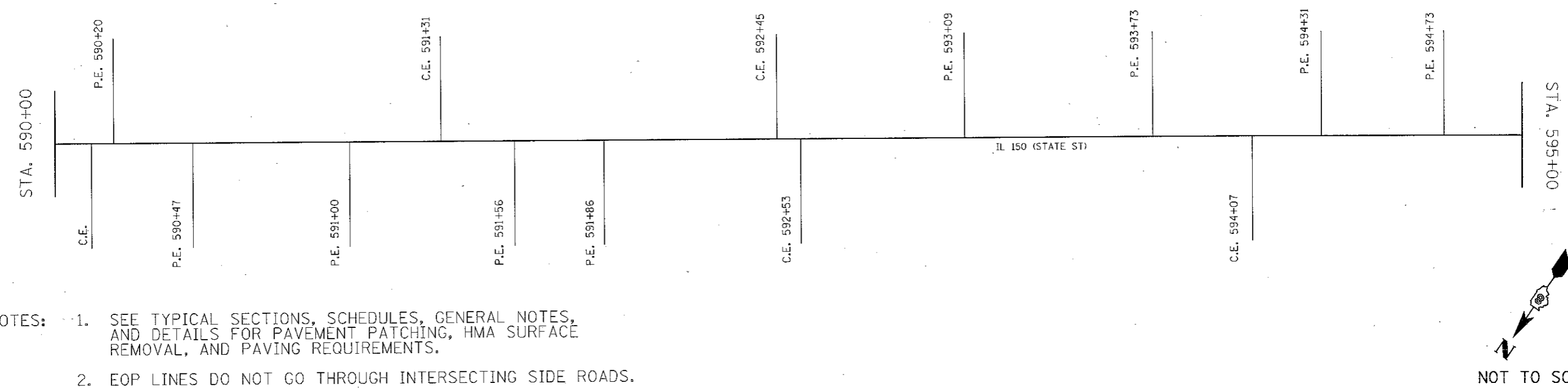

FILE NAME =	USER NAME = karlosal	DESIGNED -	REVISED -
or\pwork\pwork\karlosal\1\1\254790\d876490-Design\lncoln.dgn		DRAWN -	REVISED -
PLOT SCALE = 100.0000 / in.		CHECKED -	REVISED -
PLOT DATE = 3/14/2012		DATE -	REVISED -

**STATE OF ILLINOIS
DEPARTMENT OF TRANSPORTATION**

PLAN DIAGRAM

SCALE: NONE SHEET NO. 9 OF 11 SHEETS STA. 585+00 TO STA. 595+00

*FAP 312/FAP 861/FAU 9414/FAU 9415			
F.A.P. RTE.	SECTION	COUNTY	TOTAL SHEETS
*	019, 119-1/RS-2, 175-1/RS-2	RANDOLPH	37 23
FED. ROAD DIST. NO.		ILLINOIS FED. AID PROJECT	
		CONTRACT NO. 76E90	