

STATE OF ILLINOIS
DEPARTMENT OF TRANSPORTATION
DIVISION OF HIGHWAYS

**PROPOSED
HIGHWAY PLANS**

ROUTE IL 34 (FAP 869)
SECTION 105R-1
PROJECT ACF-0869(041)
TYPE of IMPROVEMENT: SPECIAL PROJECT
SALINE COUNTY

C-99-018-12

F.A.P. RTE.	SECTION	COUNTY	TOTAL SHEETS	SHEET NO.
869	105R-1	SALINE	26	1
		ILLINOIS	CONTRACT NO. 78290	

D-99-014-12

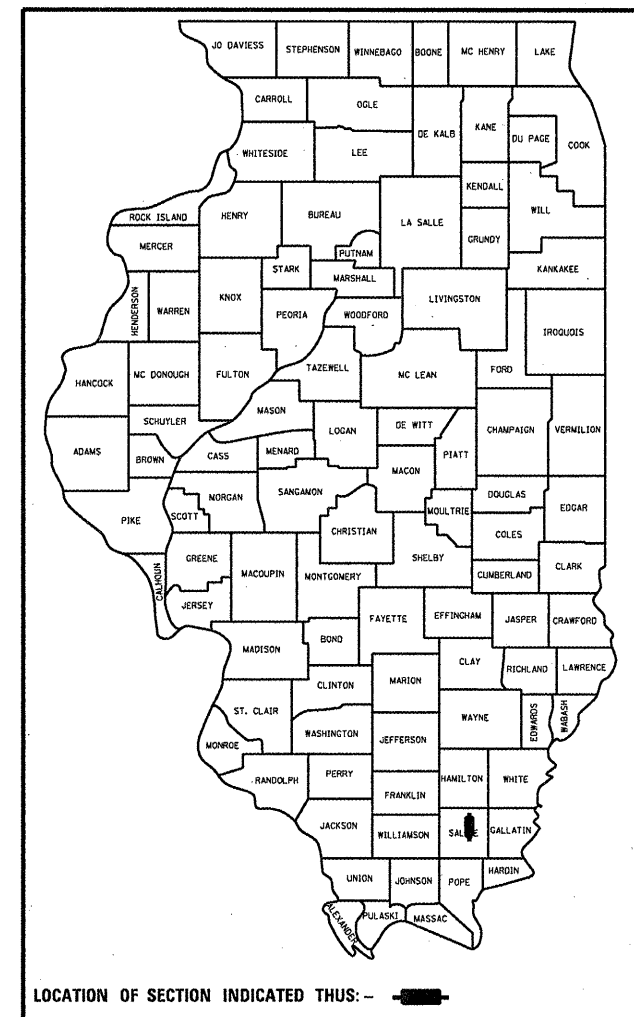

FOR INDEX OF SHEETS, SEE SHEET NO. 3

OMISSIONS:

STA 1541+73.28 TO STA 1542+26.72
STA 1560+92.40 TO STA 1562+47.60
STA 1573+62.10 TO STA 1574+37.90
STA 1581+78.51 TO STA 1582+81.49

ADT (2011)
PV= 3459
MU= 707
SU= 227
TRUCKS= 19.2%

STATION EQUATIONS: NONE

TFpcc= 24.50
TFhmq= 20.29

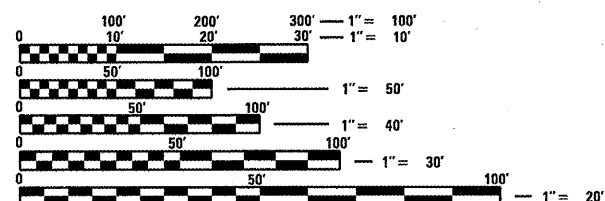
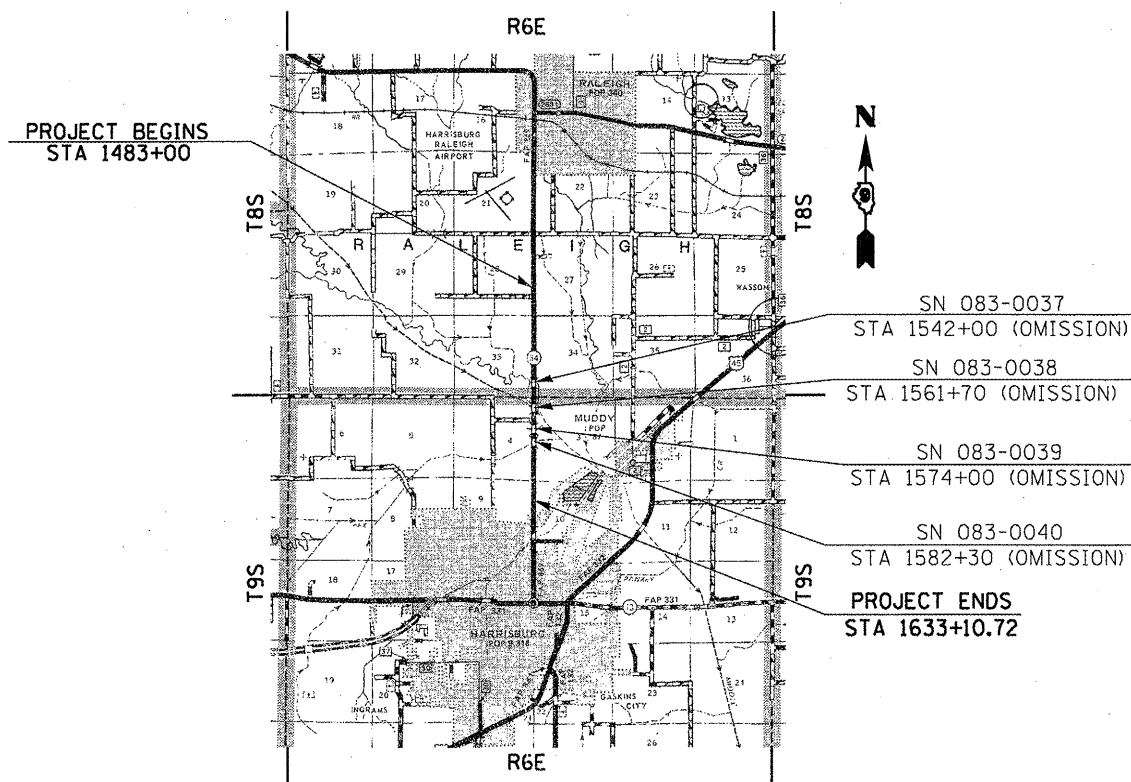

FULL SIZE PLANS HAVE BEEN PREPARED USING STANDARD ENGINEERING SCALES. REDUCED SIZED PLANS WILL NOT CONFORM TO STANDARD SCALES. IN MAKING MEASUREMENTS ON REDUCED PLANS, THE ABOVE SCALES MAY BE USED.

J.U.L.I.E.
JOINT UTILITY LOCATION INFORMATION FOR EXCAVATION
1-800-892-0123
OR 811

PROJECT ENGINEER: CHARLES STEIN
PROJECT DESIGNER: JULIO S. AYBAR

CONTRACT NO. 78290

GROSS LENGTH = 15,010 FT. = 2.84 MILES
NET LENGTH = 14,623 FT. = 2.77 MILES
OMISSION LENGHT = 387.4 FT. = 0.07 MILE

STATE OF ILLINOIS
DEPARTMENT OF TRANSPORTATION
DIVISION OF HIGHWAYS

SUBMITTED March 21 20 12
Chris Ammon
DEPUTY DIRECTOR OF HIGHWAYS, REGION ENGINEER

May 11 20 12
John D. Baranzelli, P.E. JR
ENGINEER OF DESIGN AND ENVIRONMENT

May 11 20 12
William R. Frey JR
DIRECTOR OF HIGHWAYS, CHIEF ENGINEER

PRINTED BY THE AUTHORITY
OF THE STATE OF ILLINOIS