

STATE OF ILLINOIS
DEPARTMENT OF TRANSPORTATION
DIVISION OF HIGHWAYS

**PROPOSED
HIGHWAY PLANS**

ROUTE IL 34 (FAP 869)
SECTION 105R-1
PROJECT ACF-0869(041)
TYPE of IMPROVEMENT: SPECIAL PROJECT
SALINE COUNTY

C-99-018-12

F.A.P. RTE.	SECTION	COUNTY	TOTAL SHEETS	SHEET NO.
869	105R-1	SALINE	26	1
		ILLINOIS	CONTRACT NO. 78290	

D-99-014-12

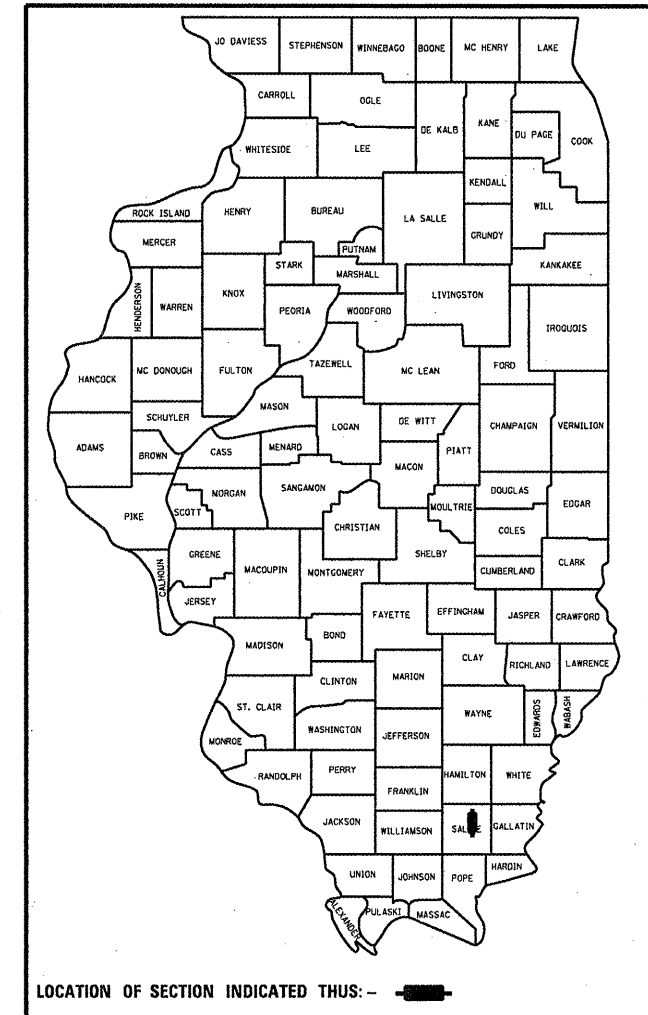

FOR INDEX OF SHEETS, SEE SHEET NO. 3

OMISSIONS:

STA 1541+73.28 TO STA 1542+26.72
STA 1560+92.40 TO STA 1562+47.60
STA 1573+62.10 TO STA 1574+37.90
STA 1581+78.51 TO STA 1582+81.49

ADT (2011)
PV= 3459
MU= 707
SU= 227
TRUCKS= 19.2%

STATION EQUATIONS: NONE

TFpcc= 24.50
TFhmq= 20.29

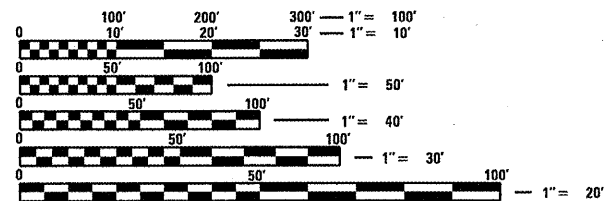
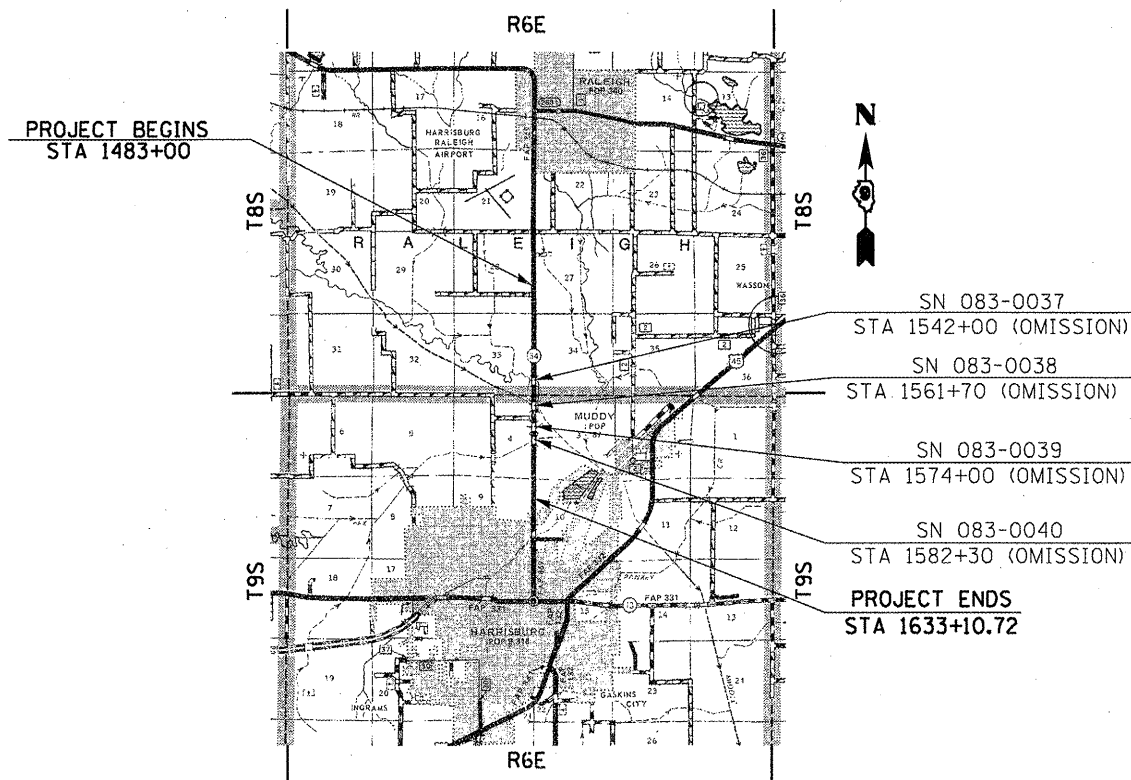

FULL SIZE PLANS HAVE BEEN PREPARED USING STANDARD ENGINEERING SCALES. REDUCED SIZED PLANS WILL NOT CONFORM TO STANDARD SCALES. IN MAKING MEASUREMENTS ON REDUCED PLANS, THE ABOVE SCALES MAY BE USED.

J.U.L.I.E.
JOINT UTILITY LOCATION INFORMATION FOR EXCAVATION
1-800-892-0123
OR 811

PROJECT ENGINEER: CHARLES STEIN
PROJECT DESIGNER: JULIO S. AYBAR

CONTRACT NO. 78290

GROSS LENGTH = 15,010 FT. = 2.84 MILES
NET LENGTH = 14,623 FT. = 2.77 MILES
OMISSION LENGHT = 387.4 FT. = 0.07 MILE

STATE OF ILLINOIS
DEPARTMENT OF TRANSPORTATION
DIVISION OF HIGHWAYS

SUBMITTED March 21 20 12
Chris Ammon
DEPUTY DIRECTOR OF HIGHWAYS, REGION ENGINEER

May 11 20 12
John D. Baranzelli, P.E. JR
acting ENGINEER OF DESIGN AND ENVIRONMENT

May 11 20 12
William R. Frey JR
acting DIRECTOR OF HIGHWAYS, CHIEF ENGINEER

PRINTED BY THE AUTHORITY
OF THE STATE OF ILLINOIS

Prepared By: Joe Zdaniewicz
DISTRICT STUDIES & PLANS ENGINEER

Examined By: James H. Emry
DISTRICT LAND ACQUISITION ENGINEER

Examined By: Carrie Nelson
DISTRICT PROGRAM DEVELOPMENT ENGINEER

Examined By: Paul Kelly
DISTRICT OPERATIONS ENGINEER

Examined By: [Signature]
DISTRICT PROJECT IMPLEMENTATION ENGINEER

Examined By: David J. Nuss
DISTRICT CONSTRUCTION ENGINEER

Examined By: Bruce W. Peltier
DISTRICT MATERIALS ENGINEER

Approved By: Omer Asmussen
DEPUTY DIRECTOR OF HIGHWAYS, REGION 5 ENGINEER

March 20 2012
DATE

FILE NAME =	USER NAME = #USER#	DESIGNED -	REVISED -
ca\pwwork\pwwork\eybarje\0290959\7829	-design\dgn	DRAWN -	REVISED -
	PLOT SCALE = 100.0000' / 1in.	CHECKED -	REVISED -
	PLOT DATE = 3/19/2012	DATE -	REVISED -

**STATE OF ILLINOIS
DEPARTMENT OF TRANSPORTATION**

SIGNATURE SHEET

SCALE: SHEET OF SHEETS STA. TO STA.

F.A.P. RTE.	SECTION	COUNTY	TOTAL SHEETS	SHEET NO.
869	105R-1	SALINE	26	2
ILLINOIS FED. AID PROJECT			CONTRACT NO. 78290	

INDEX OF SHEETS

SHEET NO.	DESCRIPTION
1	COVER SHEET
2	SIGNATURE SHEET
3	INDEX OF SHEETS, HIGHWAY STANDARDS, GENERAL NOTES
4	MIXTURE REQUIREMENTS
5-7	SUMMARY OF QUANTITIES
8	ALTERNATE QUANTITIES
9-10	TYPICAL SECTIONS
11	REMOVAL STAGING
12-13	RESURFACING SCHEDULES
14	PAVEMENT MARKING SCHEDULE, SEEDING SCHEDULE
15-20	PLAN LAYOUT FOR FAP 869 (IL 34) STA 1483+00 TO STA 1633+10.72
21	DETAIL: HMA SURFACE REMOVAL - BUTT JOINT, SAFETY EDGE
22	SIDE ROAD AND ENTRANCE DETAIL
23	STANDARD DETAILS: TEMP HOT-MIX ASPHALT TRANSITIONS
24	STANDARD DETAILS: UNEVEN LANES SIGN

HIGHWAY STANDARDS

442201-03	701311-03
701001-02	701336-06
701006-03	BLR 21-9
701011-02	BLR 22-7
701301-04	781001-03
701306-03	701901-02

GENERAL NOTES

THE THICKNESS OF BITUMINOUS MIXTURE SHOWN ON THE PLANS IS THE NOMINAL THICKNESS. DEVIATIONS FROM THE NOMINAL THICKNESS WILL BE PERMITTED WHEN SUCH DEVIATION OCCURS DUE TO IRREGULARITIES IN THE EXISTING SURFACE OR BASE ON WHICH THE BITUMINOUS MIXTURE IS PLACED.

FACTORS USED FOR ESTIMATING PLAN QUANTITIES ARE AS FOLLOWS AND SHALL NOT BE USED FOR THE BASIS OF FINAL QUANTITIES EXCEPT FOR QC/QA OF BITUMINOUS MIXTURES:

ALL HOT-MIX ASPHALT.....2.016 TONS/CU. YD.

ALL AGGREGATE.....2.05 TONS/CU. YD.

BITUMINOUS MATERIALS (PRIME COAT)

ON PAVEMENT....0.09 GALS/SQ. YD.

AGGREGATE (PRIME COAT).....0.0015 TONS/SQ. YD.

WEIGHT OF EARTH TO DETERMINE LIME.....2835 LB/CU. YD.

THE QUANTITY OF SHORT TERM PAVEMENT MARKING SHOWN IN THE PLANS WAS BASED ON ONE APPLICATION EACH FOR THE HMA SURFACE COURSE AND HMA BINDER AT THE RESURFACING LIMITS.

PRIOR TO PLACEMENT OF THE FINAL PAVEMENT MARKINGS, THE RESIDENT ENGINEER SHALL CONTACT THE BUREAU OF OPERATIONS AND ARRANGE FOR INSPECTION AND APPROVAL OF THE PAVEMENT MARKING LAYOUT.

THE CONTRACTOR SHALL STAMP STATIONING IN THE PROPOSED FULL DEPTH PAVEMENT OR HMA RESURFACING AT 300 FT. INTERVALS ON ALTERNATING SIDES OF THE PAVEMENT AND AS DIRECTED BY THE ENGINEER. THE STATION SYMBOL STAMPS USED SHALL BE FURNISHED BY THE CONTRACTOR. THEY SHALL BE 5 1/2" TALL OF A DESIGN APPROVED BY THE ENGINEER AND SHALL REMAIN THE PROPERTY OF THE CONTRACTOR.

UNLESS OTHERWISE DIRECTED BY THE ENGINEER, BITUMINOUS RESURFACING SHALL BE PLACED IN A SEQUENCE THAT WILL MINIMIZE THE TIME THE CENTER -LINE EDGE IS EXPOSED TO TRAFFIC.

QUANTITIES SHOWN IN THE PLANS FOR PATCHING ARE ESTIMATES. THE ACTUAL AMOUNT OF PATCHING REQUIRED SHALL BE DETERMINED BY THE ENGINEER IN THE FIELD. THE PATCHING SURVEY DATE WAS ON 2/2/12

RECLAIMED ASPHALT PAVEMENT (RAP) WILL NOT BE ALLOWED FOR USE AS AGGREGATE IN AGGREGATE SHOULDERS, TYPE B.

THE STRINGLINE GRADE SUPPORTS SHALL BE PLACED AT 25' INTERVALS. THE STRINGLINE AND SUPPORTS SHALL BE OFFSET SO AS NOT TO INTERFERE WITH ROLLING OPERATIONS.

COMMITMENT:

A COMMITMENT IS MADE TO PROPERTY OWNERS JOHN BASHAM AND PERVIS ELLIS TO PROVIDE ACCESS DURING THE CLOSURE OF ILL 34. THE CONTRACTOR MAY NEED TO ACCOMMODATE FARM EQUIPMENT.

FILE NAME =	USER NAME = aybar.js	DESIGNED -	REVISED -	STATE OF ILLINOIS DEPARTMENT OF TRANSPORTATION	INDEX OF SHEETS	F.A.P. RTE.	SECTION	COUNTY	TOTAL SHEETS	SHEET NO.
ca:\pwwork\pwwork\aybar.js\d0298959\7829	design.dgn	DRAWN -	REVISED -			869	105R-1	SALINE	26	3
	PLOT SCALE = 100.0000' / 1" =	CHECKED -	REVISED -		SCALE: _____ SHEET _____ OF _____ SHEETS STA. _____ TO STA. _____					
	PLOT DATE = 5/8/2012	DATE -	REVISED -							
[ILLINOIS] FED. AID PROJECT										

MIXTURE REQUIREMENTS

Location(s):	Hot-Mix Asphalt Surface Course
Mixture Use(s):	Polymerized Hot-Mix Asphalt Surface Course, Mix D, N105
AC/PG:	SBS PG76-22
RAP % (Max):	0
Design Air Voids:	4.0 %, 105 Gyration Design
Mixture Composition: (Gradation Mixture)	IL-9.5 mm or IL12.5 mm
Friction Aggregate:	D Surface

Location(s):	Hot-Mix Asphalt Binder Course (Lower Lifts)
Mixture Use(s):	Hot-Mix Asphalt Binder Course, N90, IL-19.0
AC/PG:	PG64-22
RAP % (Max):	10
Design Air Voids:	4.0 %, 90 Gyration Design
Mixture Composition: (Gradation Mixture)	IL-19.0 mm
Friction Aggregate:	None

Location(s):	Hot-Mix Asphalt Binder Course (Top Lift)
Mixture Use(s):	Polymerized Hot-Mix Asphalt Binder Course, N105, IL-19.0
AC/PG:	SBS PG76-22
RAP % (Max):	0
Design Air Voids:	4.0 %, 105 Gyration Design
Mixture Composition: (Gradation Mixture)	IL-19.0
Friction Aggregate:	None

Location(s):	Hot-Mix Asphalt Shoulders
Mixture Use(s):	Hot-Mix Asphalt Shoulders, N30
AC/PG:	PG58-22
RAP % (Max):	50
Design Air Voids:	2.0 %, 30 Gyration Design
Mixture Composition: (Gradation Mixture)	HMA Shoulder
Friction Aggregate:	None

FILE NAME =	USER NAME = #USER#	DESIGNED -	REVISED -	STATE OF ILLINOIS DEPARTMENT OF TRANSPORTATION	MIXTURE REQUIREMENTS	F.A.P. RTE.	SECTION	COUNTY	TOTAL SHEETS	SHEET NO.
et:\pwork\puidot\kellejkd\0290960\78290-sht-plan.dgn		DRAWN -	REVISED -			869	105R-1	SALINE	26	4
PLOT SCALE = 100.0000' / in.		CHECKED -	REVISED -							
PLOT DATE = 3/23/2012		DATE -	REVISED -		SCALE: SHEET OF SHEETS STA. TO STA.					CONTRACT NO. 78290
						ILLINOIS FED. AID PROJECT				

SUMMARY OF QUANTITIES

LOCATION	RURAL-STP
ROUTE	FAP 869 (IL 34)
FUNDING	80% FED 20% STATE
COUNTY	SALINE
CONSTRUCTION TYPE	ROADWAY
TYPE CODE	0004

CODE NUMBER	ITEM DESCRIPTION	UNIT	TOTAL QUANTITY	
X2020110	GRADING AND SHAPING SHOULDERS	UNIT	96	96
X2503100	MOWING	UNIT	150	150
* 25000200	SEEDING, CLASS 2	ACRE	4.4	4.4
* 25000400	NITROGEN FERTILIZER NUTRIENT	POUND	396	396
* 25000500	PHOSPHORUS FERTILIZER NUTRIENT	POUND	396	396
* 25000600	POTASSIUM FERTILIZER NUTRIENT	POUND	396	396
* 25000700	AGRICULTURAL GROUND LIMESTONE	TON	9	9
* 25100115	MULCH, METHOD 2	ACRE	4.4	4.4
30200850	PROCESSING MODIFIED SOIL 16"	SO YD	SEE TABLE, SHEET 8	SEE TABLE, SHEET 8
31001500	LIME	TON	SEE TABLE, SHEET 8	SEE TABLE, SHEET 8
31200100	STABILIZED SUBBASE 4"	SO YD	SEE TABLE, SHEET 8	SEE TABLE, SHEET 8
40201000	AGGREGATE FOR TEMPORARY ACCESS	TON	57	57
40600115	POLYMERIZED BITUMINOUS MATERIALS (PRIME COAT)	GALLON	1,408	1,408

NON-PARTICIPATING 100% STATE *SPECIALTY ITEM

FILE NAME =	USER NAME = #USER#	DESIGNED -	REVISED -	STATE OF ILLINOIS DEPARTMENT OF TRANSPORTATION	SUMMARY OF QUANTITIES			F.A.P. RTE.	SECTION	COUNTY	TOTAL SHEETS	SHEET NO.	
c:\pwwork\pvidot\kellykd\0290960\78290-sht-plan.dgn	DRAWN -	REVISED -	REVISED -					869	105R-1	SALINE	26	5	
PLOT SCALE = 100.0000' / 1"	CHECKED -	REVISED -	REVISED -		SCALE:	SHEET	OF	SHEETS	STA.	TO	STA.	CONTRACT NO. 78290 ILLINOIS FED. AID PROJECT	
PLOT DATE = 3/23/2012	DATE -	REVISED -	REVISED -										

SUMMARY OF QUANTITIES

LOCATION	RURAL-STP
ROUTE	FAP 869 (IL 34)
FUNDING	80% FED 20% STATE
COUNTY	SALINE
CONSTRUCTION TYPE	ROADWAY
TYPE CODE	0004

CODE NUMBER	ITEM DESCRIPTION	UNIT	TOTAL QUANTITY	
40600300	AGGREGATE (PRIME COAT)	TON	23	23
40600982	HOT*MIX ASPHALT SURFACE REMOVAL • BUTT JOINT	SQ YD	31	31
40603245	POLYMERIZED HOT*MIX ASPHALT BINDER COURSE, IL=19.0, N105	TON	1,971	1,971
40603550	POLYMERIZED HOT*MIX ASPHALT SURFACE COURSE, MIX "D", N105	TON	1,314	1,314
40701996	HOT*MIX ASPHALT PAVEMENT (FULL*DEPTH), 15 3/4"	SQ YD	SEE TABLE, SHEET 8	SEE TABLE, SHEET 8
40800050	INCIDENTAL HOT*MIX ASPHALT SURFACING	TON	21	21
42000511	PORTLAND CEMENT CONCRETE PAVEMENT 10 1/2" (JOINTED)	SQ YD	SEE TABLE, SHEET 8	SEE TABLE, SHEET 8
44000100	PAVEMENT REMOVAL	SQ YD	28,782	28,782
44201789	CLASS D PATCHES, TYPE II, 12"	SQ YD	146	146
44201794	CLASS D PATCHES, TYPE III, 12"	SQ YD	17	17
44201796	CLASS D PATCHES, TYPE IV, 12"	SQ YD	26	26
44300200	STRIP REFLECTIVE CRACK CONTROL TREATMENT	FOOT	10,058	10,058

SUMMARY OF QUANTITIES

LOCATION	RURAL-STP
ROUTE	FAP 869 (IL 34)
FUNDING	80% FED 20% STATE
COUNTY	SALINE
CONSTRUCTION TYPE	ROADWAY
TYPE CODE	0004

CODE NUMBER	ITEM DESCRIPTION	UNIT	TOTAL QUANTITY	
48102100	AGGREGATE WEDGE SHOULDERS, TYPE B	TON	1,090	1,090
48203100	HOT-MIX ASPHALT SHOULDERS	TON	469	469
67100100	MOBILIZATION	L SUM	1	1
70100600	TRAFFIC CONTROL AND PROTECTION, STANDARD 701336	L SUM	1	1
70100460	TRAFFIC CONTROL AND PROTECTION, STANDARD 701306	L SUM	1	1
70101830	TRAFFIC CONTROL AND PROTECTION, STANDARD BLR 21	L SUM	1	1
70101835	TRAFFIC CONTROL AND PROTECTION, STANDARD BLR 22	L SUM	1	1
70300100	SHORT- TERM PAVEMENT MARKING	FOOT	3,002	3,002
70300220	TEMPORARY PAVEMENT MARKING, LINE 4"	FOOT	33,774	33,774
72000100	SIGN PANEL - TYPE 1	SQ FT	299	299
70301000	WORK ZONE PAVEMENT MARKING REMOVAL	SQ FT	12,259	12,259
72900100	METAL POST - TYPE A	FOOT	385	385
* 78001110	PAINT PAVEMENT MARKING • LINE 4"	FOOT	33,774	33,774
* 78100100	RAISED REFLECTIVE PAVEMENT MARKER	EACH	188	188
78300200	RAISED REFLECTIVE PAVEMENT MARKER REMOVAL	EACH	63	63

*SPECIALTY ITEM

FILE NAME *	USER NAME * #USER*	DESIGNED -	REVISED -	STATE OF ILLINOIS DEPARTMENT OF TRANSPORTATION	SUMMARY OF QUANTITIES			F.A.P. RTE.	SECTION	COUNTY	TOTAL SHEETS	SHEET NO.
es:\pr_work\pwidot\kellykd\0290960\78290	0-shr-plan.dgn	DRAWN -	REVISED -					869	105R-1	SALINE	26	7
PLOT SCALE * 100.0000' / in.	CHECKED -	REVISED -	REVISED -		CONTRACT NO. 78290			ILLINOIS FED. AID PROJECT				
PLOT DATE * 3/23/2012	DATE -	REVISED -	REVISED -		SCALE:	SHEET	OF			SHEETS	STA.	TO STA.

TABLE OF ALTERNATE QUANTITIES

		LOCATION	RURAL-STP	
		FUNDING	80% FED 20% STATE	
		TYPE CODE	0004	
CODE NUMBER	ITEM DESCRIPTION	UNIT	ALTERNATE A QUANTITY	ALTERNATE B QUANTITY
30200850	PROCESSING MODIFIED SOIL 16"	SO YD	33,046	30,914
31001500	LIME	TON	1,061	974
31200100	STABILIZED SUBBASE 4"	SO YD	0	29,848
40701996	HOT-MIX ASPHALT PAVEMENT (FULL-DEPTH), 15 3/4"	SO YD	29,848	0
42000511	PORTLAND CEMENT CONCRETE PAVEMENT 10 1/2" (JOINTED)	SO YD	0	29,848

- NOTES:
 1. ALT. A HOT-MIX PAVEMENT (FULL DEPTH)
 2. ALT. B PORTLAND CEMENT CONCRETE PAVEMENT

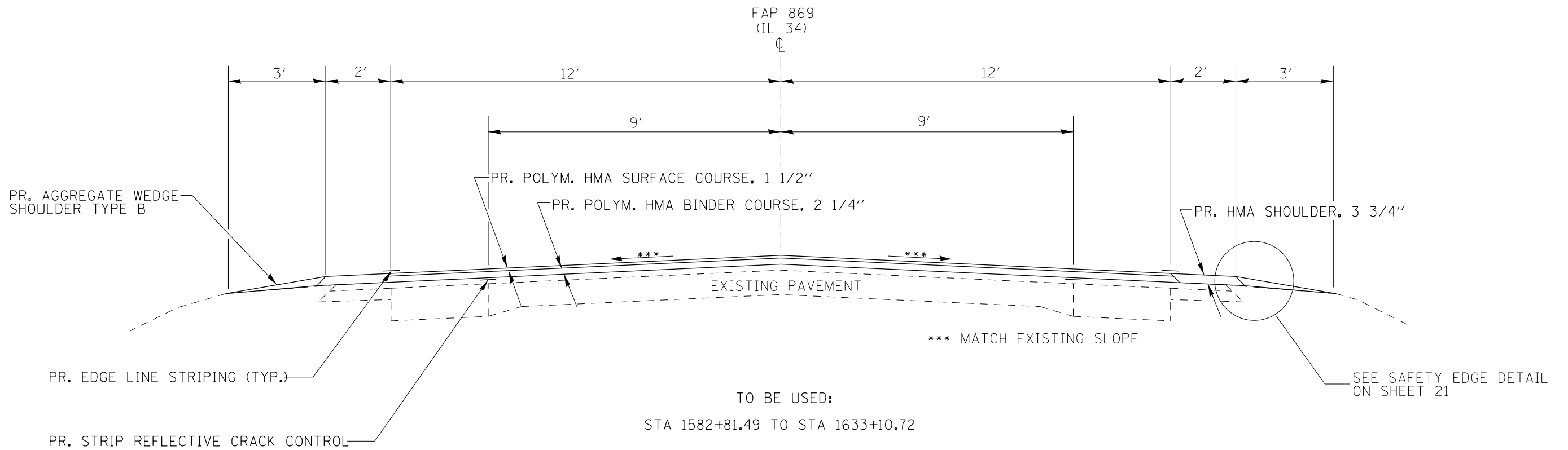
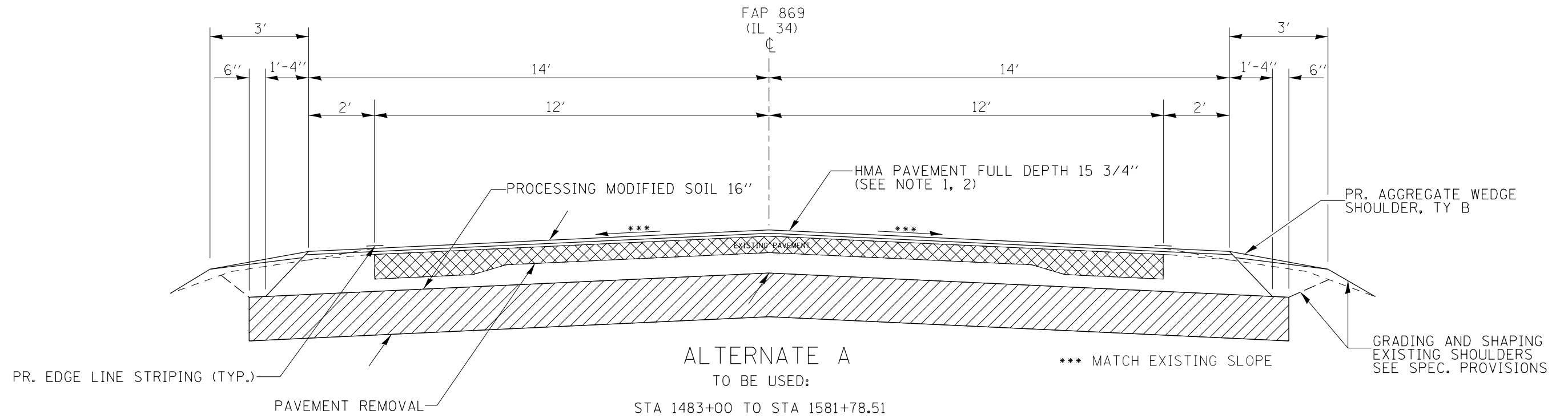

NOTE 1: POLYMERIZED HMA SURFACE COURSE, MIX D, N105, 2"
NOTE 2: HMA BINDER COURSE, N90, IL-19.0 (LOWER LIFTS), 11 1/2"
POLYMERIZED HMA BINDER, N105, IL-19.0 (TOP LIFT), 2 1/4"

FILE NAME =	USER NAME = \$USER\$	DESIGNED -	REVISED -	STATE OF ILLINOIS DEPARTMENT OF TRANSPORTATION	TYPICAL SECTIONS			F.A.P. RTE.	SECTION	COUNTY	TOTAL SHEETS	SHEET NO.				
et:\pwork\pwork\kellykd\0290960\78290-sht-plan.dgn		DRAWN -	REVISED -		SCALE:	SHEET	OF	SHEETS	STA.	TO	STA.	869	105R-1	SALINE	26	9
		PLOT SCALE = 100.0000' / in.	CHECKED -	REVISED -								CONTRACT NO. 78290				
		PLOT DATE = 3/23/2012	DATE -	REVISED -								ILLINOIS FED. AID PROJECT				

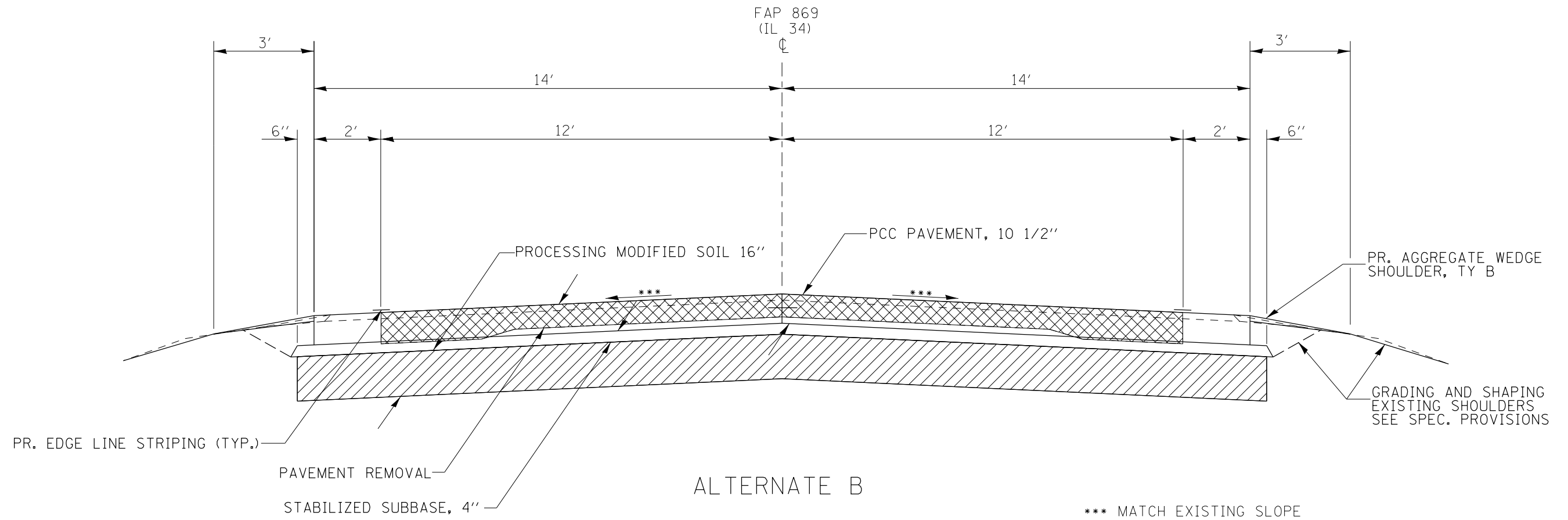

TO BE USED:
STA 1483+00 TO STA 1581+78.51

FILE NAME =	USER NAME = \$USER*	DESIGNED -	REVISED -	STATE OF ILLINOIS DEPARTMENT OF TRANSPORTATION	TYPICAL SECTIONS	F.A.P. RTE.	SECTION	COUNTY	TOTAL SHEETS	SHEET NO.
et:\pwork\pwork\kellykd\0290960\78290	0-sht-plan.dgn	DRAWN -	REVISED -			869	105R-1	SALINE	26	10
	PLOT SCALE = 100.0000' / in.	CHECKED -	REVISED -			CONTRACT NO. 78290		ILLINOIS FED. AID PROJECT		
	PLOT DATE = 3/23/2012	DATE -	REVISED -		SCALE:	SHEET	OF	SHEETS	STA.	TO STA.

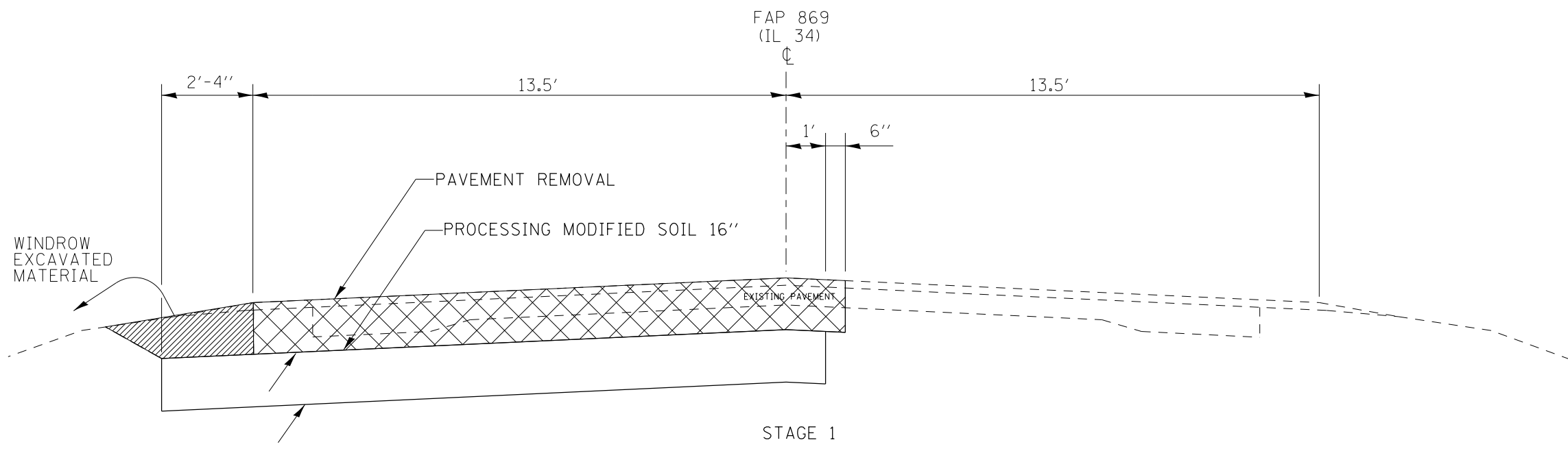

STAGE 1
TO BE USED:
STA 1483+00 TO STA 1581+78.51

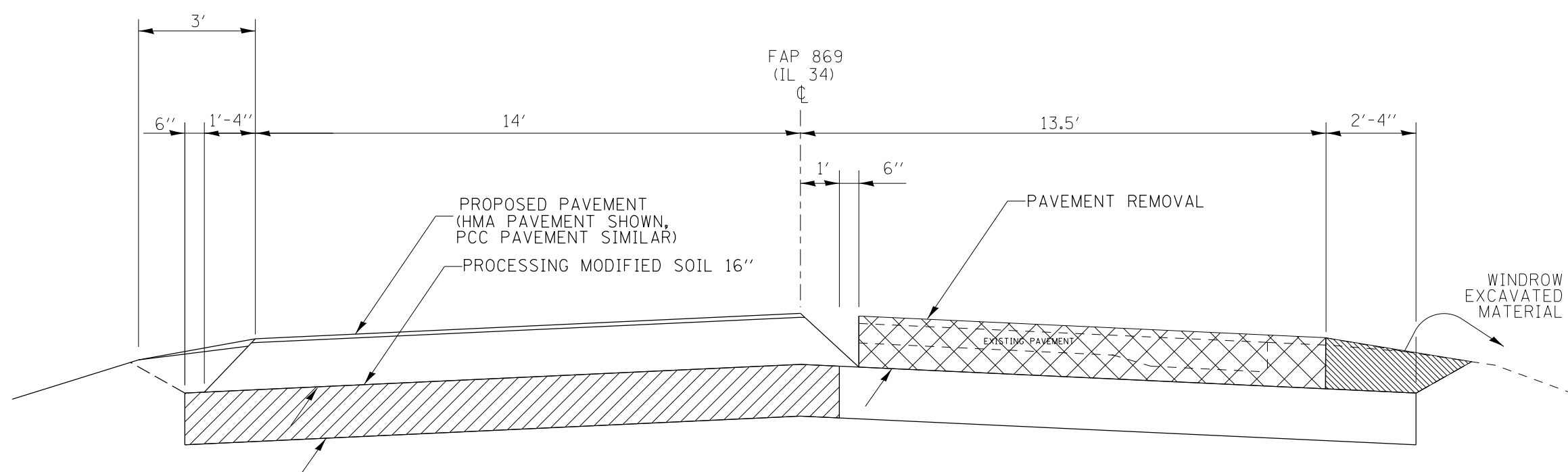

STAGE 2
TO BE USED:
STA 1483+00 TO STA 1581+78.51

FILE NAME =	USER NAME = \$USER\$	DESIGNED -	REVISED -	STATE OF ILLINOIS DEPARTMENT OF TRANSPORTATION	REMOVAL STAGING				F.A.P. RTE.	SECTION	COUNTY	TOTAL SHEETS	SHEET NO.
et:\pwork\pwork\kellykd\0290960\78290-sht-plan.dgn		DRAWN -	REVISED -		869	105R-1	SALINE	26	11				
	PLOT SCALE = 100.0000' / 1".	CHECKED -	REVISED -		SCALE: SHEET OF SHEETS STA. TO STA.				CONTRACT NO. 78290				
	PLOT DATE = 3/23/2012	DATE -	REVISED -		ILLINOIS FED. AID PROJECT								

ALTERNATE A IL 34 PAVEMENT REPLACEMENT SCHEDULE

LOCATION STATION TO STATION			LENGTH	ROADWAY WIDTH		ROADWAY AREA		PAVEMENT REMOVAL	PROCESSING MODIFIED SOIL 16"	LIME AT 5%	HMA PAVEMENT FULL DEPTH, 15 3/4"	AGG. WEDGE SHOULDER, TYPE B
			EXISTING (FOR INFORMATIONAL PURPOSES ONLY)									
			FT	FT		SQ YD		SQ YD	SQ YD	TON	SQ YD	TON
			EXISTING	PROPOSED	EXISTING	PROPOSED						
1483+00.0	TO	1541+73.3	5873.28	27	28	17620	18272	17620	20230	650	18272	446
OMISSION STR 083-0037 STA 1541+73.28 TO STA 1542+26.72												
1542+26.7	TO	1560+92.4	1865.68	27	28	5597	5804	5597	6426	206	5804	142
OMISSION STR 083-0038 STA 1560+92.4 TO STA 1562+47.6												
1562+47.6	TO	1573+62.1	1114.5	27	28	3344	3467	3344	3839	123	3467	85
OMISSION STR 083-0039 STA 1573+62.1 TO STA 1574+37.9												
1574+37.9	TO	1581+78.5	740.61	27	28	2222	2304	2222	2551	82	2304	56
PAVEMENT REPLACEMENT TOTALS			9594					28782	33046	1061	29848	728
			1.82	MILES								

IL 34 STRUCTURAL OVERLAY SCHEDULE

LOCATION STATION TO STATION			LENGTH	ROADWAY WIDTH		ROADWAY AREA		POLYMERIZED BINDER COURSE, 2 1/4"	POLYMERIZED SURFACE COURSE, 1 1/2"	HMA SHOULDER, 3 3/4"	STRIP REFLECTIVE CRACK CONTROL	AGG. WEDGE SHOULDER, TYPE B	POLY. BIT. MAT. (PRIME COAT)	AGGREGATE (PRIME COAT)	HMA SURFACE REMOVAL, BUTT JOINT
			EXISTING (FOR INFORMATIONAL PURPOSES ONLY)												
			FT	FT		SQ YD		TON	TON	TON	FOOT	TON	GAL	TON	SQ YD
			EXISTING	PROPOSED	EXISTING	PROPOSED									
OMISSION STR 083-0040 STA 1581+78.5 TO STA 1582+81.5															
1582+81.5	TO	1633+10.7	5029	27	28	15088	15646	1971	1314	469	10058		1408	23	31
1582+81.5	TO	1630+50.0	4769	AGG. SHDR LT. & RT.								362			
STRUCTURAL OVERLAY TOTALS			5029					1971	1314	469	10058	362	1408	23	31
			0.95	MILES											

ALTERNATE B IL 34 PAVEMENT REPLACEMENT SCHEDULE ALTERNATE PCC

LOCATION STATION TO STATION	LENGTH	ROADWAY WIDTH		ROADWAY AREA		PAVEMENT REMOVAL	PROCESSING MODIFIED SOIL 16"	LIME AT 5%	PCC PAVEMENT	STABILIZED SUBBASE	AGG. WEDGE SHOULDER, TYPE B
	EXISTING (FOR INFORMATIONAL PURPOSES ONLY)										
	FT	FT		SQ YD		SQ YD	SQ YD	TON	SQ YD	SQ YD	TON
		EXISTING	PROPOSED	EXISTING	PROPOSED						
1483+00.0 TO 1541+73.3	5873.28	27	28	17620	18272	17620	18925	596	18272	18272	446
OMISSION STR 083-0037 STA 1541+73.28 TO STA 1542+26.72											
1542+26.7 TO 1560+92.4	1865.68	27	28	5597	5804	5597	6012	189	5804	5804	142
OMISSION STR 083-0038 STA 1560+92.4 TO STA 1562+47.6											
1562+47.6 TO 1573+62.1	1114.5	27	28	3344	3467	3344	3591	113	3467	3467	85
OMISSION STR 083-0039 STA 1573+62.1 TO STA 1574+37.9											
1574+37.9 TO 1581+78.5	740.61	27	28	2222	2304	2222	2386	75	2304	2304	56
PAVEMENT REPLACEMENT TOTALS	9594					28782	30914	974	29848	29848	728
	1.82	MILES									

SEEDING SCHEDULE

LOCATION STATION TO STATION			LENGTH	WIDTH (2 SIDES)	SEEDING AREA	NITROGEN FERTILIZER	PHOSPHORUS FERTILIZER	POTASSIUM FERTILIZER	AGRICULTURAL GROUND LIMESTONE	SEEDING, CLASS 2	MULCH, METHOD 2	
			(FOR INFORMATION ONLY)									
			FT	FT	ACRES	POUNDS	POUNDS	POUNDS	TONS	ACRE	ACRE	
1483+00.0	TO	1541+73.3	5873.28	20	2.70	243	243	243	5	2.70	2.70	
OMISSION STR 083-0037 STA 1541+73.28 TO STA 1542+26.72												
1542+26.7	TO	1560+92.4	1865.68	20	0.86	77	77	77	2	0.86	0.86	
OMISSION STR 083-0038 STA 1560+92.4 TO STA 1562+47.6												
1562+47.6	TO	1573+62.1	1114.5	20	0.51	46	46	46	1	0.51	0.51	
OMISSION STR 083-0039 STA 1573+62.1 TO STA 1574+37.9												
1574+37.9	TO	1581+78.5	740.61	20	0.34	31	31	31	1	0.34	0.34	
SEEDING TOTALS			9594			396	396	396	9	4.40	4.40	
			1.82	MILES								

PAVEMENT MARKING SCHEDULE

STATION TO STATION	PAINT PAVEMENT MARKING		TEMPORARY	SHORT-TERM	NOTES			
	4 INCH WHITE (EDGE LINE)	4 INCH (SKIP-DASH)	4 INCH	4 INCH				
	FOOT	FOOT	FOOT	FOOT				
MAINLINE: STA 1480+92 TO STA 1633+10.72								
	1483+00.0	TO	1633+10.7	30,021	3,753	33,774	3,002	
TOTAL				30,021	3,753	33,774	3,002	

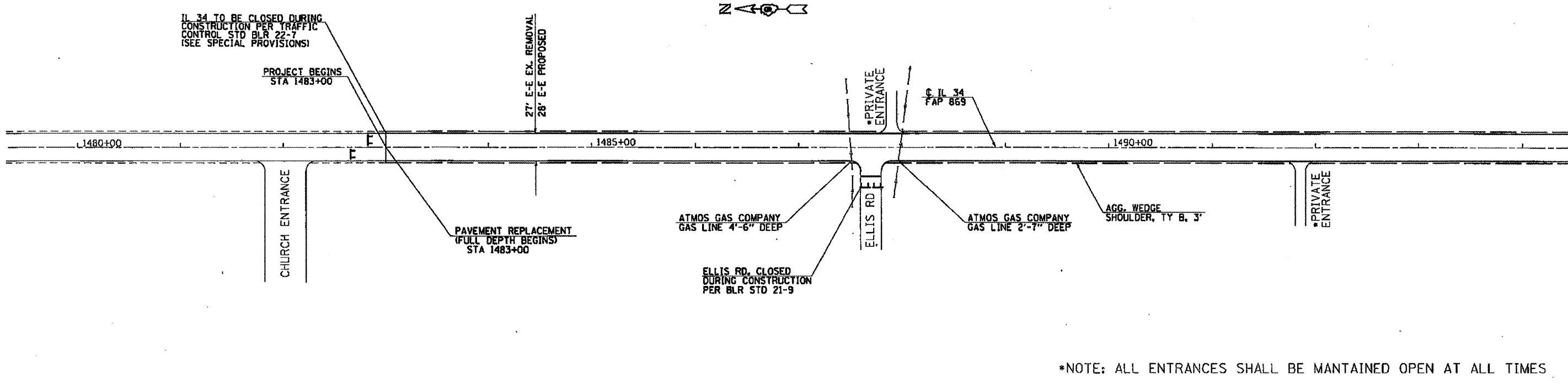

*NOTE: ALL ENTRANCES SHALL BE MANTAINED OPEN AT ALL TIMES

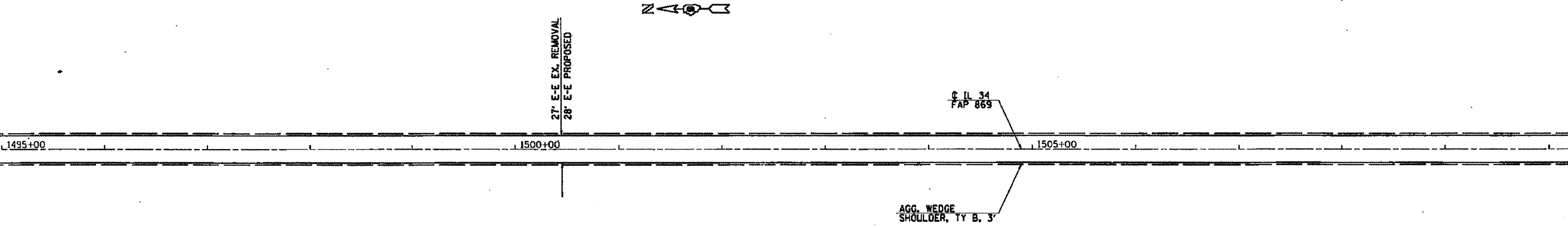

FILE NAME =	USER NAME = egbar.js	DESIGNED -	REVISED -	STATE OF ILLINOIS DEPARTMENT OF TRANSPORTATION	PLAN IL 34	F.A.P. RTE.	SECTION	COUNTY	TOTAL SHEETS	SHEET NO.	
c:\pwork\pwork\pwork\egbar.js\d0210789\7829	-design.dgn	DRAWN -	REVISED -			869	105R-1	SALINE	26	15	
PLOT SCALE = 1/8" = 1'-0"	CHECKED -	REVISED -	REVISED -			SCALE: _____ SHEET _____ OF _____ SHEETS STA. _____ TO STA. _____		CONTRACT NO. 78290			
PLOT DATE = 4/5/2012	DATE -	REVISED -	REVISED -			ILLINOIS F.B. AND PROJECT					

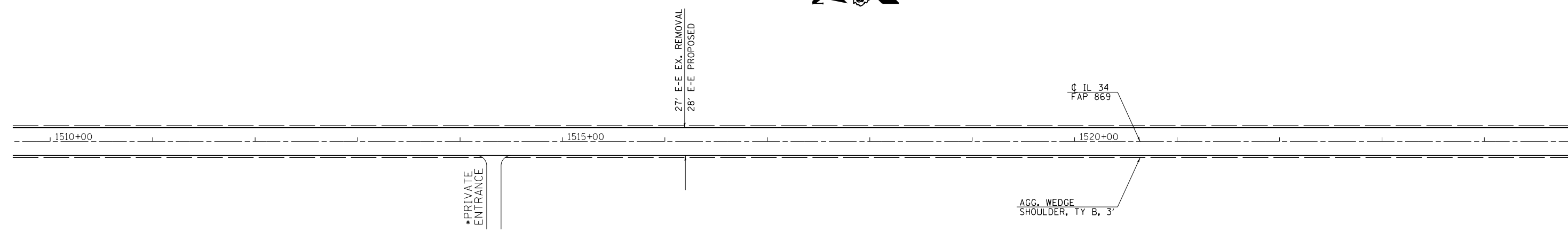

*NOTE: ALL ENTRANCES SHALL BE MANTAINED OPEN AT ALL TIMES

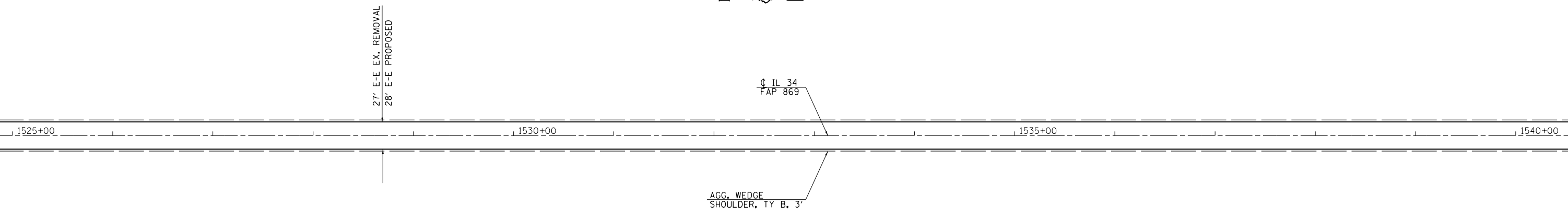
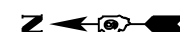

FILE NAME =	USER NAME = \$USER*	DESIGNED -	REVISED -
et:\pwork\pwork\kellykd\0290960\78290-sht-plan.dgn		DRAWN -	REVISED -
	PLOT SCALE = 100.0000' / in.	CHECKED -	REVISED -
	PLOT DATE = 3/23/2012	DATE -	REVISED -

**STATE OF ILLINOIS
DEPARTMENT OF TRANSPORTATION**

PLAN IL 34

SCALE: SHEET OF SHEETS STA. TO STA.

F.A.P. RTE.	SECTION	COUNTY	TOTAL SHEETS	SHEET NO.
869	105R-1	SALINE	26	16
			CONTRACT NO. 78290	
ILLINOIS FED. AID PROJECT				

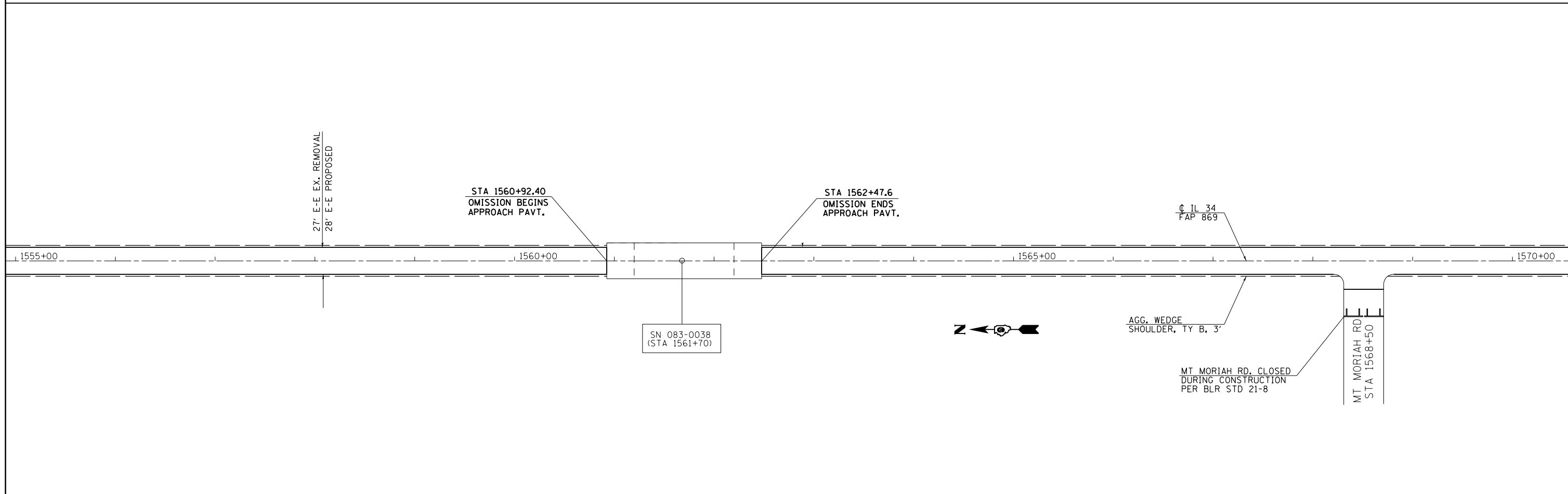
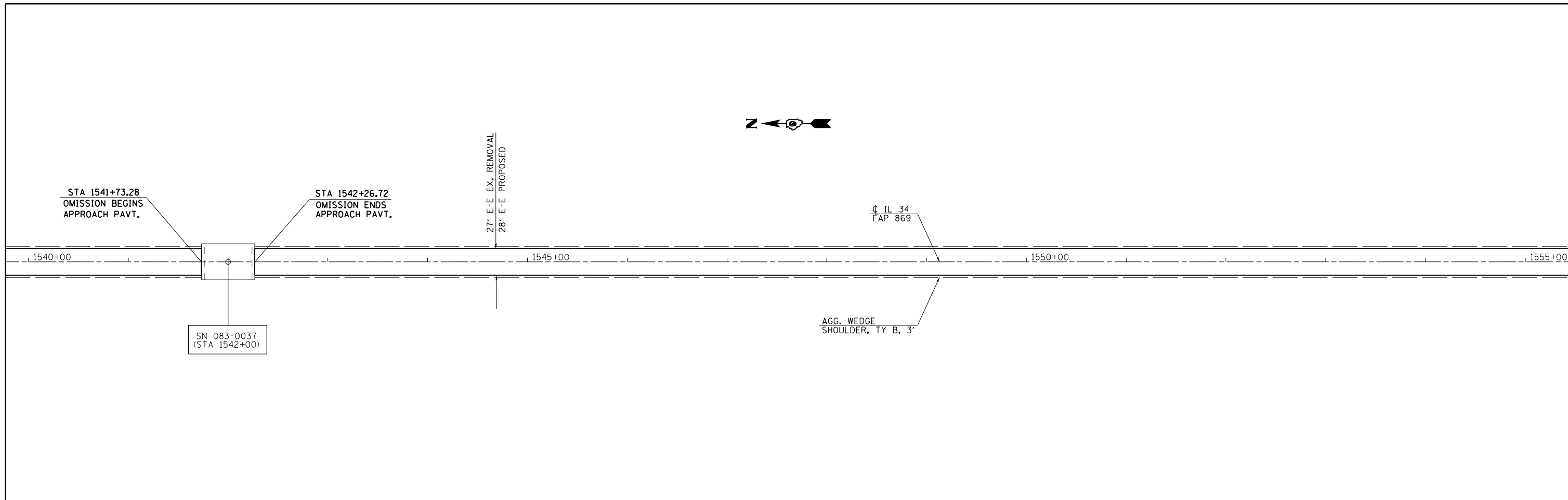

FILE NAME =	USER NAME = \$USER\$	DESIGNED -	REVISED -
et:\pw\work\p\d02\kellykd\0290960\78290-sht-plan.dgn		DRAWN -	REVISED -
	PLOT SCALE = 100.0000' / 1in.	CHECKED -	REVISED -
	PLOT DATE = 3/23/2012	DATE -	REVISED -

**STATE OF ILLINOIS
DEPARTMENT OF TRANSPORTATION**

PLAN IL 34			
SCALE:	SHEET	OF	SHEETS
	STA.	TO	STA.

F.A.P. RTE.	SECTION	COUNTY	TOTAL SHEETS	SHEET NO.
869	105R-1	SALINE	26	17
			CONTRACT NO. 78290	
ILLINOIS FED. AID PROJECT				



STA 1573+62.10
OMISSION BEGINS
APPROACH PAVT.

STA 1574+37.90
OMISSION ENDS
APPROACH PAVT.

STA 1581+78.51
OMISSION BEGINS
APPROACH PAVT.

IL 34 TO BE CLOSED DURING
CONSTRUCTION PER TRAFFIC
CONTROL STD BLR 22-7
(SEE SPECIAL PROVISIONS)

STA 1582+81.49
OMISSION ENDS
APPROACH PAVT.

1570+00 1575+00 1580+00 1585+00

SN 083-0039
(STA 1574+00)

PAVEMENT REPLACEMENT
(FULL DEPTH) ENDS
STA 1581+78.51

SN 083-0040
(STA 1582+30)

STRUCTURAL OVERLAY
BEGINS STA 1582+81.49

PROP. HMA SHOULDER 3 3/4"
BEGINS STA 1582+81.49

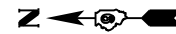

27' E-E EXISTING
28' E-E PROPOSED

IL 34
FAP 869

1590+00 1595+00 1600+00

PR. HMA SHOULDER
(SEE TYPICAL)

AGG. WEDGE
SHOULDER, TY B, 3'

FILE NAME =	USER NAME = \$USER*	DESIGNED -	REVISED -
et:\pw\work\p\idot\k\elleykd\0290960\78290-sht-plan.dgn		DRAWN -	REVISED -
	PLOT SCALE = 100.0000' / in.	CHECKED -	REVISED -
	PLOT DATE = 3/23/2012	DATE -	REVISED -

STATE OF ILLINOIS
DEPARTMENT OF TRANSPORTATION

SCALE: SHEET OF SHEETS STA. TO STA.

PLAN IL 34

F.A.P. RTE.	SECTION	COUNTY	TOTAL SHEETS	SHEET NO.
869	105R-1	SALINE	26	18
CONTRACT NO. 78290				
ILLINOIS FED. AID PROJECT				

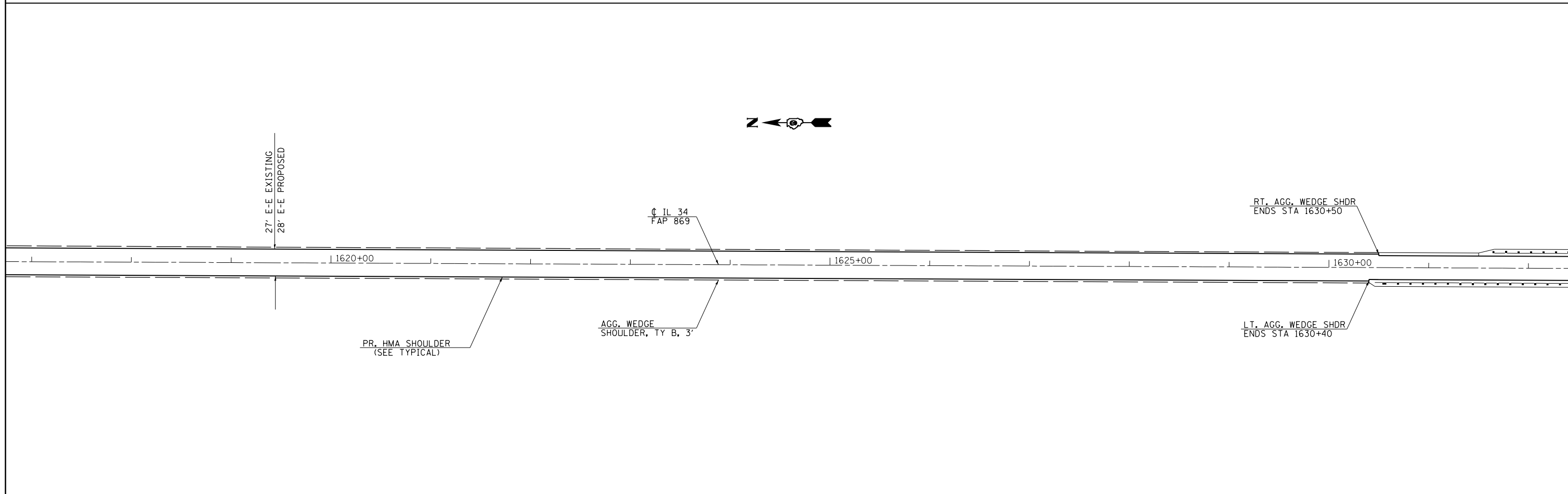
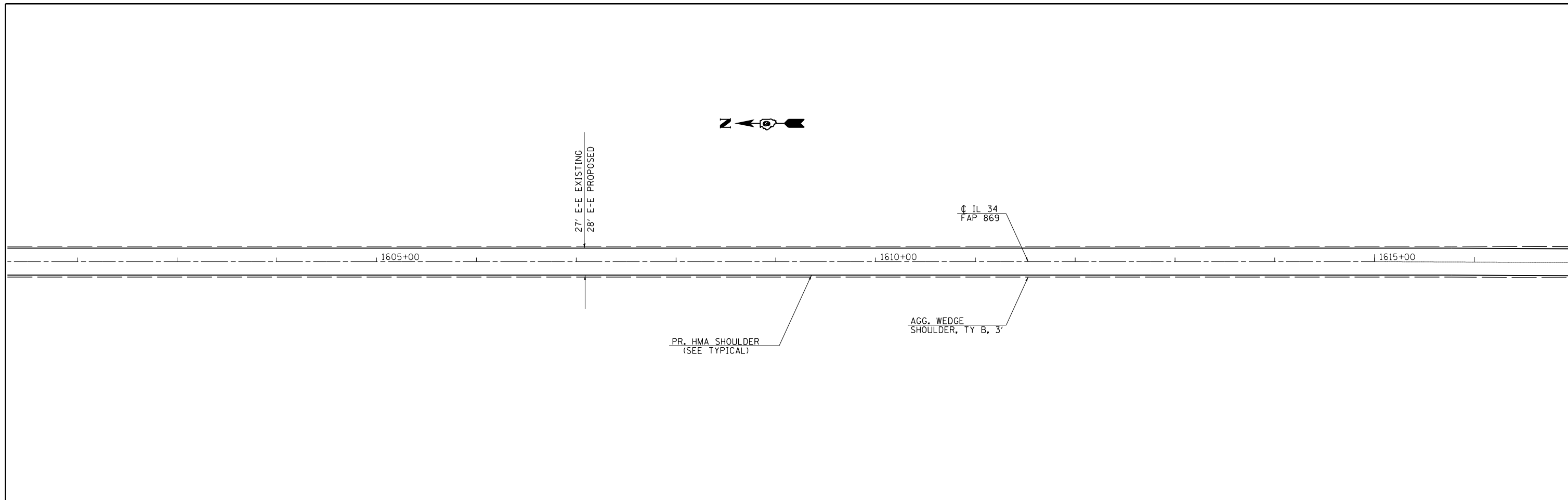

FILE NAME =	USER NAME = \$USER*	DESIGNED -	REVISED -	STATE OF ILLINOIS DEPARTMENT OF TRANSPORTATION	PLAN IL 34		F.A.P. RTE.	SECTION	COUNTY	TOTAL SHEETS	SHEET NO.
et:\pwork\pwork\kellykd\0290960\78290-sht-plan.dgn		DRAWN -	REVISED -				869	105R-1	SALINE	26	19
	PLOT SCALE = 100.0000' / in.	CHECKED -	REVISED -		SCALE: SHEET OF SHEETS STA. TO STA.		CONTRACT NO. 78290		ILLINOIS FED. AID PROJECT		
	PLOT DATE = 3/23/2012	DATE -	REVISED -								

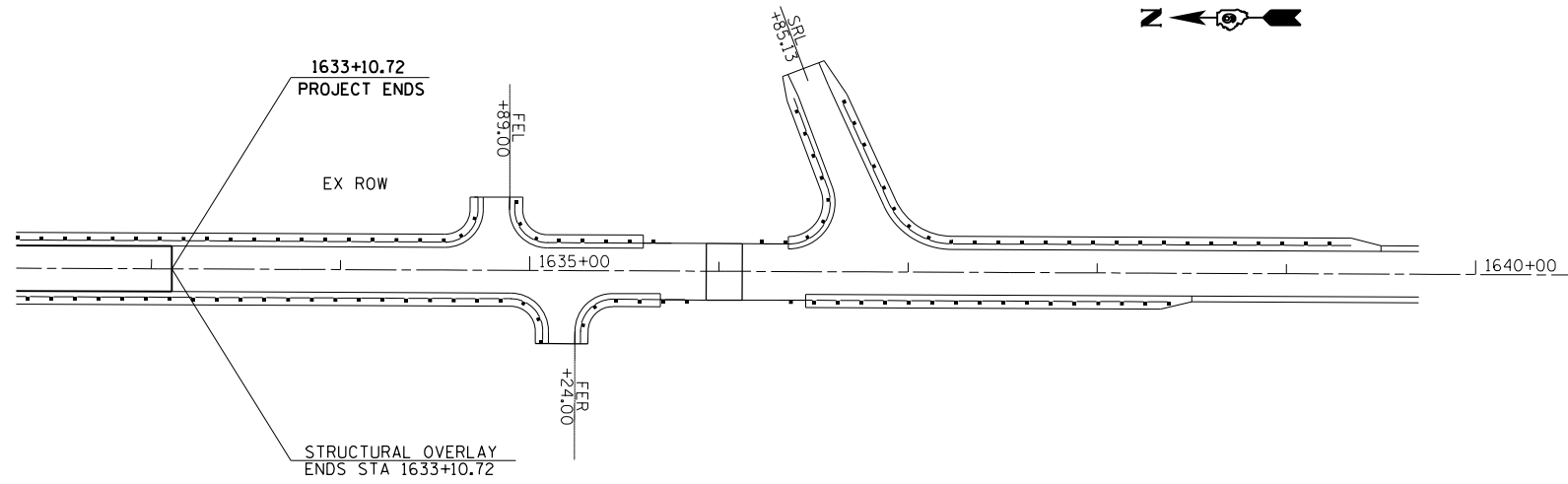

FILE NAME =	USER NAME = \$USER\$	DESIGNED -	REVISED -
c:\pw\work\p1dot\kellykd\0290960\78290-sht-plan.dgn		DRAWN -	REVISED -
	PLOT SCALE = 100.0000' / 1in.	CHECKED -	REVISED -
	PLOT DATE = 3/23/2012	DATE -	REVISED -

**STATE OF ILLINOIS
DEPARTMENT OF TRANSPORTATION**

SCALE: SHEET OF SHEETS STA. TO STA.

PLAN IL 34

F.A.P. RTE.	SECTION	COUNTY	TOTAL SHEETS	SHEET NO.
869	105R-1	SALINE	26	20
CONTRACT NO. 78290			ILLINOIS FED. AID PROJECT	

- 3 PROPOSED SIGN
- A — EXISTING SIGN

PLACE PROPOSED SIGN WITHIN 200' OF THE EXISTING SIGN IN RURAL AREAS. FOR PROPOSED SIGNS IN CITY LIMITS, THE SIGNS SHALL BE PLACED SO THEY DO NOT INTERFERE WITH EXISTING SIGNS AND AS DIRECTED BY THE ENGINEER.

SIGN DETAIL

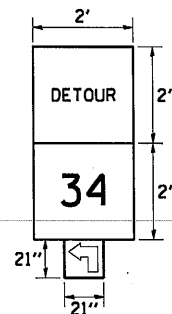

NOTES:

1. THE CONTRACTOR HAS THE OPTION OF USING METAL POSTS INSTEAD OF WOOD.
2. ALL SIGNS SHALL BE BLACK ON ORANGE. THE POSTS SHALL BE PLACED 12 FEET FROM THE EDGE OF PAVEMENT AS DIRECTED BY THE ENGINEER.
3. ALL SIGN HARDWARE REQUIRED TO INSTALL THE ALTERNATE ROUTE SIGNING SHALL BE INCLUDED IN COST OF SIGN PANEL TYPE 1.
4. SIGNS SHALL BE REMOVED ON COMPLETION OF THE CONTRACT AT THE DIRECTION OF THE ENGINEER. THIS WORK SHALL BE COMPLETED ACCORDING TO SECTION 724 OF THE STANDARD SPECIFICATIONS. THIS WORK WILL NOT BE PAID FOR. THE SIGNS AND POSTS SHALL BECOME THE PROPERTY OF THE CONTRACTOR.
5. DETOUR = US RTE. 45.
6. THE RELOCATING, MAINTENANCE OR REPLACEMENT OF SIGNS SHALL BE PAID FOR IN ACCORDANCE WITH ARTICLE 109.04.
7. EXACT SIGN PLACEMENT WILL BE DETERMINED BY THE ENGINEER.
8. THE DISTRICT 9 OPERATIONS ENGINEER SHALL BE CONTACTED 10 DAYS PRIOR TO THE ERECTION OF SIGNS.

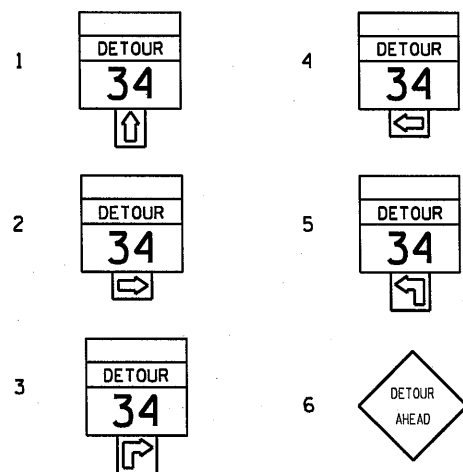

FILE NAME =	USER NAME = aybar.js	DESIGNED -	REVISED -	STATE OF ILLINOIS DEPARTMENT OF TRANSPORTATION	DETOUR SIGN DETAIL				F.A.P. RTE.	SECTION	COUNTY	TOTAL SHEETS	SHEET NO.
es:\pwork\pwork\aybar.js\d0290959\78290-design.dgn		DRAWN -	REVISED -		869	105R-1	SALINE	26	21				
PLOT SCALE = 100.0000' / 1in.		CHECKED -	REVISED -		SCALE: _____ SHEET NO. ____ OF ____ SHEETS STA. _____ TO STA. _____				CONTRACT NO. 78290				
PLOT DATE = 3/26/2012		DATE -	REVISED -		ILLINOIS FED. AID PROJECT								

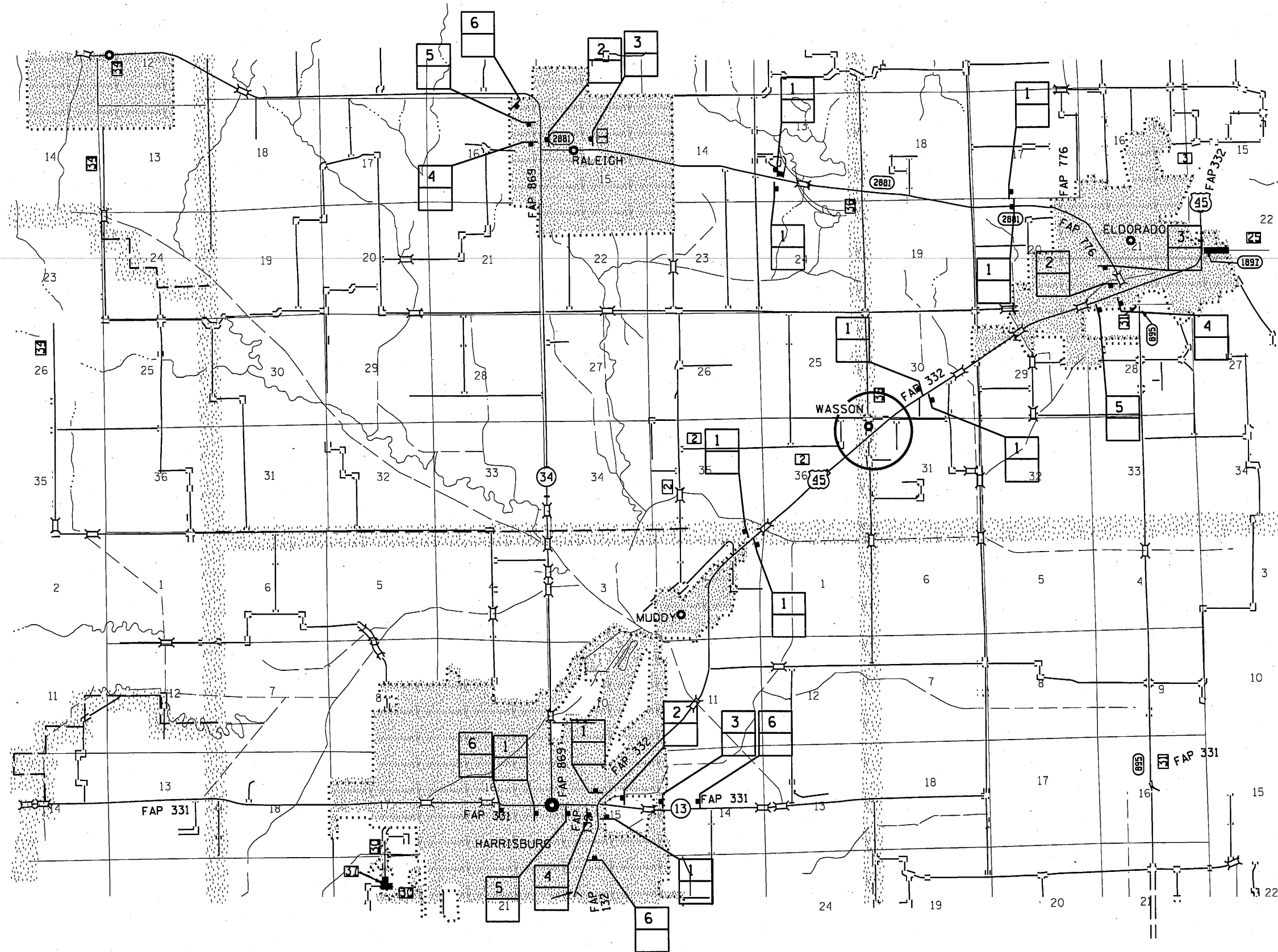

FILE NAME =
 c:\pwwork\p1\dot\aybar\j\02290959\78290

USER NAME = aybar.j
 -design.dgn
 PLOT SCALE = 100.0000' / 1" =
 PLOT DATE = 3/26/2012

DESIGNED -
 DRAWN -
 CHECKED -
 DATE -

REVISED -
 REVISED -
 REVISED -
 REVISED -

**STATE OF ILLINOIS
 DEPARTMENT OF TRANSPORTATION**

DETOUR PLAN

SCALE: _____ SHEET _____ OF _____ SHEETS STA. _____ TO STA. _____

F.A.P. RTE.	SECTION	COUNTY	TOTAL SHEETS	SHEET NO.
869	105R-1	SALINE	26	22
			CONTRACT NO. 78290	
ILLINOIS FED. AID PROJECT				

SAFETY EDGE DETAIL

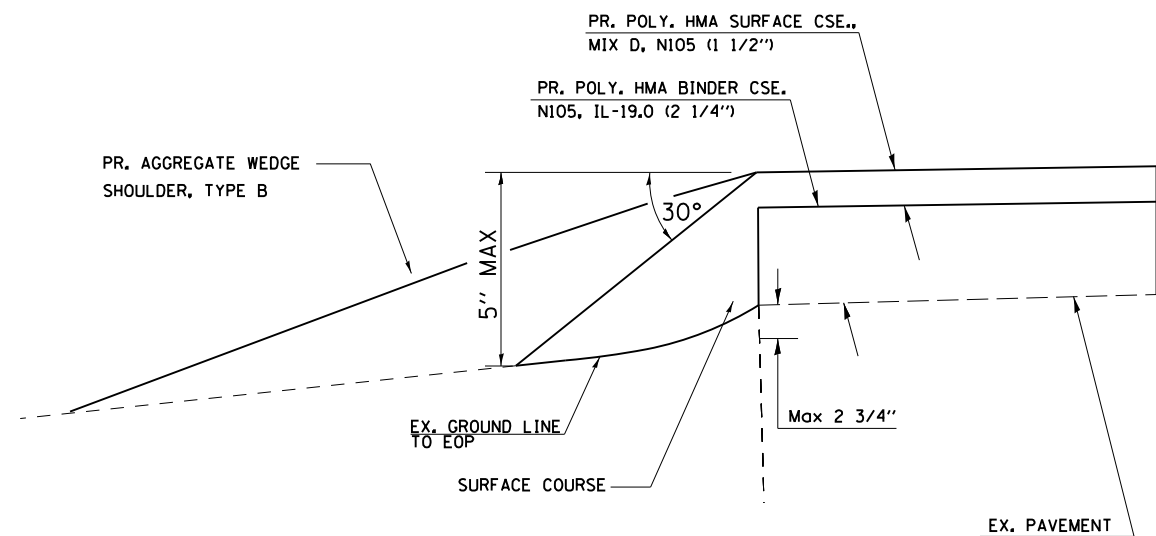

TO BE USED:
STA 1582+81.49 TO STA 1633+10.72

BUTT JOINT DETAIL

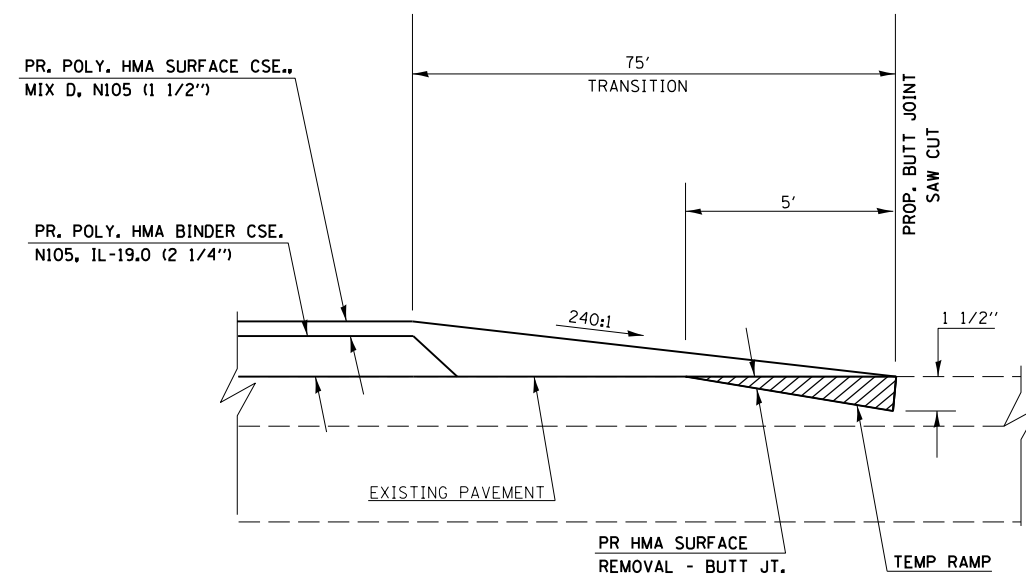

TO BE USED:
STA 1582+81.49 TO STA 1583+56.49
STA 1632+35.72 TO STA 1633+10.72

FILE NAME =	USER NAME = \$USER*	DESIGNED -	REVISED -
et:\pwork\pwork\kellykd\0290960\78290-sht-plan.dgn		DRAWN -	REVISED -
	PLOT SCALE = 100.0000' / in.	CHECKED -	REVISED -
	PLOT DATE = 3/23/2012	DATE -	REVISED -

STATE OF ILLINOIS
DEPARTMENT OF TRANSPORTATION

SAFETY EDGE DETAIL
BUTT JOINT DETAIL

SCALE: SHEET OF SHEETS STA. TO STA.

F.A.P. RTE.	SECTION	COUNTY	TOTAL SHEETS	SHEET NO.
869	105R-1	SALINE	26	23
CONTRACT NO. 78290				
ILLINOIS FED. AID PROJECT				

SIDEROAD AND ENTRANCE DETAILS

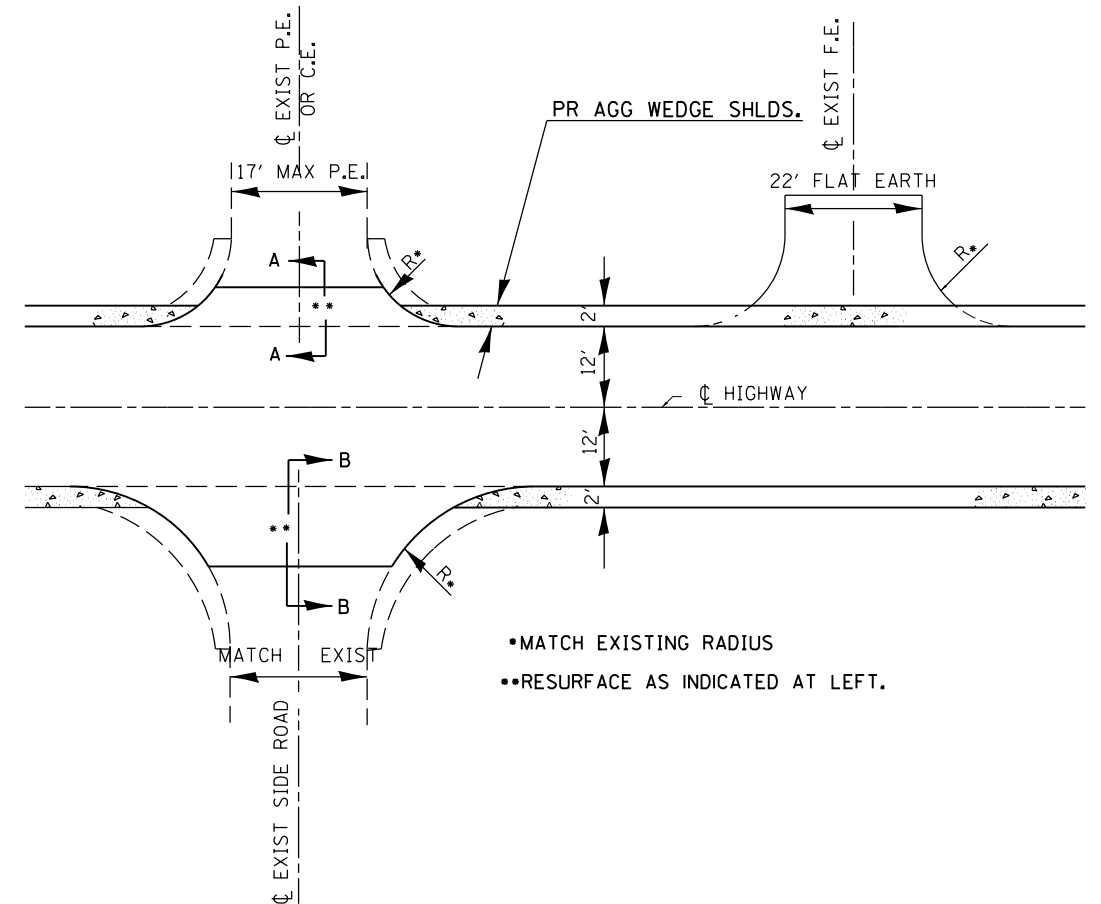
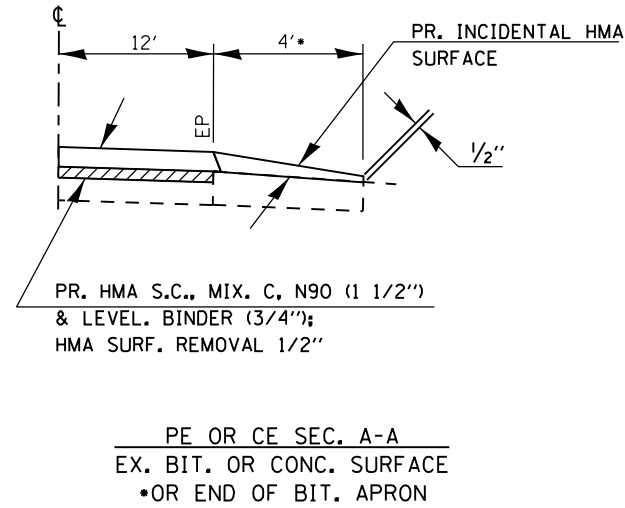
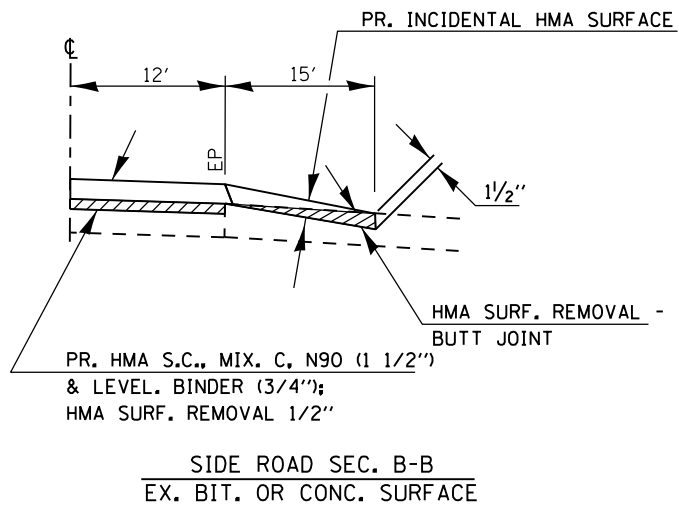

ENTRANCE SCHEDULE FOR LOCATION

TYPE	NUMBER OF ENTRANCES
P.E.	5
C.E.	1

RD. NAME	STA	INCIDENTAL HMA TON
MT MORIAH	1568+50	12
ELLIS	1487+72	9
TOTAL		21

* FAP 855
** (9.10)RS-2; (11.12)RS-3

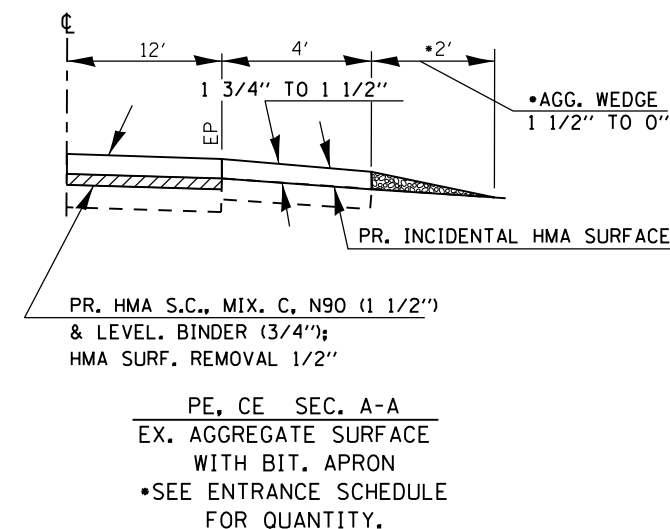
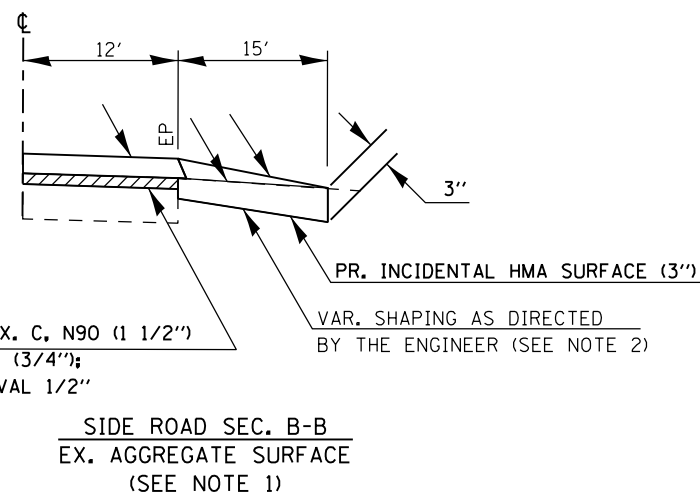

NOTES

- IF EXISTING SUBBASE IS INADEQUATE, AS DETERMINED BY THE ENGINEER, THE SIDE ROADS SHALL BE CORED OUT AND AGGREGATE SUBBASE, TYPE B SHALL BE PLACED FOR BASE. THE COST OF CORING OUT THE SIDE ROAD AND ANY AGGREGATE BASE COURSE SHALL BE PAID FOR AS SPECIFIED IN ART. 109.04 OF THE STANDARD SPECIFICATIONS FOR ROAD AND BRIDGE CONSTRUCTION. IF EXISTING SUBBASE IS DETERMINED TO BE ADEQUATE, THE PREPARATION OF THE BASE SHALL BE CONSTRUCTED ACCORDING TO ARTICLE 406.19.
- VARIABLE SHAPING IS INCLUDED IN THE COST OF INCIDENTAL HOT-MIX ASPHALT SURFACE.

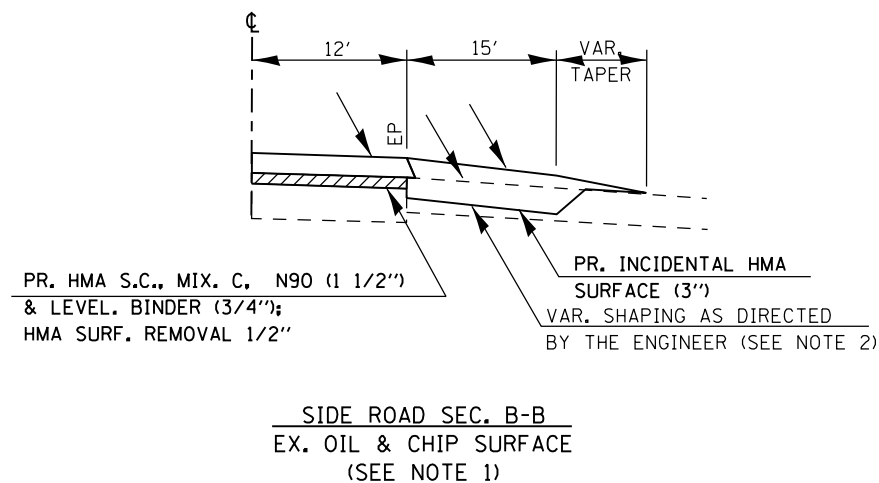

FILE NAME =	USER NAME = \$USER\$	DESIGNED -	REVISED -
et:\pw\work\p\dot\k\ell\eykd\d0290960\78290-sht-pln.dgn		DRAWN -	REVISED -
	PLOT SCALE = 100.0000' / 1in.	CHECKED -	REVISED -
	PLOT DATE = 3/23/2012	DATE -	REVISED -

STATE OF ILLINOIS
DEPARTMENT OF TRANSPORTATION

SIDE ROAD AND ENTRANCE DETAIL

SCALE: SHEET OF SHEETS STA. TO STA.

F.A.P. RTE.	SECTION	COUNTY	TOTAL SHEETS	SHEET NO.
869	105R-1	SALINE	26	24
				CONTRACT NO. 78290
ILLINOIS FED. AID PROJECT				

TEMPORARY HOT-MIX ASPHALT TRANSITIONS

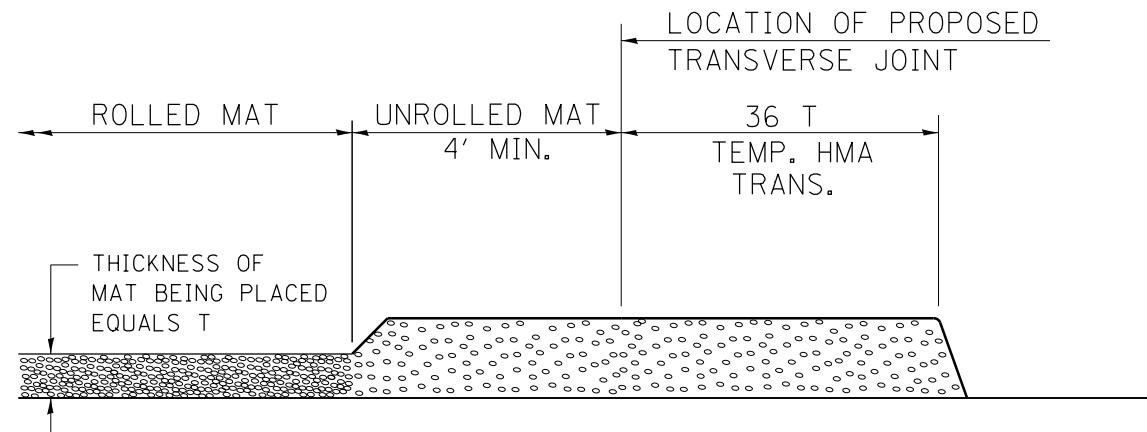

STEP I

1. PLACE HOT-MIX ASPHALT MAT, LENGTH 36 TIMES THE THICKNESS OF THE MAT BEING PLACED PAST THE PROPOSED TRANSVERSE JOINT LOCATION USING NORMAL OPERATING PROCEDURES. EXTREME CARE SHOULD BE TAKEN TO MAINTAIN ENOUGH MATERIAL IN FRONT OF THE SCREED TO MAINTAIN REQUIRED PAVING DEPTH.

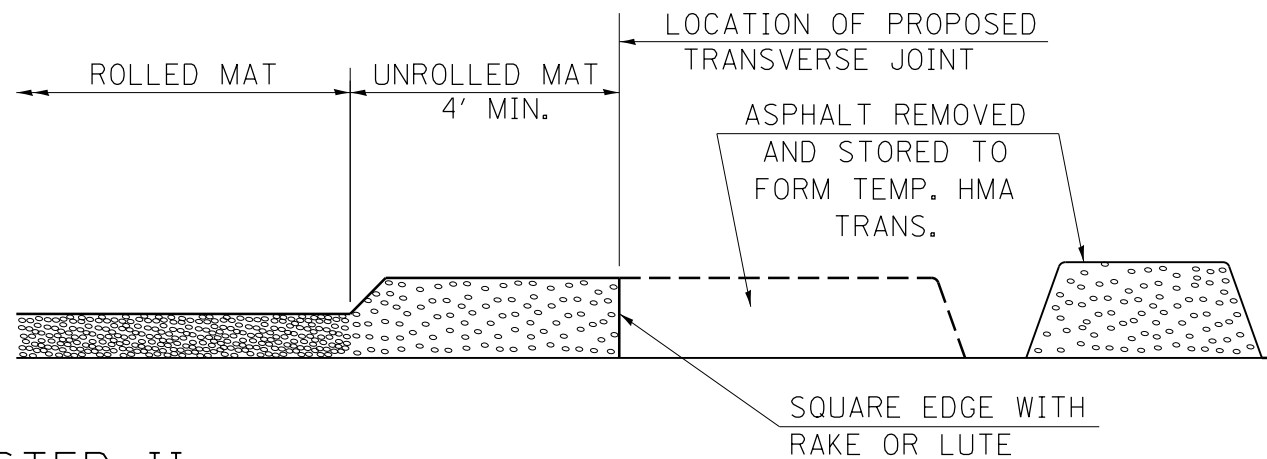

STEP II

1. MOVE THE PAVER OUT OF THE WAY AND REMOVE THE ASPHALT FROM THE AREA OF THE PROPOSED TEMPORARY HOT-MIX ASPHALT TRANSITION.
2. SQUARE UP THE END OF THE MAT WITH A RAKE OR LUTE.
3. NOTE THAT THE MAT WITHIN 4' OF THE END OF JOINT IS NOT TO BE ROLLED AT THIS TIME.

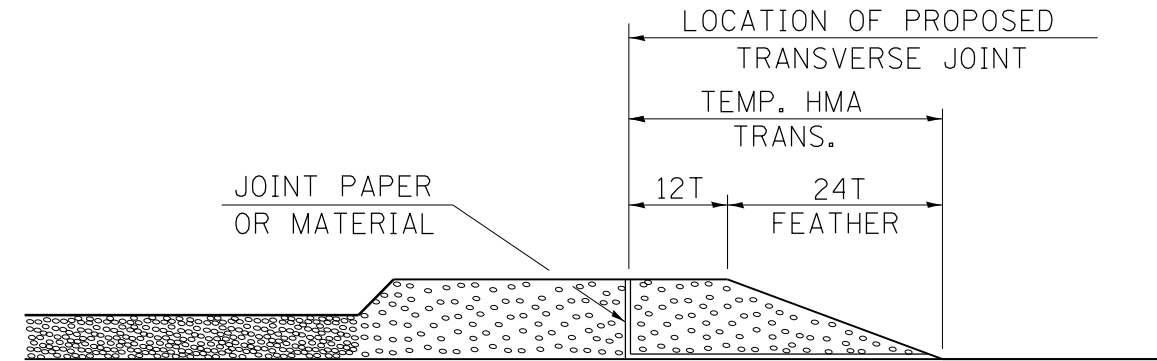

STEP III

1. JOINT PAPER OR OTHER PRESELECTED JOINT MATERIAL IS THEN PLACED IN THE CLEARED AREA AND THE EXCESS ASPHALT USED TO HAND FORM A TRANSITION TO THE DIMENSIONS SHOWN ABOVE.
2. NOTE THAT IN CONSTRUCTING THE TRANSITION, THE MAT DEPTH IS CONTINUED AS PART OF THE TRANSITION BEFORE FORMING THE FEATHER.

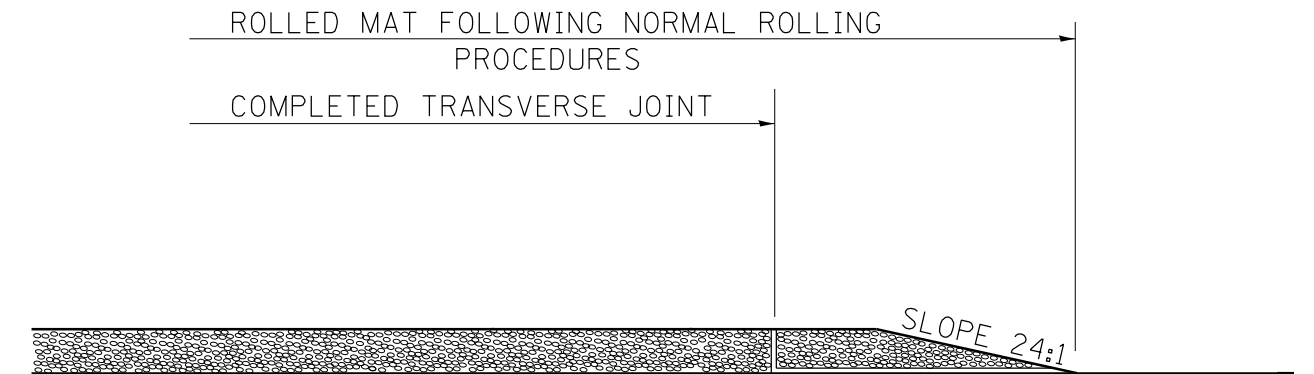

STEP IV

1. COMPLETE TEMPORARY TRANSITION BY ROLLING.
2. TO RESUME PAVING, AT THE JOINT, REMOVE TEMPORARY TRANSITION AND DISPOSE OF THE MATERIAL ACCORDING TO ART. 202.03 OF THE STD. SPECS. (COST INCLUDED IN THE CONTRACT).
3. CONSTRUCTING THE TEMPORARY TRANSITIONS WILL NOT BE PAID FOR SEPARATELY IN ACCORDANCE WITH ARTICLE 406.14 OF THE STANDARD SPECIFICATIONS.

REVISIONS

REDRAWN	2-15-89
REVISED	8-16-94
REVISED	01-09-07
RESIZED	05-8-08

STD. 9-26

UNEVEN LANES SIGN

W8-11 (48'' x 48'')

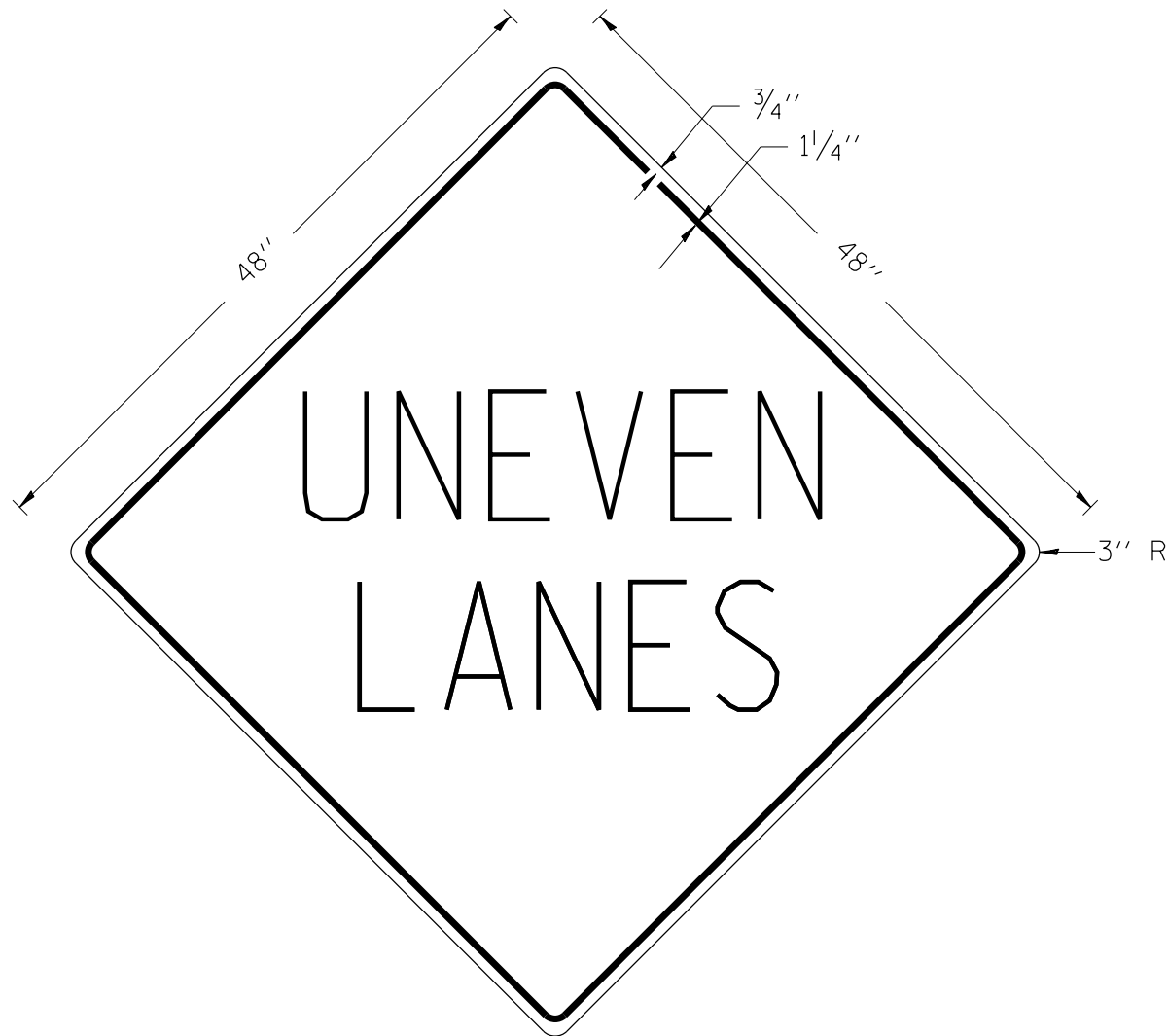

COLORS:

LEGEND AND BORDER - BLACK NON-REFLECTORIZED
BACKGROUND - ORANGE REFLECTORIZED

NOTE: PRIOR TO ALLOWING TRAFFIC ON ANY PORTION OF THE ROADWAY THAT HAS BEEN COLDMILLED OR BEFORE RESURFACING OPERATIONS BEGIN, THE CONTRACTOR SHALL HAVE ERECTED "UNEVEN PAVEMENT" SIGNS THAT CONFORM TO THE ABOVE DETAILS. A MINIMUM OF ONE SIGN AT EACH END OF THE IMPROVEMENT WILL BE REQUIRED. THE CONTRACTOR SHALL MAINTAIN THE "UNEVEN PAVEMENT" SIGNS UNTIL THE RESURFACING OPERATIONS ARE COMPLETED.

IF AT ANY TIME THE SIGNS ARE IN PLACE BUT NOT APPLICABLE, THEY SHALL BE TURNED FROM THE VIEW OF MOTORISTS OR COVERED AS DIRECTED BY THE ENGINEER.

THE COST OF FURNISHING, ERECTING, MAINTAINING, AND REMOVING THE REQUIRED SIGNS SHALL BE INCLUDED IN THE CONTRACT.

REVISIONS

DRAWN	2-15-89
REVISED	4-06-93
REDSIGNED	
RESIZED	

STD. 9-41

FILE NAME =	USER NAME = \$USER\$	DESIGNED -	REVISED -	STATE OF ILLINOIS DEPARTMENT OF TRANSPORTATION	UNEVEN LANES SIGN			F.A.P. RTE.	SECTION	COUNTY	TOTAL SHEETS	SHEET NO.
et:\pwork\pwork\kellykd\0290960\78290-sht-plan.dgn		DRAWN -	REVISED -					869	105R-1	SALINE	26	26
PLOT SCALE = 100.0000' / in.		CHECKED -	REVISED -		SCALE: SHEET OF SHEETS STA. TO STA.			CONTRACT NO. 78290				
PLOT DATE = 3/23/2012		DATE -	REVISED -		ILLINOIS FED. AID PROJECT							