

PLANS FOR PROPOSED FEDERAL-AID PROJECT

F.A.S. 178 (C.H. 9) PAW PAW ROAD PROPOSED STRUCTURE NO. 052-3513

SECTION 11-00317-00-BR LEE COUNTY PROJECT BRS-0178(105)

JOB NO. C-92-101-12

FAS ROUTE NO.	SEC	COUNTY	TOTAL SHEETS	SHEET NO.
178	*	LEE	14	1

ILLINOIS PROJECT BRS-0178(105)
* 11-00317-00-BR
CONTRACT NO. 85560

INDEX OF SHEETS

- COVER SHEET
- SUMMARY AND SCHEDULE OF QUANTITIES AND TYPICAL SECTIONS
- PLAN AND PROFILE
- ROADWAY CROSS SECTIONS
- GENERAL PLAN AND ELEVATION OF BRIDGE
- SUPERSTRUCTURE DETAILS
 - SUBSTRUCTURE - ABUTMENTS
 - STEEL BRIDGE RAIL, TYPE SM
 - PILING DETAILS
 - EROSION & SEDIMENT CONTROL PLAN

STANDARDS:

- 000001-06 STANDARD SYMBOLS, ABBREVIATIONS, AND PATTERNS
- 001001-02 AREAS OF REINFORCEMENT BARS
- 280001-06 TEMPORARY EROSION CONTROL SYSTEMS
- 515001-03 NAME PLATE FOR BRIDGES
- 630301-05 SHOULDER WIDENING FOR TYPE 1 (SPECIAL) GUARDRAIL TERMINALS
- 635006-03 REFLECTOR AND TERMINAL MARKER PLACEMENT
- 635011-02 REFLECTOR MARKER AND MOUNTING DETAILS
- 701006-03 OFF-RD OPERATIONS, 2L, 2W, 15' TO 24" FROM PAVEMENT EDGE
- 701301-04 LANE CLOSURE, 2L, 2W, SHORT TIME OPERATIONS
- 701901-02 TRAFFIC CONTROL DEVICES
- 720011-01 METAL POSTS FOR SIGNS, MARKERS & DELINEATORS
- 728001-01 TELESCOPING STEEL SIGN SUPPORT
- 729001-01 APPLICATIONS OF TYPES A & B METAL POSTS
- BLR 21-9 TYPICAL APPLICATION OF TRAFFIC CONTROL DEVICES
- BLR 23-4 TRAFFIC BARRIER TERMINAL, TYPE 1
- BLR 27-1 TRAFFIC BARRIER TERMINAL, TYPE 5A

SECTION 11-00317-00-BR
ENDS AT STA. 12+50

SECTION 11-00317-00-BR
INCLUDES THE REMOVAL OF AN EXISTING DOUBLE BARREL CULVERT (EXIST. SN 052-5026), AND REPLACEMENT WITH A SINGLE SPAN PPC DECK BEAM BRIDGE WITH CONCRETE WEARING SURFACE SPILL-THRU PILE BENT ABUTMENTS (PROP. SN 052-3513). 41'-8" BK-BK. ABUTS. ALSO INCLUDED IS NECESSARY ROADWAY APPROACH WORK.

SECTION 11-00317-00-BR
BEGINS AT STA. 7+50

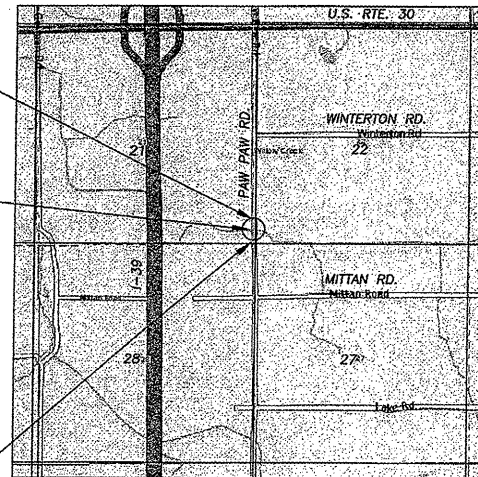

LOCATION MAP

GROSS LENGTH OF SECTION = 500 FEET (0.09 MILE)
NET LENGTH OF SECTION = 500 FEET (0.09 MILE)

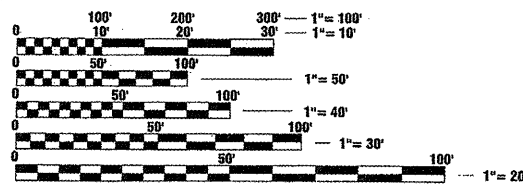

FULL SIZE PLANS HAVE BEEN PREPARED USING STANDARD ENGINEERING SCALES. REDUCED SIZED PLANS WILL NOT CONFORM TO STANDARD SCALES. IN MAKING MEASUREMENTS ON REDUCED PLANS, THE ABOVE SCALES MAY BE USED.

J.U.L.I.E.
JOINT UTILITY LOCATION INFORMATION FOR EXCAVATION
1-800-892-0123

CONTRACT NO. 85560

ROADWAY	DESIGN CLASSIFICATION	ADT 2010	ADT 2030	DESIGN SPEED
PAW PAW	MAJOR COLLECTOR NON-URBAN	350	350	55



Richard A. Baumann
STERLING, ILLINOIS
ILLINOIS LICENSED PROFESSIONAL ENGINEER NO. 062-035417
EXPIRES 11-30-2013

wendler
GROUNDBREAKING SOLUTIONS
engineers - surveyors - scientists
www.wendlergs.com ph: 815.288.2261
Illinois Professional Design Firm No. 184-000848

STATE OF ILLINOIS
DEPARTMENT OF TRANSPORTATION
DIVISION OF HIGHWAYS

SUBMITTED 3-27-2012
PASSED April 17 2012
RELEASED FOR BID BASED ON LIMITED REVIEW

RICHARD A. BAUMANN COUNTY ENGINEER
DISTRICT 2 ENGINEER OF LOCAL ROADS & STREETS
DEPUTY DIRECTOR OF HIGHWAYS, REGION 2 ENGINEER

PRINTED BY THE AUTHORITY OF THE STATE OF ILLINOIS