

EXISTING TYPICAL CROSS SECTION

STA. 510+00 TO STA. 512+37.20
 STA. 513+63.08 TO STA. 517+00

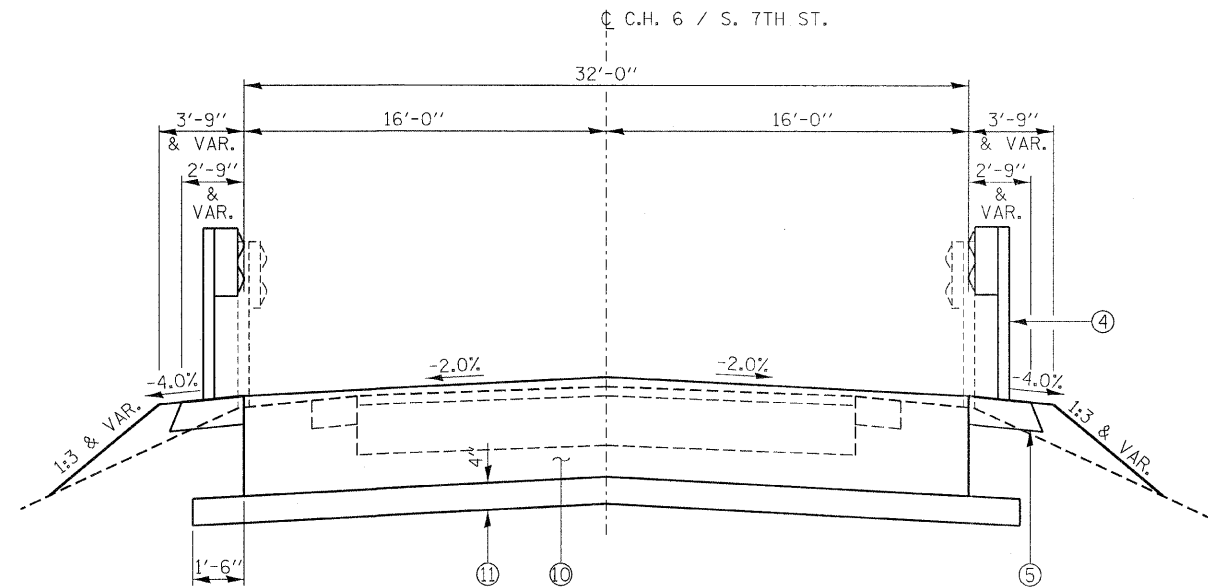

PROPOSED TYPICAL CROSS SECTION

STA. 512+02.20 TO STA. 512+32.20
 STA. 514+17.80 TO STA. 514+47.80
 STA. 511+96.20 TO STA. 512+02.20 (FLEXIBLE CONNECTOR)
 STA. 514+47.80 TO STA. 514+53.80 (FLEXIBLE CONNECTOR)

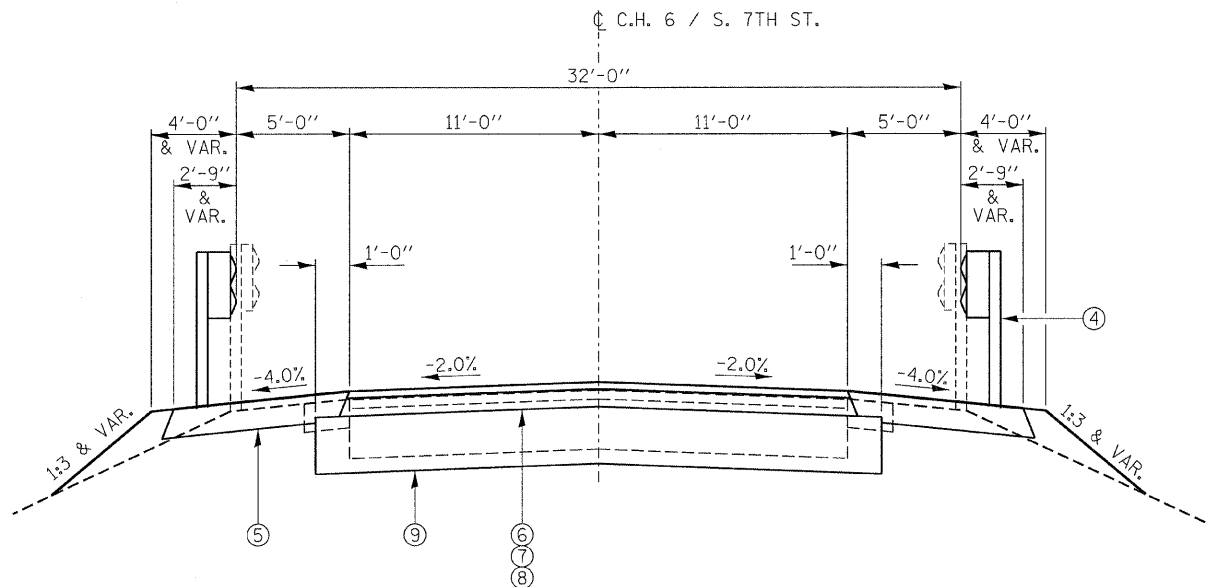

PROPOSED TYPICAL CROSS SECTION

STA. 511+50 TO STA. 511+96.20
 STA. 514+47.80 TO STA. 515+00

LEGEND

- ① EXISTING HOT-MIX ASPHALT SURFACE (3" THICKNESS)
- ② EXISTING AGGREGATE BASE
- ③ EXISTING AGGREGATE SHOULDERS
- ④ TRAFFIC BARRIER TERMINALS TYPE 6A AND TYPE 1 (SPECIAL) TANGENT
- ⑤ HOT-MIX ASPHALT SHOULDERS, 8"
- ⑥ HMA SURFACE COURSE, MIX "C", N50 (1.5" THICKNESS)
- ⑦ HMA BINDER COURSE, IL-19.0, N50 (3.75" THICKNESS)
- ⑧ BITUMINOUS MATERIALS (PRIME COAT)
- ⑨ AGGREGATE BASE COURSE, TYPE B (12" THICKNESS)
- ⑩ BRIDGE APPROACH PAVEMENT (COST INCLUDED WITH CONCRETE SUPERSTRUCTURES)
- ⑪ SUB-BASE GRANULAR MATERIAL, TY B, 4" (COST INCLUDED WITH CONCRETE SUPERSTRUCTURES)

FILE NAME = 120191-shr-typesections.dgn	USER NAME =	DESIGNED - J.W.F.	REVISED -
HAMPTON, LENZINI AND RENWICK, INC. 3000 STEVENSON DRIVE, SUITE 201 SPRINGFIELD, ILLINOIS 62703	PLOT SCALE =	DRAWN - T.W.K.	REVISED -
ILLINOIS PROFESSIONAL DESIGN FIRM L317P/1 SE CORP. 184.000939	PLOT DATE = 2/14/2012	CHECKED - S.W.M.	REVISED -
		DATE - 02/13/12	REVISED -

**STATE OF ILLINOIS
 LIVINGSTON COUNTY HIGHWAY DEPARTMENT**

TYPICAL CROSS SECTIONS C.H. 6 / 7TH STREET			
SCALE:	SHEET NO.	OF SHEETS	STA. TO STA.

F.A.S.	SECTION	COUNTY	TOTAL SHEETS	SHEET NO.
351	08-00145-05-BR	LIVINGSTON	29	4
SOUTH 7TH STREET		CONTRACT NO. 87494		
ILLINOIS FED. AID PROJECT				