

PLAN	SURVEYED	DATE
	NOTED	
	PLOTTED	
	CHECKED	
	BY	
	NO.	
	FILE NAME	

PROFILE	SURVEYED	DATE
	NOTED	
	PLOTTED	
	CHECKED	
	BY	
	NO.	
	NOTATIONS	

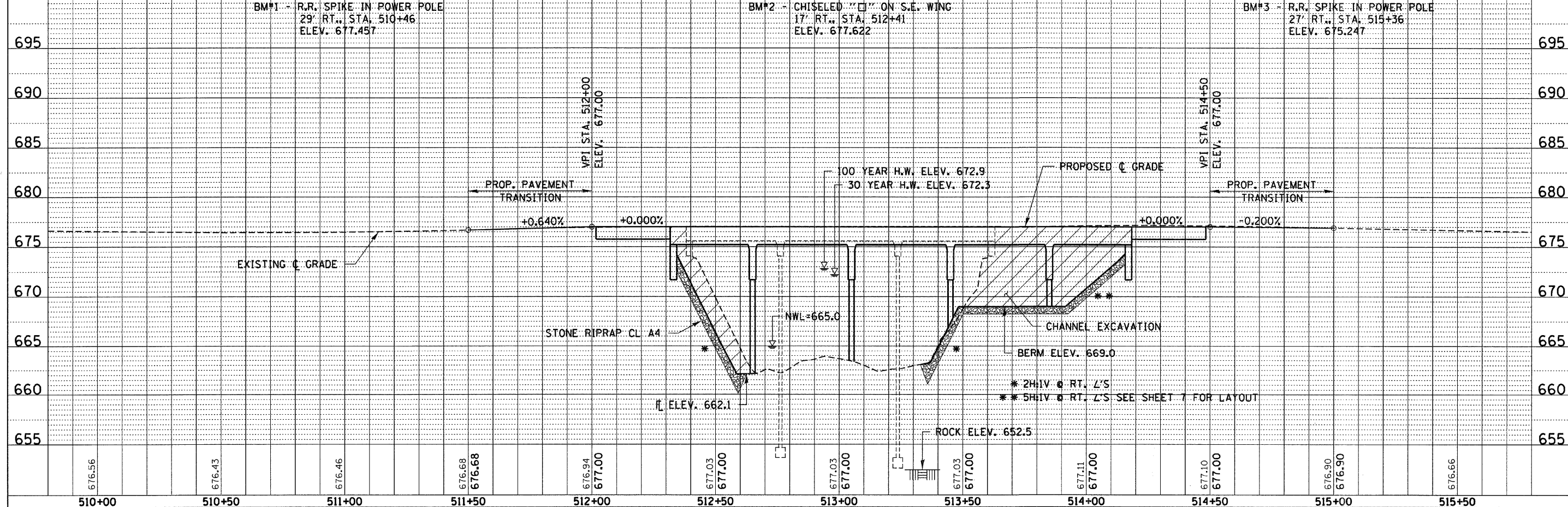

FILE NAME = 120191-shh-pp2.dgn	USER NAME =	DESIGNED - J.W.F.	REVISED -	STATE OF ILLINOIS LIVINGSTON COUNTY HIGHWAY DEPARTMENT	PLAN & PROFILE C.H. 6 / S. 7TH STREET		F.A.S.	SECTION	COUNTY	TOTAL SHEETS	SHEET NO.
HAMPTON, LENZINI AND RENWICK, INC. 306 STEVENSON DRIVE, SUITE 201 SPRINGFIELD, ILLINOIS 62702		DRAWN - D.T.M.	REVISED -		351	08-00145-05-BR	LIVINGSTON	29	5		
ILLINOIS PROFESSIONAL DESIGN FIRM LS / PE / SE CORP. 184.000989	PLOT SCALE =	CHECKED - S.W.M.	REVISED -		SOUTH 7TH STREET			CONTRACT NO. 87494			
	PLOT DATE = 2/14/2012	DATE - 02/13/12	REVISED -		SCALE: H20xV5 SHEET NO. 2 OF 3 SHEETS STA. 509+80 TO STA. 515+80			ILLINOIS FED. AID PROJECT			