

SEE SHEETS 10 & 11 FOR DRAINAGE SCHEDULES

BENCHMARKS:
 CHISELED "X" IN LIGHT POLE BASE AT NORTHWEST CORNER OF IL 113 AND CURTIS ELEV. = 560.20
 SOUTHWEST BOLT ON FIRE HYDRANT 250' ± EAST OF WILL ROAD ON NORTH SIDE OF IL 113 ELEV. = 556.76

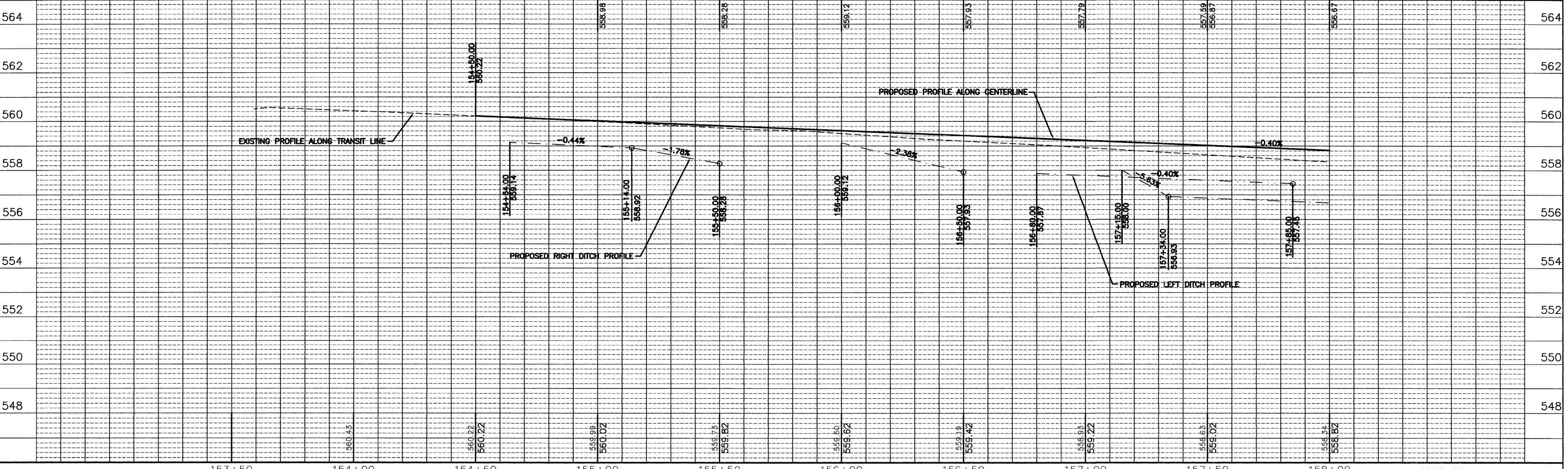

CHAMBLIN & ASSOCIATES, INC. © 2011
 Drawing No.: 66022-01 - Diamond - Will - Road - & - IL - 113 - E - Survey - CAD - PLANS - EXTENDED - G20 - PP - 154 - 158.dwg Last Modified: Feb 16, 2012 - 8:36am Plotted on: Mar 27, 2012 - 1:15pm by: nancie

DRAWN BY: NV	LEVEL	BY	DATE	REVISIONS	DESCRIPTION
CHECKED BY: JKC					
DATE: 02/12					

CHAMBLIN & ASSOCIATES
 PERU MORRIS ILLINOIS

FAS 301 / FAU 383
 SECTION 11-00007-00-WR
 VILLAGE OF DIAMOND
 GRUNDY AND WILL COUNTIES

PLAN AND PROFILE - IL 113
 STA. 154+00 TO STA. 158+00

CONSTRUCTION PLANS	CURRENT AS OF: 02/12	
	SCALE: AS NOTED	SHEET 20
	FILE NO.: 66022.01Y-	OF 96

CONTRACT NO. 87520