

HORIZONTAL CONTROL

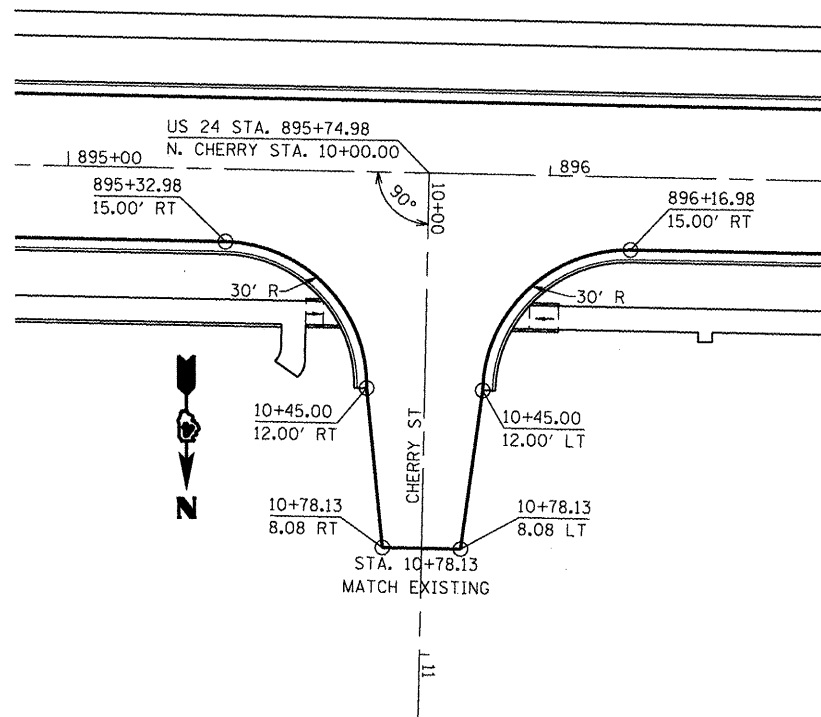

VERTICAL CONTROL

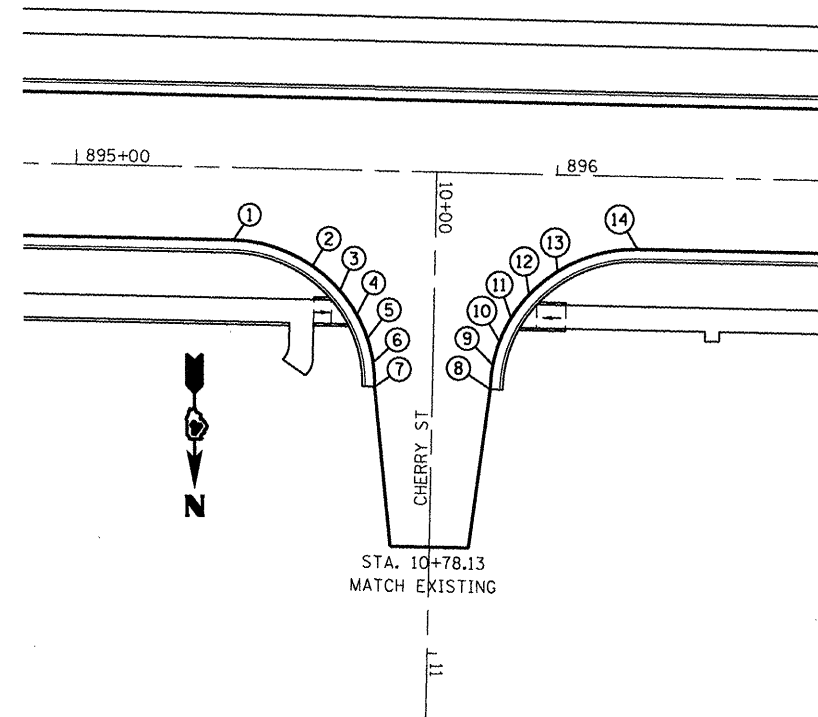

PAVEMENT JOINTS

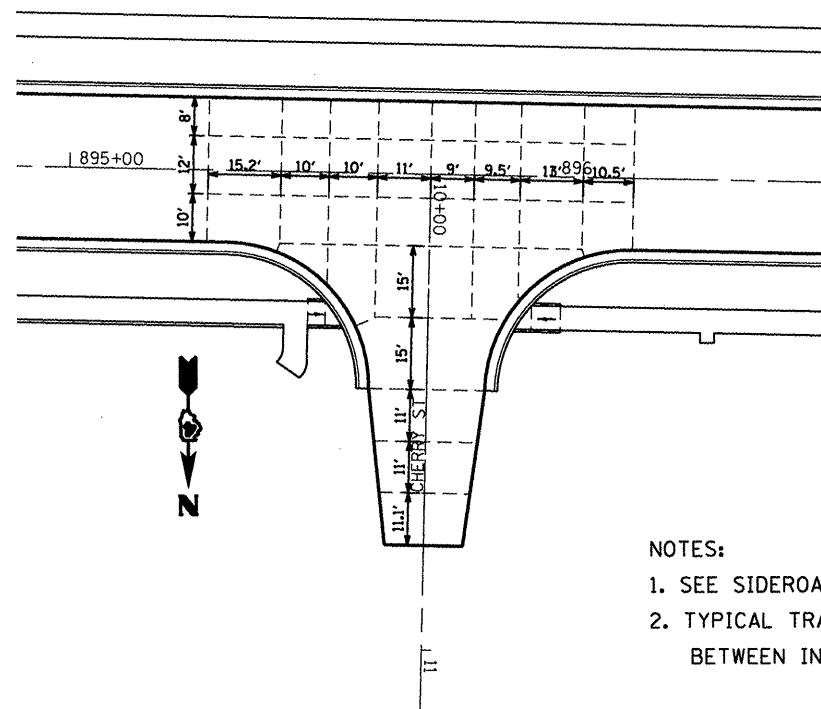

NOTES:

1. SEE SIDEROAD PROFILES.
2. TYPICAL TRANSVERSE JOINT SPACING ON US 24 BETWEEN INTERSECTIONS SHALL BE 14'.

LOCATION	STATION	OFFSET	ELEVATION
CHERRY ST			
1	10+15.00	42.00	697.30
2	10+20.00	25.42	697.41
3	10+25.00	19.64	697.50
4	10+30.00	16.02	697.59
5	10+35.00	13.72	697.67
6	10+40.00	12.42	697.76
7	10+45.00	12.00	697.82
8	10+45.00	12.00	697.82
9	10+40.00	12.42	697.76
10	10+35.00	13.72	697.70
11	10+30.00	16.02	697.64
12	10+25.00	19.64	697.57
13	10+20.00	25.42	697.48
14	10+15.00	42.00	697.68

