

SEE SCHEDULE FOR PAVEMENT MARKINGS TO THE EAST

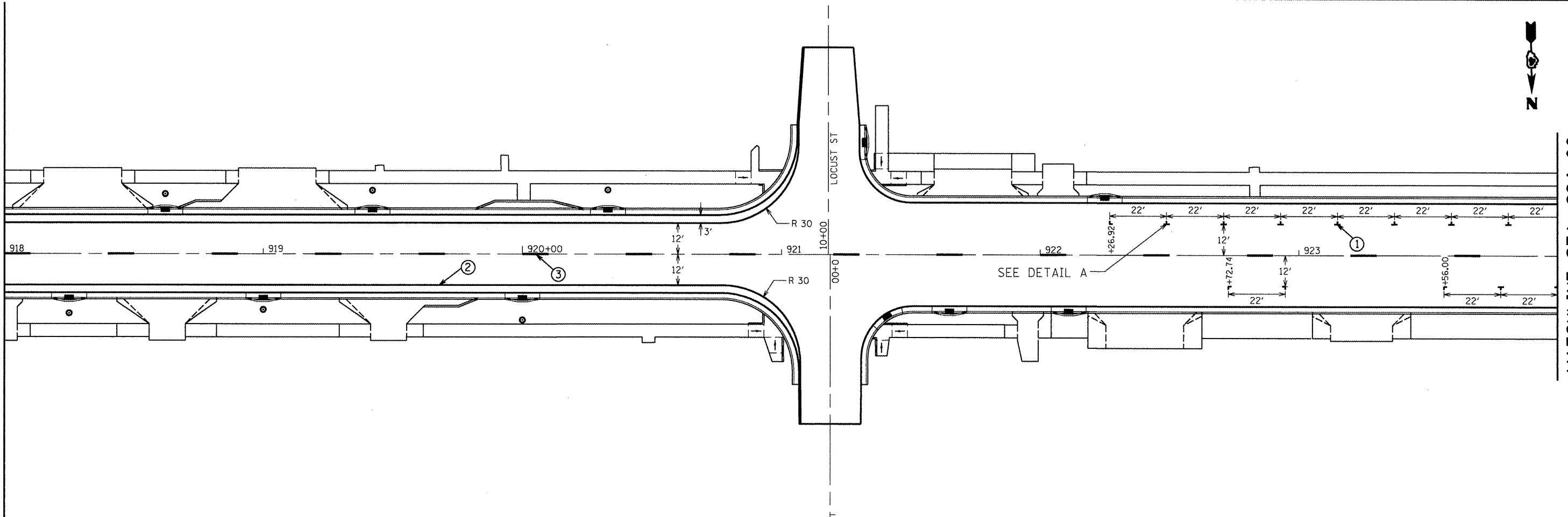

MATCHLINE STA. 924+00

DETAIL A

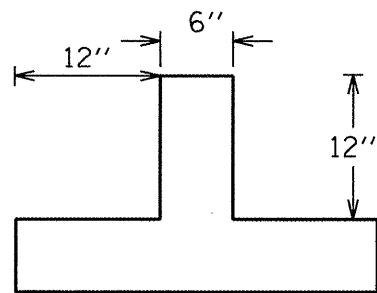

LEGEND

- ① MODIFIED URETHANE PAVEMENT MARKING - LINE 6" (FOOT) (WHITE)
- ② MODIFIED URETHANE PAVEMENT MARKING - LINE 4" (FOOT) (WHITE)
- ③ MODIFIED URETHANE PAVEMENT MARKING - LINE 4" (FOOT) (YELLOW)
- ④ MODIFIED URETHANE PAVEMENT MARKING - LINE 8" (FOOT) (WHITE)

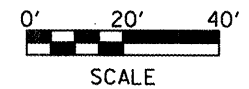

FILE NAME = plan01.dgn	USER NAME = horstkj	DESIGNED -	REVISED -	STATE OF ILLINOIS DEPARTMENT OF TRANSPORTATION	PAVEMENT MARKING DETAILS			F.A.P. RTE.	SECTION	COUNTY	TOTAL SHEETS	SHEET NO.
	PLOT SCALE = 40.0000' / in.	DRAWN -	REVISED -		317	16W-1,RS-3	FULTON	347	152			
PLOT DATE = 3/20/2012	CHECKED -	REVISED -	SCALE: 1" = 40'		SHEET	OF	SHEETS	STA.	TO STA.	CONTRACT NO. 88795		
	DATE -	REVISED -								ILLINOIS FED. AID PROJECT		