

**NOTES**

1. USE 1/2" PREFORMED EXPANSION JOINT FILLER BETWEEN THE CURB AND SIDEWALK AND BETWEEN THE SIDEWALK AND BUILDINGS.
2. CONCRETE STEP SHALL BE CONSTRUCTED OF A TINTED CONCRETE MIX FROM STA. 925+07 TO STA. 926+93.50 RT. SEE THE SPECIAL PROVISIONS.

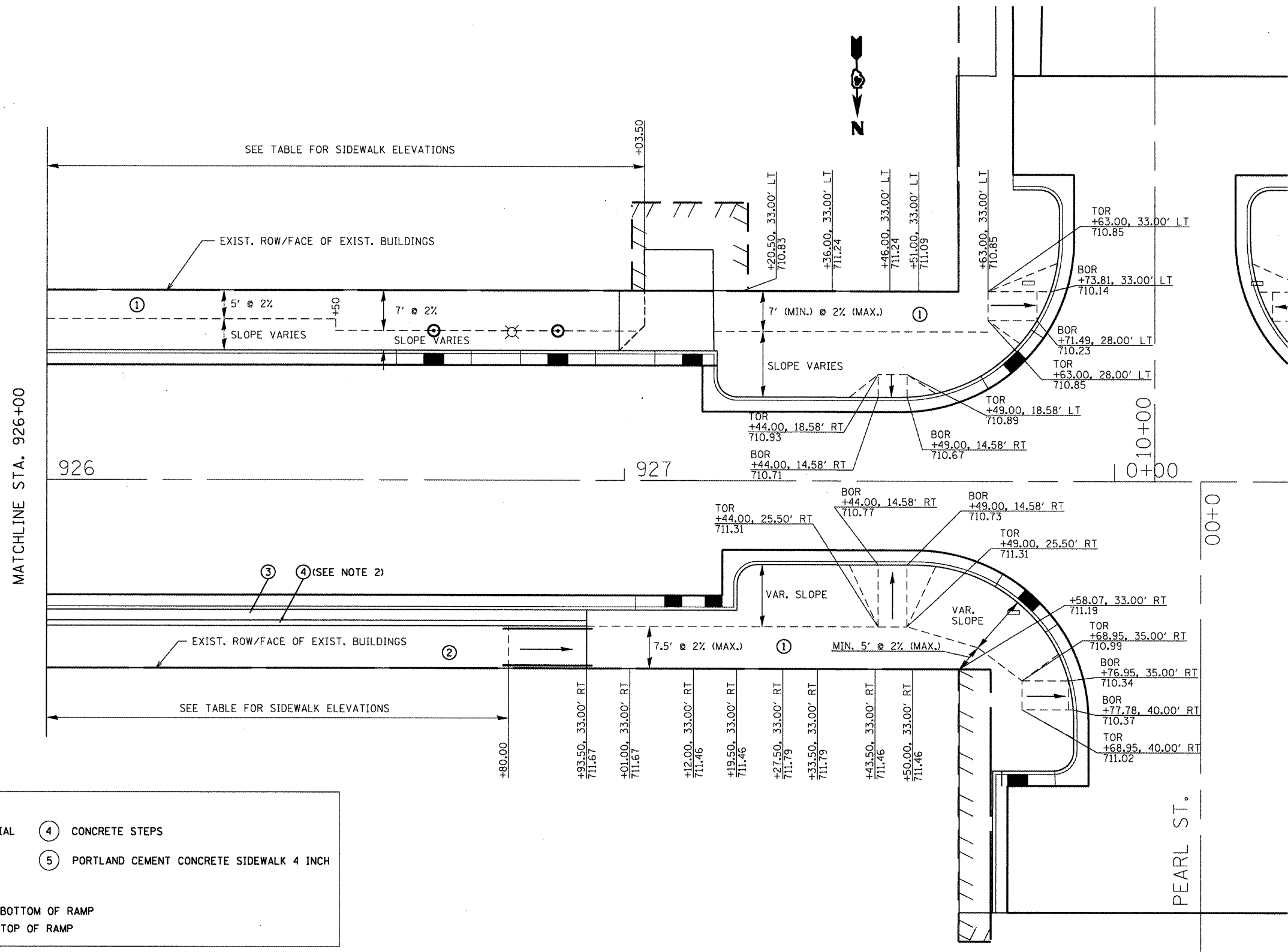

**LEGEND**

- |   |  |
|---|--|
| ① PORTLAND CEMENT CONCRETE SIDEWALK 4 INCH, SPECIAL | ④ CONCRETE STEPS                           |
| ② PORTLAND CEMENT CONCRETE SIDEWALK, SPECIAL        | ⑤ PORTLAND CEMENT CONCRETE SIDEWALK 4 INCH |
| ③ PORTLAND CEMENT CONCRETE SIDEWALK 6 INCH          |  |

BOR = BOTTOM OF RAMP  
TOR = TOP OF RAMP

FILE NAME = miscsheets.dgn	USER NAME = horstkj	DESIGNED -	REVISED -	<b>STATE OF ILLINOIS DEPARTMENT OF TRANSPORTATION</b>	<b>SIDEWALK DETAILS WALNUT ST. TO PEARL ST.</b>			F.A.P. RTE. 317	SECTION 16W-1, RS-3	COUNTY FULTON	TOTAL SHEETS 347	SHEET NO. 157
	PLOT SCALE = 20,0000' / in.	DRAWN -	REVISED -		SCALE:	SHEET NO.	OF SHEETS	STA.	TO STA.	CONTRACT NO. 88795		
	PLOT DATE = 3/21/2012	CHECKED -	REVISED -							ILLINOIS FED. AID PROJECT		
		DATE -	REVISED -									