

SURVEYED \_\_\_\_\_  
 PLOTTED \_\_\_\_\_  
 SURVEY AREA \_\_\_\_\_  
 NOTE BOOK \_\_\_\_\_  
 NO. \_\_\_\_\_  
 AREAS CHECKED \_\_\_\_\_

SURVEYED \_\_\_\_\_  
 PLOTTED \_\_\_\_\_  
 SURVEY AREA \_\_\_\_\_  
 NOTE BOOK \_\_\_\_\_  
 NO. \_\_\_\_\_  
 AREAS CHECKED \_\_\_\_\_

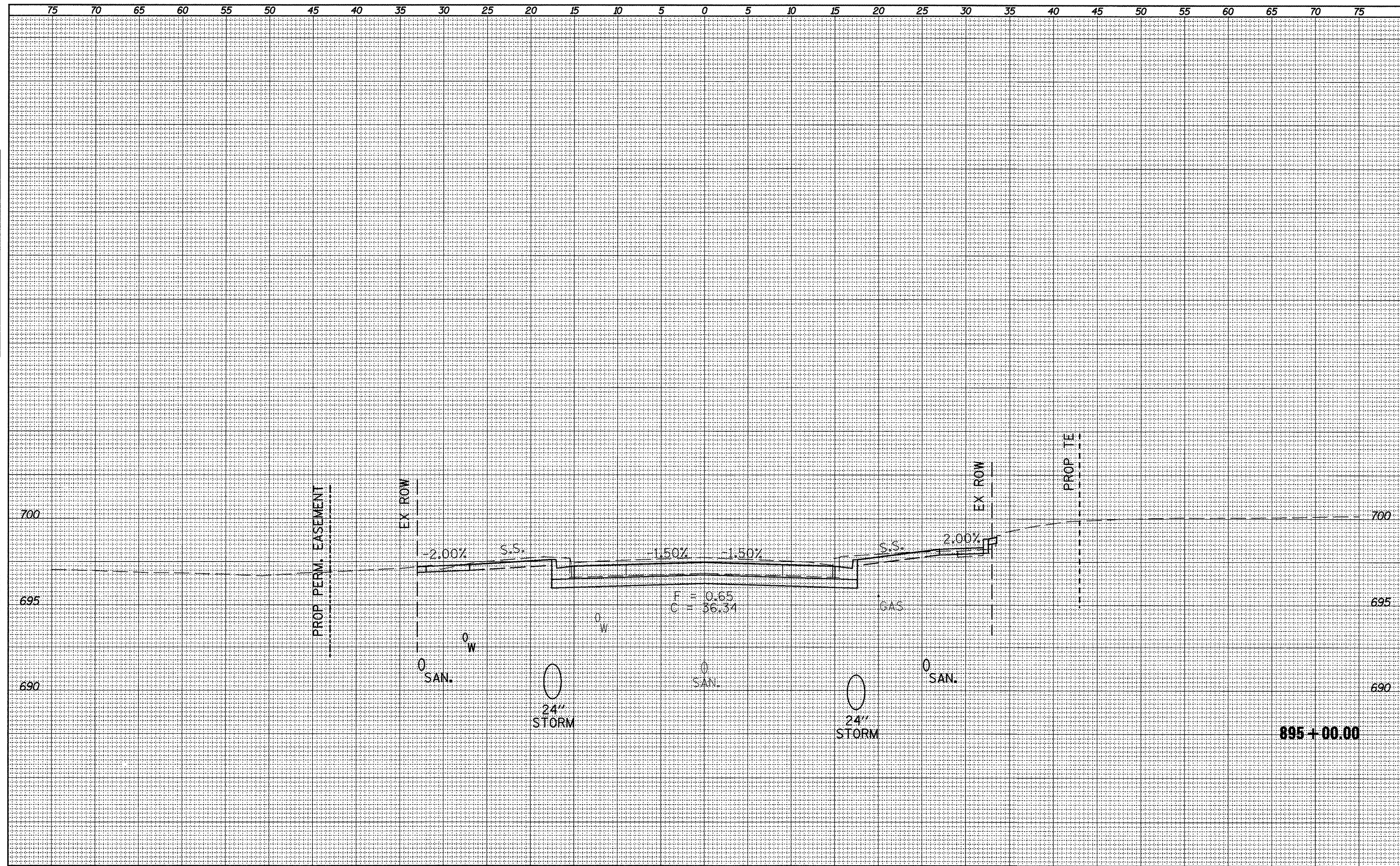

FILE NAME = xsect_sht.dgn	USER NAME = horstkj	DESIGNED -	REVISED -	<b>STATE OF ILLINOIS DEPARTMENT OF TRANSPORTATION</b>	<b>CROSS SECTIONS</b>	F.A.P. RTE. = 317	SECTION 16W-1,RS-3	COUNTY FULTON	TOTAL SHEETS 347	SHEET NO. 236	
	PLOT SCALE = 10.0457' / in.	DRAWN -	REVISED -			SCALE:	SHEET NO. OF SHEETS	STA. 895+00.00 TO STA. 895+00.00	CONTRACT NO. 88795		ILLINOIS FED. AID PROJECT
	PLOT DATE = 3/21/2012	CHECKED -	REVISED -								
		DATE -	REVISED -								