

PLOT ID: _____
 NOTE BOOK: _____
 NO. _____
 AREAS CHECKED: _____
 AREAS CHECKED: _____

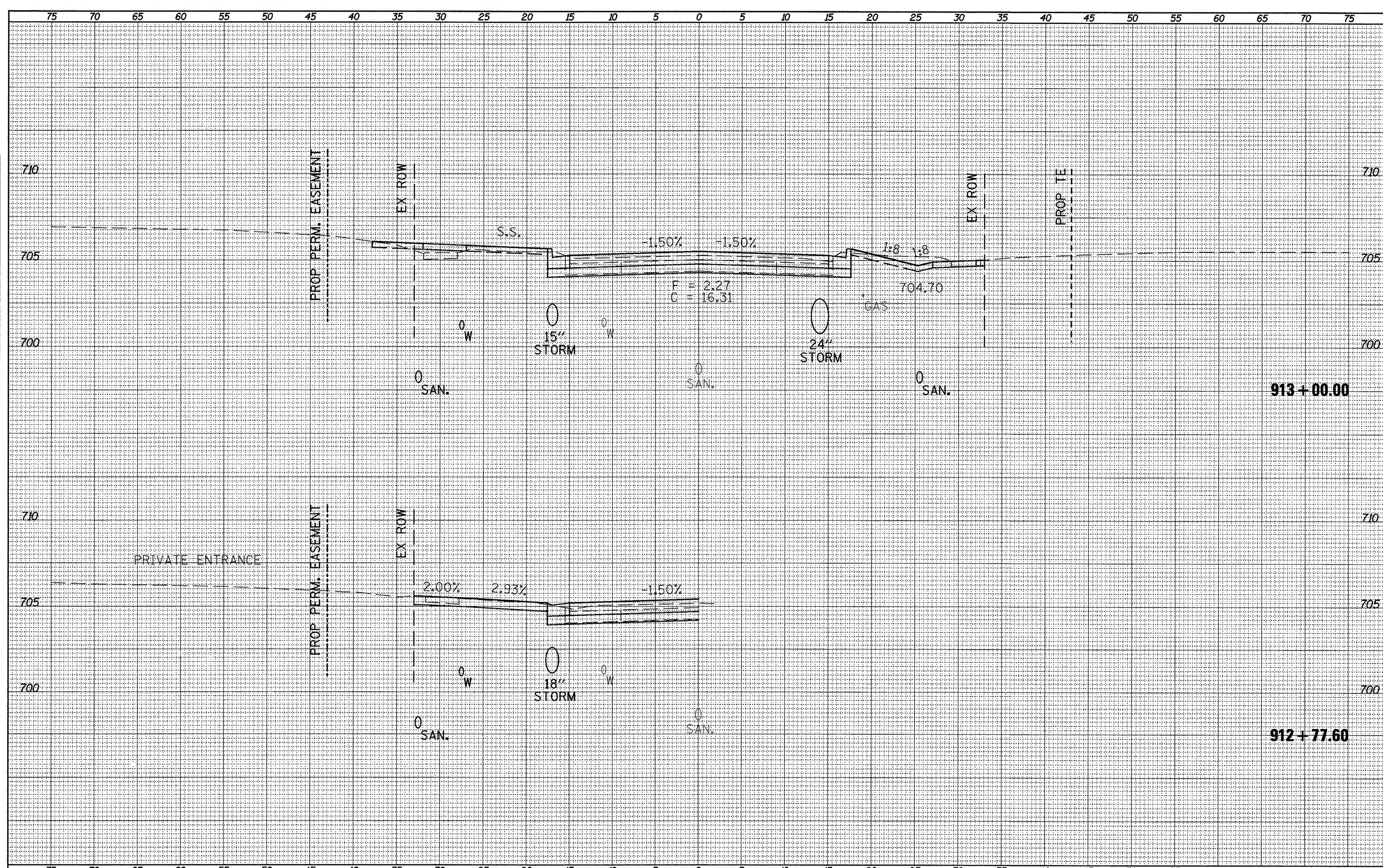

PLOT ID: _____
 NOTE BOOK: _____
 NO. _____
 AREAS CHECKED: _____
 AREAS CHECKED: _____

FILE NAME = xsect_sht.dgn	USER NAME = horstkj	DESIGNED -	REVISED -	STATE OF ILLINOIS DEPARTMENT OF TRANSPORTATION	CROSS SECTIONS	F.A.P. RTE. 317	SECTION 16W-1,RS-3	COUNTY FULTON	TOTAL SHEETS 347	SHEET NO. 271		
	PLOT SCALE = 18.0457' / 1"	DRAWN -	REVISED -			SCALE:	SHEET NO. OF SHEETS	STA. 912+77.60	TO STA. 913+00.00	CONTRACT NO. 88795		
	PLOT DATE = 3/21/2012	CHECKED -	REVISED -			ILLINOIS FED. AID PROJECT						
		DATE -	REVISED -									