

| PLAN | | BY | | DATE |
|----------|----|------|--|------|
| SURVEYED | BY | DATE | | |
| NOTED | BY | DATE | | |
| ALIGNED | BY | DATE | | |
| CHECKED | BY | DATE | | |
| DESIGNED | BY | DATE | | |

| PROFILE | | BY | | DATE |
|----------------|----|------|--|------|
| PROPOSED | BY | DATE | | |
| GRADES CHECKED | BY | DATE | | |
| NOTE BOOK | BY | DATE | | |
| NO. | BY | DATE | | |

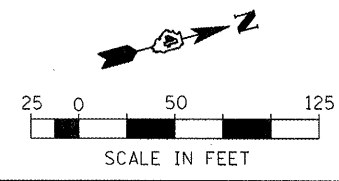

PROP. CURVE VET1
PI STA. = 110+71.73
 $\Delta = 18^\circ 25' 57''$ (RT)
 $D = 1^\circ 08' 45''$
 $R = 5,000.00'$
 $T = 811.28'$
 $L = 1,608.53'$
 $E = 65.39'$
 $S.E. = 3\%$
TRANSITION IN = STA. 99+80.45 TO STA. 103+30.45
TRANSITION OUT = STA. 117+98.98 TO STA. 121+48.98
P.C. STA. = 102+60.45
P.T. STA. = 118+68.99

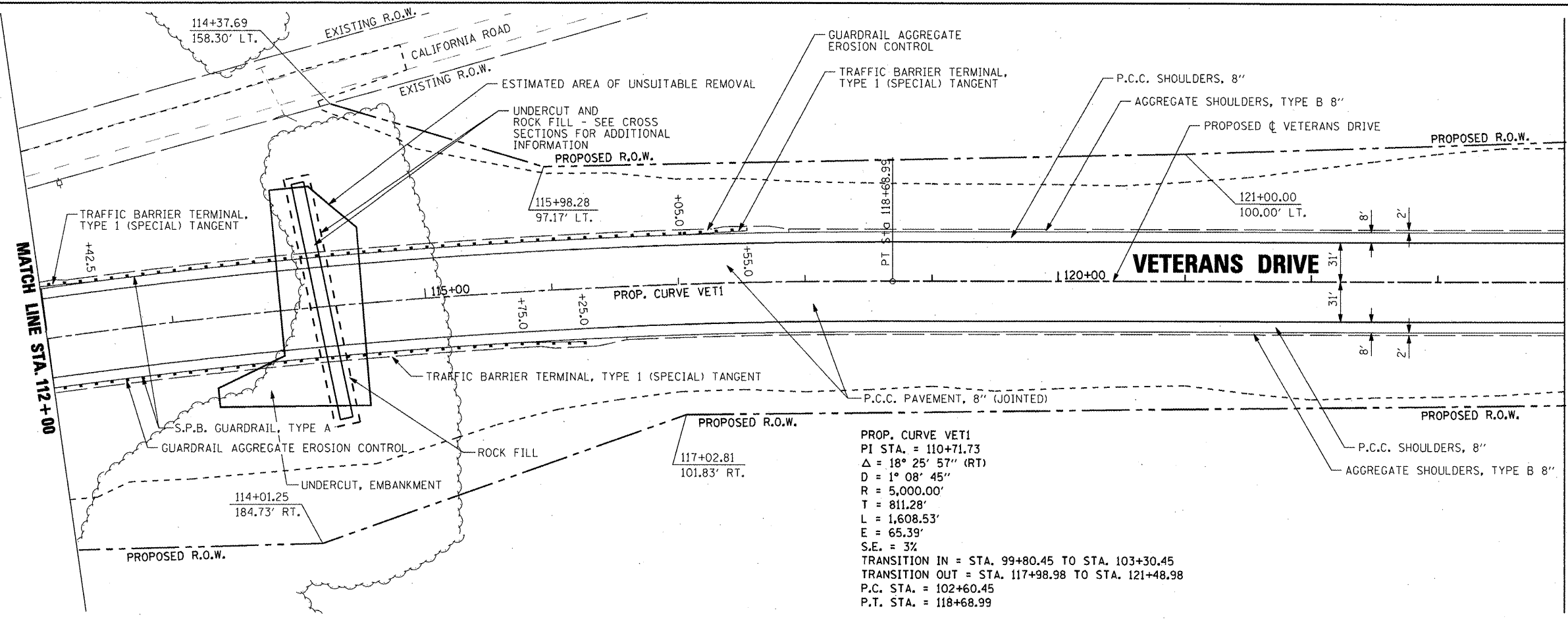
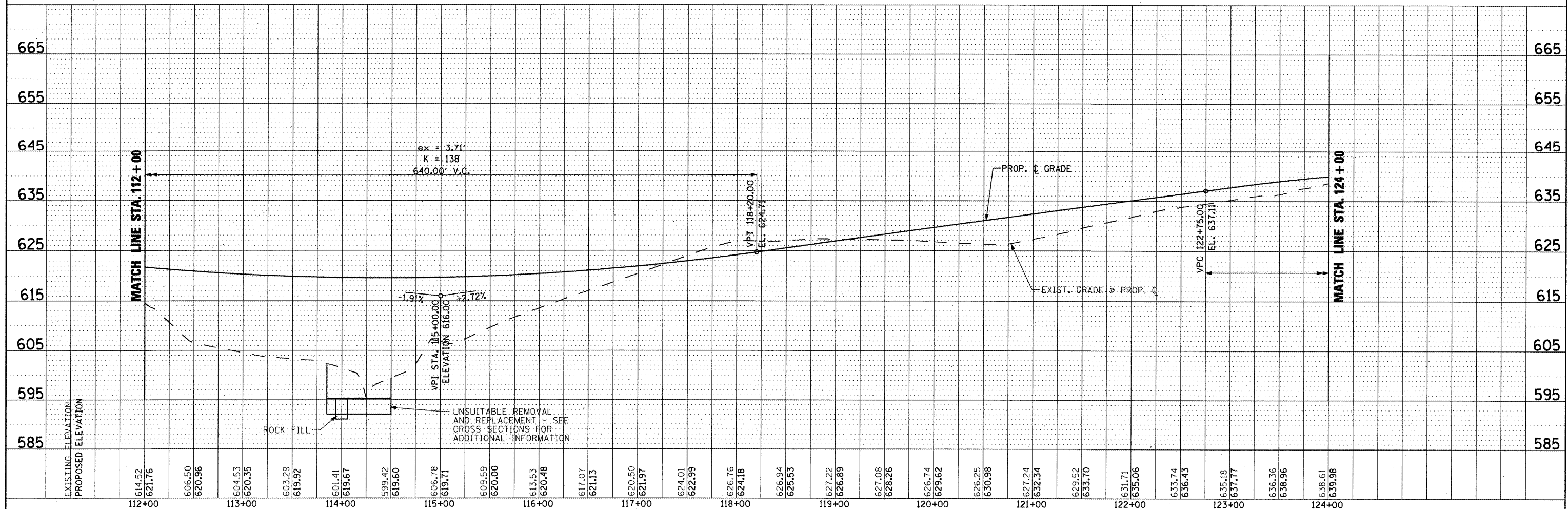

| | | | | | | | | | | | |
|--|------------------|------------------|-----------|---|---|---------------------------|----------------|----------|--------------|-----------|--|
| FILE NAME = | USER NAME = IDOT | DESIGNED REW/KRS | REVISED - | STATE OF ILLINOIS DEPARTMENT OF TRANSPORTATION | VETERANS DRIVE IMPROVEMENTS ROADWAY PLAN AND PROFILE | F.A.U. RTE. | SECTION | COUNTY | TOTAL SHEETS | SHEET NO. | |
| xi\projects\200805025\dgn\plans and xref | NLPR 112-124.dgn | DRAWN CAM | REVISED - | | | 676B | 10-00169-00-RP | TAZEWELL | 98 | 23 | |
| PLOT SCALE = 100.0000' / IN. | CHECKED KMC | DATE 3-21-12 | REVISED - | | | CONTRACT NO. 89588 | | | | | |
| PLOT DATE = 4/12/2012 | | | | | | ILLINOIS FED. AID PROJECT | | | | | |