

DATE	
BY	
FINAL SURVEY	
NOTED	
PLOTTED	
TEMPLATE	
AREAS	
CHECKED	
NO.	

DATE	
BY	
ORIGINAL SURVEY	
NOTED	
PLOTTED	
TEMPLATE	
AREAS	
CHECKED	
NO.	

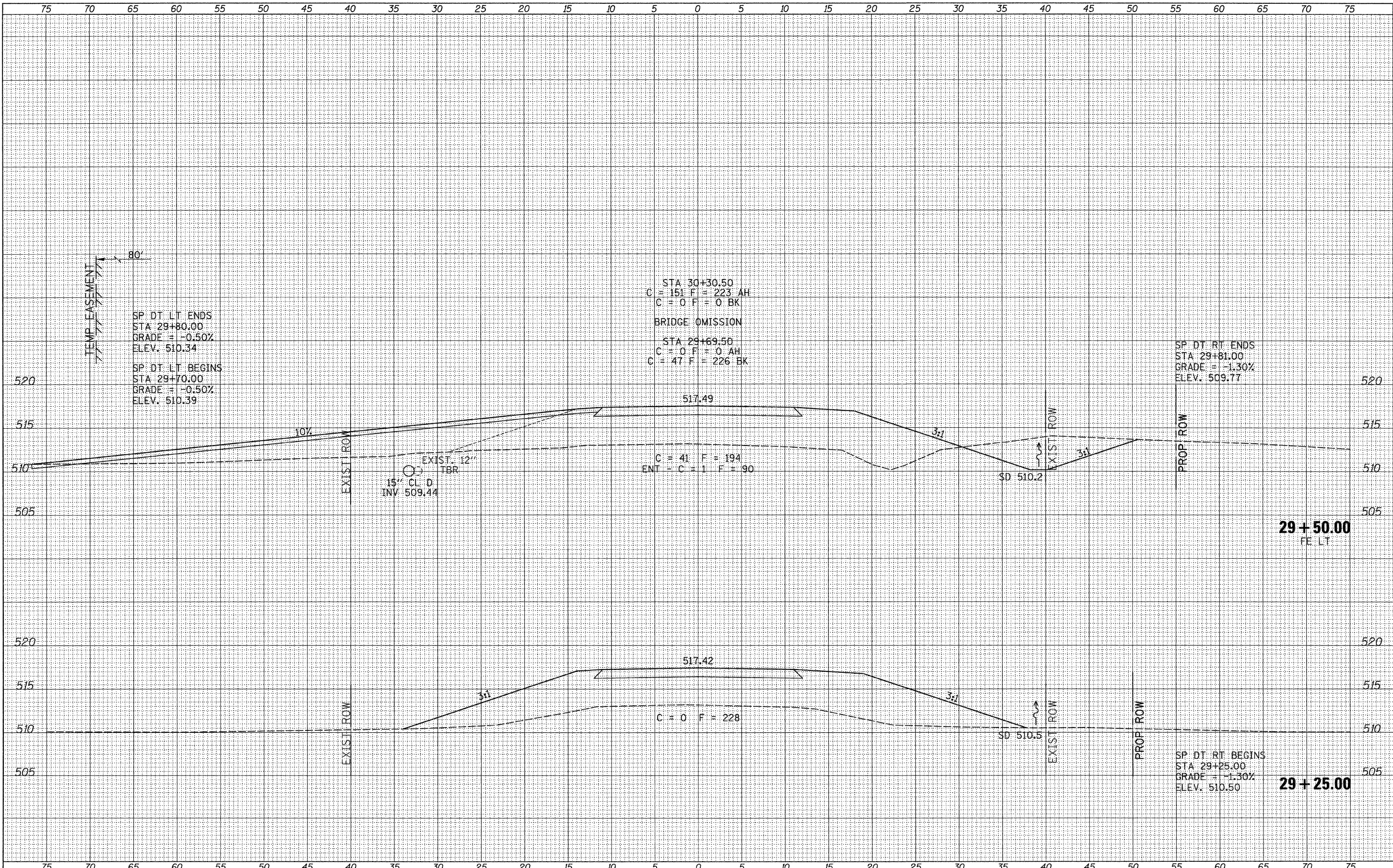

FILE NAME =	USER NAME = othomas	DESIGNED -	REVISED -	MASON COUNTY COUNTY HIGHWAY 5 OVER DUFF ARMSTRONG DITCH	CROSS SECTIONS			F.A.S. RTE.	SECTION	COUNTY	TOTAL SHEETS	SHEET NO.
V:\Bridges\2964 - Mason\2964\khta.dgn		DRAWN -	REVISED -		572	10-00016-02-BR	MASON	22	17			
PLOT SCALE = 5.0000' / IN.		CHECKED -	REVISED -		SCALE: 1"=5'			SHEET NO. 4 OF 9 SHEETS STA. 29+25.00 TO STA. 29+50.00			CONTRACT NO. 93568	
PLOT DATE = 10/21/2011		DATE -	REVISED -		FED. ROAD DIST. NO. 7 ILLINOIS			FED. AID PROJECT BRS-0572(305)				