

FINAL SURVEY NO.	DATE
REVISIONS	BY
PLOTTED	
TEMPLATE	
AREAS CHECKED	

ORIGINAL SURVEY NO.	DATE
REVISIONS	BY
PLOTTED	
TEMPLATE	
AREAS CHECKED	

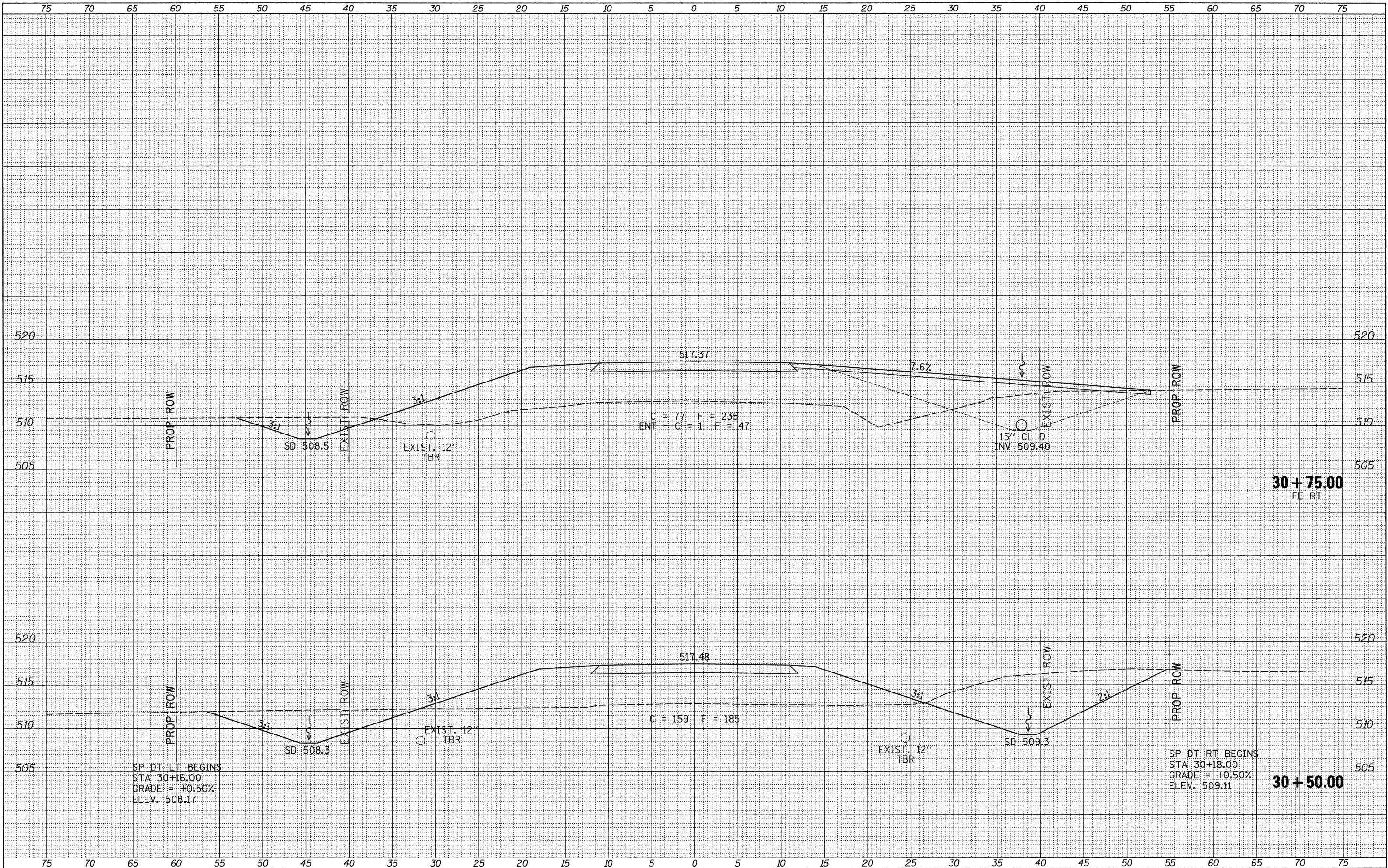

FILE NAME = V:\Bridges\2964 - Mason\2964\shsta.dgn	USER NAME = c.thomas	DESIGNED -	REVISED -	<b>MASON COUNTY COUNTY HIGHWAY 5 OVER DUFF ARMSTRONG DITCH</b>	<b>CROSS SECTIONS</b>			F.A.S. RTE. 572	SECTION 10-00016-02-BR	COUNTY MASON	TOTAL SHEETS 22	SHEET NO. 18
PLOT SCALE = 5.0000' / IN.	CHECKED -	REVISED -	REVISED -		SCALE: 1"=5'	SHEET NO. 5 OF 9 SHEETS	STA. 30+50.00 TO STA. 30+75.00	CONTRACT NO. 93568				
PLOT DATE = 10/21/2011	DATE -	REVISED -	REVISED -		FED. ROAD DIST. NO. 7 ILLINOIS FED. AID PROJECT BRS-05723051							