

24 REMOVE DRIVEWAY PAVEMENT = 42 S.Y.	25 REMOVE DRIVEWAY PAVEMENT = 41 S.Y.	26 REMOVE DRIVEWAY PAVEMENT = 42 S.Y.	27 REMOVE DRIVEWAY PAVEMENT = 23 S.Y.
28 CURB REMOVAL = 387 FT PAVEMENT REMOVAL SPECIAL = 50 S.Y.	29 HOT-MIX ASPHALT SURFACE REMOVAL-BUTT JOINT (30') A = 153 S.Y. B = 172 S.Y. TOTAL = 325 S.Y.	30 REMOVE INLET = 1 EA	31 CURB REMOVAL = 350 FT
32 CC&G REM. = 32 FT	33 HOT-MIX ASPHALT SURFACE REMOVAL- BUTT JOINT (30') = 163 S.Y.	34 REMOVE DRIVEWAY PAVEMENT A = 8 S.Y. B = 6 S.Y. C = 11 S.Y. D = 5 S.Y. TOTAL = 30 S.Y.	35 PAVEMENT REMOVAL SPECIAL = 40 S.Y.

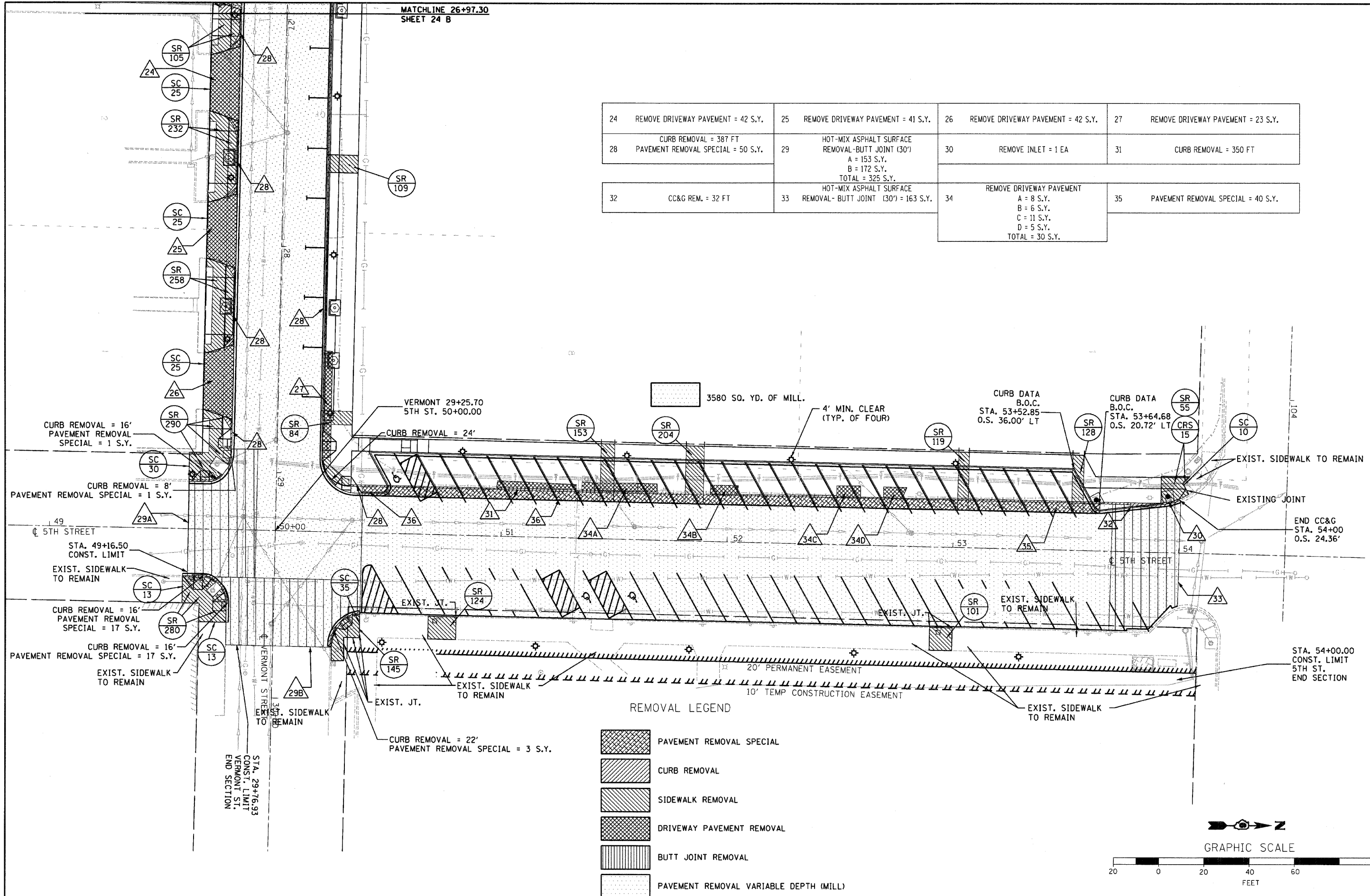

REMOVAL LEGEND

	PAVEMENT REMOVAL SPECIAL
	CURB REMOVAL
	SIDEWALK REMOVAL
	DRIVEWAY PAVEMENT REMOVAL
	BUTT JOINT REMOVAL
	PAVEMENT REMOVAL VARIABLE DEPTH (MILL)

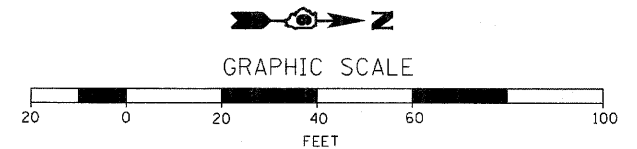

FILE NAME = D6XXXX-sh1-24_C-Removal	USER NAME = MDL	DESIGNED -	REVISED -
PLOT SCALE = 1" = 40'	DRAWN -	REVISOR -	REVISOR -
PLOT DATE = #DATE#	CHECKED -	REVISOR -	REVISOR -
	DATE -	REVISOR -	REVISOR -

STATE OF ILLINOIS
DEPARTMENT OF TRANSPORTATION

REMOVAL PLANS

SCALE: 1" = 20' SHEET NO. 3 OF 3 SHEETS STA. _____ TO STA. _____

F.A.P. RTE. 63	SECTION 09-00309-00-LS	COUNTY ADAMS	TOTAL SHEETS 39	SHEET NO. 24 B
				CONTRACT NO. 93578
ILLINOIS FED. AID PROJECT				