

NOTE:
CONTRACTOR SHALL PROVIDE NECESSARY UTILITY LOCATE FOR ALL UNDERGROUND UTILITY SERVICES

○ LIGHTING UNIT "A" - COMPLETE HOLOPHANE GRANVILLE SERIES LUMINAIRE WITH 150W., 240V., HIGH PRESSURE SODIUM LAMP EQUIPPED WITH A ONE PIECE PRISMATIC REFRACTOR WITH IES TYPE III DISTRIBUTION PATTERN AND S-67517 COLOR CORRECTED LAMP ON A 14' TALL HISTORIC STYLED POLE WITH A 120V. RECEPTACLE.

□ LIGHTING UNIT "B" - COMPLETE SAME AS UNIT "A" EXCEPT GLOBE SHALL INCLUDE LUNAR OPTIC LOUVERS.

▽ LUMINAIRE, SODIUM VAPOR, VERTICAL MOUNT, 250W., SINGLE HEAD SODIUM VAPOR LUMINAIRE WITH ADJUSTABLE THROW (DESIGNED FOR ZERO DEGREE TILT), FLAT GLASS, MULTI-MOUNT, MULTI-TAP BALLAST, WITH A 250W., 240V. LAMP WITH IES "FORWARD THROW" DISTRIBUTION PATTERN AND MOUNTED ON A 30' TALL POLE.

HARLAN'S AUTO SALES, INC.
339 VERMONT STREET

THE SALVATION ARMY
RAY AND JOAN KROC CORPS
COMMUNITY CENTER
323 NORTH 5TH STREET

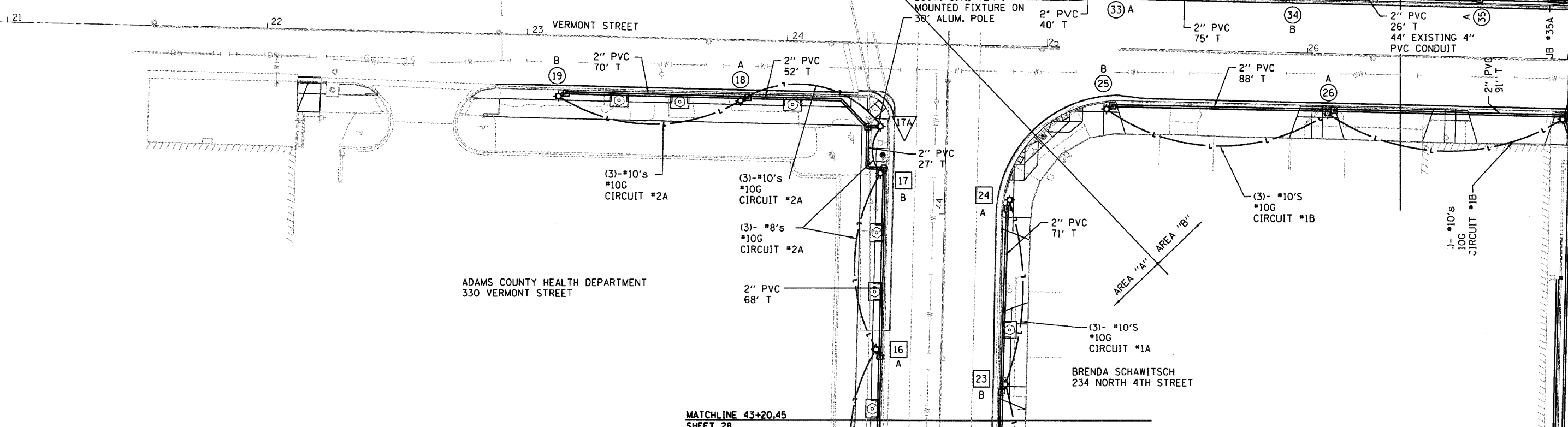

FILE NAME = DBXXXX-sh-29-Light	USER NAME = MDL	DESIGNED -	REVISED -
		DRAWN -	REVISED -
		CHECKED -	REVISED -
		DATE -	REVISED -

PLOT SCALE = 1" = 40'	DESIGNED -	REVISED -
PLOT DATE = *DATE*	DRAWN -	REVISED -
	CHECKED -	REVISED -
	DATE -	REVISED -

**STATE OF ILLINOIS
DEPARTMENT OF TRANSPORTATION**

**ROADWAY LIGHTING
SHEETS**

SCALE: 1" = 20' SHEET NO. 2 OF 3 SHEETS STA. _____ TO STA. _____

F.A.P. RTE. 63	SECTION 09-00309-00-LS	COUNTY ADAMS	TOTAL SHEETS 39	SHEET NO. 29
CONTRACT NO. 9 5 7 8				
ILLINOIS FED. AID PROJECT				