

SECTION	11-00096-00-BR	TOTAL SHEETS	16	SHEET NO.	4
COUNTY	CRAWFORD	ROUTE	FAS 698 (CH 3)	STA. 299+00	TO STA. 299+50

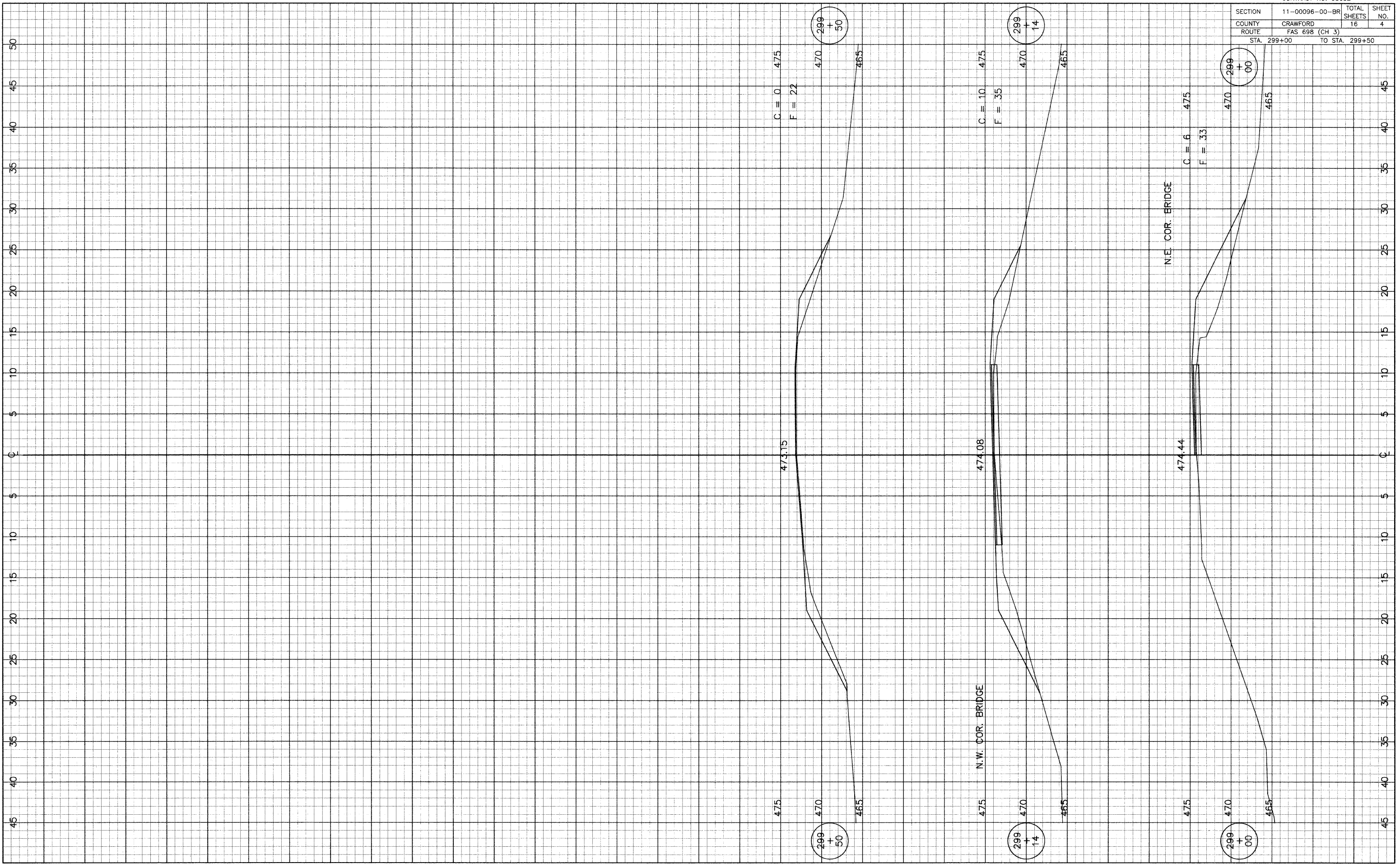

C = 0 475
F = 22

C = 10 475
F = 35

C = 6 475
F = 33

299 + 50

299 + 14

299 + 00

475

470

465

475

470

465

475

470

465

475.15

474.08

474.44

N.W. COR. BRIDGE

N.E. COR. BRIDGE

N.E.L. COR. BRIDGE

45 40 35 30 25 20 15 10 5 0 5 10 15 20 25 30 35 40 45 50

45 40 35 30 25 20 15 10 5 0 5 10 15 20 25 30 35 40 45 50