

- NOTE:
- ALL BRUSH TO BE CLEARED WITHIN THE EASEMENT AREAS BOTH UPSTREAM AND DOWNSTREAM OF THE PROPOSED BOX CULVERT.
 - CONTRACTOR TO EXPOSE SANITARY LATERAL PRIOR TO CONSTRUCTING STORM SEWER TO VERIFY CLEARANCE.

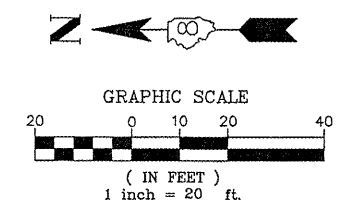

620																								620
615																								615
610																								610
605																								605
600																								600
595																								595
590																								590
585																								585

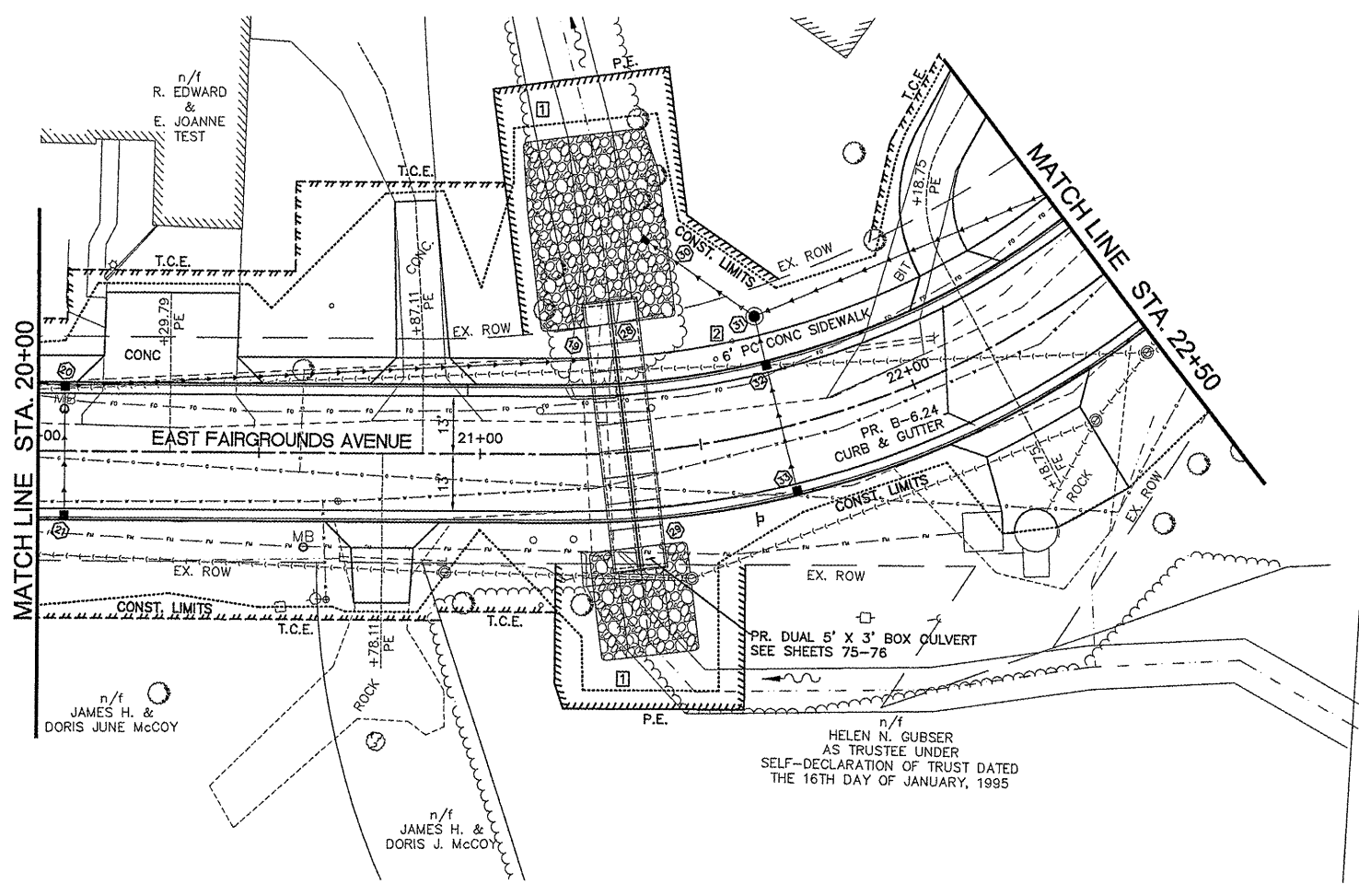